

PROPOSED AGRICULTURAL BUILDING
IDENTICAL IN SIZE TO BUILDING A
176.5m² APPROX

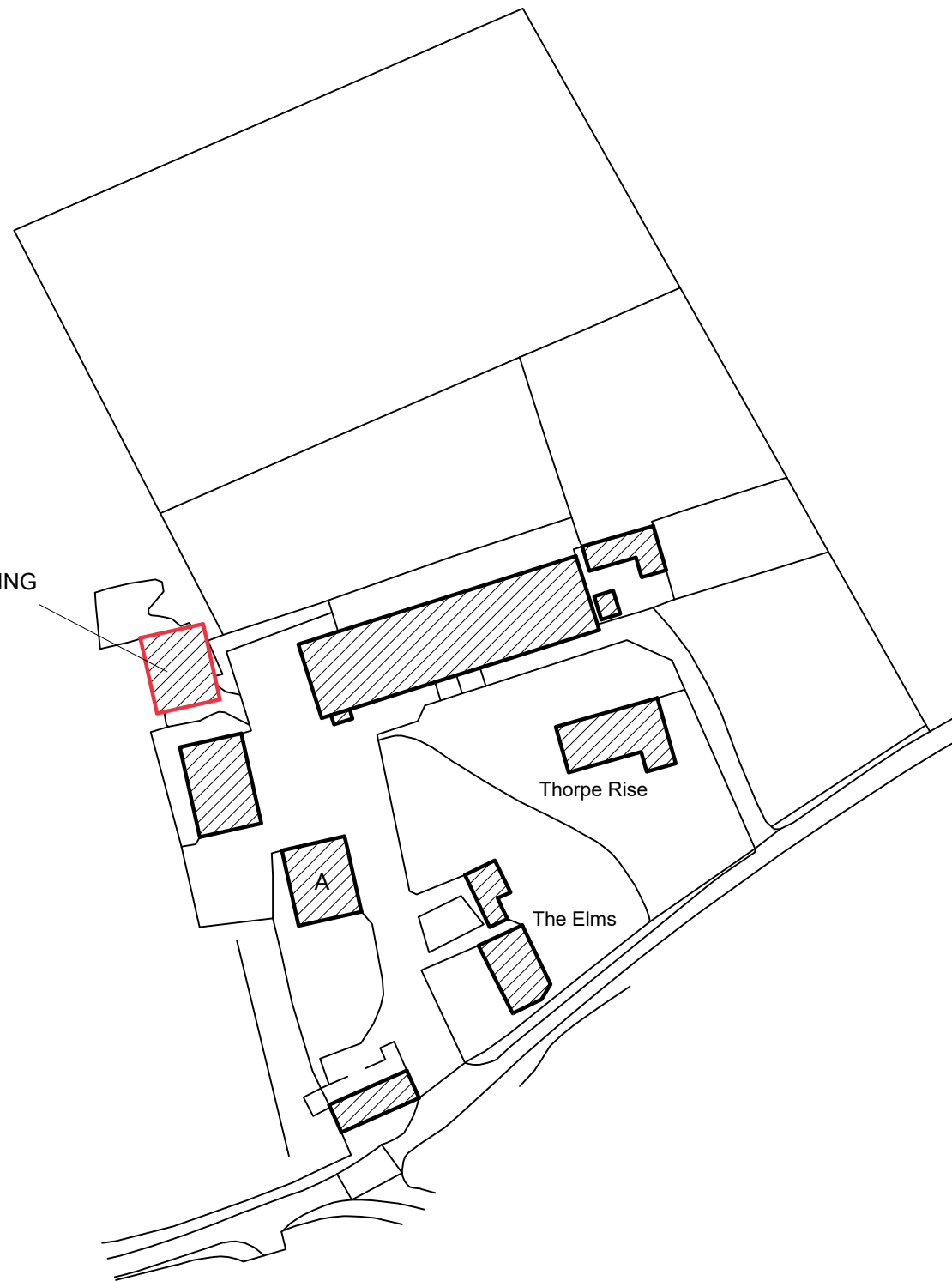

Ordnance Survey, (c) Crown Copyright 2020. All rights reserved. Licence number 100022432

LOCATION PLAN
SCALE 1:1250

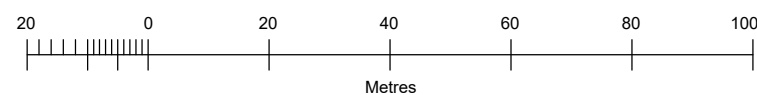

No. Date Revisions
Revisions

HOLLINS

Architects, Surveyors &
Planning Consultants

The Guildhall
Market Hill
Framlingham
Suffolk
IP13 9BD

Telephone 01728 723959
E mail all@hollins.co.uk
Website www.hollins.co.uk

Client

MR ANDREW AVES

Site

THE ELMS,
HINDERCLAY, DISS,
NORFOLK, IP22 1HT,

Project

NEW AGRICULTURAL BUILDING

Details

LOCATION PLAN

Scale

1:1250 @ A3

Date

NOVEMBER 2020

Drawn by

RJB

Drawing number

20226 1

This drawing is copyright. This drawing must not be scaled. Before commencing any work the contractor must set out and check all dimensions on site. This drawing to be read in conjunction with any consultants details. Any discrepancies must be reported to Hollins Architects & Surveyors.