

Location Plan 1:1250

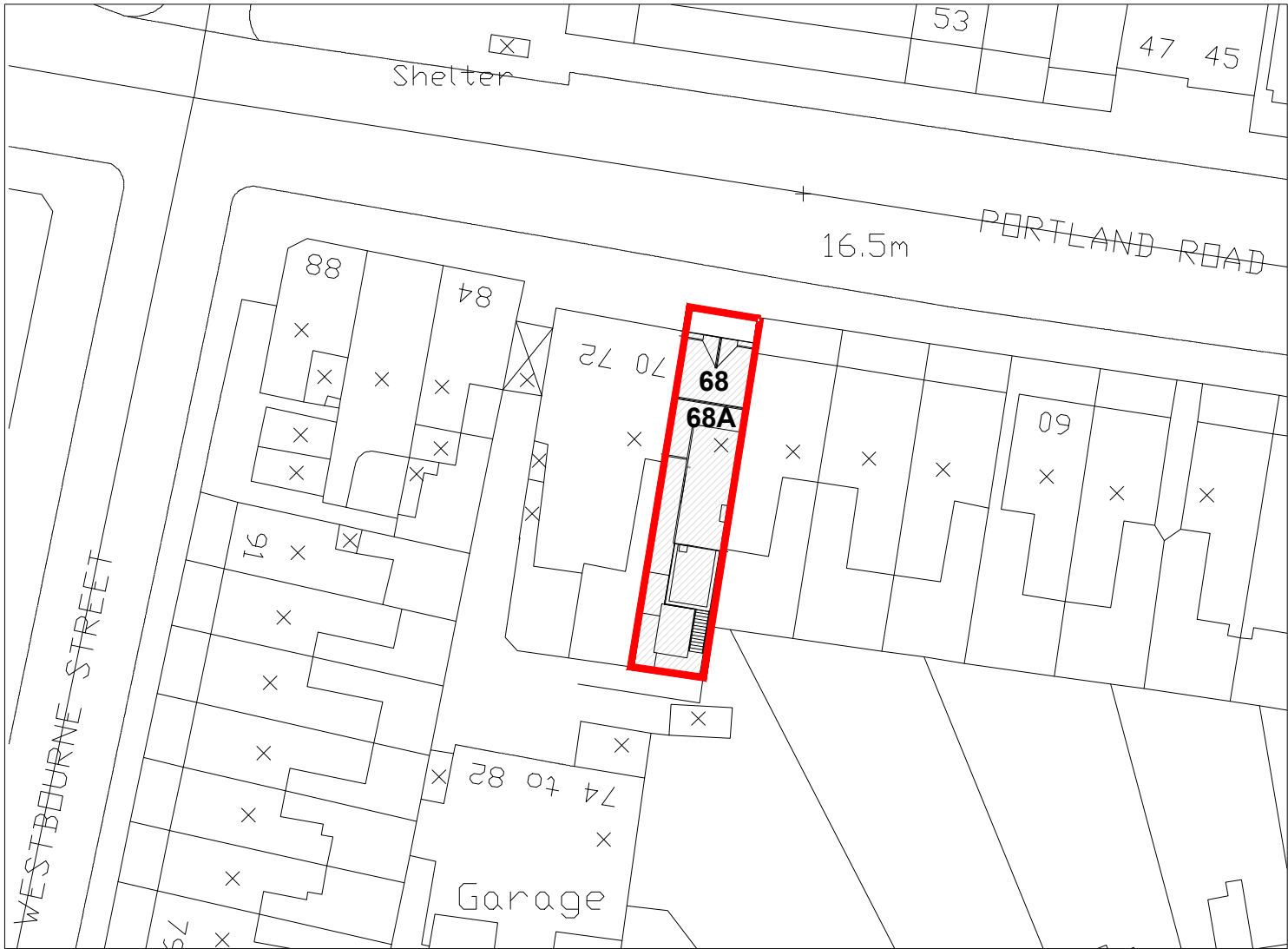

Block Plan 1:500

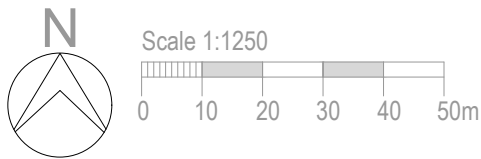
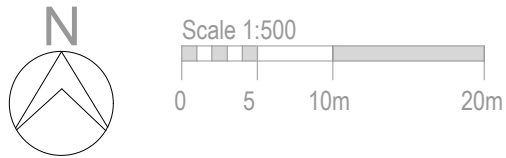

Proposal: Retaining the existing front restaurant entrance (Amendment to approved application BH2020/02948), new boiler and extractor flues on front roof (part retrospective) and rear brick wall to be changed to render wall and associated works.

CLIENT
Mrs Linda
This drawing is for Planning Permission purpose only. All dimensions to be confirmed on site.
© This drawing is the sole copyright of Wang Dao Architecture Ltd.
Any discrepancies between this drawing & other information shall be reported to the Architect. MODIFICATIONS to be made solely on ORIGINAL MAGNETIC MEDIA.

PROJECT
68 Portland Road Hove BN3 5DL
TITLE
Changes Location and Block Plans

STATUS
Planning
DATE
September 2020
DRAWN BY
Edward
DRAWING NUMBER
2009 PL1 01
CTB file:
XREFS: