

Existing Roof/Site layout

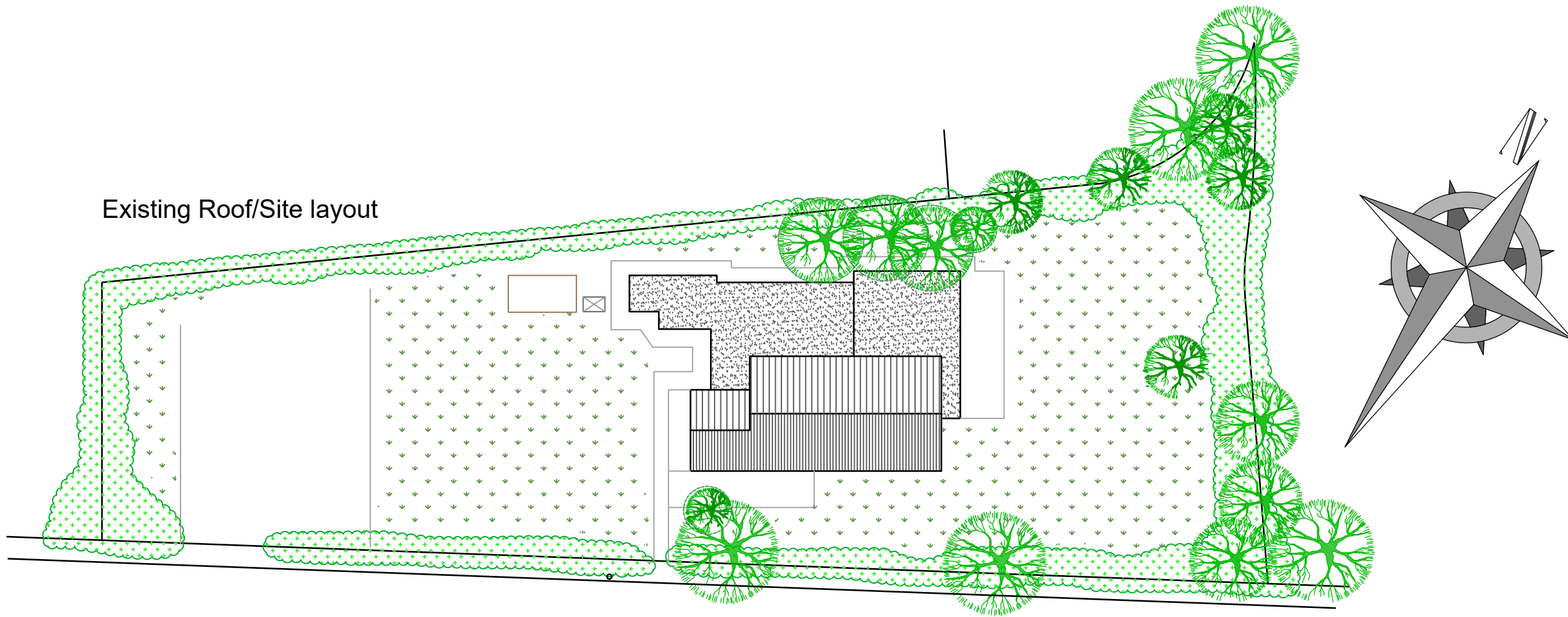

Chapel Lane

Proposed Roof/Site layout

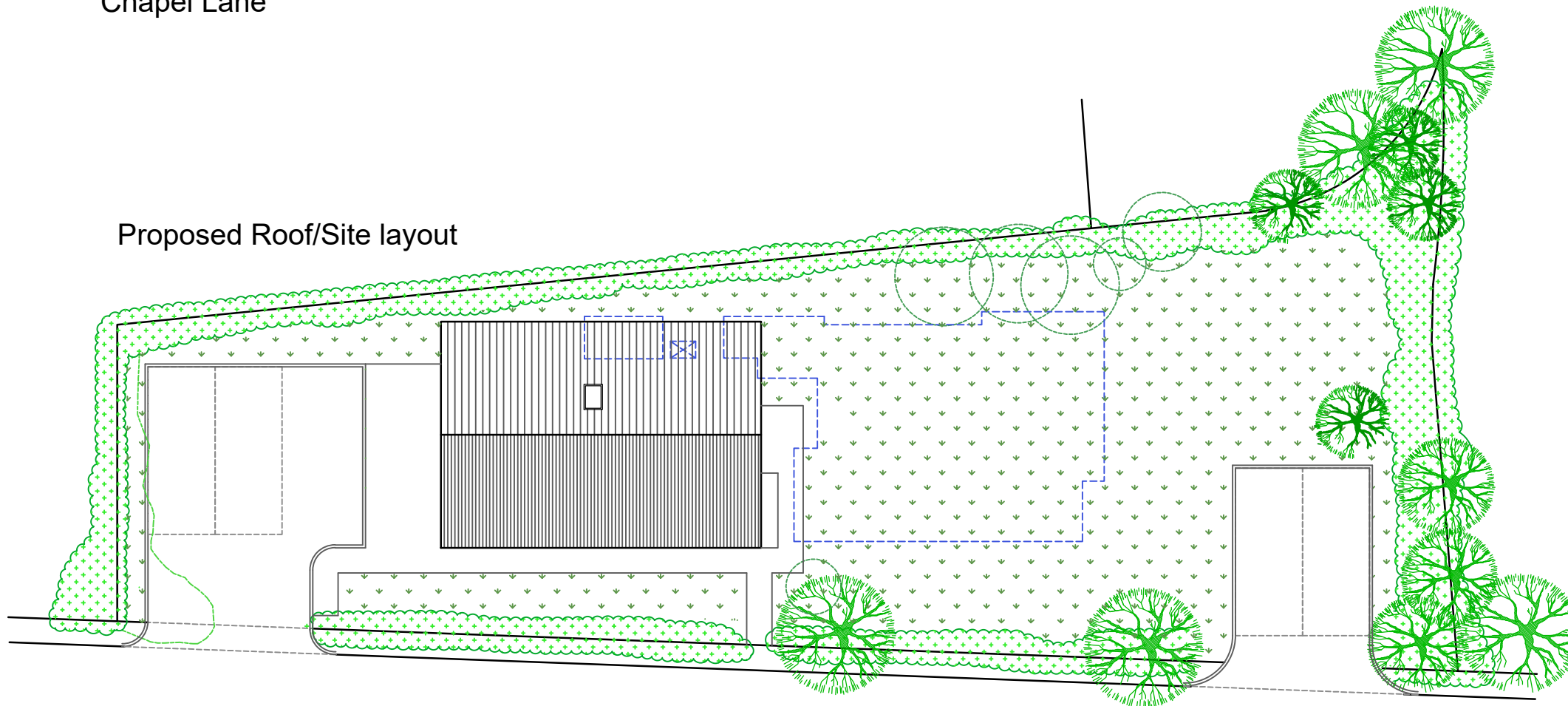

Chapel Lane

Status
[Submitted for L.A.Planning approval.](#)

Project
 Proposed replacement Dwelling.
 'Syringa', Chapel Lane,
 Acton Bridge,
 Northwich,
 Cheshire,
 CW8 3QS

Title
 Existing & Proposed Site layouts

Client
 Mrs L. Hanmer

Date Scale
 01:21 1:200@A3

Job no Drawing no Revision
 21-005 PL-07



AB Architecture Ltd
 Andrew Barber - Director

31 Radcliffe Road, Winsford
 Cheshire, CW7 1RE

01606 553 968 - 07739 795785
 www.abarch.co.uk
 andy@abarch.co.uk