

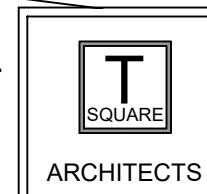

MR ADAM
 PROPOSED SPIRAL FIRE ESCAPE STAIR
 AND PATIO DOORS
 6B PITT TERRACE, STIRLING



Architecture - Design - Planning
 39 Allanvale Road
 Bridge of Allan
 Stirling
 FK9 4PA
 Mob: 07596906412
 E-mail: claire.gibbons@tsquare-architects.co.uk Web: www.tsquare-architects.co.uk

SITE PLAN

scale	1:200	date	15.01.21	drawn	CG	status	P
proj no.	2020-832	Dwg no.	T-701				-