

Produced on 14 January 2021 from the Ordnance Survey National Geographic Database and incorporating surveyed revision available at this date.
 This map shows the area bounded by 279570,692958 279570,693100 279712,693100 279712,692958
 Reproduction in whole or part is prohibited without the prior permission of Ordnance Survey.
 Crown copyright 2021. Supplied by copla ltd trading as UKPlanningMaps.com a licensed Ordnance Survey partner (100054135).
 Data licenced for 1 year, expiring 14 January 2022. Unique plan reference: v2c/558762/756873

MR ADAM

PROPOSED SPIRAL FIRE ESCAPE STAIR
 AND PATIO DOORS
 6B PITT TERRACE, STIRLING

LOCATION PLAN

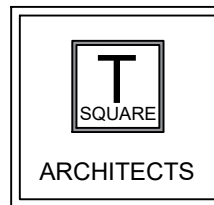

Architecture - Design - Planning

39 Allanvale Road
 Bridge of Allan
 Stirling
 FK9 4PA

Mob: 07596906412
 E-mail: daire.gibbons@tsquare-architects.co.uk Web: www.tsquare-architects.co.uk

scale	1:1250	date	15.01.21	drawn:	CG	status:	P
proj no.	2020-832		Dwg no.	T-101		-	