

Notes

For full detail of proposed works, including relocating of existing doors please see the Schedule of Works in Appendix 1 of the Design, Access and Heritage Statement.

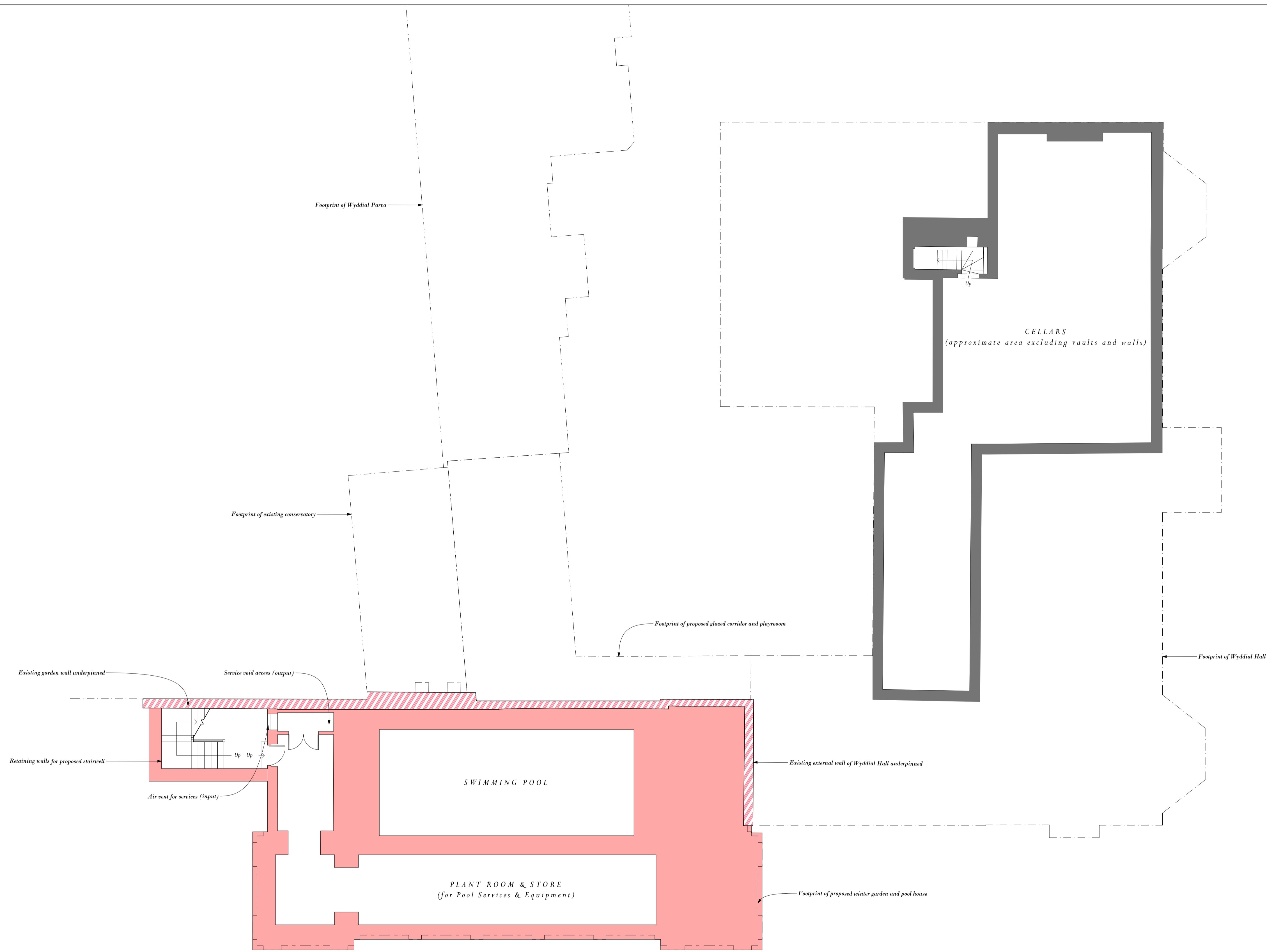

- KEY**
- Proposed alterations
  - Existing fabric
  - Fabric and walls to be removed

A	03/10/18	Revised plan of footprint for Winter Garden / Pool House	JH
Rev.	Date	Description	Initials

Scale 1:100 @ A1  
Scale 1:200 @ A3

# WYDDIAL HALL, HERTFORDSHIRE

## Proposed Lower Ground Floor Plan

1:100 @ A1

Drawing Number : 6021/PL07 Rev. A | April 2018 | Author: PP / RP

**ADAM ARCHITECTURE**  
www.adamarchitecture.com contact@adamarchitecture.com