

Technical Survey Form

Sales person:	Ian Whyte	Surveyor	William OHagan
Job Type:	Domestic - Private Sale	Category:	Stiltz build
Site visit date:	16-Jun-2020	Postcode:	AB35 5TB
Site visit time:	16:09	Survey Type	Final tech survey - Stiltz build

Customer details (Used for invoicing)	
Name:	Mr I Murray
House No/Street:	Balmoral Estate
Line 2:	Balmoral
Town:	Ballater
County:	Aberdeenshire
Postcode:	AB35 5TB
Telephone:	0000
Mobile:	07771346650
Email address:	ianlochnagar1@btinternet.com

Installation address	
House No/Street:	Balmoral Estate
Line 2:	Balmoral
Town:	Ballater
County:	Aberdeenshire
Postcode:	AB35 5TB
Main contact:	
Telephone:	

Lift Type:	New
Total warranty agreed: (standard warranty 12 months)	12
Other warranty details:	
Does the customer have a blue badge or doctors letter?	Yes <input type="checkbox"/> No <input checked="" type="checkbox"/>
Order form completed on site?	Yes <input type="checkbox"/> No <input type="checkbox"/>
Are there any planning requirements?	
Grade 1 <input type="checkbox"/> Grade 2 <input checked="" type="checkbox"/> Full plans for commercial building <input type="checkbox"/> Building warrant <input type="checkbox"/> Std building control <input type="checkbox"/>	
Does the client have a DECT cordless phone?	Yes <input checked="" type="checkbox"/> No <input type="checkbox"/>

Structural approvals	
Ground floor strengthening?	Yes <input type="checkbox"/> No <input checked="" type="checkbox"/>
Building work structural approval/ calculations required?	Yes <input checked="" type="checkbox"/> No <input type="checkbox"/>

Building works time		
Plumber man hours	8.00	hours
Electrician man hours	8.00	hours
Gas engineer man hours	0.00	hours
Builder man hours (based on 2 man team)	48.00	hours

Installation	
Pit required?	Yes <input type="checkbox"/> No <input checked="" type="checkbox"/>
Loft recess required?	Yes <input checked="" type="checkbox"/> No <input type="checkbox"/>
Fit power supply?	Yes <input checked="" type="checkbox"/> No <input type="checkbox"/>
Loft recess or bulkhead?	Recess
Installation type	Aperture installation
Additional gate interlock kit(s) reqd?	Yes <input type="checkbox"/> No <input checked="" type="checkbox"/>
If yes, how many?	



Asbestos Details			
Is this a commercial building?	Yes	<input type="checkbox"/>	No <input type="checkbox"/>
Is there an asbestos register?	Yes	<input type="checkbox"/>	No <input type="checkbox"/>
Does the register indicate asbestos in the area where the lift is to be installed?	Yes	<input type="checkbox"/>	No <input type="checkbox"/>
Is this property built pre-2000?	Yes	<input checked="" type="checkbox"/>	No <input type="checkbox"/>
Asbestos test required?	Yes	<input checked="" type="checkbox"/>	No <input type="checkbox"/>
Asbestos details if possible presence identified: Both ceilings, deafening in void and plaster in loft area			

Job site details – lift location
<p>Please describe the location of the lift on both floors and a description of the works to be undertaken</p> <p>Installation of Lifton Trio EN81 from pantry to bathroom</p> <p>Lift installation - 16 hours Building Works - 48 hours Electrical Works - 8 hours Plumbing Works - 8 hours Property info - age, style, Property condition - Grade 2 large traditional build 2 storey cottage pre 1927</p> <p>First floor - 230 x 60 @ 450 centres spanning 4.6m with 22mm floorboards Ground floor - concrete Loft area - 150 x 60 @ 500 centres spanning 3m</p> <p>Stiltz are to create the aperture and fit insert for the lift - PLEASE REFER TO STRUCTURAL ENGINEER REPORT AND ARCHITECT DRAWINGS Stiltz are to create a 350mm deep loft recess 1200 x 1500 with removable lid for maintenance - PLEASE REFER TO STRUCTURAL ENGINEER REPORT AND ARCHITECT DRAWINGS Stiltz to fit insert in line with loft pocket Stiltz to remove stud wall between WC and bathroom Stiltz to remove deafening from void area Stiltz to fit plug socket for the lift to the rear left at high level in pantry ceiling Stiltz to resite ceiling light on both floors Stiltz to re-route cables around aperture area Stiltz to re-route pipework around aperture area Stiltz to fit client's carpet to lift lid</p> <p>STILTZ TO PROTECT ALL CARPETS THROUGHOUT AND KEEP DUST TO A MINIMUM - DUST PREVENTION WILL BE REQUIRED</p> <p>EXTRA GUIDE RAIL REQUIRED</p> <p>Client will remove all sanitary ware from wc and bathroom Client will fit new stud wall once install completed Client will clear loft area of rubbish Client will have member of staff shadow Stiltz at all times</p> <p>Rubbish ok on site only if collected quickly</p> <p>Stiltz to use toilets in staff quarters</p> <p>PLEASE CALL AHEAD, YOU MAY BE ESCORTED TO COTTAGE</p> <p>PLEASE NOTE THAT NOTHING CAN GO WRONG WITH THIS JOB FROM START TO FINISH</p>

Approved by Stiltz	Surveyor William OHagan	 Sign
--------------------	-------------------------	---

Client details			
Client weight:	10.00	stone	
Wheelchair weight:		stone	
Combined weight (Max weight should be <39.4 stone (250kg)):		10.00	stone

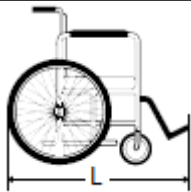
Does the lift user use a wheelchair in the lift?	No
Is there a wheelchair present?	
Is the wheelchair self propelled?	
Is the client likely to change wheelchair before lift installation?	

Wheelchair details			
Length should be taken from rear handles/wheel to front edge/toes of footplate (whichever is greater). Ensure there is enough clearance for wheelchair to fit in lift with client.		For width measurement ensure front castors are splayed out. Ensure there is enough clearance for wheelchair to fit in lift with client.	
Total length of wheelchair:		mm	Total width of wheelchair
			mm

VAT Charges			
Is VAT to be added to the price?	Yes	<input type="checkbox"/> No	<input checked="" type="checkbox"/>
Is the user over 60 years old?	Yes	<input type="checkbox"/> No	<input type="checkbox"/>

Lift details					
Lift model:	Lifton Tri (Trio+) specific options				
Lifton Trio (Trio+)					
EN81 hoist unit required?	Yes <input checked="" type="checkbox"/>	No <input type="checkbox"/>	Entry/exit options:	Ramped entry front only	
			Use controls (looking at lift)	Right hand side	Door option: Manual

Door swing (ground floor looking at front of lift): RH hinge - LH lock	
Lift colour finishes:	Custom RAL:
	Paint finish:

If colour finishes are different, please complete below:			
Rails:	Custom RAL:	Paint finish:	
Insert:	Custom RAL:	Paint finish:	
Lift Car:	Custom RAL:	Paint finish:	

Lift Interior:	If custom, please detail below:
Walls:	

Note: Floor only available as standard finish

Through car door options (only complete if through door)	
Front:	
Rear:	

Is the client able to manage the step into the lift – approx. 100mm If pit or ramp required, please complete relevant sections on survey sheet	No
---	----

Optional extras	
Seat: (Classic = Fold-Down, Lifton = Parch)	<input checked="" type="checkbox"/>
Ramp:	
UPS:	None
Handrails:	One
Door type:	Half Height

Ceiling height and travel		
Pit depth (if pit required)		mm
Ground floor to ceiling	2963	mm
Void thickness	280	mm
First floor to ceiling	2110	mm
Second floor void thickness		mm
Second floor to ceiling		mm
Ceiling recess depth (if required)	350	mm
Total travel	3243	mm
Total rail length	5703	mm

Measurements checked by surveyor?	Yes	<input checked="" type="checkbox"/>	No	<input type="checkbox"/>
EN81 hoist unit required?	Yes	<input checked="" type="checkbox"/>	No	<input type="checkbox"/>
Is ground floor level? (tolerance of 15mm allowed)	Yes	<input checked="" type="checkbox"/>	No	<input type="checkbox"/>
Is upper floor level? (tolerance of 15mm allowed)	Yes	<input checked="" type="checkbox"/>	No	<input type="checkbox"/>
Car to be cut down	Yes	<input type="checkbox"/>	No	<input checked="" type="checkbox"/>
Minimum ceiling height is 2370mm, cut down size 2270mm (100mm standard cut down)				
Cut down details				

Minimum ceiling heights chart				
Lift Type	Ground Floor + Aperture Minimum Height	**First Floor Minimum Ceiling Height	**Cut Down Options	SWL – Kg
Duo Classic/Vista/Thru	2450mm	2370mm	Max cut down 200mm	170
Duo+ (Lifton)	2450mm	2370mm	Max cut down 100mm	170
Trio Classic/Thru	2450mm	2370mm	Max cut down 200mm	220
Trio+ No Ramp Entry				
Trio+ (Lifton)	2450mm	2370mm	Max cut down 100mm	250
Trio+ Thru (Lifton)	2450mm	2370mm	Max cut down 100mm	250
Trio+ Ramp Entry or Exit				
Trio+ (Lifton)	2450mm	2430mm	Max cut down 100mm	250
Trio+ thru (Lifton)	2450mm	2430mm	Max cut down 100mm	250
** Note if lift is cut down first floor min ceiling height is reduced by cut down value				

Rail fixing			
Lower floor		Upper floor	
Lower floor material:	Concrete	Upper floor material:	Timber
Lower floor covering:	Carpet	Upper floor covering:	Carpet
Lower floor under floor heating:	No	Upper floor under floor heating:	No
Lower floor ceiling:	Lath and plaster	Upper floor ceiling:	Lath and plaster

Rail fixing notes
EXTRA GUIDE RAIL REQUIRED

	Stiltz building works responsibilities Enter no req	Client Responsibilities Enter no req
Aperture formed in plasterboard ceiling	1	
Aperture formed through block, beam floor/ with cost of steel	0	
Aperture formed through concrete floor/ with cost of steel	0	
Install 18mm MDF bulkhead, get ready for decoration		
Brackets for ceiling voids		
Stair void rail brackets		
Stair void false ceiling bulk head, MDF/plaster finish, (Scaffold)		
Ceiling pocket	1	
Stair void gate (create bannister gate)		
Chase out walls for lift rails, breezeblocks (How many sides?)	0	
Removal of full height cupboards/ shelving, making good, Skip	0	
Full first floor brackets		
False ceiling brackets		
Fire proof shaft, plaster finish, FD30 fire door, with switched lock	0	
Re-route gas pipework	0	
Re-route water pipework	1	
Reposition radiator/ moving pipework	0	
Install Electrical Socket / Switched Spur for Lift Power Supply	1	
Moving light fitting or switch	2	
Upgrading earth bonding		
Installing /moving electrical socket (new RDC)		
Upgrading consumer box		
Re-route electrical cables	1	
Form a pit in a concrete floor		
Form a pit in a timber floor		
Moving an internal doorway & make good with skip	0	
Turning around internal door	0	
Strengthening timbers in ground floor		
Fitting new 30 minute fire door & frame with ironmongery	0	
Fitting new door & frame with ironmongery	0	
Plasterboard studwork & skimmed per square meter		
Architrave per set		
Skirting board per metre		
Cutting out internal doorway with lintel in blockwork		
Cutting out doorway internal door in studwork	0	
Building Notice		
Architect structural calculations (Compulsory Scotland)	1	
Remove stud wall between wc and bathroom	£600.00	

The above information has been explained to me and I agree to the lift specification and acknowledge what building works will be undertaken by Stiltz Ltd and what works are my responsibility to be completed prior to installation. Failure to complete building works prior to the installation date which causes an aborted installation will incur a £500 per day abort fee. All primary works undertaken by Stiltz will be left for the client to decorate. Client is aware to pay engineer on day of installation any balance due in full.

Customer signature <i>COV19</i>	Date 18-Jun-2020
---------------------------------	------------------

AIDS FOR DISABLED PERSONS, SUPPLIES TO INDIVIDUALS	
Name:	I Murray
House No/Street:	Balmoral Estate
Line 2:	Balmoral
Town:	Ballater
County:	Aberdeenshire
Postcode:	AB35 5TB

NAME OF SUPPLIER*	Stiltz Lifts, Building 5, Bay 1, First Avenue, Pensnett Estate, Kingswinford DY6 7TE, United Kingdom
--------------------------	---

a	The goods mentioned below, which are being supplied to me for domestic or my personal use.	<input checked="checked" type="checkbox"/>
b	Services of adapting, as described below, the goods mentioned to suit my condition.	<input type="checkbox"/>
c	Services of repair or maintenance of the goods mentioned below.	<input type="checkbox"/>

(Where applicable) The adaption consisting in:

Signature 	Date 18-Jun-2020
---	------------------

Photographs

Downstairs

1. Downstairs looking down at the footprint from in front of the lift entrance door



2. Looking up at the ceiling of the lower floor from in front of the lift – check for signs plaster and lathe



Downstairs (continued)

3. An aspect photo of the lift in relation to the room



4. Diagonal photo of the room showing 2 of 4 walls



Downstairs (continued)

5. Opposite diagonal photo of the room showing remaining 2 other walls of the room



Upstairs

6. Upstairs looking down at the footprint from in front of the lift entrance door



7. Looking up at the ceiling of the upper floor from in front of the lift – checking for a flat surface



Upstairs (continued)

8. An aspect photo of the lift in relation to the room



9. Diagonal photo of the room showing 2 of 4 walls



Upstairs (continued)

10. Opposite diagonal photo of the room showing remaining 2 other walls of the room



Photo of front of disability badge

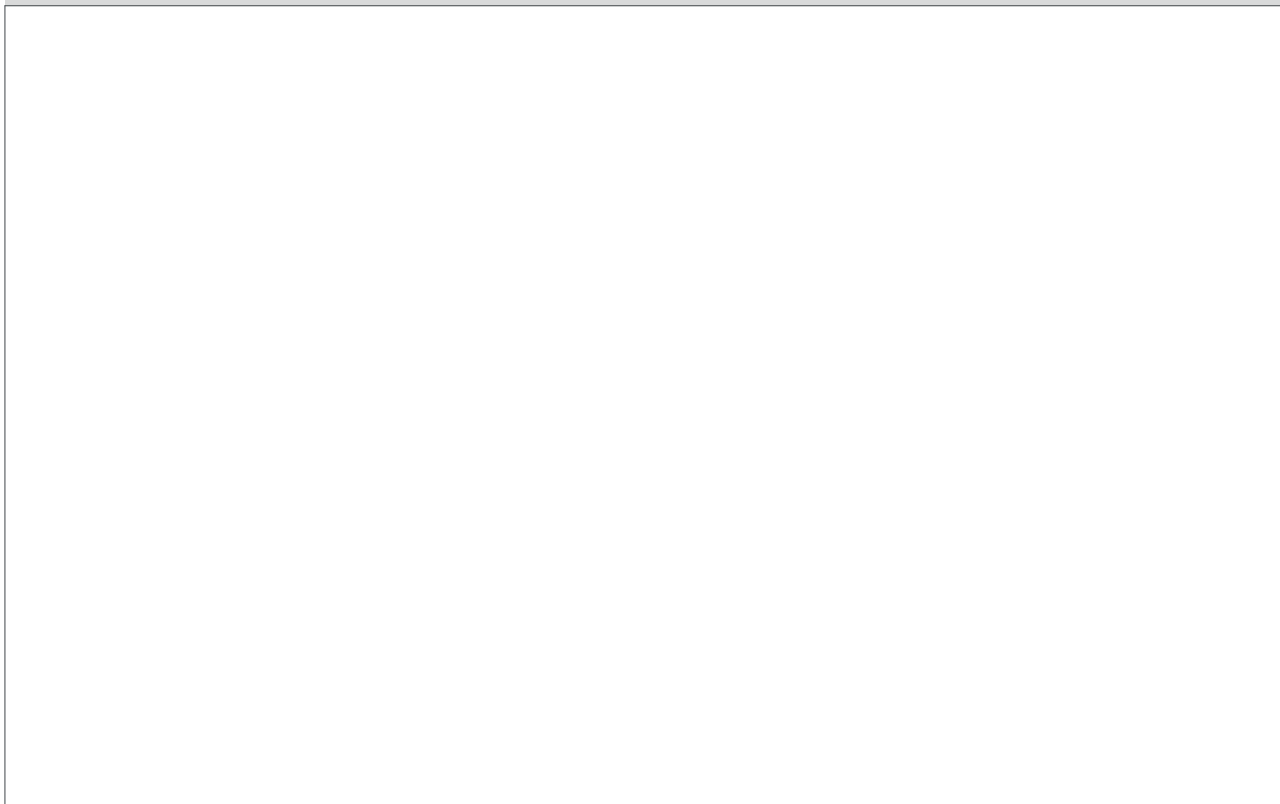

Photo of back of disability badge

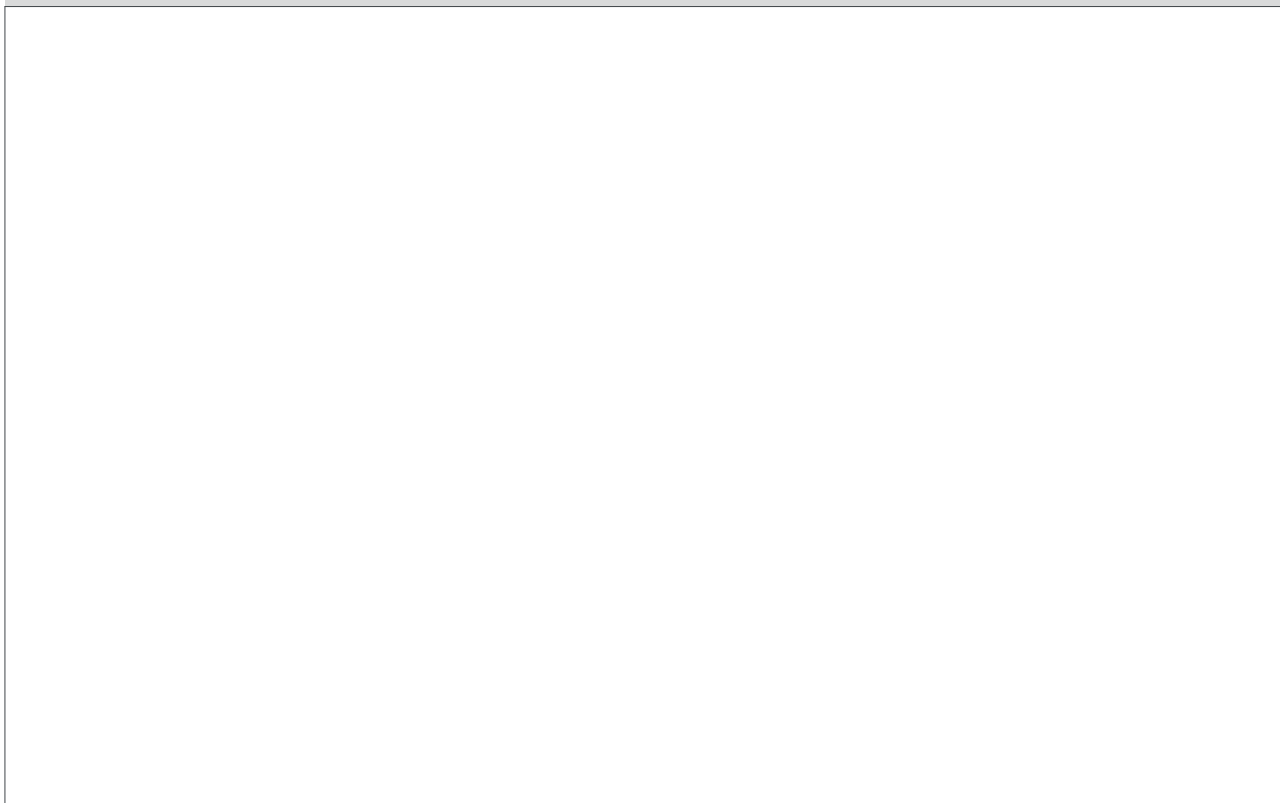

Photo of front of house



Photo of electrical fuse board



Photo of electrical incoming supply



Boiler location and type

Boiler room

Supporting photographs



Additional Information and Photographs

Additional Information

Estate manager
Alex the clerk of works
Ian Murray lift adviser all present on site

Additional pictures



Additional pictures (continued)



Additional pictures (continued)



Floor plans

Please attach a plan of each room or area upstairs and downstairs. Please show doorways and their swings, power socket locations, boiler location, light fittings and of course the lift. Any other crucial items too.

Upstairs / Downstairs

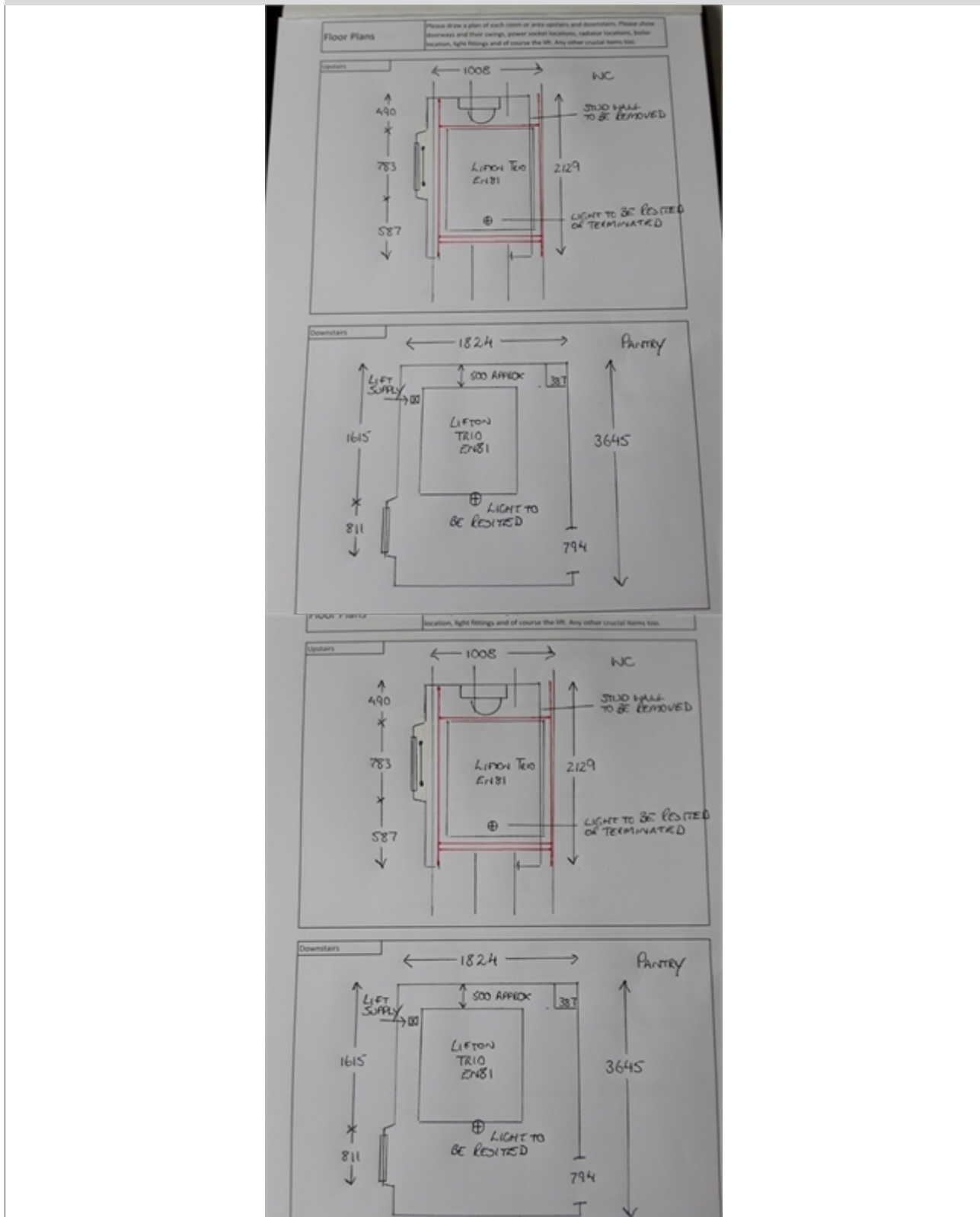

Upstairs ceiling

Please attach drawing of upstairs ceiling angle and orientation. Please show front and side on aspects, showing where both rails relate to the ceiling.

Front on / Side on

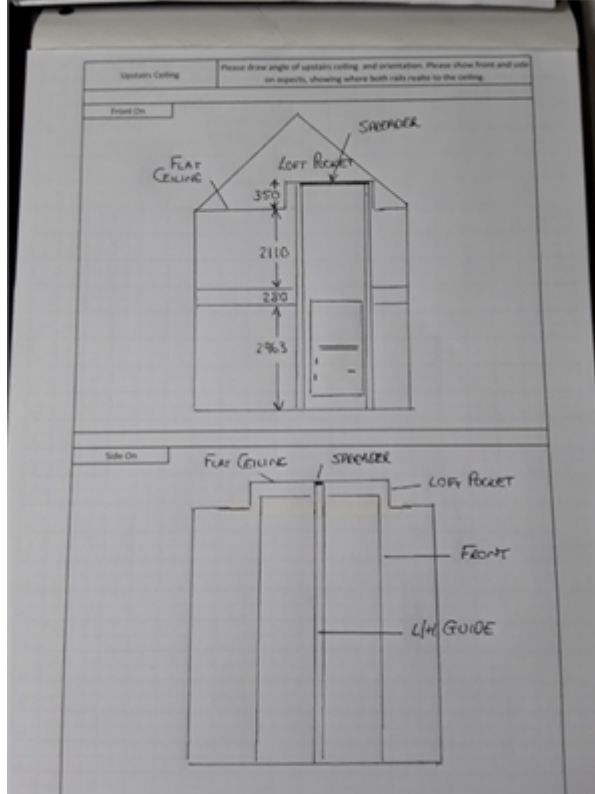
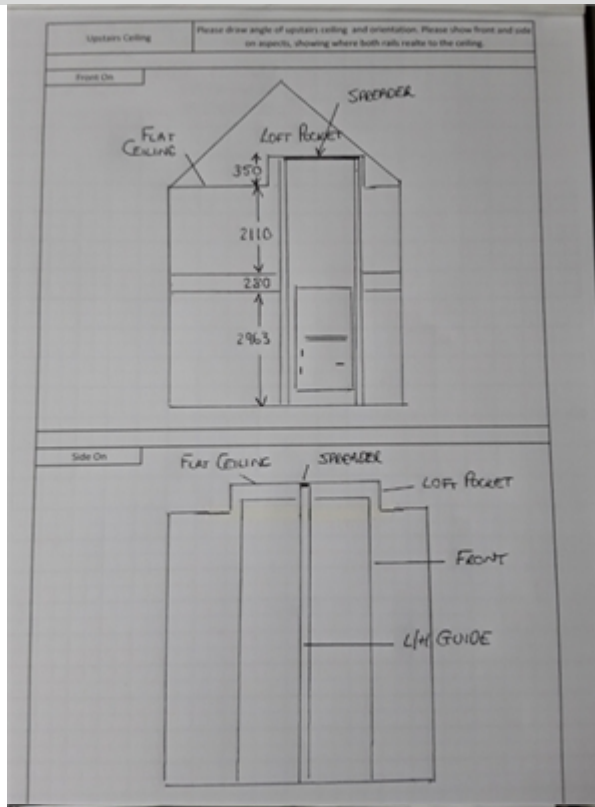

Flooring details

What are the joist centres of the floor upstairs? This can be determined by viewing the nails on the floor boards.	450 mm
What are the depth of the floor joists? This can be determined by the floor thickness.	230 mm
Are there pipes in the aperture area?	Yes <input checked="" type="checkbox"/> No <input type="checkbox"/>

Site access and installation

Site access and installation					
Parking available	Yes <input checked="" type="checkbox"/>	No <input type="checkbox"/>	Parking charges	Yes <input type="checkbox"/>	No <input checked="" type="checkbox"/>
Proximity to site	0m	<10m	<20m	<30m	>30m
	<input checked="" type="checkbox"/>	<input type="checkbox"/>	<input type="checkbox"/>	<input type="checkbox"/>	<input type="checkbox"/>

Additional site access details

Sat nav to exact location to front gate press intercom and ask for estate office and you will be escorted to site

Door widths	1st	2nd	3rd	4th	5th
710mm required	932 mm	836 mm	836 mm	mm	mm

Will assembled car stand up in downstairs room 2470mm required				Yes	<input checked="" type="checkbox"/>	No	<input type="checkbox"/>
WARNING – DUO CLASSIC CANNOT BE FLAT PACKED							
Can the assembled car navigate safely into position?				Yes	<input checked="" type="checkbox"/>	No	<input type="checkbox"/>
If not, assemble on site:	Partial Everything except back seat	<input type="checkbox"/>	Complete Reassembly of car	<input type="checkbox"/>			
Detail where lift can be built on site:							

Access path

Use space below to draw / describe access path if complex



Approved by Stiltz

Surveyor
William OHagan

Sign

WOH

Checked

Production Summary Sheet

Customer details	
Name:	Mr I Murray
Telephone:	0000
Mobile:	07771346650
Partners name:	
Email address:	ianlochnagar1@btinternet.com
Surveyor name:	William OHagan

Installation address	
House No/Street:	Balmoral Estate
Line 2:	Balmoral
Town:	Ballater
County:	Aberdeenshire
Postcode:	AB35 5TB
Contact person:	
Telephone:	

Supply phone to program into clients existing system: ☒

Supply phone and base station: ☐

Lift details				
Lift model:		Lifton Tri (Trio+) specific options		
Lifton Trio (Trio+)				
EN81 hoist unit required?	Yes <input checked="" type="checkbox"/>	No <input type="checkbox"/>	Entry/exit options:	Ramped entry front only
			Use controls (looking at lift)	Right hand side
			Door option:	Manual

Door swing (ground floor looking at front of lift): RH hinge - LH lock	
Lift colour finishes:	Custom RAL:
	Paint finish:

If colour finishes are different, please complete below:			
Rails:	Custom RAL:	Paint finish:	
Insert:	Custom RAL:	Paint finish:	
Lift Car:	Custom RAL:	Paint finish:	

Lift Interior:	If custom, please detail below:
Walls:	

Through car door options (only complete if through door)	
Front:	
Rear:	

Installation	
Void brackets required	<input type="checkbox"/>
Aperture insert required	<input checked="" type="checkbox"/>
Additional gate interlock kit(s) required	
Optional extras	
Seat: (Classic = Fold-Down, Lifton = Parch)	<input checked="" type="checkbox"/>
Ramp:	
UPS:	None
Handrails:	One
Door type:	Half Height

Ceiling height and travel		
Pit depth (if pit required)		mm
Ground floor to ceiling	2963	mm
Void thickness	280	mm
First floor to ceiling	2110	mm
Second floor void thickness		mm
Second floor to ceiling		mm
Ceiling recess depth (if required)	350	mm
Total travel	3243	mm
Total rail length	5703	mm

Extra rail section:	<input type="checkbox"/>
Extra gripper rod	<input type="checkbox"/>
Rope extension required:	<input type="checkbox"/>

Car to be cut down (Minimum ceiling height is 2370mm, cut down size 2270mm (100mm standard cut down)) Yes ☐ No ☒

Non standard cut down details:

Can the assembled car navigate safely into position?			
If not, assemble on site:	Partial Everything except back seat	<input type="checkbox"/>	Complete Reassembly of car
		<input type="checkbox"/>	