

nominal 400mm thick long straw thatch, 2 courses, minimum 200mm wearing course above fixings, treated to achieve Class A rating for spread of flame. Refer photos of existing to replicate similar details.

Principal trusses*:
250dp x 150mm D30 oak rafters, trenched into wall plate
150dp x 150mm D30 oak upper collar
225dp x 150mm D30 oak lower collar

Purlins*:
150dp x 100mm D30 oak purlins, maximum 2100mm centres

Common Rafters*:
125dp x 38mm C16 softwood rafters, 400mm centres

Binders*:
170dp x 47mm D30 oak binders, 1500mm centres

Intermediate ceiling joists*:
97dp x 38mm C16 softwood joists, 400mm centres

20mm Thatchsafe o/s fire resistant barrier, 100mm overlaps

12.5mm plasterboard + skim to u/s s/w joists between oak beams

50x25mm treated sw battens

19mm softwood floorboards

Intermediate floor joists*:
120dp x 44mm C24 s/w joists, 400mm centres

12.5mm plasterboard + skim to u/s s/w joists between oak beams

Primary cross beams*:
ex 300x300mm oak beam

20mm Limelite lime based 2-part renovating plaster

Existing concrete floor

B PLAN SECTION
HOUSE Scale 1:75

Purlins*:
150dp x 100mm D30 oak purlins, maximum 2100mm centres

Ridge beam*:
350dp x 50mm D30 oak ridge beam

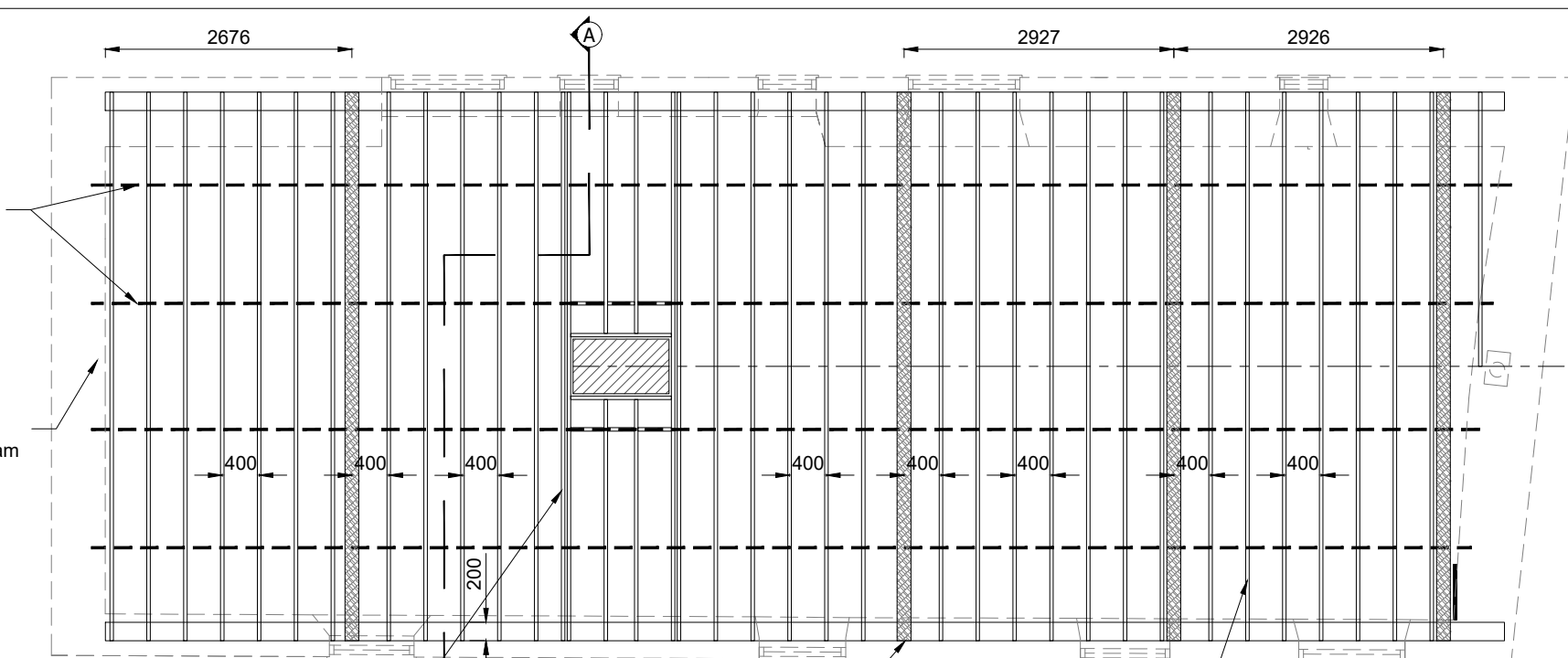

Softwood trusses doubled up either side of chimney stack

Principal trusses*:
250dp x 150mm D30 oak rafters
150dp x 150mm D30 oak upper collar
225dp x 150mm D30 oak lower collar

Common Rafters*:
125dp x 38mm C16 softwood rafters, 400mm centres

Wall plate*:
150dp x 200mm D30 oak wall plates to full length of building (in minimum 3m lengths), half-overlapped joints, bedded on mortar

proprietary vent to give min 5mm continuous ventilation

50-135mm firrings on top of joists to achieve approx 1in40 fall. Leave gaps between firrings to allow for min 50mm cross ventilation

box gutter along front edge to side downpipes discharging to soakaways

proprietary vent to give min 10mm continuous ventilation

Roof joists*:
170dp x 63mm C24 softwood rafters, 400mm centres, insulation between

12.5mm foil backed plasterboard + skim to u/s joists

***NB
ROOF SUPPORT STRUCTURE
TO SPECIALIST DESIGN.
ALL SECTIONAL SIZES AND
DETAILS
TO BE ADVISED BY
STRUCTURAL ENGINEER**

A VERTICAL SECTION
Scale 1:50

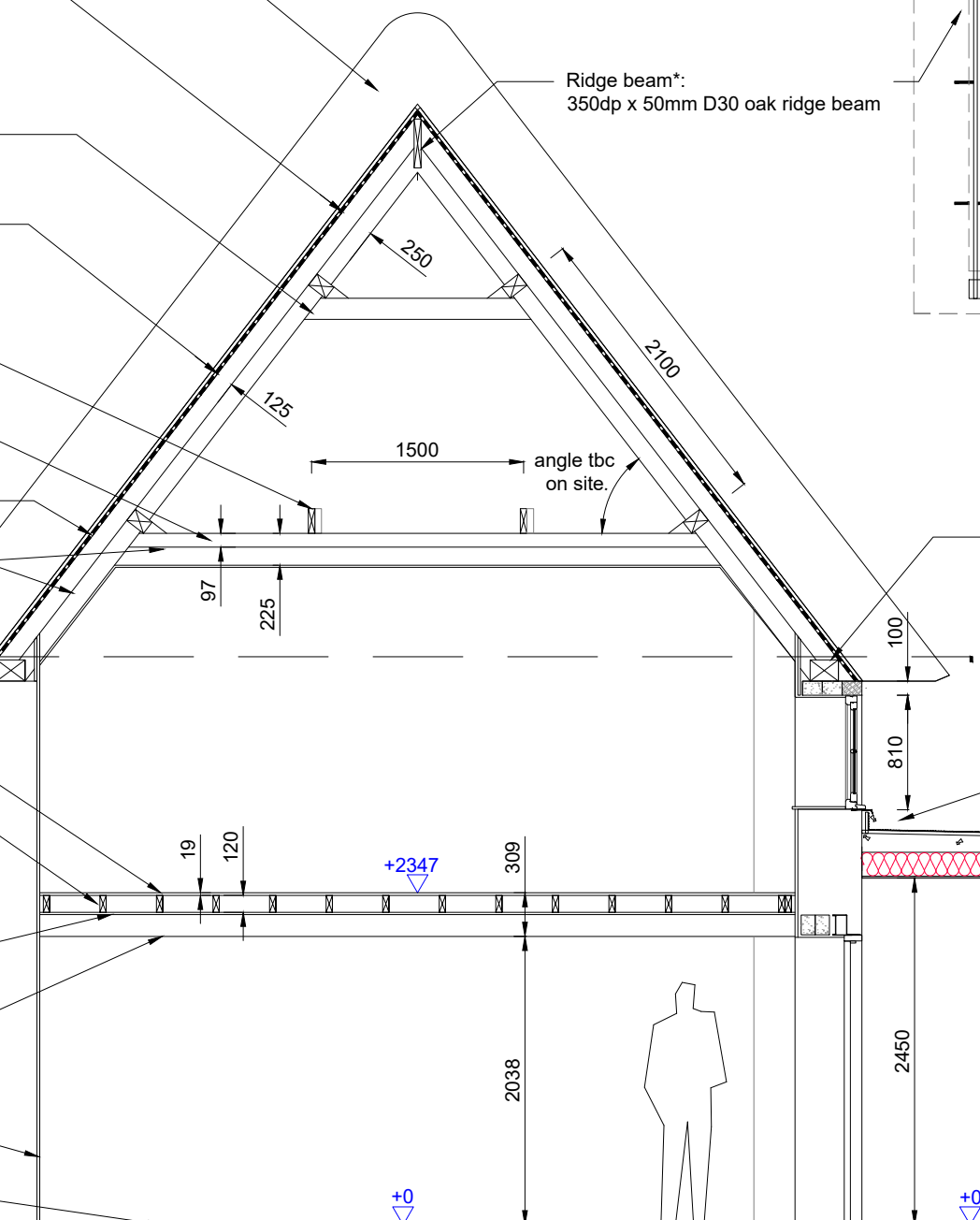

 07739 570265 alisonlamont@aol.com 11 Gorse Close Rugby CV22 6SH	CLIENT	T JANSON-CADDEL & M JAMIESON				REVISIONS	A GENERALLY AMENDED 31/01/2021 This drawing is the property of ALISON LAMONT DESIGN LTD & should not be reproduced in any format without written permission Written dimensions only should be used DO NOT SCALE		
	TITLE	1-2 SUDBOROUGH ROAD, SLIPTON NN14 3AQ PROPOSED RECONSTRUCTION PROPOSED SECTION A & HOUSE ROOF PLAN (P/LBC)							
	DRG. NO.	201002-301	REV.	-	DATE	03/02/21		SCALE	1:50@A3