

GF GROUND FLOOR PLAN
 PROPOSED Scale 1:100

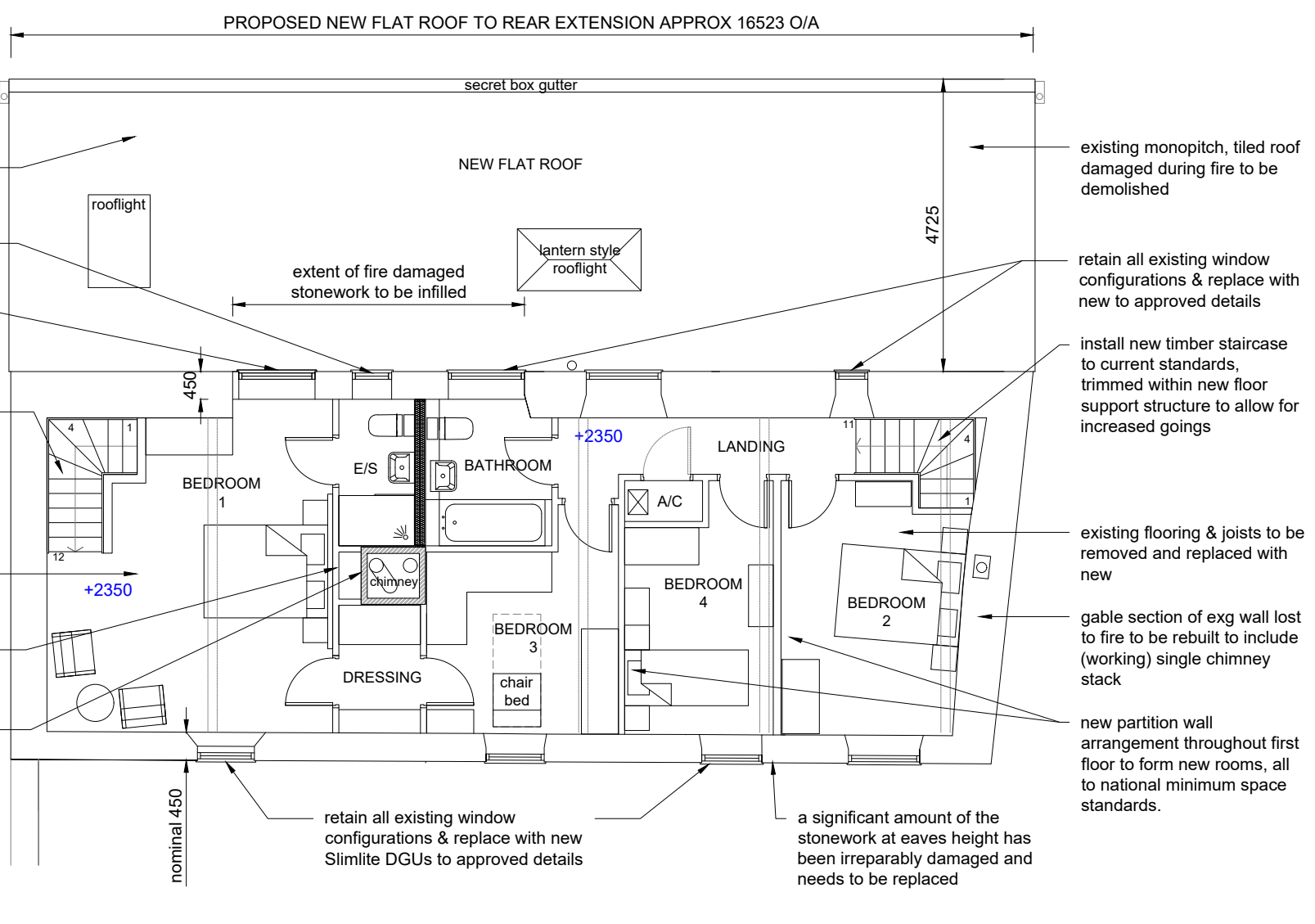

1F FIRST FLOOR PLAN
 PROPOSED Scale 1:100

REPLACEMENT WORKS
 • REFER TO PLANNING APPLICATIONS REF 20/00337/FUL & 20/00338/LBC FOR SPECIALIST STRUCTURAL REPORTS DATED 18 OCTOBER 2018 & 22 JUNE 2020
 • PRIOR TO WORKS COMMENCING ON SITE A PROGRAMME OF ARCHAEOLOGICAL WORK IS TO BE PROVIDED TOGETHER WITH A WRITTEN SCHEME OF INVESTIGATION

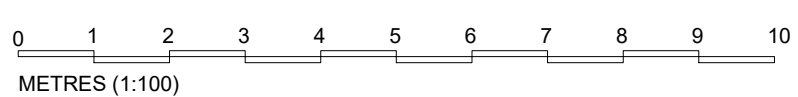
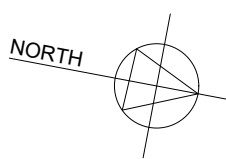

 alisonlamont@aol.com 11 Gorse Close Rugby CV22 6SH	CLIENT T JANSON-CADDEL & M JAMIESON		REVISIONS A DIMENSIONS ADDED 12/02/2021		This drawing is the property of ALISON LAMONT DESIGN LTD & should not be reproduced in any format without written permission Written dimensions only should be used DO NOT SCALE
	TITLE 1-2 SUDBOROUGH ROAD, SLIPTON NN14 3AQ PROPOSED RECONSTRUCTION PROPOSED GF & 1F PLANS (PLANNING/LBC)				
DRG. NO. 201002-103	REV. A	DATE 05/02/21	SCALE 1:100@A3	DRAWN AJL	