

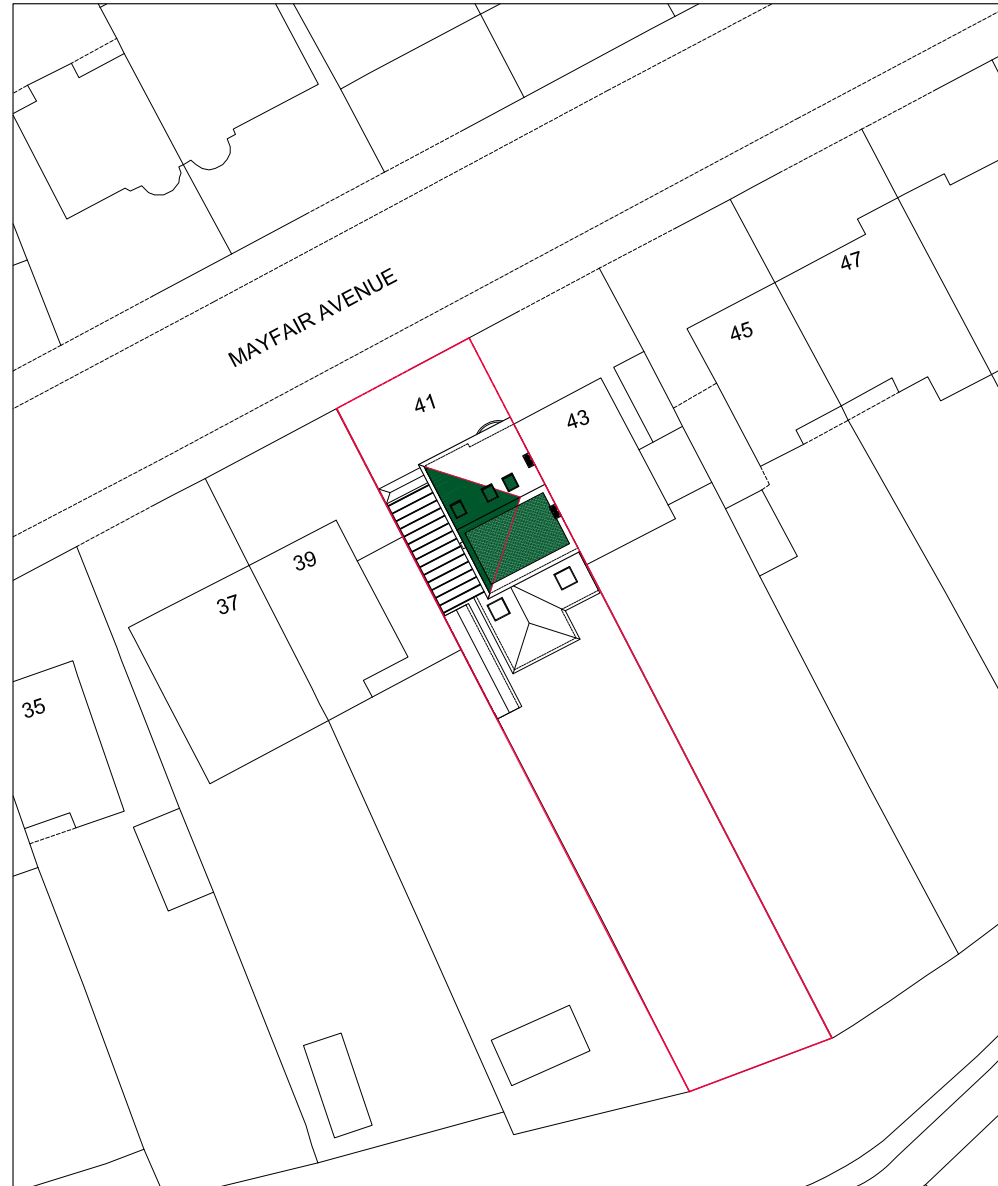

Site Plan 1:500



Copyright © Studio 136 Ltd.

This drawing which is the property of Studio 136 Ltd is the subject of Intellectual Property Rights including copyright and design right and shall not be reproduced, copied, loaned or submitted to any other party without the written consent of Studio 136 Ltd.

Any discrepancies to be reported to Studio 136 Ltd prior to setting out or starting of any materials.

This drawing is prepared solely for design and planning submission purposes. It is not intended or suitable for other Building Regulations or Construction purposes and should not be used for such.



HP TO GABLE REAR DORMER LOFT CONVERSION AT
41 MAYFAIR AVENUE
WORCESTER PARK
KINGSTON
KT4 7SH

Client:

Ms Tanya Havard-Kuehn
41 MAYFAIR AVENUE
WORCESTER PARK
KINGSTON
KT4 7SH

Drawn by: 136
SITE AND LOCATION PLAN

Scale	Drawn	Checked	Authorised
1:1250, 1:500@04		--	--
	11th February 2021	--	--

Drawing Number	Rev
CL_20_41MAYFAIR_CoL_00	--

Note:
Green hatched area indicates
the proposed development.

