

Existing Section A-A _ Scale 1:50 @ A2

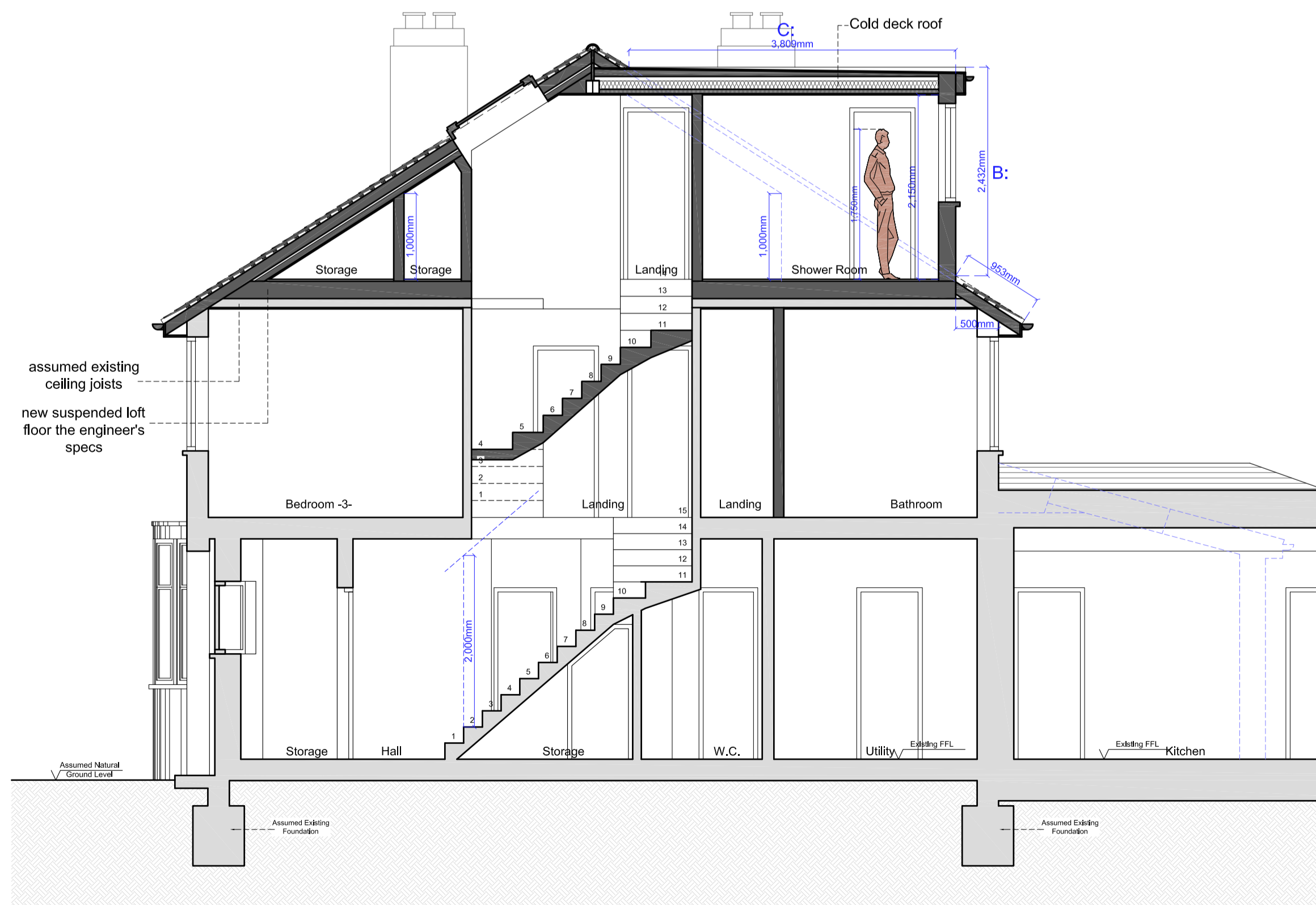

EXISTING SECTION A-A

Proposed Section A-A _ Scale 1:50 @ A2



PROPOSED SECTION A-A

Copyright © Studio136 Ltd

This drawing which is the property of Studio 136 Ltd is the subject of Intellectual Property Rights including copyright and design right and shall not be reproduced, copied, loaned or submitted to any other party without the written consent of Studio 136 Ltd.

Any discrepancies to be reported to Studio 136 Ltd prior to setting out or ordering of any materials.

This drawing is prepared solely for design and planning submission purposes. It is not intended or suitable for either Building Regulations or Construction purposes and should not be used for such.

Notes:

PD Guidelines:

- All new materials to match existing.
- All new side windows to be obscure-glazed and fixed shut up to 1.7m above internal floor level.
- All roof lights placed on the existing roof slope should not project by more than 150mm.
- All roof lights placed on the extended part of the roof should flush within the roof slope.
- No part of the proposed development should be higher than the original ridge level.

Proposed staircase is shown as a guide. Exact layout and dimensions is to be confirmed by the staircase company and the Building Control on site.

New casement window sizes to be confirmed with client on site.

Plans may change after Contract is Signed subject to Final Design and Specific Structural Engineer Specifications.

The Contractor should check all dimensions on site prior to ordering materials or fitting any steel beams/timber joists.

Exact position and size of all chimney stacks/breasts to be confirmed on site prior to ordering materials. In case the proposed structure is affected, the Contractor should seek report back to the Engineer or Architect.

General Notes on Layout and Furniture:

Please note furniture, beds, kitchens and cupboard shown are for illustration purposes only and are Not Included in the Contract UNLESS PREVIOUSLY AGREED and/or OTHERWISE SPECIFIED on plans.

0 1m 2m 3m 4m 5m

Scale Bar @1:100

0 1m 2m 3m

Scale Bar @1:50



Project

TWO STOREY EXTENSION AND LOFT CONVERSION AT
41 MAYFAIR AVENUE
WORCESTER PARK
KINGSTON
KT4 7SH

Client

Ms Tania Hawlin-Kushn
41 MAYFAIR AVENUE
WORCESTER PARK
KINGSTON
KT4 7SH

Drawing Title
HIP TO GABLE REAR DORMER LOFT CONVERSION AT

Scale	Drawn	Checked	Authorised
1:50@A2		-	-
	11th February 2021	-	-

Drawing Number	Rev
CL_20_41MAYFAIR_CoL_05	B