

Yorkshire

Published 1854

Source map scale - 1:10,560

The historical maps shown were reproduced from maps predominantly held at the scale adopted for England, Wales and Scotland in the 1840 s. In 1854 the 1:2,500 scale was adopted for mapping urban areas; these maps were used to update the 1:10,560 maps. The published date given therefore is often some years later than the surveyed date. Before 1938, all OS maps were based on the Cassini Projection, with independent surveys of a single county or group of counties, giving rise to significant inaccuracies in outlying areas. In the late 1940 s, a Provisional Edition was produced, which updated the 1:10,560 mapping from a number of sources. The maps appear unfinished - with all military camps and other strategic sites removed. These maps were initially overprinted with the National Grid. In 1970, the first 1:10,000 maps were produced using the Transverse Mercator Projection. The revision process continued until recently, with new editions appearing every 10 years or so for urban areas.

Map Name(s) and Date(s)

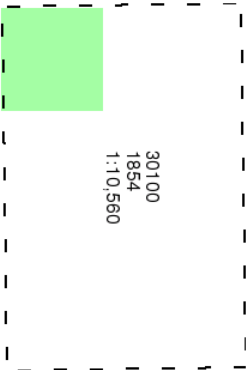

Historical Map - Slice A

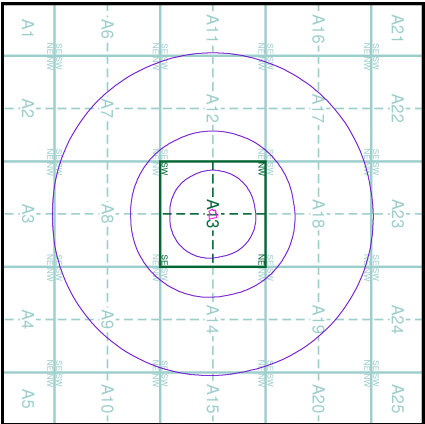

Order Details

Order Number: 268169345\_1\_1  
Customer Ref: 100525  
National Grid Reference: 458370, 378900  
Slice: A  
Site Area (Ha): 0.24  
Search Buffer (m): 1000

Site Details

15-17 Newcastle Avenue, Worksep, S80 1EY



Nottinghamshire

Published 1885 - 1886

Source map scale - 1:10,560

The historical maps shown were reproduced from maps predominantly held at the scale adopted for England, Wales and Scotland in the 1840 s. In 1854 the 1:2,500 scale was adopted for mapping urban areas; these maps were used to update the 1:10,560 maps. The published date given therefore is often some years later than the surveyed date. Before 1938, all OS maps were based on the Cassini Projection, with independent surveys of a single county or group of counties, giving rise to significant inaccuracies in outlying areas. In the late 1940 s, a Provisional Edition was produced, which updated the 1:10,560 mapping from a number of sources. The maps appear unfinished - with all military camps and other strategic sites removed. These maps were initially overprinted with the National Grid. In 1970, the first 1:10,000 maps were produced using the Transverse Mercator Projection. The revision process continued until recently, with new editions appearing every 10 years or so for urban areas.

Map Name(s) and Date(s)

008SW 1885 1:10,560	008SE 1885 1:10,560
013NW 1885 1:10,560	013NE 1886 1:10,560

Historical Map - Slice A

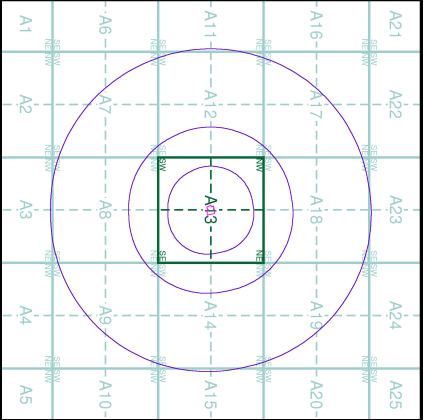

Order Details

Order Number: 268169345\_1\_1  
Customer Ref: 100525  
National Grid Reference: 458370, 378900

Slice: A  
Site Area (Ha): 0.24  
Search Buffer (m): 1000

Site Details

15-17 Newcastle Avenue, Worksp, S80 1EY



Nottinghamshire

Published 1899 - 1900

Source map scale - 1:10,560

The historical maps shown were reproduced from maps predominantly held at the scale adopted for England, Wales and Scotland in the 1840's. In 1854 the 1:2,500 scale was adopted for mapping urban areas; these maps were used to update the 1:10,560 maps. The published date given therefore is often some years later than the surveyed date. Before 1938, all OS maps were based on the Cassini Projection, with independent surveys of a single county or group of counties, giving rise to significant inaccuracies in outlying areas. In the late 1940's, a Provisional Edition was produced, which updated the 1:10,560 mapping from a number of sources. The maps appear unfinished - with all military camps and other strategic sites removed. These maps were initially overprinted with the National Grid. In 1970, the first 1:10,000 maps were produced using the Transverse Mercator Projection. The revision process continued until recently, with new editions appearing every 10 years or so for urban areas.

Map Name(s) and Date(s)

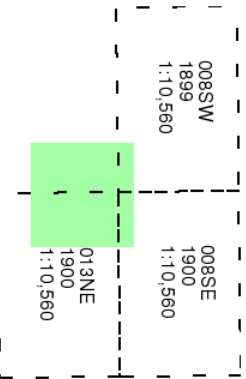

Historical Map - Slice A

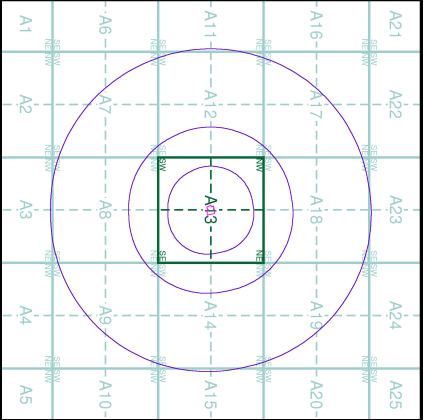

Order Details

Order Number: 268169345\_1\_1  
Customer Ref: 100525  
National Grid Reference: 458370, 378900  
Slice: A  
Site Area (Ha): 0.24  
Search Buffer (m): 1000  
Site Details  
15-17 Newcastle Avenue, Worksop, S80 1EY

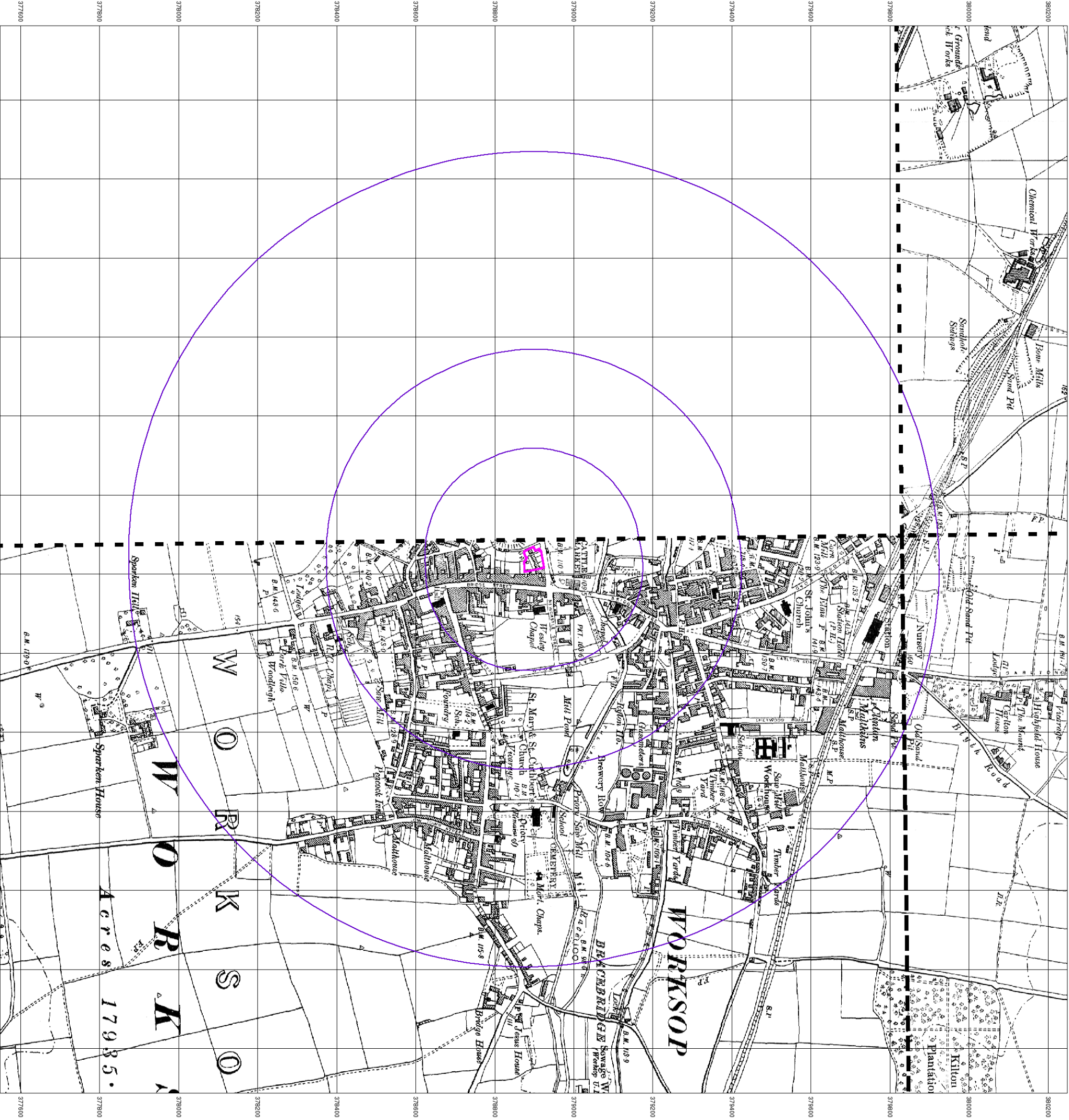



Derbyshire

Published 1899

Source map scale - 1:10,560

The historical maps shown were reproduced from maps predominantly held at the scale adopted for England, Wales and Scotland in the 1840 s. In 1854 the 1:2,500 scale was adopted for mapping urban areas; these maps were used to update the 1:10,560 maps. The published date given therefore is often some years later than the surveyed date. Before 1938, all OS maps were based on the Cassini Projection, with independent surveys of a single county or group of counties, giving rise to significant inaccuracies in outlying areas. In the late 1940 s, a Provisional Edition was produced, which updated the 1:10,560 mapping from a number of sources. The maps appear unfinished - with all military camps and other strategic sites removed. These maps were initially overprinted with the National Grid. In 1970, the first 1:10,000 maps were produced using the Transverse Mercator Projection. The revision process continued until recently, with new editions appearing every 10 years or so for urban areas.

Map Name(s) and Date(s)

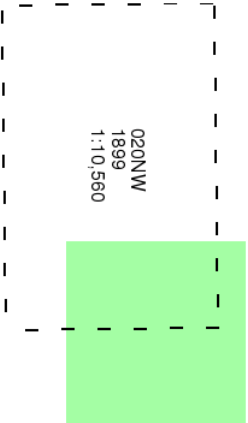

Historical Map - Slice A

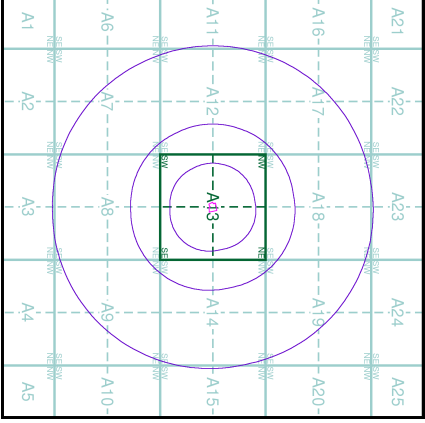

Order Details

Order Number: 268169345\_1\_1  
Customer Ref: 100525  
National Grid Reference: 458370, 378900  
Slice: A  
Site Area (Ha): 0.24  
Search Buffer (m): 1000

Site Details

15-17 Newcastle Avenue, Worksep, S80 1EY



**Derbyshire**

**Published 1922**

**Source map scale - 1:10,560**

The historical maps shown were reproduced from maps predominantly held at the scale adopted for England, Wales and Scotland in the 1840 s. In 1854 the 1:2,500 scale was adopted for mapping urban areas; these maps were used to update the 1:10,560 maps. The published date given therefore is often some years later than the surveyed date. Before 1938, all OS maps were based on the Cassini Projection, with independent surveys of a single county or group of counties, giving rise to significant inaccuracies in outlying areas. In the late 1940 s, a Provisional Edition was produced, which updated the 1:10,560 mapping from a number of sources. The maps appear unfinished - with all military camps and other strategic sites removed. These maps were initially overprinted with the National Grid. In 1970, the first 1:10,000 maps were produced using the Transverse Mercator Projection. The revision process continued until recently, with new editions appearing every 10 years or so for urban areas.

**Map Name(s) and Date(s)**

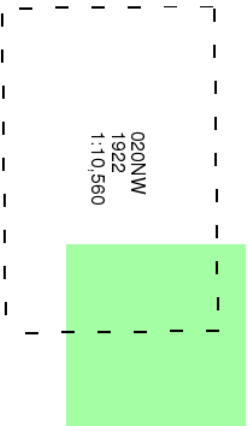

**Historical Map - Slice A**

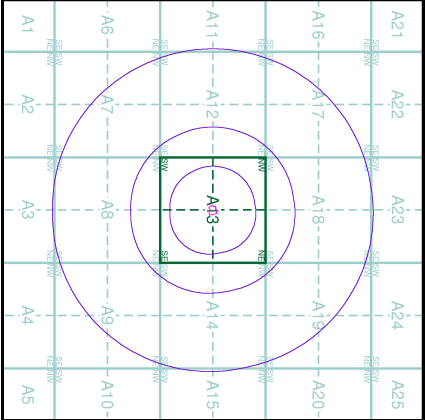

**Order Details**

Order Number: 268169345\_1\_1  
Customer Ref: 100525  
National Grid Reference: 458370, 378900  
Slice: A  
Site Area (Ha): 0.24  
Search Buffer (m): 1000

**Site Details**

15-17 Newcastle Avenue, Worksop, S80 1EY



The historical maps shown were reproduced from maps predominantly held at the scale adopted for England, Wales and Scotland in the 1840 s. In 1854 the 1:2,500 scale was adopted for mapping urban areas; these maps were used to update the 1:10,560 maps. The published date given therefore is often some years later than the surveyed date. Before 1938, all OS maps were based on the Cassini Projection, with independent surveys of a single county or group of counties, giving rise to significant inaccuracies in outlying areas. In the late 1940 s, a Provisional Edition was produced, which updated the 1:10,560 mapping from a number of sources. The maps appear unfinished - with all military camps and other strategic sites removed. These maps were initially overprinted with the National Grid. In 1970, the first 1:10,000 maps were produced using the Transverse Mercator Projection. The revision process continued until recently, with new editions appearing every 10 years or so for urban areas.

Map Name(s) and Date(s)

008SW 1923 1:10,560	008SE 1923 1:10,560
013NE 1922 1:10,560	

Historical Map - Slice A

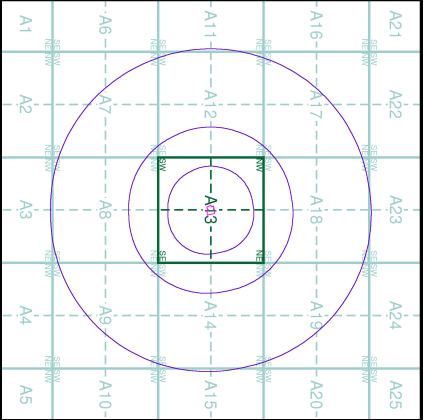

Order Details

Order Number: 268169345\_1\_1  
Customer Ref: 100525  
National Grid Reference: 458370, 378900  
Slice: A  
Site Area (Ha): 0.24  
Search Buffer (m): 1000

Site Details

15-17 Newcastle Avenue, Worksop, S80 1EY



Derbyshire

Published 1938

Source map scale - 1:10,560

The historical maps shown were reproduced from maps predominantly held at the scale adopted for England, Wales and Scotland in the 1840 s. In 1854 the 1:2,500 scale was adopted for mapping urban areas; these maps were used to update the 1:10,560 maps. The published date given therefore is often some years later than the surveyed date. Before 1938, all OS maps were based on the Cassini Projection, with independent surveys of a single county or group of counties, giving rise to significant inaccuracies in outlying areas. In the late 1940 s, a Provisional Edition was produced, which updated the 1:10,560 mapping from a number of sources. The maps appear unfinished - with all military camps and other strategic sites removed. These maps were initially overprinted with the National Grid. In 1970, the first 1:10,000 maps were produced using the Transverse Mercator Projection. The revision process continued until recently, with new editions appearing every 10 years or so for urban areas.

Map Name(s) and Date(s)

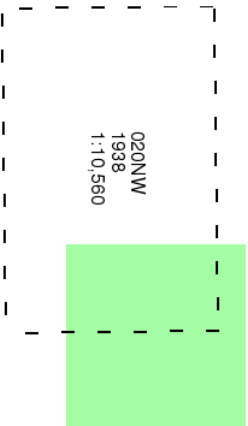

Historical Map - Slice A

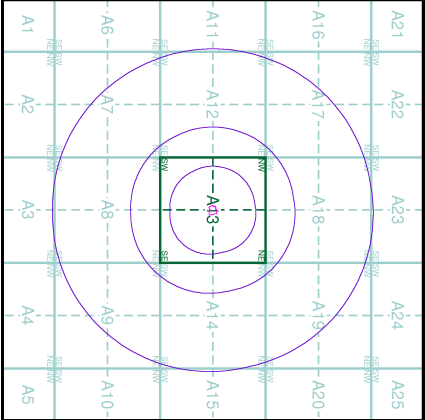

Order Details

Order Number: 268169345\_1\_1  
Customer Ref: 100525  
National Grid Reference: 458370, 378900  
Slice: A  
Site Area (Ha): 0.24  
Search Buffer (m): 1000

Site Details

15-17 Newcastle Avenue, Worksop, S80 1EY



The historical maps shown were reproduced from maps predominantly held at the scale adopted for England, Wales and Scotland in the 1840 s. In 1854 the 1:2,500 scale was adopted for mapping urban areas; these maps were used to update the 1:10,560 maps. The published date given therefore is often some years later than the surveyed date. Before 1938, all OS maps were based on the Cassini Projection, with independent surveys of a single county or group of counties, giving rise to significant inaccuracies in outlying areas. In the late 1940 s, a Provisional Edition was produced, which updated the 1:10,560 mapping from a number of sources. The maps appear unfinished - with all military camps and other strategic sites removed. These maps were initially overprinted with the National Grid. In 1970, the first 1:10,000 maps were produced using the Transverse Mercator Projection. The revision process continued until recently, with new editions appearing every 10 years or so for urban areas.

Map Name(s) and Date(s)

008SW 1938 1:10,560	008SE 1938 1:10,560
013NE 1938 1:10,560	

Historical Map - Slice A

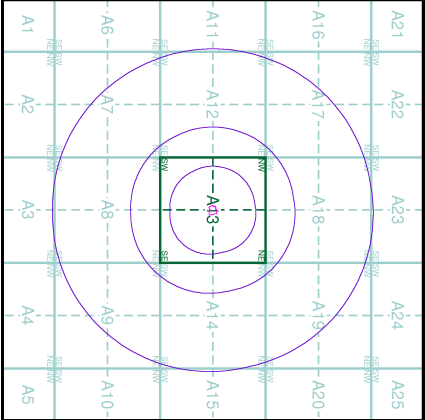

Order Details

Order Number: 268169345\_1\_1  
Customer Ref: 100525  
National Grid Reference: 458370, 378900  
Slice: A  
Site Area (Ha): 0.24  
Search Buffer (m): 1000  
Site Details  
15-17 Newcastle Avenue, Worksp, S80 1EY



Nottinghamshire

Published 1947 - 1950

Source map scale - 1:10,560

The historical maps shown were reproduced from maps predominantly held at the scale adopted for England, Wales and Scotland in the 1840 s. In 1854 the 1:2,500 scale was adopted for mapping urban areas; these maps were used to update the 1:10,560 maps. The published date given therefore is often some years later than the surveyed date. Before 1938, all OS maps were based on the Cassini Projection, with independent surveys of a single county or group of counties, giving rise to significant inaccuracies in outlying areas. In the late 1940 s, a Provisional Edition was produced, which updated the 1:10,560 mapping from a number of sources. The maps appear unfinished - with all military camps and other strategic sites removed. These maps were initially overprinted with the National Grid. In 1970, the first 1:10,000 maps were produced using the Transverse Mercator Projection. The revision process continued until recently, with new editions appearing every 10 years or so for urban areas.

Map Name(s) and Date(s)

008SW 1950 1:10,560	008SE 1950 1:10,560
013NE 1947 1:10,560	

Historical Map - Slice A

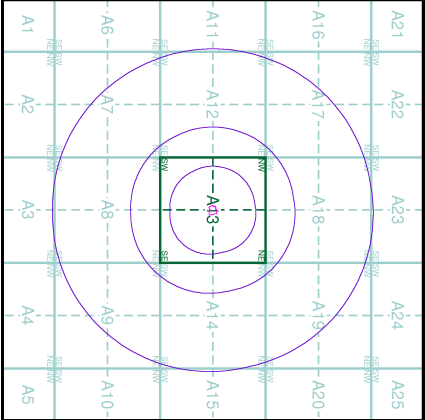

Order Details

Order Number: 268169345\_1\_1  
Customer Ref: 100525  
National Grid Reference: 458370, 378900

Slice: A  
Site Area (Ha): 0.24  
Search Buffer (m): 1000

Site Details

15-17 Newcastle Avenue, Worksp, S80 1EY



Derbyshire

Published 1950

Source map scale - 1:10,560

The historical maps shown were reproduced from maps predominantly held at the scale adopted for England, Wales and Scotland in the 1840 s. In 1854 the 1:2,500 scale was adopted for mapping urban areas; these maps were used to update the 1:10,560 maps. The published date given therefore is often some years later than the surveyed date. Before 1938, all OS maps were based on the Cassini Projection, with independent surveys of a single county or group of counties, giving rise to significant inaccuracies in outlying areas. In the late 1940 s, a Provisional Edition was produced, which updated the 1:10,560 mapping from a number of sources. The maps appear unfinished - with all military camps and other strategic sites removed. These maps were initially overprinted with the National Grid. In 1970, the first 1:10,000 maps were produced using the Transverse Mercator Projection. The revision process continued until recently, with new editions appearing every 10 years or so for urban areas.

Map Name(s) and Date(s)

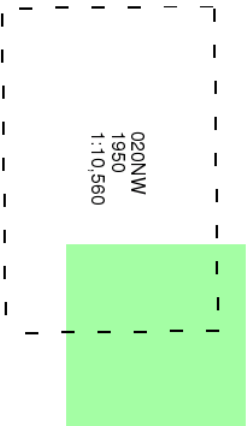

Historical Map - Slice A

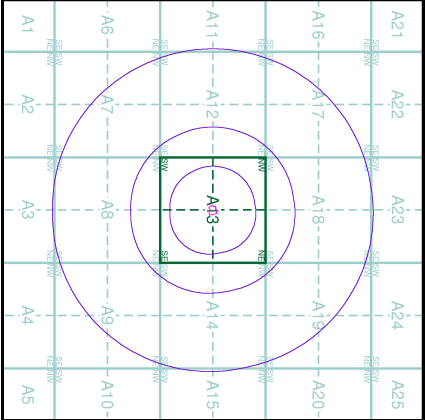

Order Details

Order Number: 268169345\_1\_1  
Customer Ref: 100525  
National Grid Reference: 458370, 378900  
Slice: A  
Site Area (Ha): 0.24  
Search Buffer (m): 1000

Site Details

15-17 Newcastle Avenue, Worksop, S80 1EY



Ordnance Survey Plan

Published 1956

Source map scale - 1:10,000

The historical maps shown were reproduced from maps predominantly held at the scale adopted for England, Wales and Scotland in the 1840 s. In 1854 the 1:2,500 scale was adopted for mapping urban areas; these maps were used to update the 1:10,560 maps. The published date given therefore is often some years later than the surveyed date. Before 1938, all OS maps were based on the Cassini Projection, with independent surveys of a single county or group of counties, giving rise to significant inaccuracies in outlying areas. In the late 1940 s, a Provisional Edition was produced, which updated the 1:10,560 mapping from a number of sources. The maps appear unfinished - with all military camps and other strategic sites removed. These maps were initially overprinted with the National Grid. In 1970, the first 1:10,000 maps were produced using the Transverse Mercator Projection. The revision process continued until recently, with new editions appearing every 10 years or so for urban areas.

Map Name(s) and Date(s)

- SK58SE 1956 1:10,560
- SK57NE 1956 1:10,560

Historical Map - Slice A

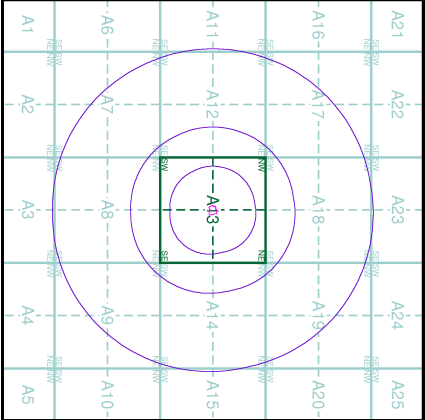

Order Details

Order Number: 268169345\_1\_1  
Customer Ref: 100525  
National Grid Reference: 456370, 378900

Slice: A  
Site Area (Ha): 0.24  
Search Buffer (m): 1000

Site Details

15-17 Newcastle Avenue, Workso, S80 1EY



Ordnance Survey Plan

Published 1967 - 1968

Source map scale - 1:10,000

The historical maps shown were reproduced from maps predominantly held at the scale adopted for England, Wales and Scotland in the 1840 s. In 1854 the 1:2,500 scale was adopted for mapping urban areas; these maps were used to update the 1:10,560 maps. The published date given therefore is often some years later than the surveyed date. Before 1938, all OS maps were based on the Cassini Projection, with independent surveys of a single county or group of counties, giving rise to significant inaccuracies in outlying areas. In the late 1940 s, a Provisional Edition was produced, which updated the 1:10,560 mapping from a number of sources. The maps appear unfinished - with all military camps and other strategic sites removed. These maps were initially overprinted with the National Grid. In 1970, the first 1:10,000 maps were produced using the Transverse Mercator Projection. The revision process continued until recently, with new editions appearing every 10 years or so for urban areas.

Map Name(s) and Date(s)

SK58SE	1968
1:10,560	
SK57NE	1967
1:10,560	

Historical Map - Slice A

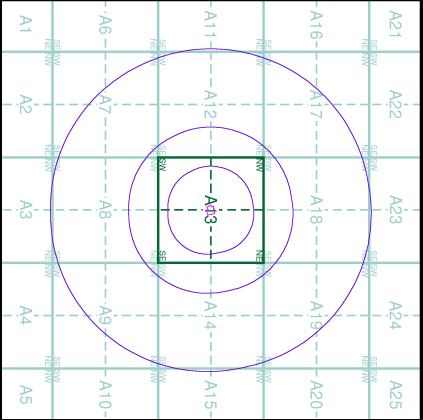

Order Details

Order Number: 268169345\_1\_1  
Customer Ref: 100525  
National Grid Reference: 458370, 378900

Slice: A  
Site Area (Ha): 0.24  
Search Buffer (m): 1000

Site Details

15-17 Newcastle Avenue, Worksop, S80 1EY