

a: design development. date: 24.04.18

b: alternative garden explored. date: 25.05.18

c: lightwell revised. date: 25.06.18

d: planting revised, charge point &amp; heat pump added. date: 15.02.21

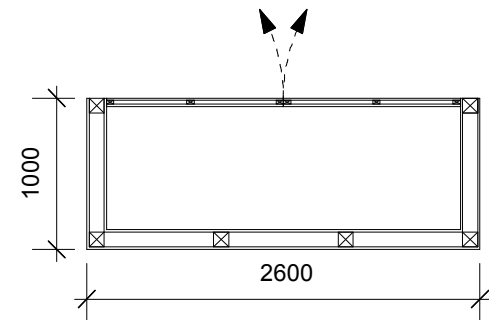

bin store constructed in oak posts with 'hit & miss' planks

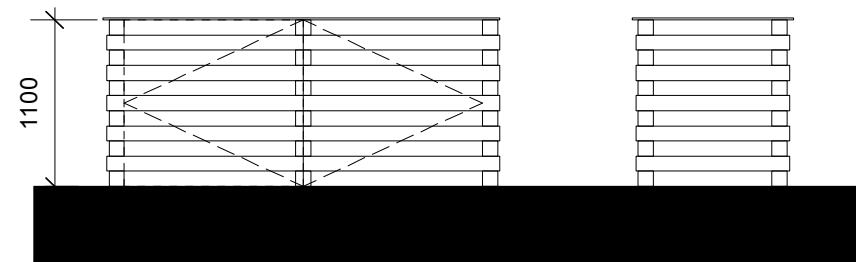

bin store for 2N° wheelie bins (1:50)

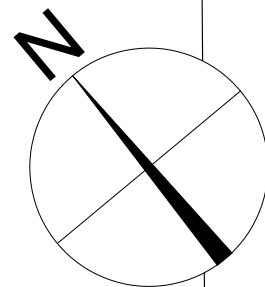

**Policy H17 – Residential Development – Privacy Standards**  
In new residential development there should be a minimum distance of 21 metres between properties with facing windows to habitable rooms to avoid overlooking, and 10.5 metres to a neighbouring garden. This distance should be increased by three metres for each additional storey over two storeys.

**Policy H18 – Residential Development – Amenity Space Standards**  
In new residential schemes, the minimum provision of gardens or amenity space should be at the following standards:

- For Flats:
  - > 5 square metres of space per habitable room.
- For Houses:
  - > 40 square metres of space for up to four habitable rooms.
  - > 55 square metres of space for up to five habitable rooms.
  - > 70 square metres of space for up to six habitable rooms.
  - > 85 square metres of space for up to seven or more habitable rooms.

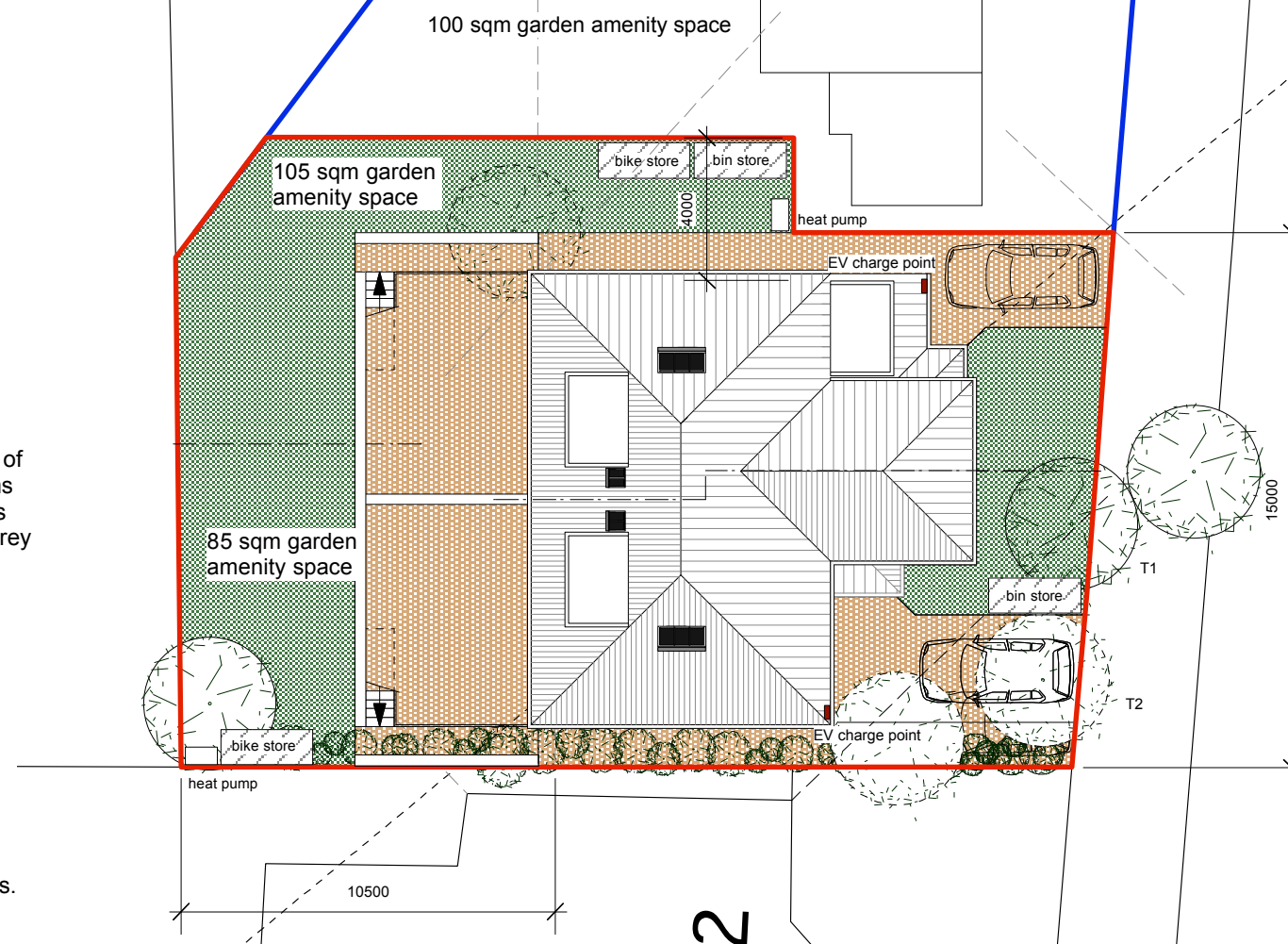

0 1 2 3 4 5  
scale

48

50

2

