

Proposed Garden shed
 at
 62 West Rd, Newport,
 Wormit, Fife, DD6 8HP.

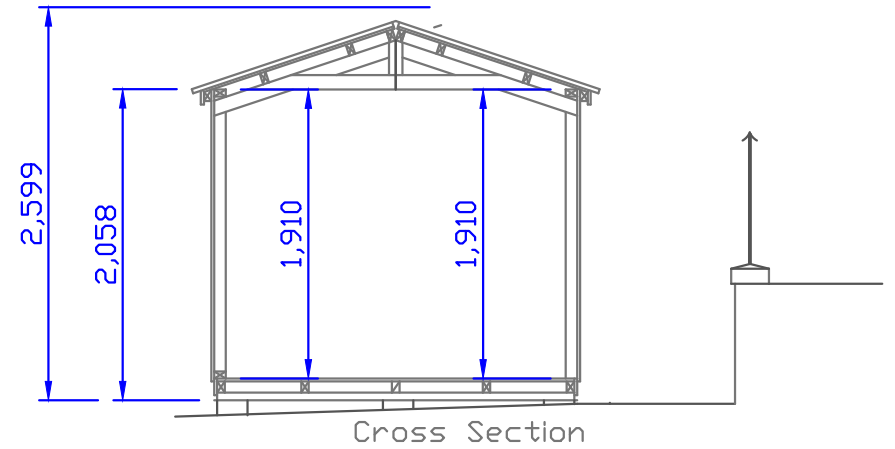

Timber shed constructed from 19mm redwood weather board on 70 x 45 frame with Black box profile roof covering.

Scale bar

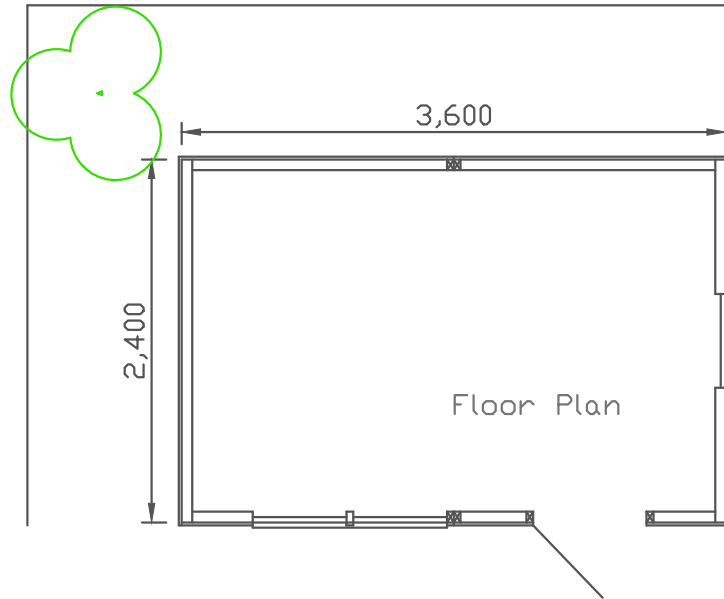

| | | | | |
|--------------|----------------|----------------|-------------|-------------------|
| | | | | GILLIES & MACKAY |
| | | | | EAST INCHMICHAEL |
| <u>SCALE</u> | <u>INITIAL</u> | <u>DWG. No</u> | <u>DATE</u> | ERRDL , PERTH |
| 1 - 50 | AGG | HORD02 | 08/02/21 | PH. 01821 642 713 |