

GROSS AREA
321.96sq.m.

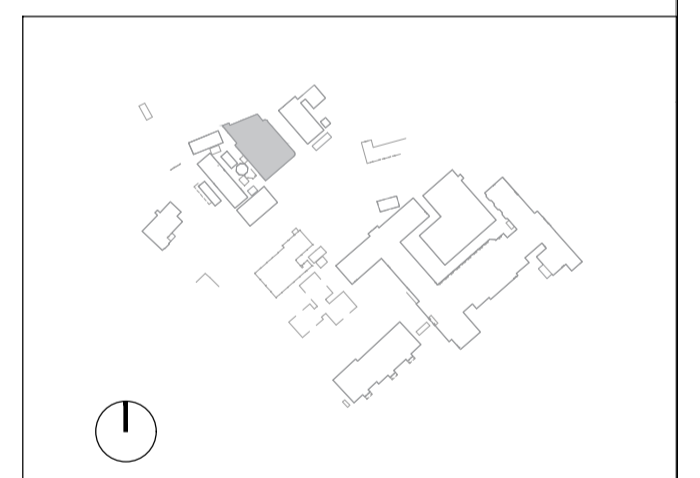
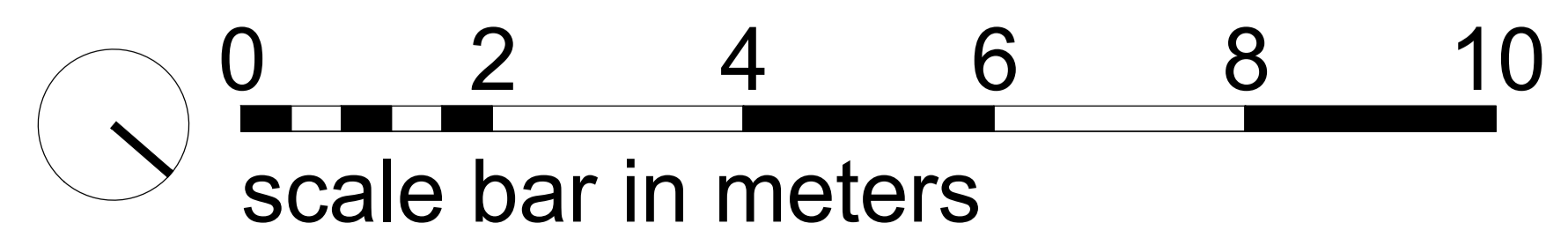

revisions

Epsom and St. Helier NHS
University Hospitals
NHS Trust

DEPARTMENT OF ESTATE MANAGEMENT
SUTTON HOSPITAL
COTSWOLD ROAD, SUTTON
SM2 5NF
HEAD OF SERVICE
TREVOR FITZGERALD

Site
EPSOM HOSPITAL

Job
BUILDING OUTLINE

Title
BOILER HOUSE

Project Ref.	Drawn
Scale 1:50@A1	Date 13.05.14
Drg.no.	Rev.