

General Notes

All dimensions to be checked on site. All details and dimensions relating the sub-contractors or suppliers work must be checked and agreed between the subcontractors or supplier and the general contractor.

This drawing is to be read in conjunction with all relevant architect's and engineer's drawings and the specification.

Works to comply with current Codes of Practice, British Standards and Building Regulations.

Contractor to establish with the local authority their requirements for inspecting the works, and adhere to these, from the outset.

Contractor to provide all necessary vertical and lateral restraint strapping in order to comply with The Building Regulations.

Fire Protection - All internal steelwork to be clad to comply with minimum fire resistance according to table B4 in Building Regulation Approved Documents B1 or B2.

Dry Packing - Steel beams to be dry packed up to existing masonry over to ensure full load take-up.

Existing Structure - Existing walling and foundations to be exposed and confirmed as adequate prior to works taking place. Assumed spans of existing joists, rafters etc. to be confirmed as correct. Structural Engineer to be consulted if any differences are found prior to works taking place

Temporary Stability - Contractor to provide all necessary temporary propping to safely undertake the works.

Steelwork and Timber Connections - All steelwork and timber connections are to be detailed and designed by the fabricator taking into account the loadings outlined in the calculations.

Roof and Trimming - Design for roof structure, trimming and connections are to be prepared by suitably qualified persons prior to construction.

Steelwork Protection - All steelwork to be blast cleaned to Sa 2 1/2 in accordance with BS EN ISO 12944. Internal Specification - coat with a Zinc phosphate epoxy primer to 80µm in accordance with BS EN ISO 12944. External Specification - hot dip galvanised to 140µm in accordance with BS EN ISO 1461 and 14713.

Steelwork grade - All steelwork to be high yield (S355) unless noted otherwise.

New timber in the works shall be tanalised and cut ends are to be thoroughly treated before fixing.

Splice details for long-span beams can often be accommodated if required.

Proprietary items to be used in accordance with manufacturer's instructions.

Party Wall - Works come under the Party Wall Etc. Act 1996. All appropriate notices and awards should be issued prior to work taking place.

Masonry Strength - Contractor to confirm strength of existing brick/blockwork and mortar class is in accordance with assumptions prior to commencing or ordering materials. Refer to Structural Engineer if found to be different for revised pier/padstone calculations.

All dimensions, levels, insulations, DPM, waterproofing and setting out of structures by architect.

Designer Risk Assessment

Mechanical aids should be employed when installing beams. Structural Engineer to be consulted if required.

The contractor is to provide all necessary temporary propping & temporary works to safely undertake the work and maintain structural stability. The contractor is to be aware that the property may be occupied during construction and temporary works loading to consider this.

The assumptions made within the calculations and drawings should be confirmed on site, prior to commencement of works. Any differences should be discussed with Structural Engineer, in order to check calculations.

Asbestos - Any suspected Asbestos containing materials should be tested and removed by specialist contractors in accordance with HSE guidance.

Appropriate checks are to be completed by contractor prior to commencement of work to ensure no services are in the local vicinity of the works.

Contractor to take all measures to control noise and dust.

All appropriate scaffold and edge protection should be put in place to ensure safety while working from height. Existing ceilings to be boarded during works to protect from falls between joists.

The BCO and contractor are to investigate the adequacy of the existing foundations prior to ordering materials.

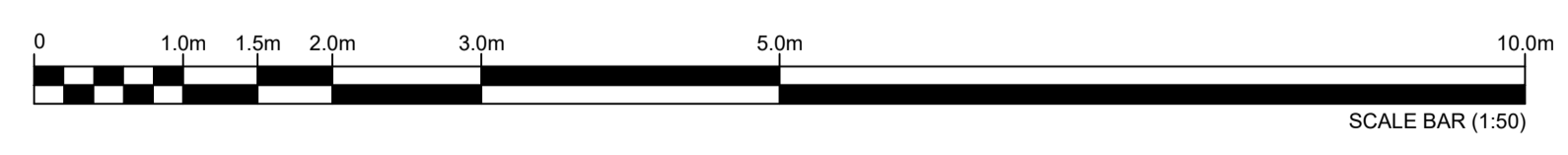
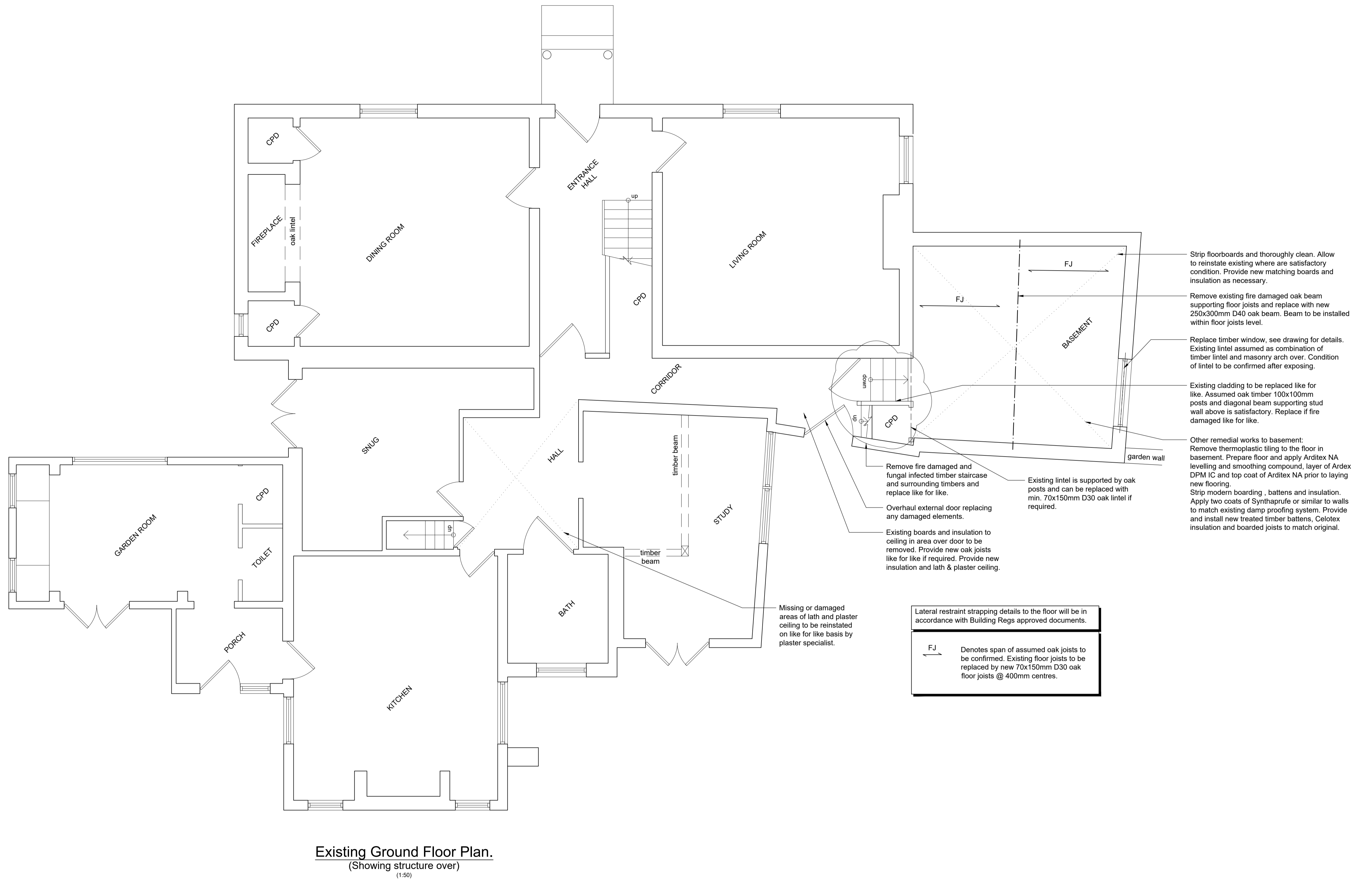

Revision:	Date:	Description:
A	07.12.2020	BR issue.
B	20.01.2021	Updated layout and notes.

PHILIP GOACHER ASSOCIATES
 Consulting Civil and Structural Engineers
 Park House • 122A Newland Road • Worthing • West Sussex • BN11 1LB
 TEL: 01903 217723 • EMAIL: mail@pgoacher.co.uk
 www.pgoacher.co.uk

Scale(s):	Date:
1:50@A1	JAN'21
Engineer:	Checked:
OR	PJG

Mr G Pound
 Crouchers, Birdham Road, Chichester
 GROUND FLOOR – LISTED
 BUILDING WORKS

Project No: 20308
 Drawing No: 004
 Revision: B