

50mm 50mm

50mm 50mm

50mm 50mm

Upstream SURREYS  
Downstream SURREYS  
P01.DWG - DATES  
STIMES

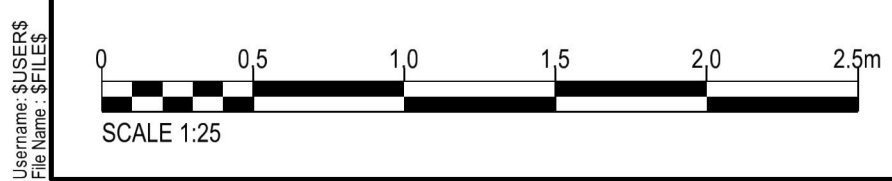

A11:594 x 841

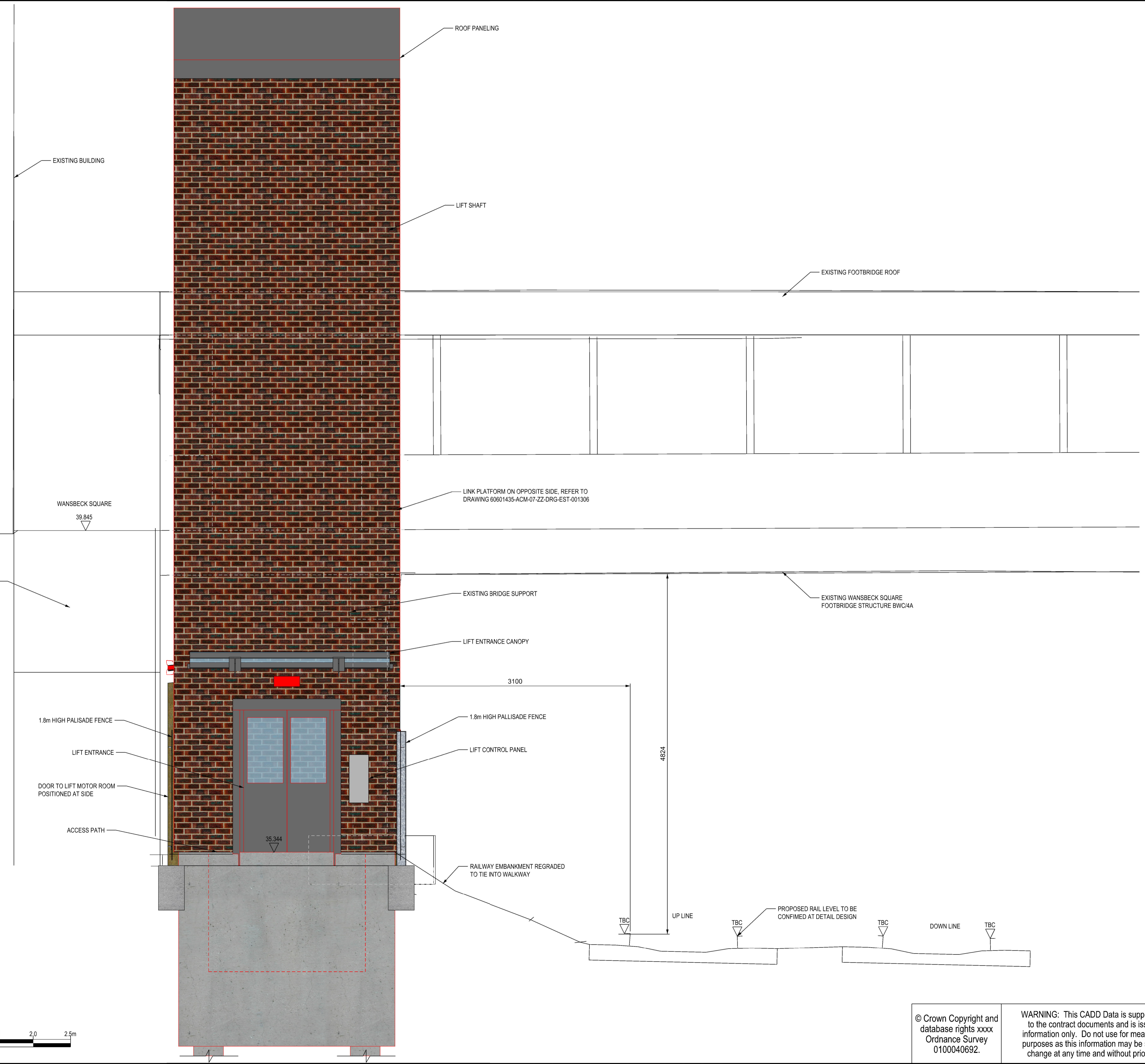

SAFETY, HEALTH AND ENVIRONMENTAL INFORMATION BOX

IT IS ASSUMED THAT WORKS ON THIS DRAWING WILL BE CARRIED OUT BY A COMPETENT CONTRACTOR WORKING, WHERE APPROPRIATE, TO AN APPROPRIATE METHOD STATEMENT

THIS DRAWING IS TO BE USED ONLY FOR THE PURPOSE OF ISSUE THAT IT WAS ISSUED FOR AND IS SUBJECT TO AMENDMENT

Notes

- THIS DRAWING IS TO BE READ IN CONJUNCTION WITH ALL OTHER RELEVANT DOCUMENTATION.
- DO NOT SCALE FROM THIS DRAWING. USE ONLY PRINTED DIMENSIONS.
- ALL DIMENSIONS IN MILLIMETRES. ALL CHANGE, LEVELS AND COORDINATES ARE IN METRES UNLESS DEFINED OTHERWISE.
- THIS DRAWING IS TO BE READ IN CONJUNCTION WITH THE PROJECT HEALTH & SAFETY FILE FOR ANY IDENTIFIED POTENTIAL RISKS.
- FOUNDATION TYPE, DIMENSIONS AND DEPTHS TO BE CONFIRMED FOLLOWING GROUND INVESTIGATION.
- THE NEED FOR CONSOLIDATION GROUTING OF MINE WORKINGS TO BE ADVISED AFTER COMPLETION OF SCHEME SPECIFIC GROUND INVESTIGATION.

LOCATION PLAN

Revision	By	Chkd	Appd	Checked Date	Suffix
First Issue				17/11/20	P01.1

Purpose of Issue: WIP-S0 SUITABILITY

Client: Northumberland County Council

Project Title: NORTHUMBERLAND LINE

Drawing Title: ASHINGTON STATION PROPOSED WANSBECK SQ LIFT ACCESS FRONT ELEVATION

Designed	Drawn	Checked	Approved	Date
---	---	---	---	---

Subsidiarity: S0

Scale @ 594 x 841

AS SHOWN

AECOM Internal Project No: 60601435

Zone / ELR / Mileage: --- BWC 2M 100yds to BWC 2M 1213yds

Engineering Manager: Alesdair Bathie  
alesdair.bathie@aecom.com  
+44 7810 771397

THIS DRAWING HAS BEEN PREPARED FOR THE USE OF AECOM'S CLIENT. IT MAY NOT BE USED, REPRODUCED OR RELIED UPON BY THIRD PARTIES, EXCEPT AS AGREED BY AECOM OR AS REQUIRED BY LAW. AECOM ACCEPTS NO RESPONSIBILITY AND DENIES ANY LIABILITY WHATSOEVER TO ANY PARTY THAT USES OR RELIES ON THIS DRAWING WITHOUT AECOM'S EXPRESS WRITTEN CONSENT. DO NOT SCALE THIS DOCUMENT. ALL MEASUREMENTS MUST BE OBTAINED FROM THE STATED DIMENSIONS.

AECOM Infrastructure & Environment UK Limited  
7th Floor, Aurora Building  
120 Bothwell Street  
Glasgow  
Tel: +44 141 248 0300  
Fax: N/A

**AECOM**

www.aecom.com

Drawing Number: 60601435-ACM-07-ZZ-DRG-EST-001303

Rev: P01.1

© Crown Copyright and database rights xxxx Ordnance Survey 0100040692.

WARNING: This CADD Data is supplementary to the contract documents and is issued for information only. Do not use for measurement purposes as this information may be subject to change at any time and without prior notice.

50mm 50mm