

© Crown Copyright and  
database rights 2020  
Ordnance Survey  
0100040692

SCALE 1:100

**PROPOSED PLAN**  
1:100

**SAFETY, HEALTH AND ENVIRONMENTAL INFORMATION**  
NOTES BELOW ARE ADDITIONAL TO HAZARDOUS RISKS NORMALLY ASSOCIATED WITH THIS TYPE OF WORK:

CN001. RISK OF STRIKING BURIED SERVICES DURING EXCAVATION WORKS

THESE NOTES ARE BASED ON THE USE OF EXPERIENCED AND COMPETENT CONTRACTORS CARRYING OUT THE WORK USING AN APPROVED SAFE METHOD OF WORKING.

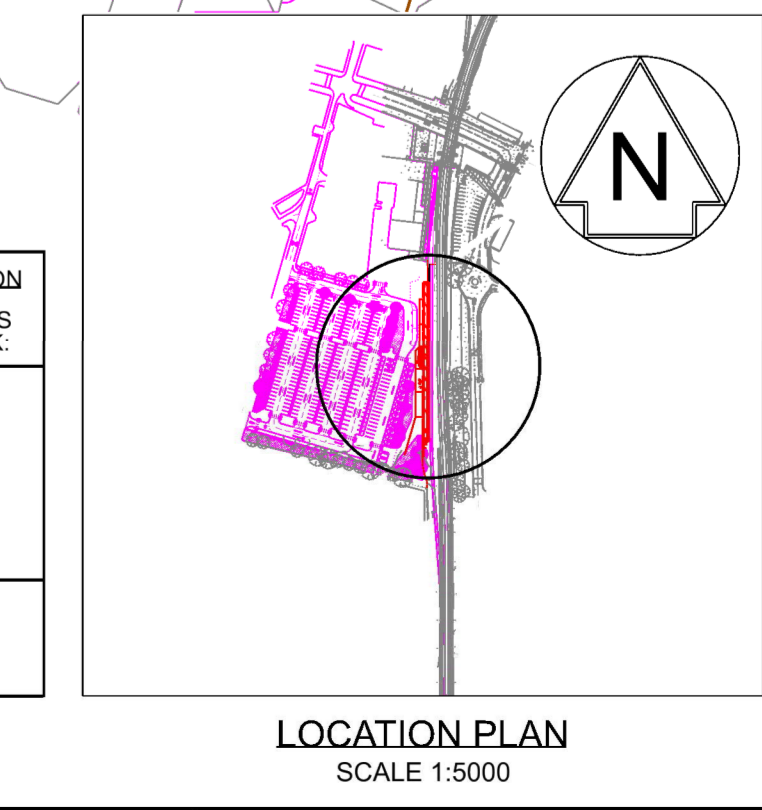

**SAFETY, HEALTH AND ENVIRONMENTAL INFORMATION BOX**  
IT IS ASSUMED THAT WORKS ON THIS DRAWING WILL BE CARRIED OUT BY A COMPETENT CONTRACTOR WHOSE WORK IS APPROPRIATE TO AN APPROPRIATE METHOD STATEMENT.  
THIS DRAWING IS TO BE USED ONLY FOR THE PURPOSE OF ISSUE THAT IT WAS ISSUED FOR AND IS SUBJECT TO AMENDMENT.

1. ALL DIMENSIONS ARE IN MILLIMETRES UNLESS STATED OTHERWISE.  
2. ALL CHANGES AND LEVELS ARE IN METRES.  
3. THIS DRAWING IS TO BE READ IN CONJUNCTION WITH:  
- 60601435-ACM-07-22-DRG-EHW-070001 AND ALL DRAWINGS LISTED THEREON.  
4. RAILWAY PLATFORM SPECIFIC DRAWINGS ARE:  
- 60601435-ACM-07-PL-DRG-ECV-000002  
- 60601435-ACM-07-PL-DRG-ECV-000006  
- 60601435-ACM-07-PL-DRG-ECV-000007

**HOLDS LIST**  
HOLD 01: AREA BETWEEN NEW PATH TO WANSBECK SQUARE AND PLATFORM TO BE REVIEWED AT A LATER DATE

**COLOUR KEY:**

- NEW, PROPOSED OR ADDITIONAL
- REDUNDANT OR TO BE REMOVED
- MODIFIED OR TO BE MOVED
- EXISTING OR UNCHANGED
- BY OTHERS
- OS/SURVEY DATA

Issue for Planning	RP	PP	AB	AS	PO1
Revision Details	By	CHK	Appr	Check	Date
Position of Issue	WIP-SO SUITABILITY				
GRIP Stage	GRIP 4				

**Northumberland County Council**

**NORTHUMBERLAND LINE**

**ASHINGTON STATION PROPOSED GENERAL ARRANGEMENT**

Design	Draw	Check	Approved	Date
O. Quinn	R. Price	P. Peacy	A. Barrie	15.01.2021
S. Quinn	S. Price	P. Peacy	A. Barrie	

Subsidiary: AECOM Infrastructure & Environment UK Limited  
7th Floor, Aurora Building  
120 Seaward Street  
Glasgow  
Tel: +44 (0) 141 248 0300  
Fax: NA

**AECOM**

Drawing Number: 60601435-ACM-07-PL-DRG-ECV-000003