

**These are the notes referred to on the following official copy**

Title Number GR116900

The electronic official copy of the document follows this message.

This copy may not be the same size as the original.

Please note that this is the only official copy we will issue. We will not issue a paper official copy.

OFFICE COPY

ISSUED BY THE GLOUCESTER  
DISTRICT LAND REGISTRY

form part of a  
the amount or  
five thousand five

and seals the

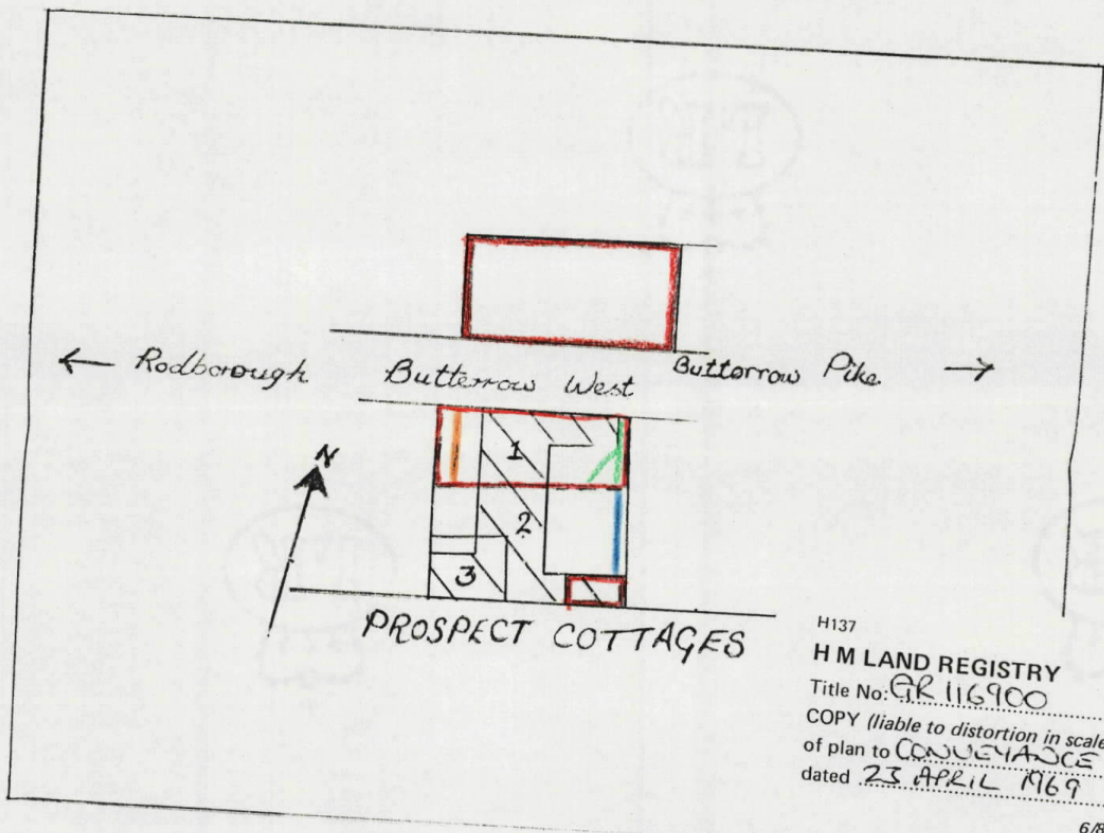

H137  
H M LAND REGISTRY  
Title No: GR 116900  
COPY (liable to distortion in scale)  
of plan to CONVEYANCE  
dated 23 APRIL 1969

