

# Dead and Dangerous Tree Notice Form



## Exception Works for Trees Subject to Tree Preservation Order or Within a Conservation Area

**Dead and Dangerous Tree Notice - If intending to carry out works that are an exception from the normal requirements to gain written consent the tree owner (or contractor on his/her behalf) are advised to provide at least 5 working days notice, in writing, to Cornwall Council's Planning Department before doing so.**

**Please read 'Dead and Dangerous Tree Notice' Advice Note**

### **Owners Contact Details:**

Name	Andrew Johnston
Address	Ruthern Valley Holidays Ruthernbridge
Postcode	PL30 5LU
Phone	
email	

**Agents Contact Details:**

Name	
Address	
Postcode	
Phone	
email	

N.B. Only complete this section if an agent is acting on behalf of owner. Your tree work contractor's/consultant's name should not be included unless they are handling the correspondence on your behalf. All correspondence, including the decision letter, will be sent to the agent. Arrangements for a site visit will also be made through the agent.

**Details of Tree/s:**

Species	Oak tree
Age (eg young, middle aged, mature, veteran)	Mature
Location	Eastern boundary above Lodge no 1
Address or description	As above
Postcode	
Grid ref	

Map

Please provide annotated plan if necessary

N.B. A Council officer must be able to find the tree(s) without difficulty in order to confirm that the works may proceed.

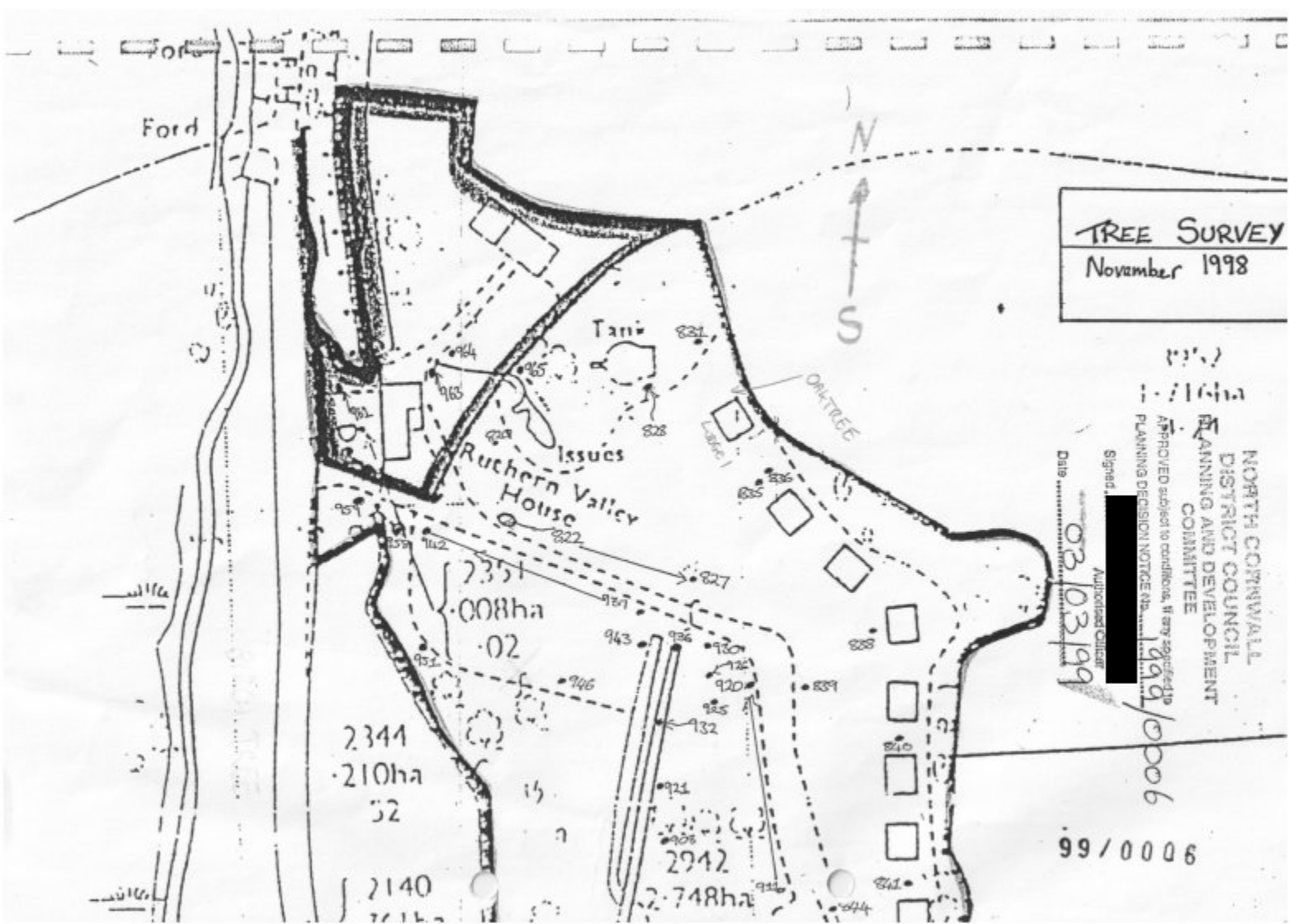

**Please Sketch/Insert Plan Here:**

**No1**



**No2**



**Proposal:**

Provide a detailed description of proposed works

One broken branch lying on bank above Lodge – remove. Photo No1  
5 metres up the tree large split in big branch before the y junction over Lodge 1. Photo No2.  
Cut back branch to a safe juncture as per good forestry practice.

--	--

***Reason:***

Describe why the works are an exception	Dangerous – to property and occupants.
---	--

***Photographs:***

***Replacement Proposals:***

Do you have a preference for replacement planting?  Describe preferred replacement trees and reasoning	None – removal of dangerous branches only.
--	--

***Additional Comments:***

Provide additional information here	
-------------------------------------	--

Please complete the form and return via email to [planning@cornwall.gov.uk](mailto:planning@cornwall.gov.uk).