

Mineral wool insulation EWI system to be installed as per manufacturers details and specification.

Basecoat with mesh reinforcing with rendered brick effect finish.

Existing SVP to be replaced with UPVC items to match existing.

Base track and XPS plinth to be formed as per detail SD6

Existing SVP removed as part of EWI works

Existing drainage point to SVP to be broken out and repositioned to suit proposed SVP location. Allow for bend, underground connections including collars and bedding to pipe as required.

Parge coat applied to face of brickwork to act as air barrier layer

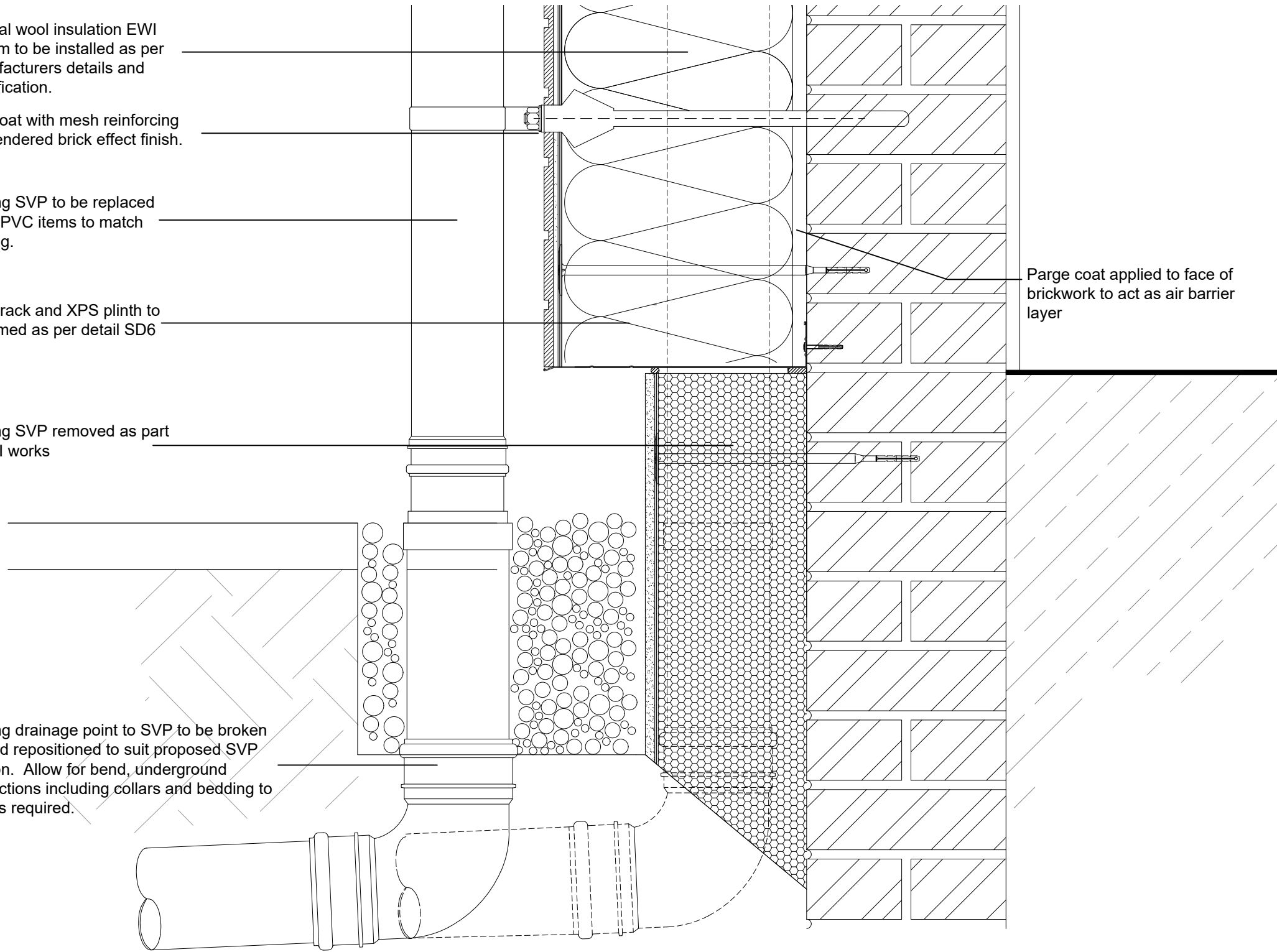

## SD21 RWP DETAIL (OPTION 2)

NOTE:  
DETAIL TO BE ONLY USED WHERE RWP POSITION MAKES THE USE OF DETAIL SD6 UNFEASIBLE.

### SAFETY, HEALTH AND ENVIRONMENTAL INFORMATION:

IN ADDITION TO THE HAZARDS / RISKS NORMALLY ASSOCIATED WITH THE TYPES OF WORK DETAILED ON THIS DRAWING, NOTE THE FOLLOWING;

Significant Residual Risks :

Action to be Taken :  
Refer to Health and Safety Plan

### NOTES

REFER TO DRAWING 550-(TE)-8627 REGARDING FIRE STOPPING ARRANGEMENTS

REV	DATE	AMENDMENTS	BY	APR'D

Do not scale from this drawing.  
All dimensions must be checked on site by the Contractor prior to the commencement of any fabrication or building works.  
Where applicable, dimensions and details are to be read in conjunction with specialist consultants' drawings and/or other specifications; any disparity is to be brought to the attention of Michael Dyson Associates Limited prior to the commencement of any fabrication or building works.  
©This drawing is the property and copyright of Michael Dyson Associates Limited; it shall not be copied to any other party without the express written consent of an authorised director of Michael Dyson Associates Limited.

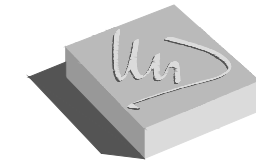

**Michael Dyson associates ltd**

Excellence in Housing Consultancy

West House, Meltham Road, Honley,  
Huddersfield HD9 6LB  
t. 01484 666888 f. 01484 664186  
w. www.mdysion.co.uk

CLIENT :

CONNEXUS HOUSING LTD

PROJECT :

CONNEXUS WARMER HOMES ERDF PROJECT  
SHROPSHIRE / HEREFORDSHIRE

TITLE :

SECTION DETAILS (SD25)  
SVP DETAIL - OPITION 2

DRAWN BY :	JMY	APPROVED BY :	
DATE :	DEC/2020	DATE :	
SCALE :	1:5	ORIGINAL DRAWING SIZE 420 x 297 - A3	
DRAWING No :	325-(TE)-8627-(SD21)	REV.	-