

Allow for 100mm th mineral wool insulation to fitted over over masonry as indicated to eliminate cold bridging. Mineral wool to be fitted under rafter roll so that ventilation to roof space is uninterrupted.

Existing loft insulation

Roof to be extended as per MDA detail drawing 301-(TE)-8627-317.

EPDM membrane to be taped and sealed to wall plate.

EPDM membrane to be dressed up existing masonry as indicated to form air tightness layer. EPDM to be lapped under parge coat as indicated

Existing rainwater goods to be replaced with UPVC rainwater goods to match existing.

UPVC soffit and fascia

EWI system to be taken up and notched around rafters and up to bottom edge of rafter roll

Mastic Sealant

Parge coat applied to face of brickwork to act as air barrier layer

Note:

Drawing indicates typical roof construction arrangement Contractor to investigate existing roof structures on a property to property basis and inform MDA of any deviations from drawing as necessary

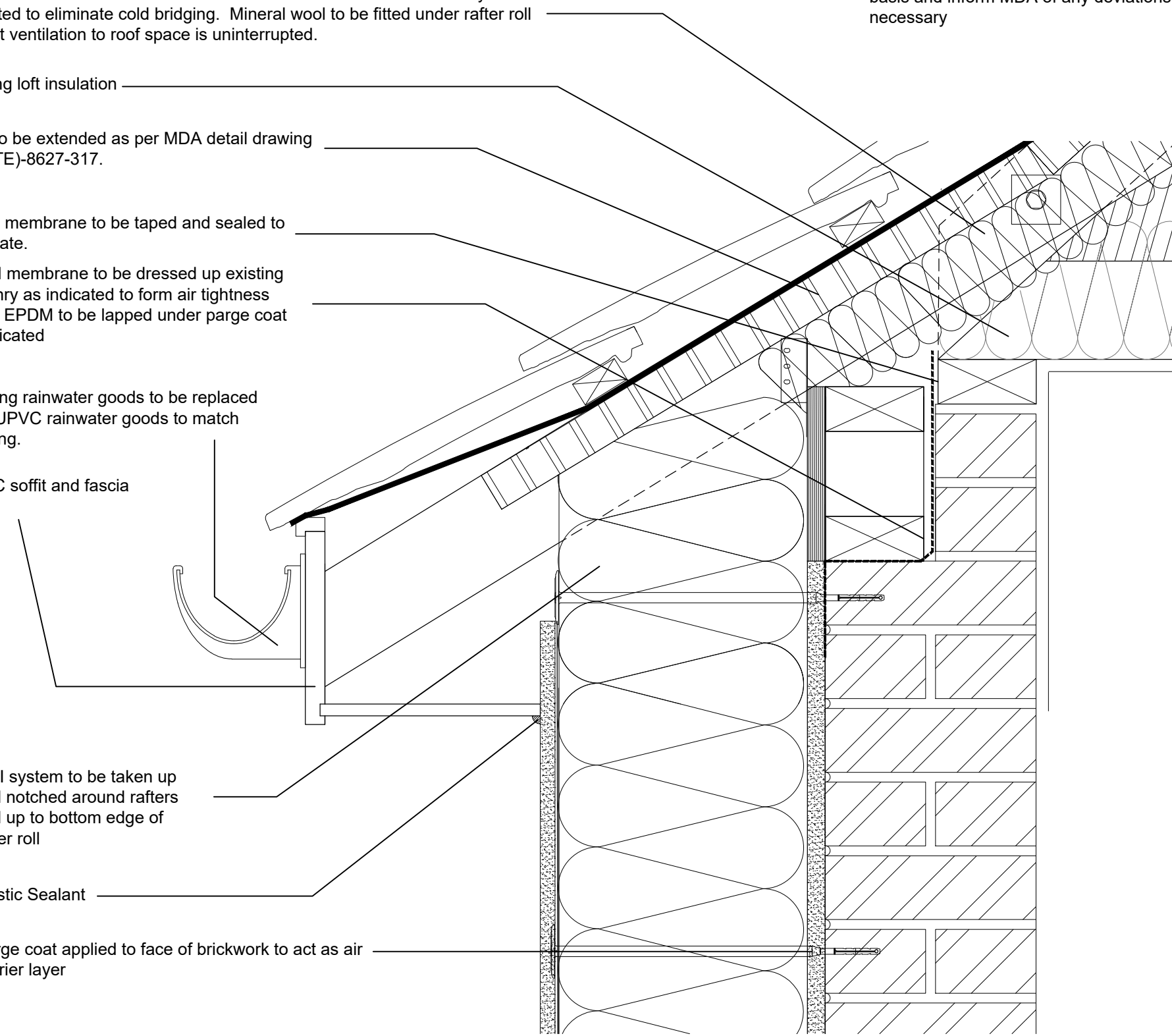

SAFETY, HEALTH AND ENVIRONMENTAL INFORMATION:

IN ADDITION TO THE HAZARDS / RISKS NORMALLY ASSOCIATED WITH THE TYPES OF WORK DETAILED ON THIS DRAWING, NOTE THE FOLLOWING;

Significant Residual Risks :

Action to be Taken :
Refer to Health and Safety Plan

NOTES

REFER TO DRAWING 550-(TE)-8627 REGARDING FIRE STOPPING ARRANGEMENTS

REV	DATE	AMENDMENTS	BY	APR'D
A	05.01.21	NOTE REGARDING FIRE STOPPING ADDED	JLW	PT

Do not scale from this drawing. All dimensions must be checked on site by the Contractor prior to the commencement of any fabrication or building works. Where applicable, dimensions and details are to be read in conjunction with specialist consultants' drawings and/or other specifications; any disparity is to be brought to the attention of Michael Dyson Associates Limited prior to the commencement of any fabrication or building works. ©This drawing is the property and copyright of Michael Dyson Associates Limited; it shall not be copied to any other party without the express written consent of an authorised director of Michael Dyson Associates Limited.

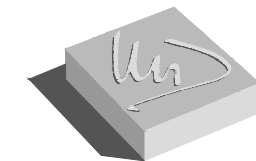

Michael Dyson associates Ltd

Excellence in Housing Consultancy

West House, Meltham Road, Honley,
Huddersfield HD9 6LB
t. 01484 666888 f. 01484 664186
w. www.mdysen.co.uk

CLIENT :

CONNEXUS HOUSING LTD

PROJECT :

CONNEXUS WARNER HOMES ERDF PROJECT
SHROPSHIRE / HEREFORDSHIRE

TITLE :

SECTION DETAILS (SD17)
EAVES DETAIL

DRAWN BY :	JMY	APPROVED BY :	
DATE :	DEC/2020	DATE :	
SCALE :	1:5	ORIGINAL DRAWING SIZE 420 x 297 - A3	
DRAWING No :	317-(TE)-8627-(SD17)	REV.	A

SD17 EAVES DETAIL