

Upstand

(Drg.No: D0901/03-00W_0-4Deg_201-ExtInt-S-DB_001)

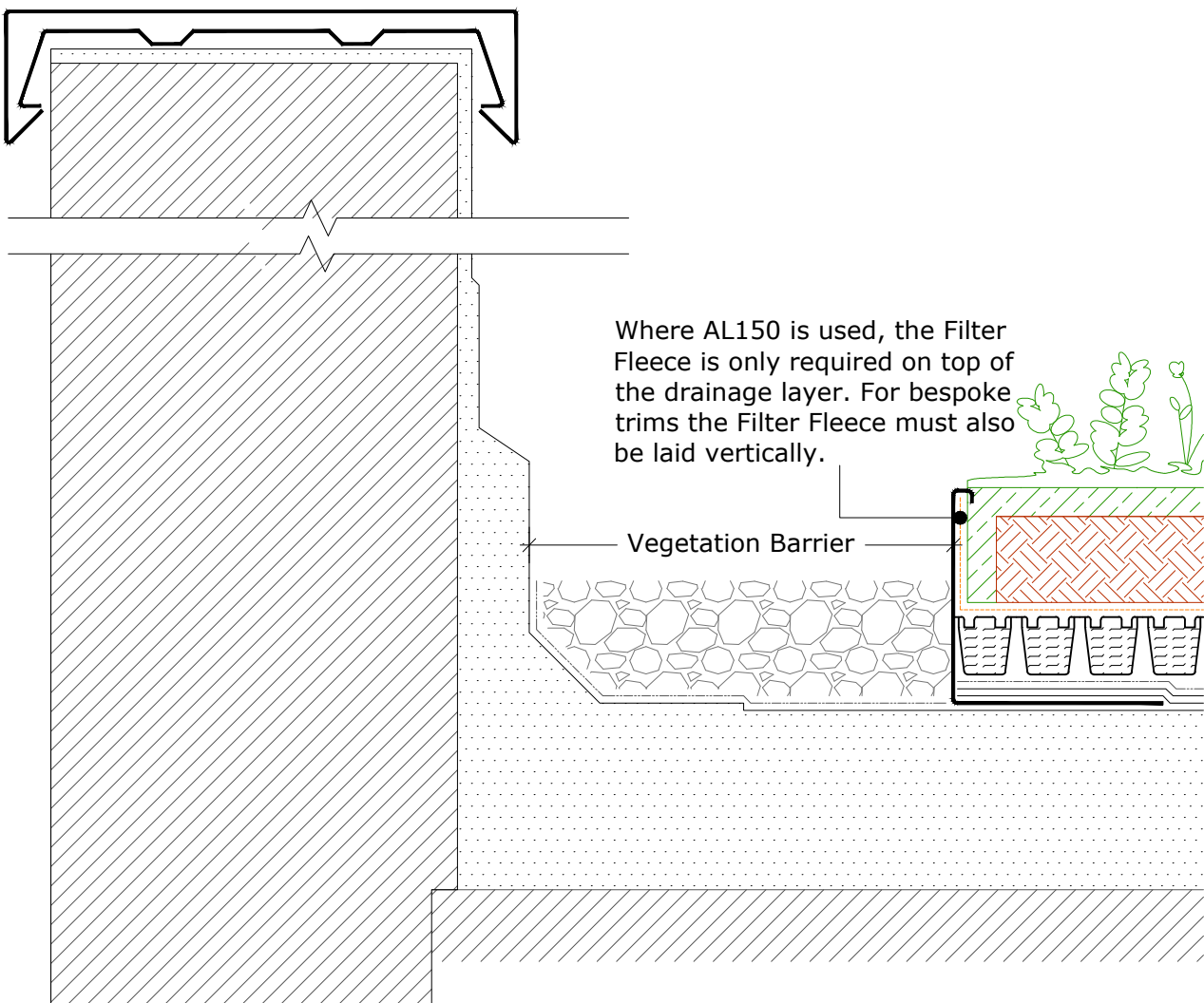

Upstand to Parapet

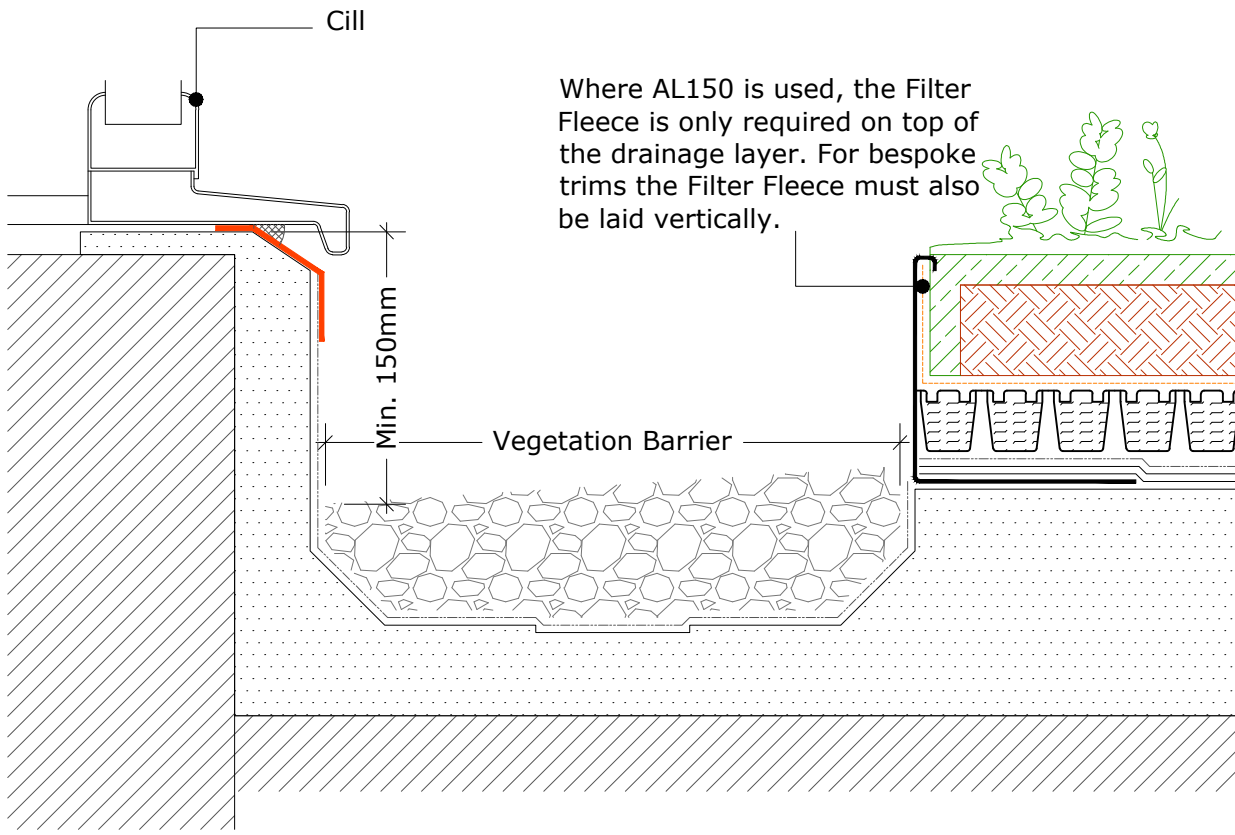

Internal Gutter to Upper floor glazing

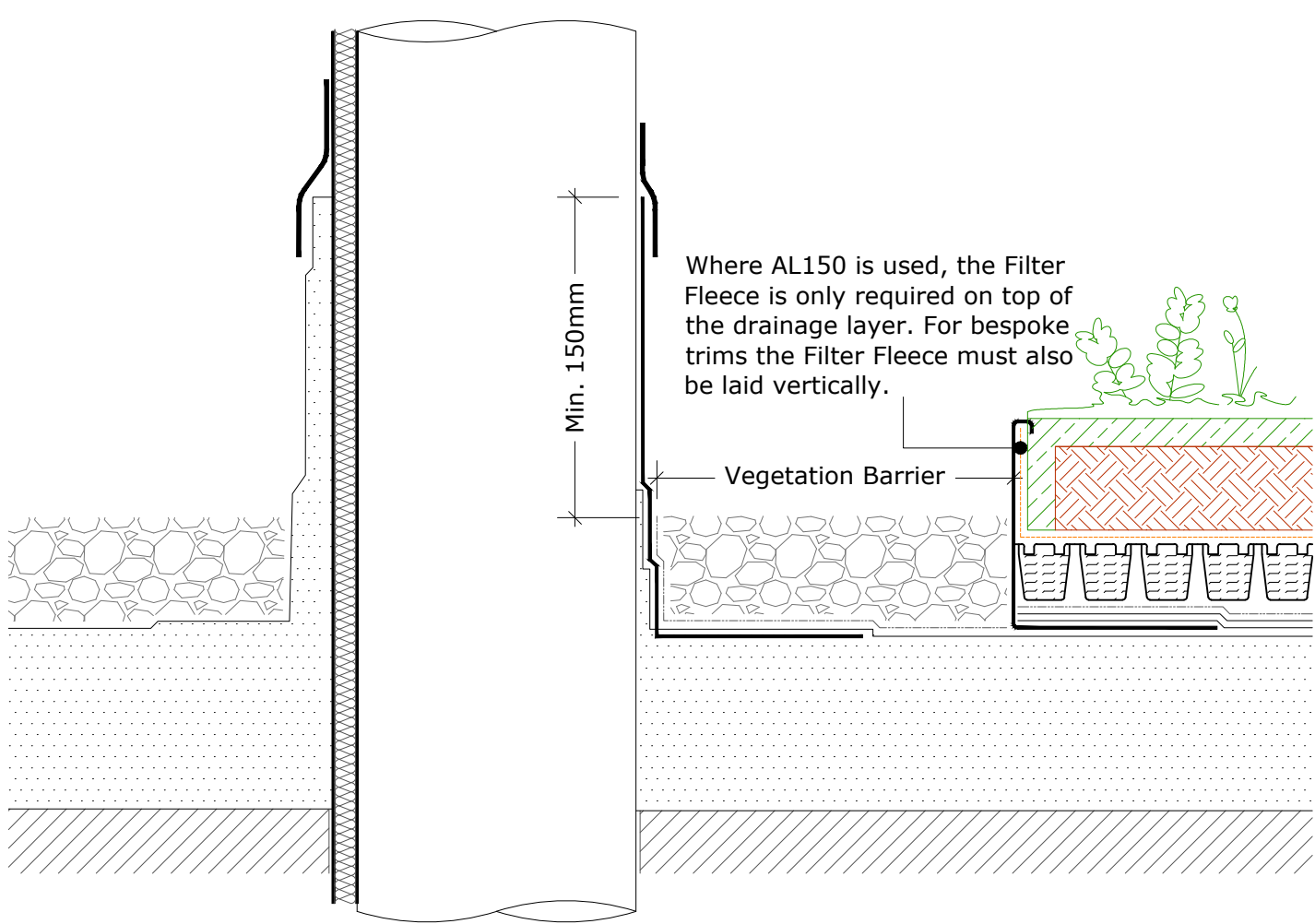

Upstand to Hot Flue or Cold Pipe

(Drg.No: D0901/03-00W_0-4Deg_007-ExtInt-S-DB_002)

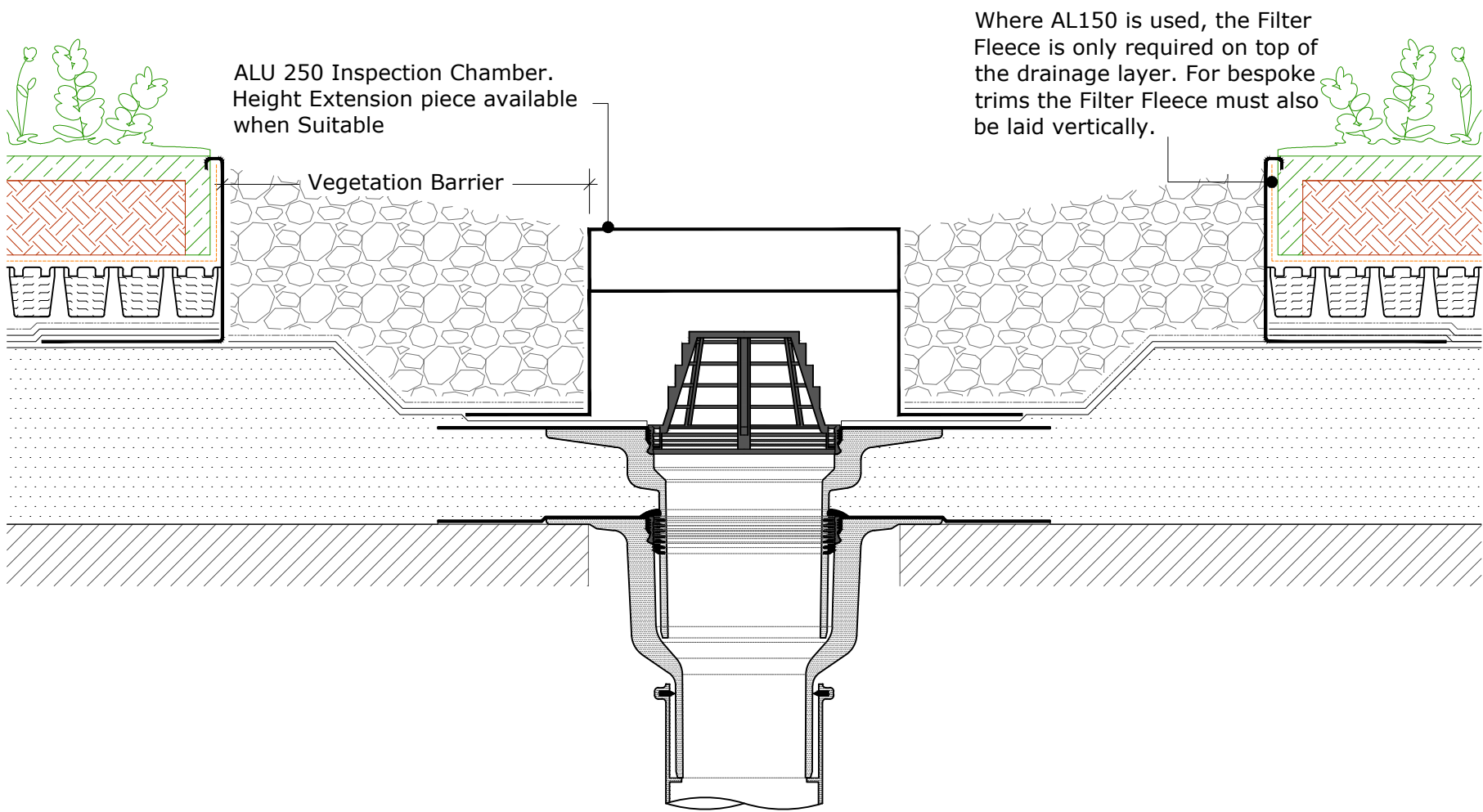

Bauder Outlet - Compact

(Drg.No: D0901/03-00W_0-4Deg_006-ExtInt-S-DB_001)

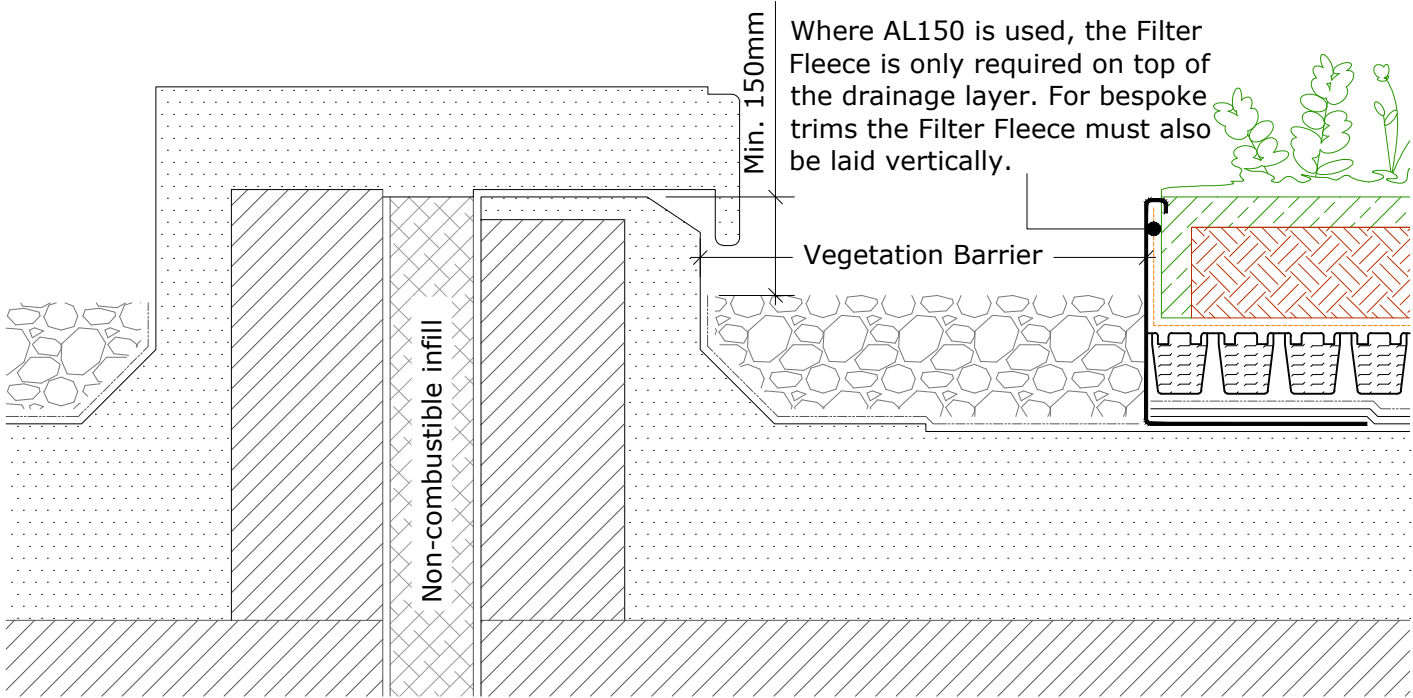

Twin Kerb Expansion Joint

(Drg.No: D0901/03-00W_0-4Deg_204-ExtInt-S-DB_001)

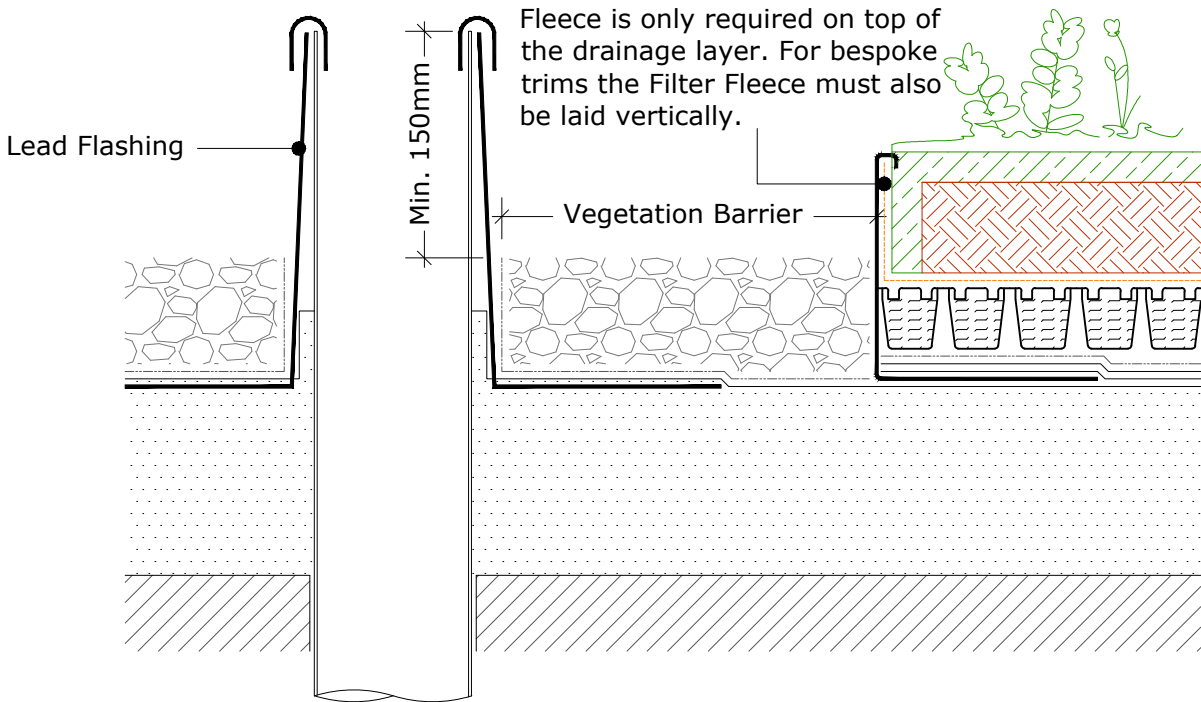

Soil Vent Pipe

(Drg.No: D0901/03-00W_0-4Deg_007-ExtInt-S-DB_001)

Vegetation Termination Detail

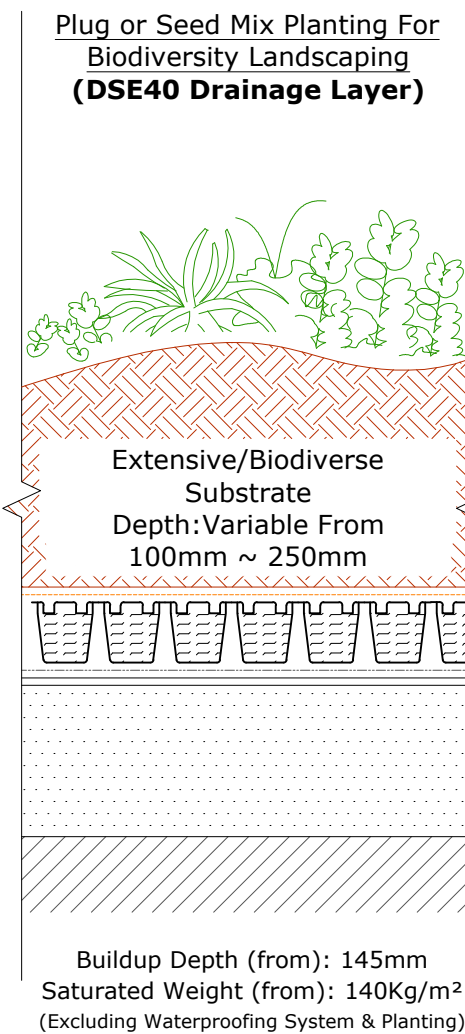
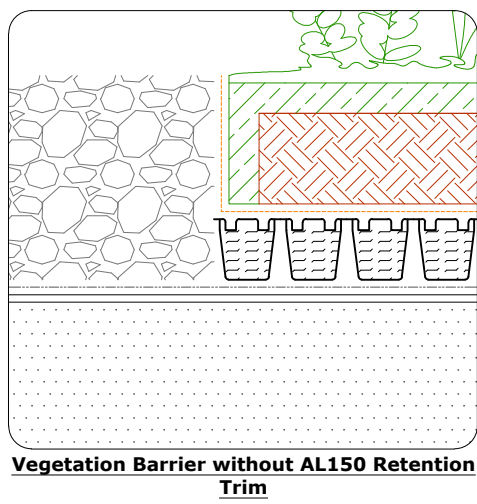

Extensive Brown Roof System

(Exact planting to be agreed with LPA ecologist prior to installation)

NOTES

- The Copy right of this drawing is the property of Smith Maloney Architects Limited and must not be copied otherwise reproduced without written consent.
- The contractor is responsible for checking dimensions, tolerances and references. Any discrepancy to be verified with the Architect before proceeding with the works.

CDM Regulations 2015

ALL current drawings and specifications for the project must be read in conjunction with the Designer's Hazard and Environmental Assessment Record.

Key

- Extensive / Biodiverse Substrate
- DES40 Drainage Board
- Bauder Filter Fleece
- Bauder Protection Mat
- Additional Bauder Capping Sheet / Membrane to secure the metal trim
- Bauder single ply membrane on rigid insulation
- Deck / Substrate
- Vegetation barrier
Minimum 80mm deep & 300mm wide.
Width must be increased to at least 500mm when positioned adjacent to opening rooflights, windows or door openings. In accordance with both gro green and flt roof codes.
- AL150 Edge / Drainage trim. Secured in place by separate pieces of torch applied Bauder Plant-E Capping Sheet.
For vegetation/substrate build-up depths greater than 150mm, a bespoke perforated edge/drainage trim is required.

17/02/2021 (-) PLANNING ISSUE

date	rev	revision/author/checker
------	-----	-------------------------

client
HADLEY WOOD GOLF CLUB
project
THE LODGE DEVELOPMENT HADLEY WOOD GOLF CLUB BEECH HILL, HADLEY WOOD
drawing
NEW BUILD ELEMENT: BROWN ROOF DETAILS
-
-

PLANNING ISSUE

drawing no	rev
T(20)D27	(-)
drawn	checked
—	ADS
scale @ A1 1:5	date 12/02/21

**SMITH
MALONEY**
ARCHITECTS

Waterloo House Waterloo St Clifton Bristol BS8 4BT
T 0117 214 0575
www.smithmaloney.co.uk