

BORLUM ROAD

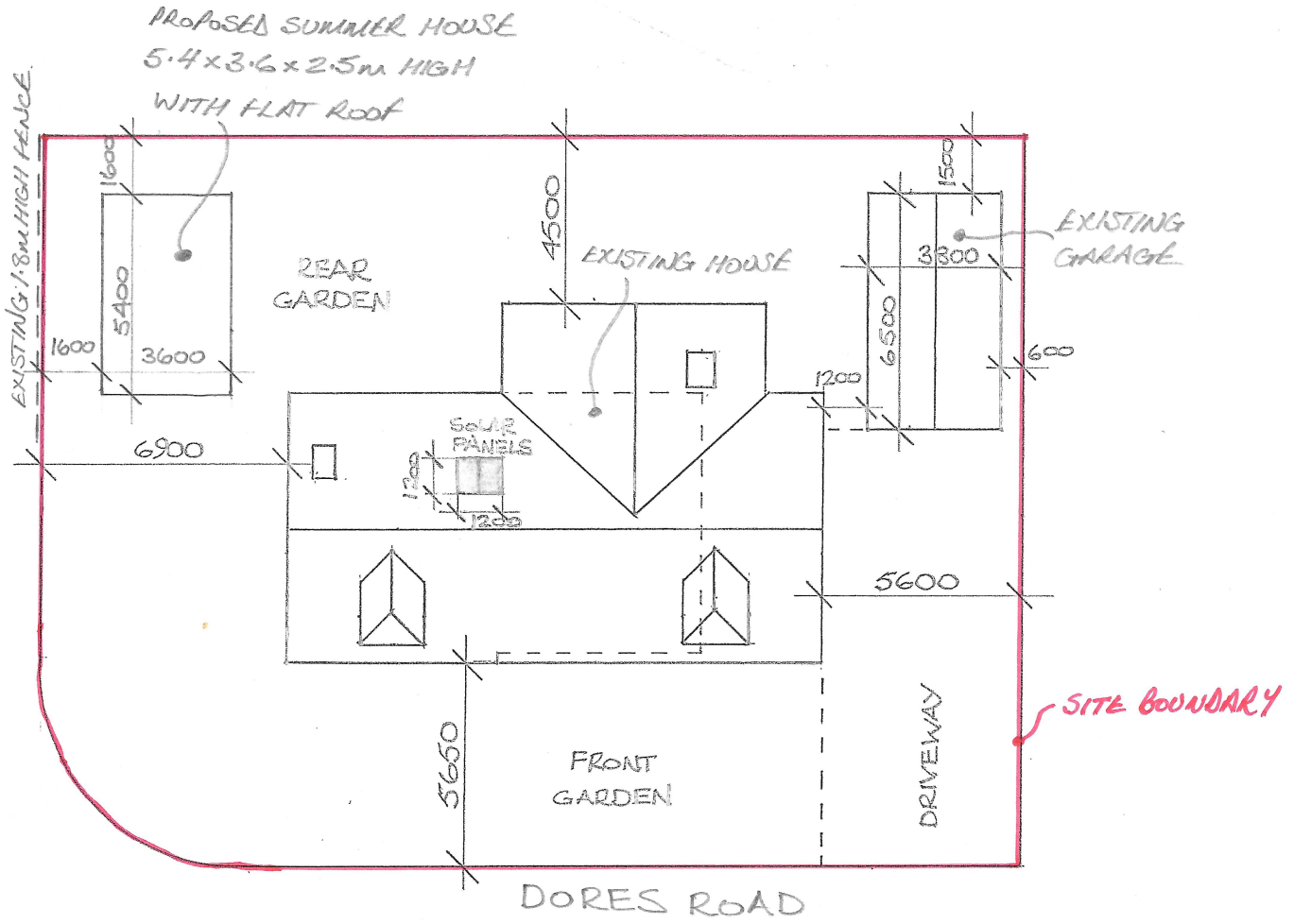

PROPOSED SITE PLAN 1:200

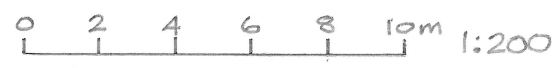

PROPOSED SUMMER HOUSE AT 35 DORES ROAD, INVERNESS FOR MR & MRS A. RUSSELL

DRAWING N° AR 0221-01A

PROPOSED ALTERATION & EXTENSION  
TO  
35 DORES ROAD, INVERNESS  
FOR  
MR & MRS A. RUSSELL  
DRAWING No. AR/0815/01/GW