



PHOTOGRAPH OF FRONT ELEVATION



PHOTOGRAPH OF REAR ELEVATION



PHOTOGRAPH OF REAR ELEVATION AND TREE 01 AND TREE 02



PHOTOGRAPH OF REAR ELEVATION AND EXISTING RAISED PATIO

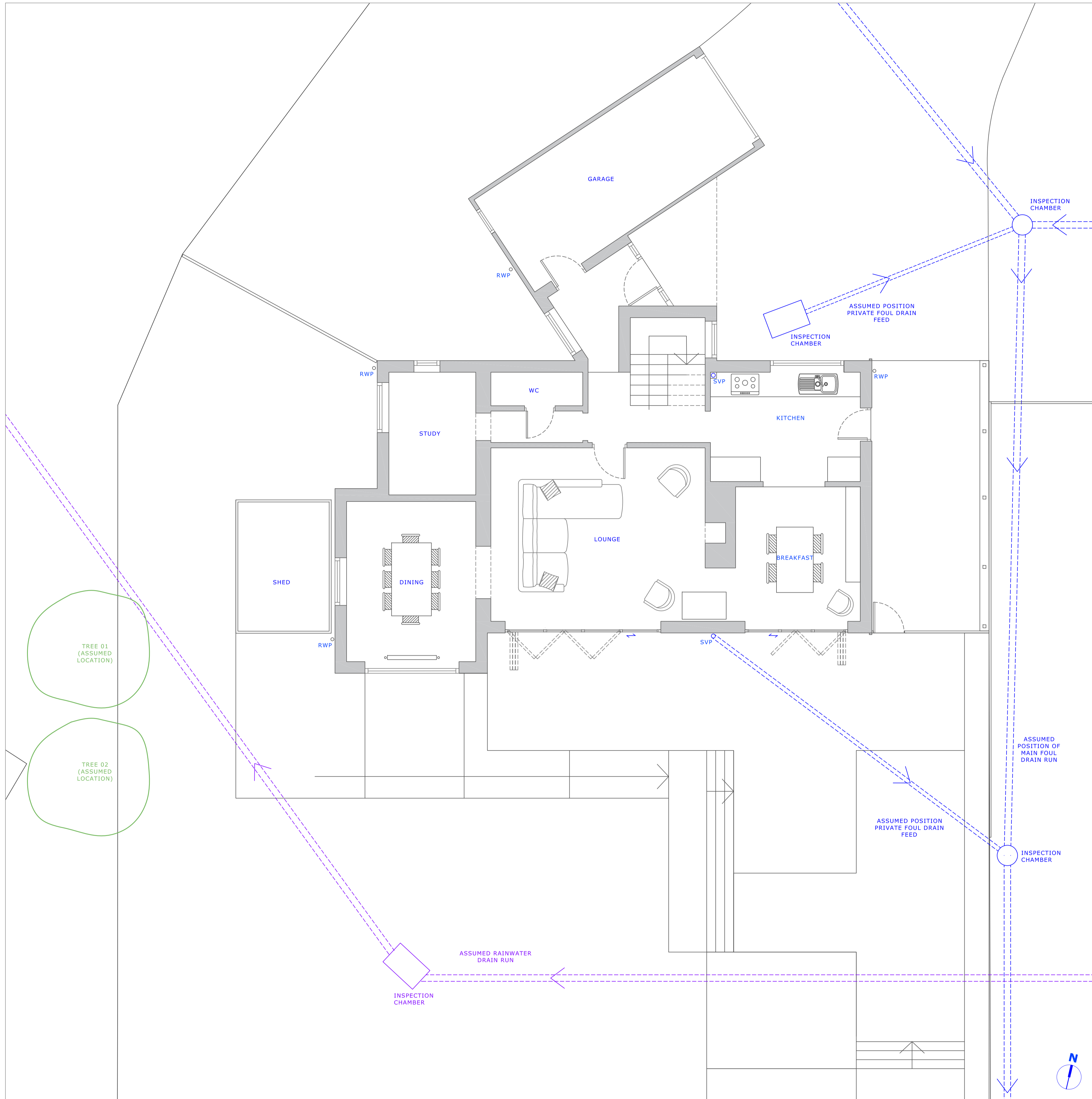

EXISTING GROUND FLOOR PLAN  
1:50

GENERAL NOTES

MATERIALS

These plans must not be acted upon until the appropriate planning and building regulations approvals have been granted. Should the works be undertaken prior to the above approvals being in place, it is done so entirely at the clients own risk.

-	-
-	-
-	-
-	-
-	-
-	-
-	-
-	-
-	-

DATE	REVISION
------	----------

# group 19

ARCHITECTURE AND URBAN DESIGN

24 St. Andrews Close  
Crowthorne  
Berkshire  
RG45 6UP

07988851147  
hopkins.group19@gmail.com  
www.group19.co.uk

This drawing is © Group 19 2021. All rights reserved. Group 19 retains all intellectual property (IP) rights and copyright associated with this work, as set out in Group 19's terms and conditions. Further publication or use will require copyright usage approval. Contact Group 19 for further information.

CLIENT  
**Richard and Elaine McCully**

PROJECT  
**11 Linkway  
Edgcumbe Park  
Crowthorne  
RG45 6ES**

DRAWING TITLE  
**Existing Ground Floor Plan**

SCALE  
**1:100 / 1:50**

FORMAT  
**A1**

DATE  
**February 2021**

DRAWN  
**MH**

DRAWING NUMBER  
**043-A-EX-02**

REVISION  
-