



3D RENDER OF PROPOSED EXTENSION FROM FRONT ELEVATION



3D RENDER SHOWING EXISTING REAR ELEVATION



3D RENDER SHOWING PROPOSED REAR EXTENSION



3D RENDER SHOWING PROPOSED REAR EXTENSION

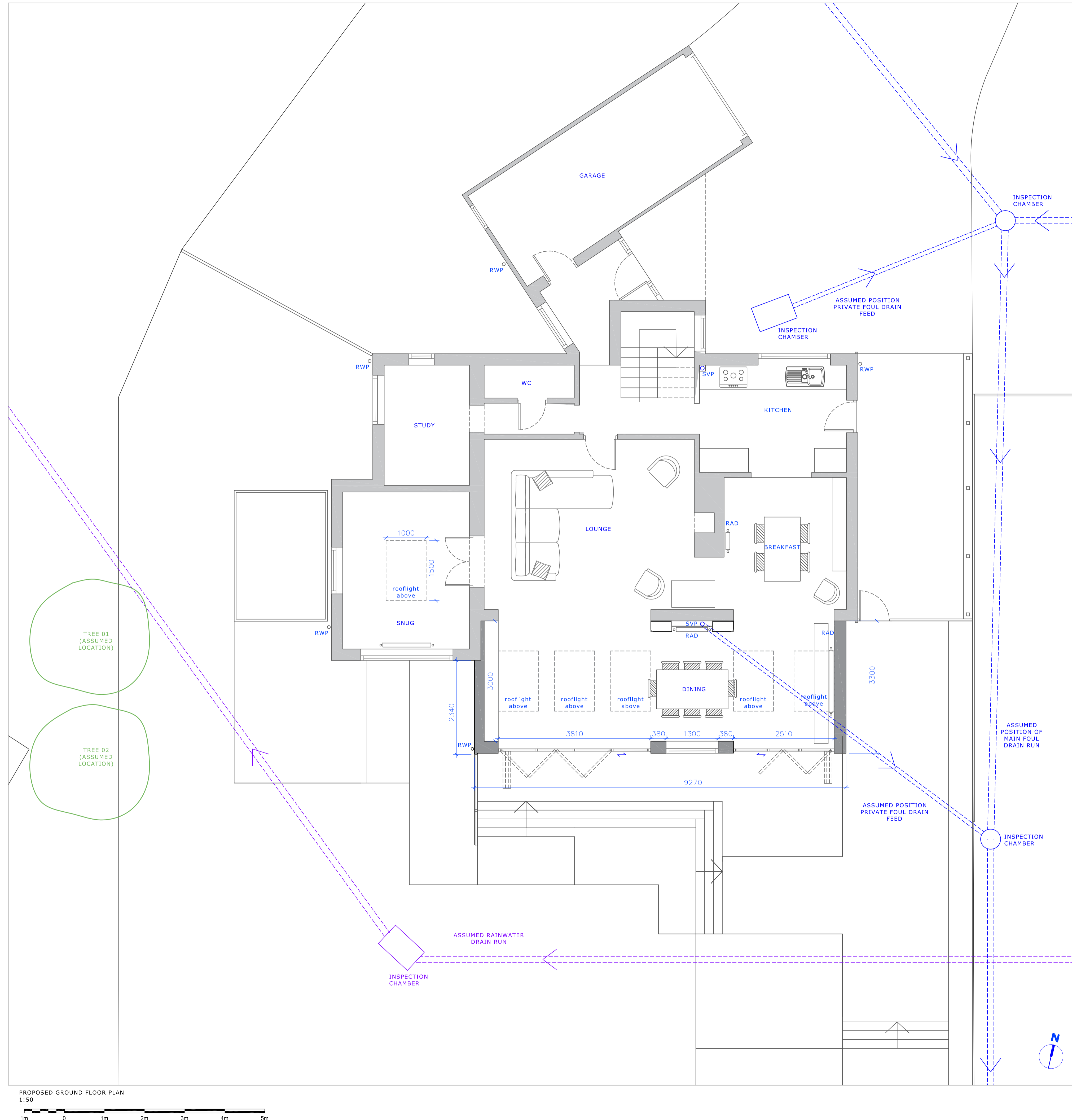

PROPOSED GROUND FLOOR PLAN
1:50

GENERAL NOTES

MATERIALS

These plans must not be acted upon until the appropriate planning and building regulations approvals have been granted. Should the works be undertaken prior to the above approvals being in place, it is done so entirely at the clients own risk.

DATE	REVISION
-	-
-	-
-	-
-	-
-	-
-	-
-	-
-	-
-	-
-	-

group 19

ARCHITECTURE AND URBAN DESIGN
24 St. Andrews Close
Crowthorne
Berkshire
RG45 6UP
07988851147
hopkins.group19@gmail.com
www.group19.co.uk

This drawing is © Group 19 2021. All rights reserved. Group 19 retains all intellectual property (IP) rights and copyright associated with this work, as set out in Group 19's terms and conditions. Further publication or use will require copyright usage approval. Contact Group 19 for further information.

CLIENT
Richard and Elaine McCully

PROJECT
**11 Linkway
Edgcombe Park
Crowthorne
RG45 6ES**

DRAWING TITLE
**Proposed Ground Floor Plan and
3D Renders**

SCALE
1:100 / 1:50

FORMAT
A1

DATE
February 2021

DRAWN
MH

DRAWING NUMBER
043-A-PR-02

REVISION
-