

Existing ground floor plan

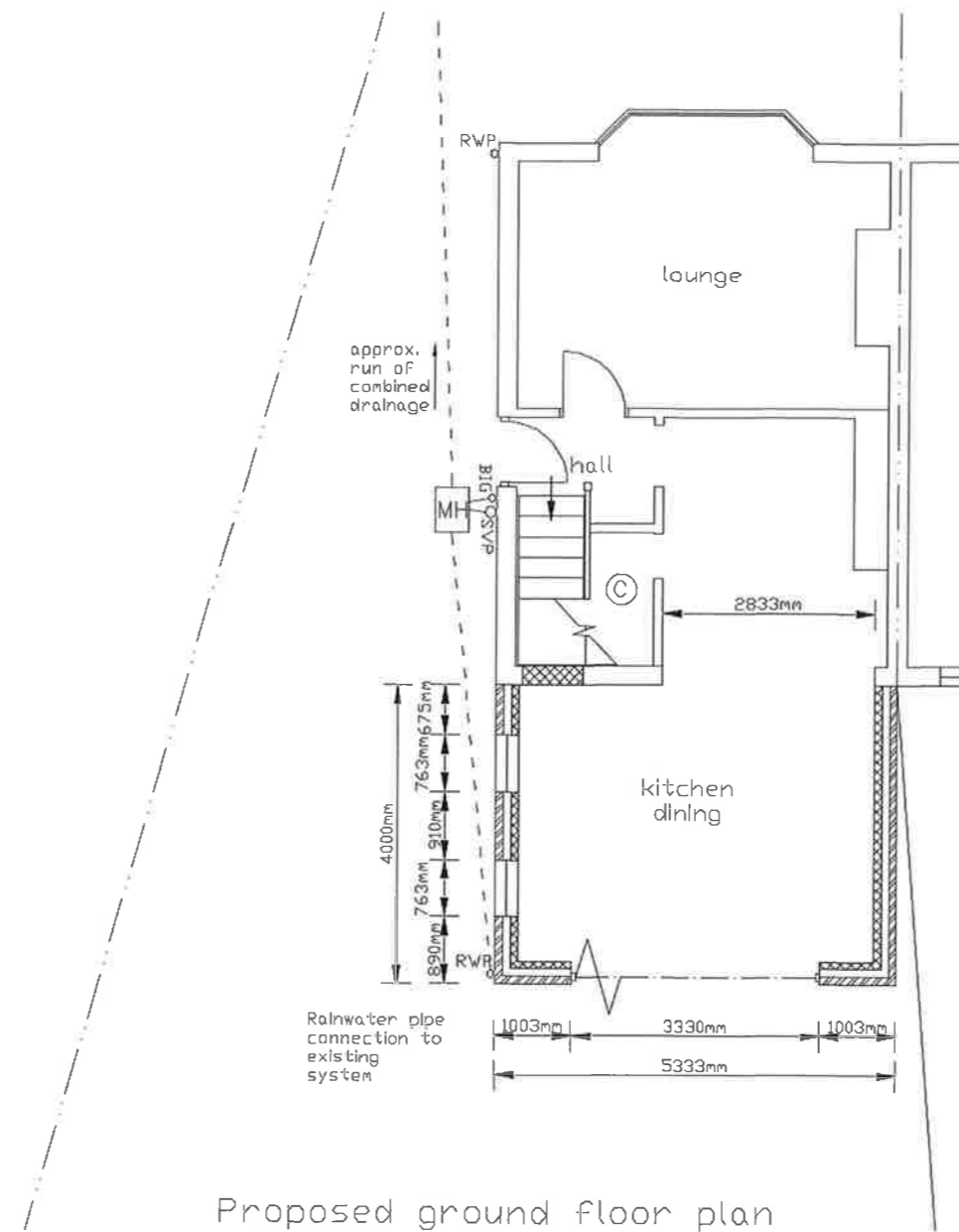

Proposed ground floor plan

Approximately 1930s semi detached dwelling, solid wall construction, with roof and floor joist load to new beams

Dining/kitchen steel beams supporting masonry above, designed by specialist structural engineer, including pier and pad stone construction, calculations supplied to building control with submission of main drawings

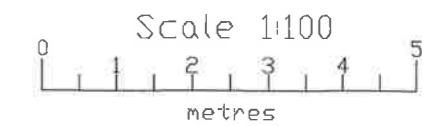

Drawings by  
**ROSCAMP CONSTRUCTION**  
Andrew Roscamp  
01325 481468  
07802 435157

Notes  
1. All dimensions to be verified on site prior to any site works commencing.  
2. Any discrepancies reported to client before any work put in hand.  
3. This drawing must be read in conjunction with relevant consultants and specialist drawings.

NAME	Mr T Burnside
ADDRESS	111 Geneva Crescent Darlington, DL1 4LA
TITLE	Kitchen/dining room rear extension
SCALE/REF	1:100 Drg. 2 of 4 July 20