

DRWG 31 RR 02  
 23/2/21  
 Scale 1:25

Randolph Lane

No 29 Randolph Road Adjacent

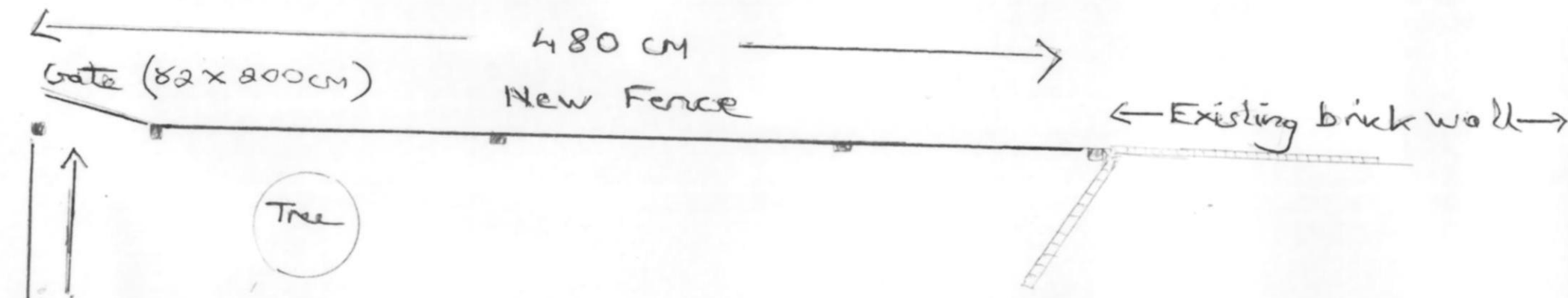

Notes

- Posts at 1m centres 150 x 150 treated white pine.
- Top and bottom rail with 100mm x 18 slats 'hit and miss' on both sides.
- Fence painted with timber preservative.

