

The Highland Council
Development & Infrastructure
APPROVED
16 March 2015

EVOLUTION STORE	
GENERAL NOTES	
INTERNAL COVERS:	60
INTERNAL TABLES:	23
EXTERNAL COVERS:	12
EXTERNAL TABLES:	4
SALES AREA:	106m ²
BOH/WC AREA:	42m ²
TOTAL AREA:	1593ft ²
	148m ²
EXTERNAL AREA:	11.7m ²

ALL INTERNAL BALUSTRADES TO BE EVOLUTION SPEC WITH HORIZONTAL BARS

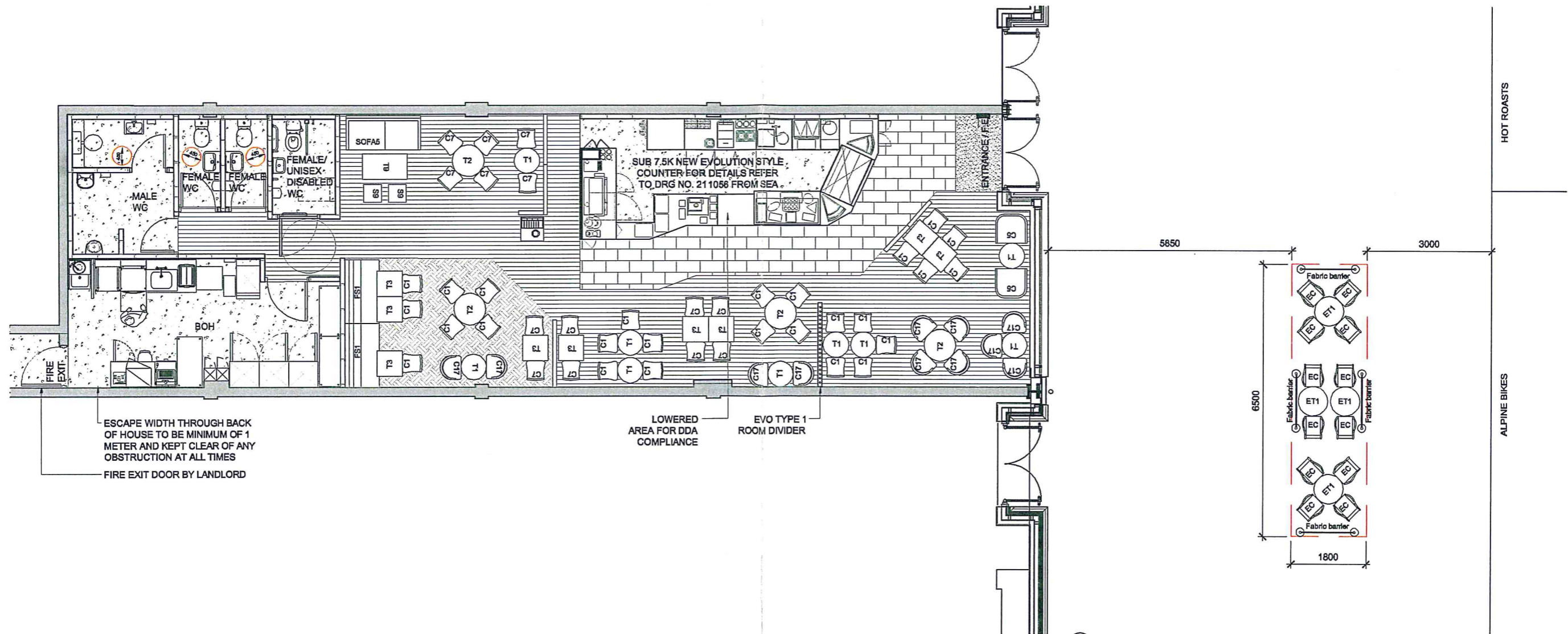

GENERAL LAYOUT SCALE 1:100@A3

THIS DRAWING IS NOT TO BE SCALED, ONLY FIGURED DIMENSIONS ARE TO BE FOLLOWED. CONTRACTORS TO CHECK ALL DIMENSIONS & CONDITIONS ON SITE & REFER ANY DISCREPANCY TO S.G.M MANAGEMENT AND DESIGN LTD. THIS DRAWING IS THE SOLE PROPERTY OF S.G.M MANAGEMENT AND DESIGN LTD., AND MAY NOT BE COPIED OR REPRODUCED IN ANY MANNER WHATSOEVER WITHOUT THE OWNERS CONSENT. © COPYRIGHT

REVISIONS:

- A - SCHEMATIC ISSUE - 04.04.2014 - KG
- B - DEMISE & COVERS INCREASED - 19.05.2014 - KG
- C - FULL PACK ISSUE - 29.05.2014 - KG
- D - DIMS ADDED TO BOH, FIRE EXIT DOOR NOTED AS 'BY LANDLORD' - 10.06.2014 - KG
- E - BOH ESCAPE WIDTH NOTE ADDED - 25.06.2014 - KG
- F - EXTERNAL SEATING RELOCATED & INCREASED AS PER GERALD EVE COMMENTS - 16.07.2014 - KG
- G - BOH & WC'S RELOCATED TO CREATE MORE DIRECT ROUTE TO FIRE EXIT - 24.07.2014 - KG

- H - NEW COUNTER AND BOH UPDATES. NOTE ADDED TO EXTERNAL BARRIERS - 29.10.2014 - BK
- J - EXTERNAL SEATING OMITTED AS PER CM INSTRUCTION - 04.11.2014
- K - EXTERNAL SEATING ADDED IN NEW LOCATION - 02.03.2015 - KG

CLIENT: COSTA COFFEE
PROJECT NUMBER: 13463
PROJECT: UNIT 3B, 94-104 HIGH STREET, FORT WILLIAM, PH33 6DG
DRAWING TITLE: PROPOSED GENERAL LAYOUT
SCALE: 1:100@A3
DRAWN BY: KG
PROJECT MANAGER: RWB
DATE: 31.03.2014

SGM Management & Design Ltd
Architecture Design Project & Value Management
104 HIGH STREET, THAME, OXON, OX9 3DZ.
TEL: 01844 218333 FAX: 01844 218444
sgm.admin@sgm.co.uk
www.s-g-m.co.uk

1.2
K