



APSE BUILDING DESIGN LTD

15 Quantock Drive
Kidderminster
Worcs
DY101RZ
Tel: 01562 743782
Email: apsebuildingdesign@outlook.com

Copyright of this drawing is vested in the Architect and it must not be copied or reproduced without consent. Only figured dimensions are to be taken from this drawing. All contractors must visit the site and be responsible for taking and checking all dimensions relative to their work. Notify the Architect immediately of any variation between drawings and site conditions.

DO NOT SCALE OFF THIS DRAWING - IF IN DOUBT ASK.

All drawings to be read in conjunction with all relevant Structural and M&E Engineers drawings and specifications. It is assumed that all works on this drawing will be carried out by a competent contractor working, where appropriate, to an approved method statement.

No.	Description	Date

CODE	SUITABILITY DESCRIPTION
STATUS	PURPOSE OF ISSUE



PROJECT
PROPOSED SITE PLAN

TITLE
BEWDLEY BUSINESS PARK, LONG BANK, BEWDLEY

CLIENT
BEWDLEY COMMERCIAL CENTRE

DRAWN BY JG	CHECKED BY SG	DATE 02/11/2018
SCALE (@A2) 1 : 500		
DRAWING NUMBER 4028-01B		REV

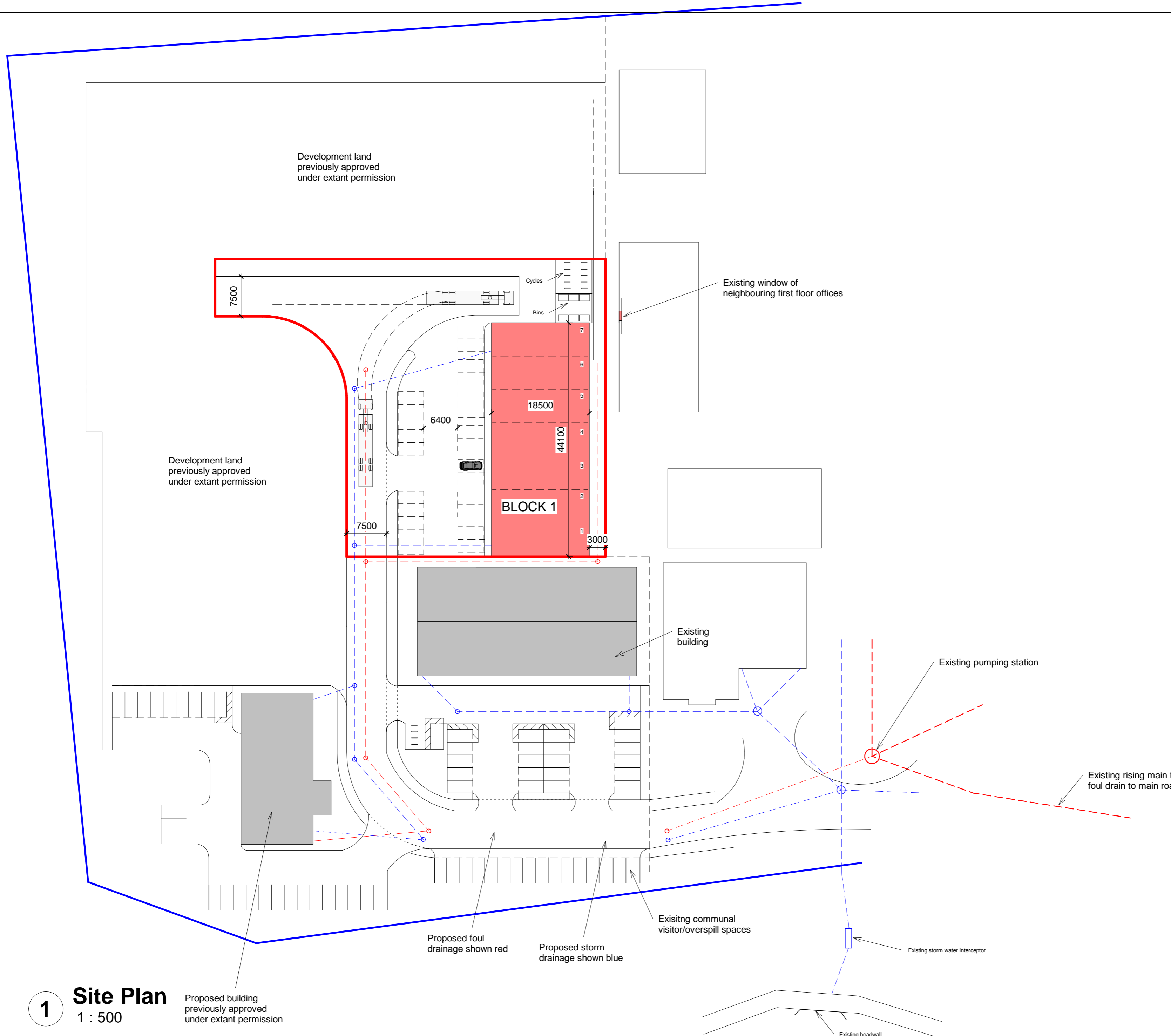

1 Site Plan
1 : 500
Proposed building previously approved under extant permission