

**BASEMENT FLOOR**

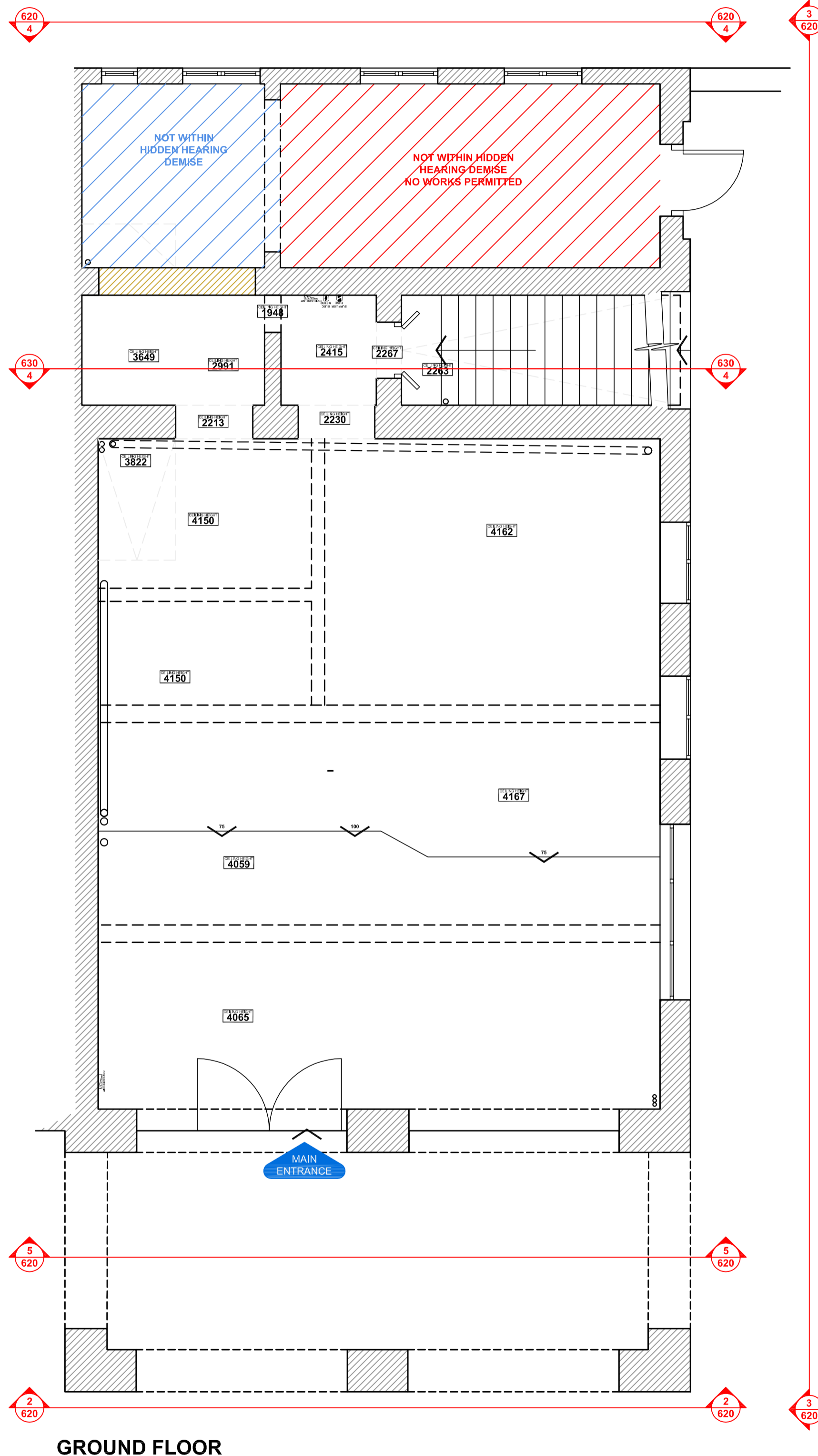

**GROUND FLOOR**

**GENERAL DRAWING KEY**

The below symbols have been used to denote relevant items. Refer to the Standard Details and Schedules for further information.

- Timber Effect Vinyl Flooring
- Barrier Matting
- Vinyl Flooring
- Carpet
- Retained Flooring
- New Acoustic Partition
- New Standard Partition
- Existing Walls/Columns
- New Acoustic Glazing

**FIRE ITEMS KEY**

The below symbols have been used to denote relevant items. Refer to the ceiling schedule and MEP Spec for further details.

- Manual Call Point
- Fire Alarm Panel
- Fire Alarm Sounder with Visual Beacon - Ceiling Mounted
- Fire Alarm Sounder - Ceiling Mounted
- Fire Alarm Sounder with Visual Beacon - Wall Mounted
- Fire Alarm Sounder - Wall Mounted
- Smoke Detector
- Heat Detector
- Carbon Monoxide Detector
- Sprinkler Head
- Fire Blanket
- Photoluminescent Fire Signage
- Emergency Exit Keep Clear Signage
- Fire Extinguisher - Water
- Fire Extinguisher - Foam
- Fire Extinguisher - Carbon Dioxide
- Fire Extinguisher - Powder
- 30 Min Fire rating to all walls, partitions, columns, doors and penetrations on this line
- FX2000 Fire Alarm Panel
- Fire Zone Clip Frame
- Emergency Door Release

**ELECTRICAL AND SERVICES KEY**

The below symbols have been used to denote relevant items. Adjacent 'x1, x2, x3 etc' numbers denote number of sockets. Additional notes clarify location where unclear.

- HL - High Level
- LL - Low Level
- CL - Counter Level
- 2 Compartment Floor Box
- 1 Compartment Floor Boxes
- 2 Gang Socket
- 1 Gang Socket
- Data Socket
- Telephone Socket
- Cat 5 Data Socket
- Cat 6 Data Socket
- TV Aerial Socket
- BT Box
- DP Point
- Door Bell Push
- FPAUD-1 Face Plate
- FPAUD-2 Face Plate
- Master Switch (Last Man Out)
- Emergency Test Switch
- 1 Gang Switch
- 2 Gang Switch
- 3 Gang Switch
- Pull Cord Switch
- Remote Locking Switch
- Fuse Spur
- Occupancy Indicator Switch
- Occupancy Indicator Light
- Alarm Pull Cord
- Alarm Light Signal
- Electrical Trunking
- Indicative Drainage (Dashed at HL)
- Soil Vent Pipe
- Gas Incoming (Dashed at HL)
- Gas Meter
- Water Incoming (Dashed at HL)
- Stop Cock
- Water Meter
- Supplier Fuse (Sealed)
- Electric Meter
- Consumer Unit
- Window Lights Time Switch
- Signage Time Switch
- Thermostat
- Electrical Incoming (Dashed at HL)
- Extract Fan
- Door Release Button
- Wall Mounted AC Cassette
- Emergency Door Release Break Glass
- Door Release Button
- Installation Rail Valve for Watercooler
- Microbore Pipe to Watercooler - Max 5M. Pipe install via Kaflevind, conduit by contractor, if required.

**DISCLAIMER**

All proposals are subject to Fire Officer & Building Control approval. All works to comply with Building Regulations. This drawing is for relevant approvals from the Local Planning Authority only and is not to be used for construction or fabrication. This drawing should only be scaled for planning purposes.

REV	DATE	BY	DESCRIPTION
			<b>PLANNING</b>

**BRANCH NAME:**  
**TEMPLE FORTUNE**

**REFURBISHMENT CATEGORY**  
AQ  
**CONSERVATION STATUS** BRANCH NO  
Grade II Listed XXXX  
Hamstead Garden Suburb Conservation Area  
**DRAWING PREPARED FOR:**

**Hidden Hearing**

**BY:**  
**BELL ASSOCIATES**  
ARCHITECTS/DESIGNERS

**CLIENT**  
Hidden Hearing

**PROJECT**  
788-790 Finchley Road  
Temple Fortune  
NW11 7TJ

**DRAWING**  
Ground and Basement Floor Plans  
Existing

**DRAWING NUMBER** 308-078-610  
**DATE** 01.03.21

**SCALE** 1:50  
**PAPER SIZE** A1

**DRAWN** SLS  
**CHECKED** JEB

E design@bellassociates.co.uk  
T 020 8688 4696  
W www.bellassociates.co.uk

Millgrove House, 77 Farleigh Road, Warlingham, Surrey, CR6 9EJ



Bell Associates is the trading name of Bell Associates Architects Ltd, a limited company registered in England and Wales. VAT registered number 2585874. Where registered office is at Millgrove House, Warlingham, Surrey, CR6 9EJ. All drawings to be verified on site. Unauthorised reproduction of information leads to liability for damages. © 2021