

The Site

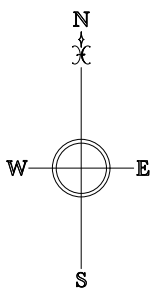
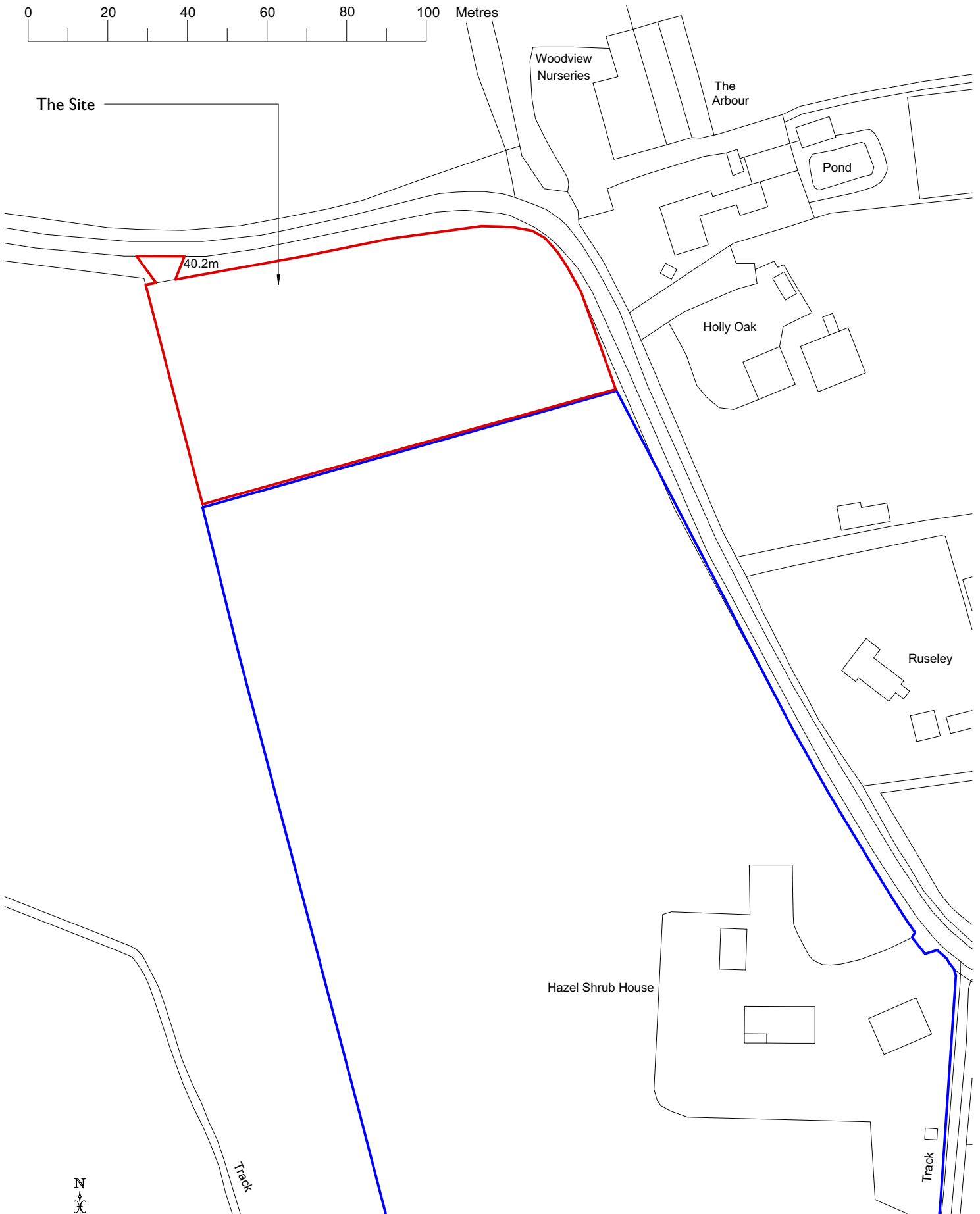

enquiries@rogerbalmerdesign.co.uk	<b>ROGER BALMER DESIGN</b>	Telephone 01206 299477
Client Mr and Mrs Faiers	Project Proposed new dwelling land off Hazel Shrub	Drawing Site Location Plan
Scale 1: 1250 at A4	Date February 2021 Del. MJJ	Drawing no. 7020 - 01
Contractors must verify all dimensions and information on site prior to commencement of work. Do not scale from drawing.		© Roger A Balmer Ltd