

Timber decking is positioned here along the rear boundary fence. The decking is approximately 11.8m long by 3.2m wide. There are timber decking stairs at one side of the decking to gain access. The steps are approximately 1.2m wide with a rise of 150mm and a going of 300mm. There is a balustrade that runs the full perimeter of the decking. This balustrade is 900mm high with no opening greater than 99mm within the full construction of the decking. The actual decking is made up from 200 x 50mm C16 timber joists at 600mm centres that span from back to front and rest on a doubled up 200 x 50mm timbers that span between the timber posts that are at 2200mm centres.

Project	:- Proposed Erection of a Timber Decking		
Address	:- No11 Woodfoot Quadrant, Darnley		
Client	:- Mrs Maria Naqvi		
Dwg Title	:- Proposed Block Plan		
Scale	:- 1 : 100	Dwg No:-	WQ103

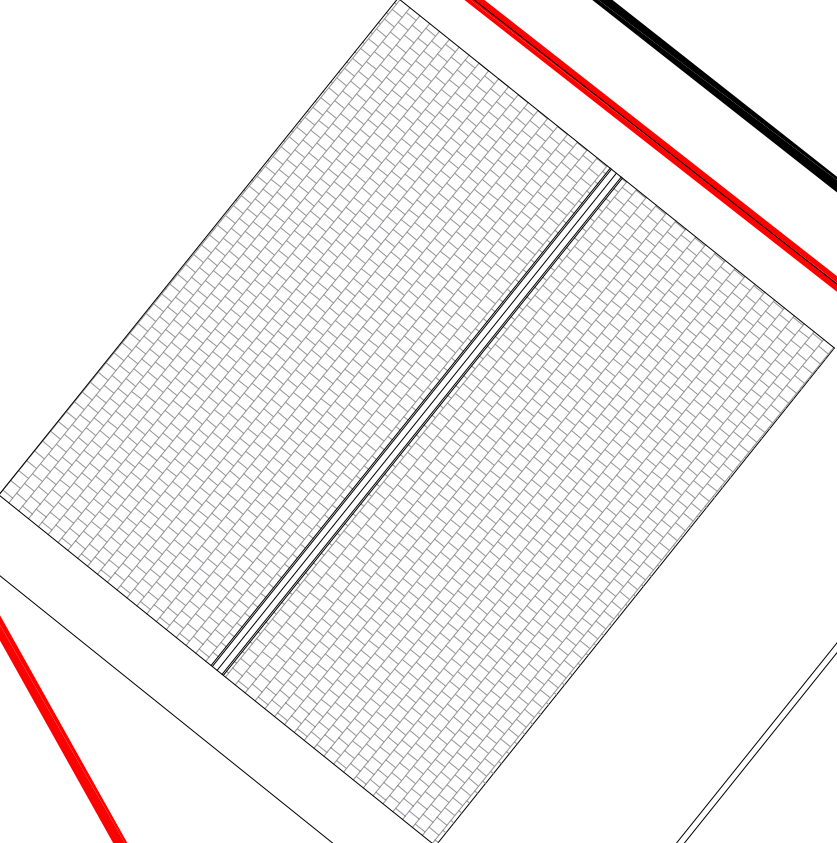
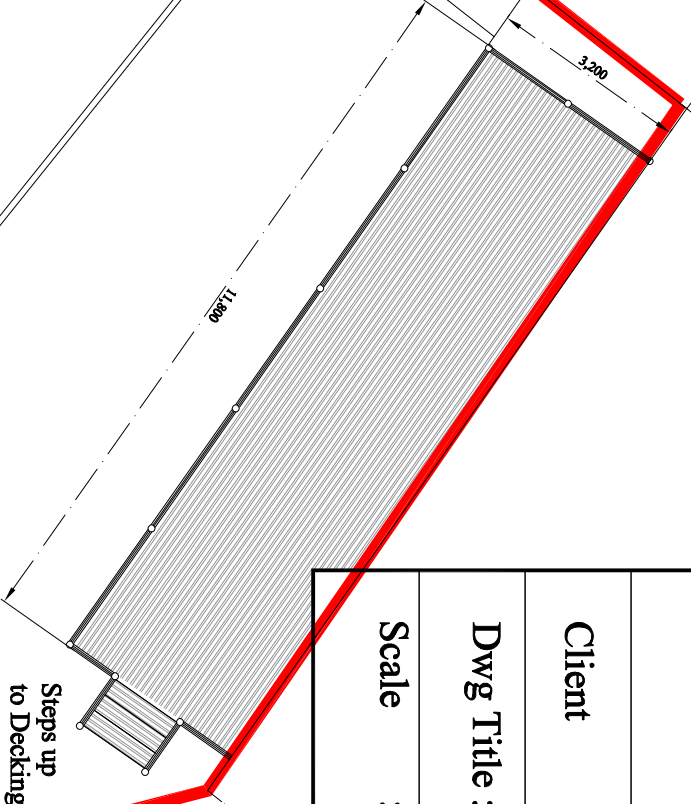

No11

NORTH

0.0m

14.0m