

NOTE
Do not scale from this drawing - all dimensions should be checked on site by the contractor prior to construction and discrepancies notified to the architect immediately.

This drawing should be read in conjunction with the architect's drawings, specification and schedules, and those provided by the other consultants.

No works to be carried out until the appropriate bat licenses and statutory consents are in place.

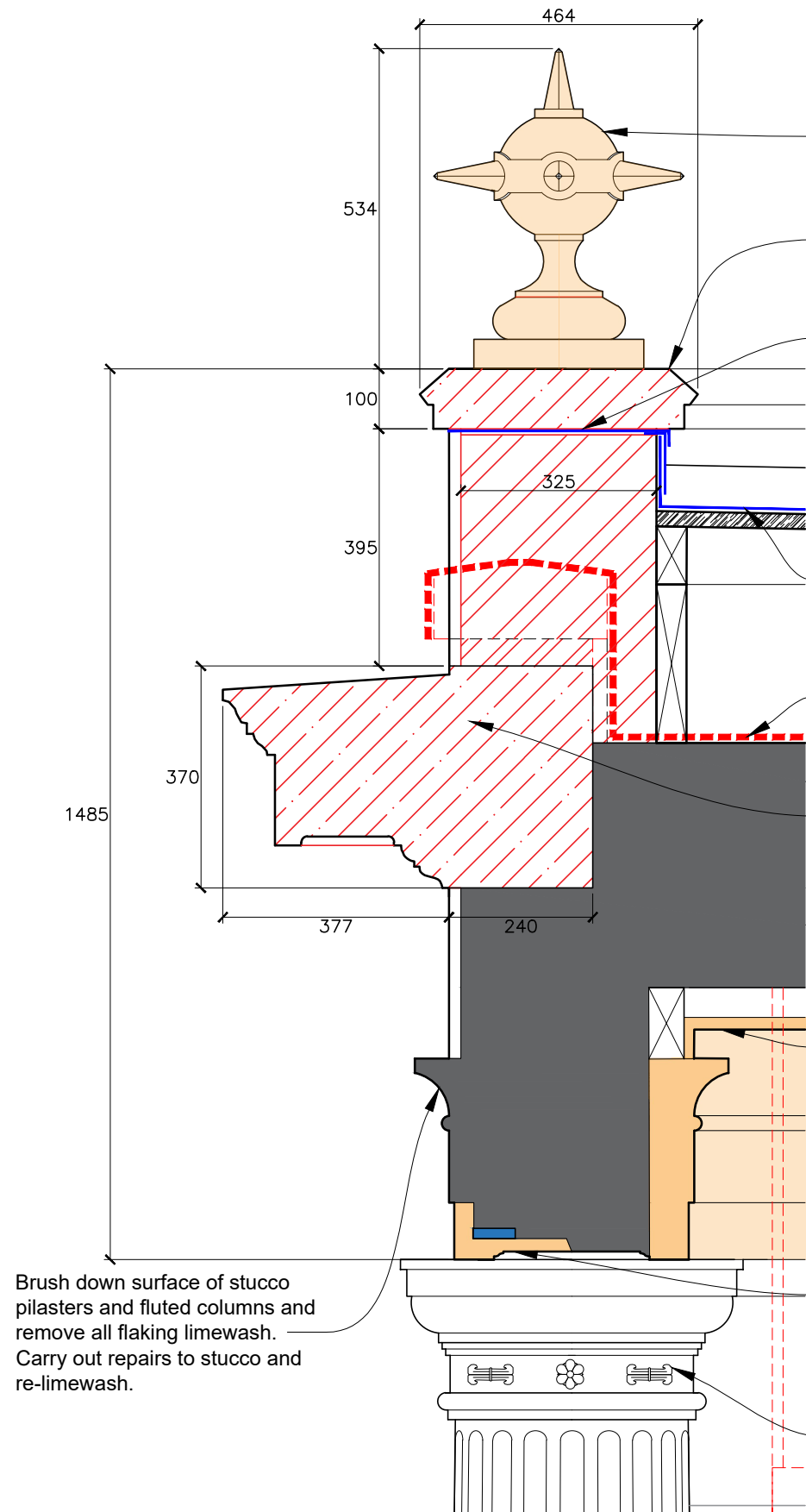

New stone finial with 5no painted hardwood spikes fixed in position with stainless steel pins. Finial and blocking course doweled to cope with stainless steel dowels.

Profile of cope and finial to be confirmed base on physical and documentary evidence. Profiles drawn for pricing purposes only.

Code 6 flashing chased into wall below cill level and under code 6 lead DPC. Lead under cope to include welded sleeve over stainless steel dowel to corner copes

350mm wide code 8 lead gutter on 18mm Airtrax board laid to 1:40 fall. Provisionally fit one 70mm step. 150mm deep sump, with 75mm diameter lead outlet to hopper, and 100wide x 50mm high overflow, all at west end of gutter.

New code 6 lead flat roof, all to LSA recommendation on 18mm Airtrax board on new treated softwood firing pieces, 50mm x 225 joists at 450mm centres. 25mm air gap to be formed on hit and miss timber spacers or Airtrax stainless steel proprietary vent. Stainless steel insect mesh to be fitted to the vent.

Remove existing felt roof and parapet and allow for review of the existing roof structure by conservation architect.

Take down existing non-original brick parapet and stone cope. Fit new limestone cornice based on pattern of cornice on building (scaled to suit dimensions given) and raised brick parapet complete with profiled limestone cope.

Allow for removal of ASBESTOS ceiling by certified contractor and allow for inspection by Conservation Architect. Form new flat lime plaster ceiling on split chestnut laths, provisionally on new softwood battens fixed to the existing roof structure. Fit painted hardwood feature moulding, similar to the existing (which may be contaminated) and run lime plaster cornice to match profile of external architrave, between the top of capital and the ceiling line.

Allow for carefully taking down existing plaster panel to underside of lintol and allowing for inspection of rusting iron plate/angle. Provisionally allow for replacing lintol in galvanised steel with stainless steel expanded metal lathing to underside. Reinstate stucco plaster panel using salvaged plaster and new.

Where missing reinstate wheat sheath and rose plaster enrichments to all column and pilaster capitals.

Brush down surface of stucco pilasters and fluted columns and remove all flaking limewash. Carry out repairs to stucco and re-limewash.

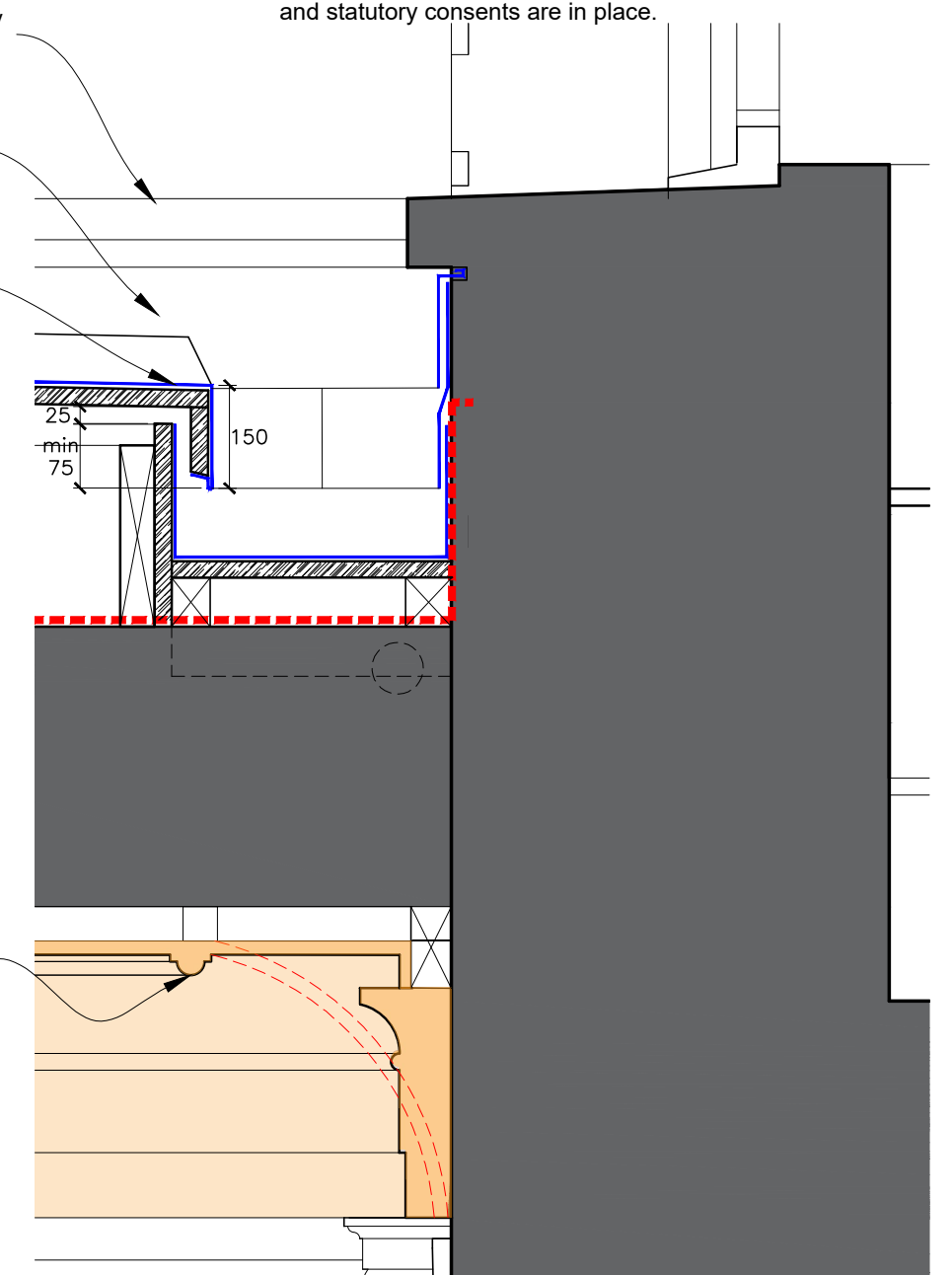

DETAILED SECTION THROUGH ABUTMENT AND NEW GUTTER TO PORTICO (PORCH) - AS PROPOSED scale 1:10

DETAILED SECTION THROUGH FRONT PARAPET OF PORTICO (PORCH) - AS PROPOSED scale 1:10

Simpson & Brown
www.simpsonandbrown.co.uk

The Old Printworks, 77a Brunswick Street, Edinburgh, EH7 5HS
admin@simpsonandbrown.co.uk 0131 555 4678

Architecture Heritage Consultancy Archaeology

JOB TITLE Poltimore House Portico
CLIENT Poltimore House Trust
DWG TITLE Front Sections AA & BB Proposed

A3 SCALE	DRAWN	STATUS	JOB NO.	DWG NO.	REV
1:10	SW	TENDER	1099.02	PPP10	