

DO NOT SCALE DIMENSIONS IF IN DOUBT ASK

Ensure roof tiles conform to required pitch

Verify pitch during construction

Code no 4 lead soaker to be chased into brickwork min 75mm up- standand dressed over tiles 150-200mm to form a watertight seal.

Cavity tray to existing cavity wall.

Marley Ashmore (Old English Dark Red) Interlocking Double Plan Roof Tile with Minimum 77mm Headlap, Minimum Pitch 22.5° on 38mm x 25mm battens on kingspan nilvent breathable membrane on 150mm x 50mm (c16) rafters at max 400mm crs, eaves to be fitted with eaves barrier to prevent uv breakdown of membrane.

Ceiling;  
100mm Quilt insulation in voids and 200mm Quilt insulation above  
12.5mm thick plasterboard to ceiling

UPVC rainwater goods to be fixed to 25mm fascia board @ 900mm crs approx  
As main roof discharges onto extension, **fit deepflow gutters.**

New UPVC 25mm continuous eaves vent

White UPVC windows

Terracotta airbrick  
Weep vent

Lean mix cavity fill at least 225mm below DPC

Ground Floor;  
250x50 SW floor joists at 400mm centres  
Double joists noggins under studwork partitions  
Crown Rocksilk flexible slab insulation 140mm thickness  
22mm thick moisture resistant chipboard floor deck  
**100mm over site concrete on 2000 gauge polythene**  
**25mm sand binding**  
**150mm consolidated hardcore**

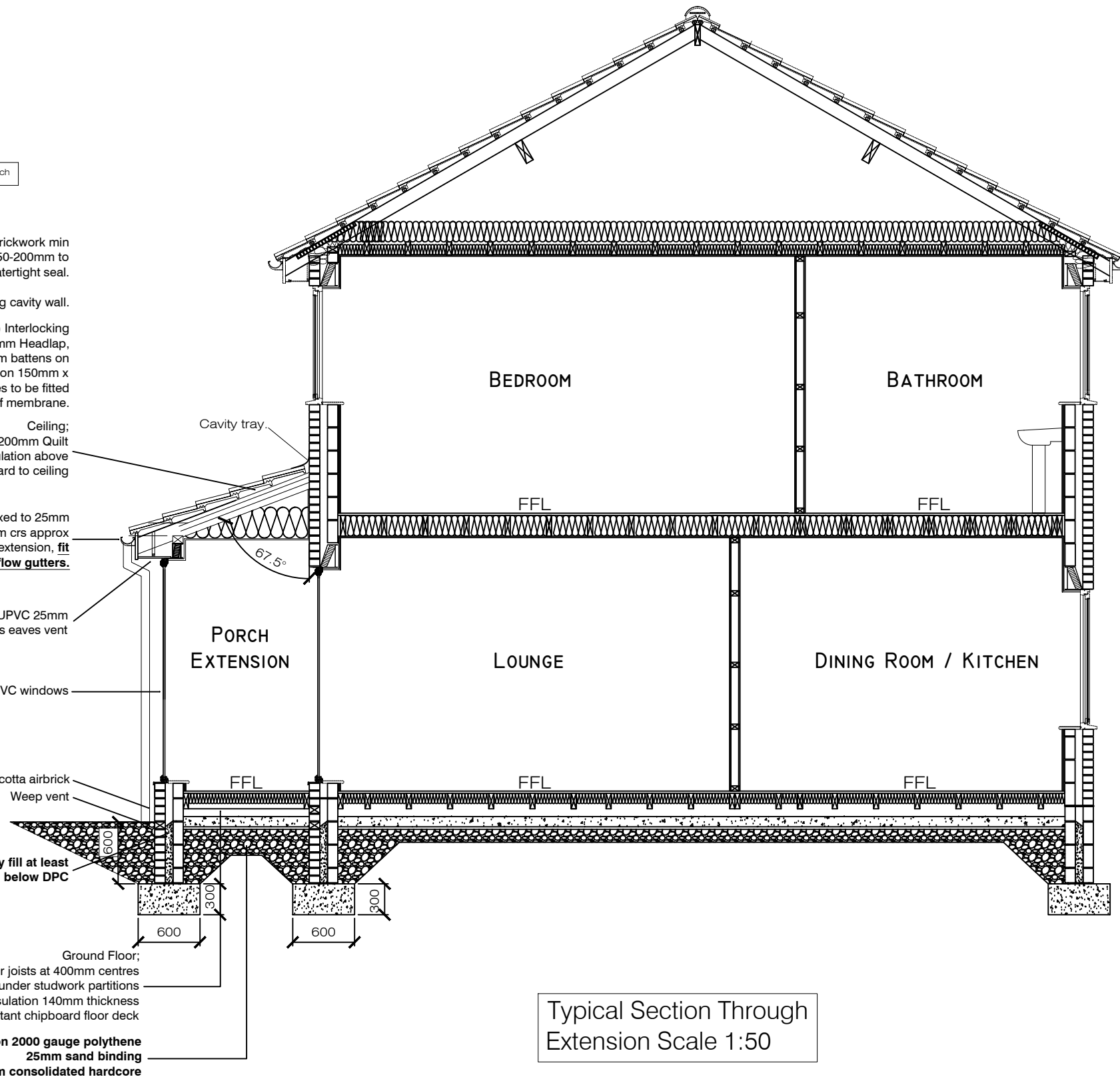

**NOTE**

Electricians must be Part P compliant with full certification that all works are carried out in accordance with BS7671 to be provided, if not Part P credited then separate application to be made through Local Authority Building Control Dept.

**NOTE**

ALL SIZES TO BE CHECKED PRIOR TO COMMENCEMENT OF WORKS

Rev -	Revision Note : -	
PROPOSED ALTERATIONS TO 23 THE BRIARS CASTLETOWN, SUNDERLAND SR5 3DU		Scale 1:50
		Date 10.01.21
Title PROPOSED SECTION		Sheet No. 3 of 7