

ALL DIMENSIONS ARE IN mm UNLESS NOTED OTHERWISE

N.G.R. E: 435969 N: 558136

DIRECTIONS TO SITE:
 FROM A19 TAKE THE A1231 EAST. AT THE SECOND ROUNDABOUT TAKE THE FIRST EXIT ONTO BARONS QUAY ROAD THEN TAKE THE FIRST RIGHT ONTO GRANGE ROAD. AFTER 0.2 MILES THE ROAD NAME CHANGES TO ETHEL TERRACE AND THE SITE IS LOCATED 100M ON THE RIGHT. ACCESS TO THE EQUIPMENT IS THROUGH THE DOUBLE GATES DOWN THE SIDE OF THE FENCE.

NOTES:

REV	A	Issued for Approval	MODIFICATION	BY	CH	DATE
				CDN	JS	27.11.20

WHP Telecoms Ltd
 Faraday Court
 401 Faraday Street
 Brighton Park
 Warrington WA3 8QA
 Tel: 01925 424100 Fax: 01925 424101
 e-mail: info@whptelecoms.com



O₂

CORNERSTONE - BEACON

Cell Name	Opt
HYLTON REDHOUSE	A
Cell ID No	VF
CORNERSTONE	TEF
11419625	34864
	-

Site Address / Contact Details
 RUEBEN PAGE BOOKMAKER (CORAL)
 10 ETHEL TERRACE, CASTLETOWN
 SUNDERLAND
 TYNE & WEAR
 SR5 3BQ

Drawing Title:	SITE LOCATION MAPS
Purpose of Issue:	PLANNING
Drawing Number:	100
Surveys By:	SH
Drawn:	CDN
Date:	27.11.20
Checked:	AS
Date:	27.11.20
Original Sheet Size:	A3
Drawn:	CDN
Issue:	A
Issue:	C

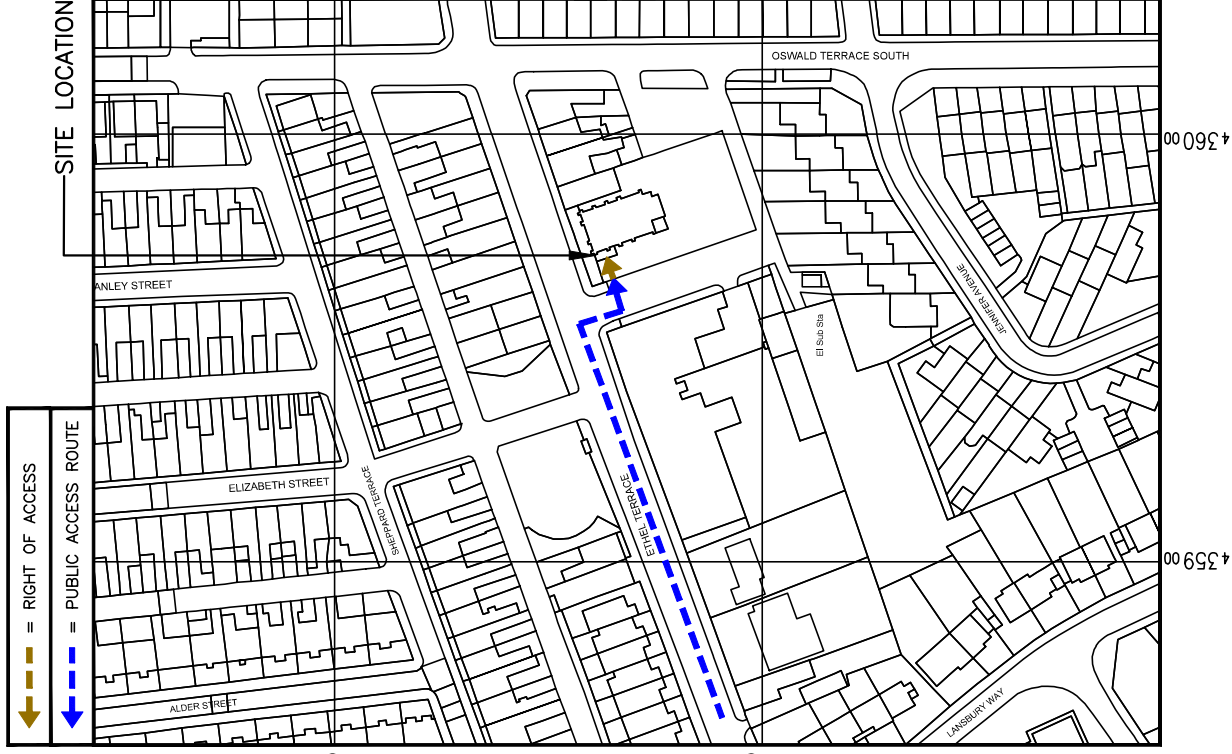

DETAILED SITE LOCATION
 (Scale 1:1250)

Based upon Ordnance Survey map extract with the permission of the Controller of Her Majesty's Stationary Office. Crown copyright. Licence No. 100062043

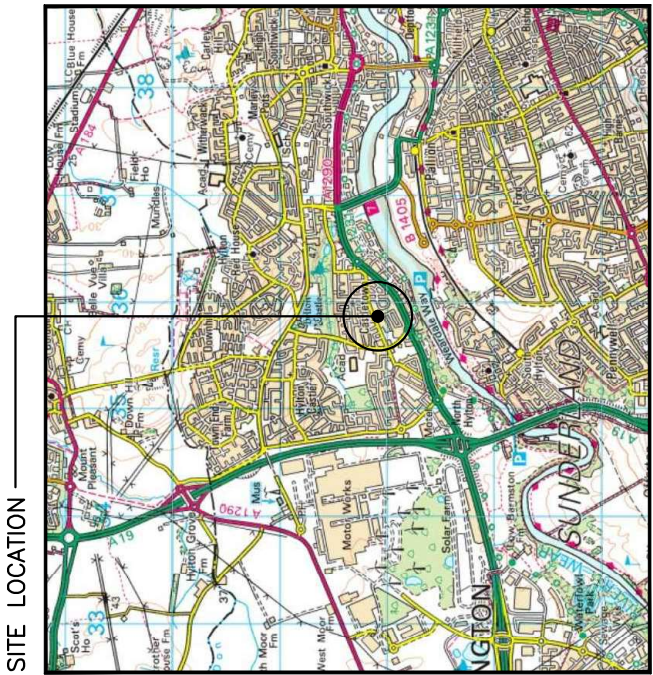

SITE LOCATION
 (Scale 1:50000)

Ordnance Survey map extract based upon Landranger map series with the permission of the controller of Her Majesty's Stationary Office. Licence No. 100022432. Crown copyright.



SITE PHOTOGRAPH

The drawings comply with TEF & VF Standard ICNIRP guidelines. Designed in accordance with Cornerstone documents: UKDBS0700.

ALL DIMENSIONS ARE IN mm UNLESS NOTED OTHERWISE

N.G.R. E: 435969 N: 558136

NOTES:

REV	MODIFICATION	BY	CH	DATE
A	Issued for Approval	CDN	AS	27.11.20

WHP Telecoms Ltd
 Faraday Court
 401 Faraday Street
 Richmond Park
 Warrington WA3 6GA
 Tel: 01925 424100 Fax: 01925 424101
 e-mail: info@whptelecoms.com



O₂
 CORNERSTONE - BEACON

Cell Name
 HYLTON REDHOUSE

Cell ID No
 TEF VF

Site Address / Contact Details
 RUEBEN PAGE BOOKMAKER (CORAL)
 10 ETHEL TERRACE, CASTLETOWN
 SUNDERLAND
 TYNE & WEAR
 SR5 3BQ

Dwg Ref: EXISTING SITE PLAN

Purpose of Issue: PLANNING

Drawing Number: 200

Surveys By: PB

Original Sheet Size: A3

Date: 27.11.20

Checked: AS

Date: 27.11.20

Drawn: CDN

Issue: A

Issue: C

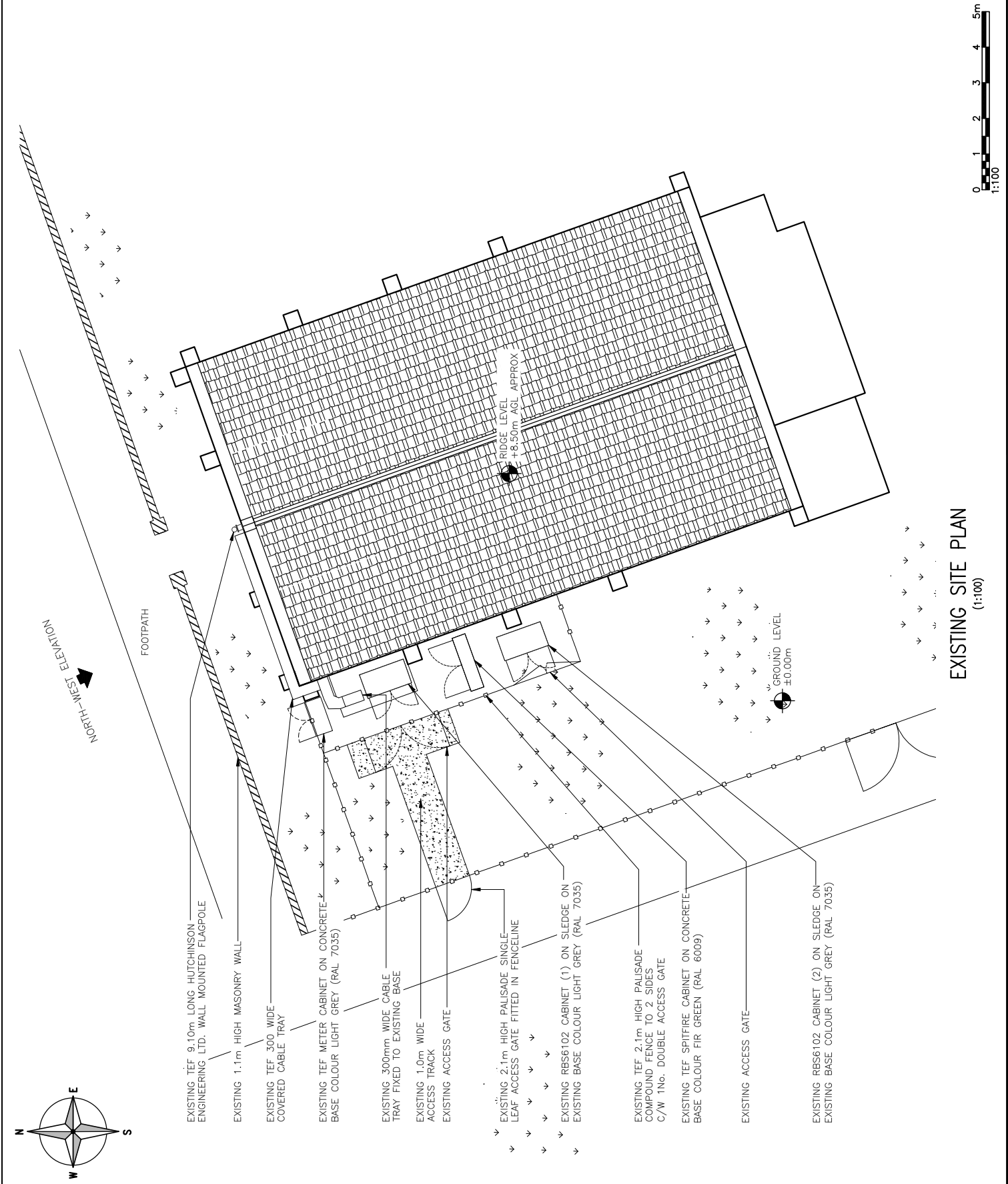

EXISTING SITE PLAN
 (1:100)

ALL DIMENSIONS ARE IN mm UNLESS NOTED OTHERWISE

N.G.R. E: 435969 N: 558136

NOTES:

REV	MODIFICATION	BY	CH	DATE
C	Relocate Proposed Pole of 17.5m High	CDN	AS	29.01.21
B	Compound Demise Area Revised	AS	GH	26.01.21
A	Issued for Approval	CDN	AS	27.11.20

WHP Telecoms Ltd
 Faraday Court
 401 Faraday Street
 Richmond Park
 Warrington WA3 6GA
 Tel: 01925 424100 Fax: 01925 424101
 e-mail: info@whptelecoms.com



O₂

CORNERSTONE - BEACON

Cell Name	Opt
HYLTON REDHOUSE	A
Cell ID No	VF
CORNERSTONE	TEF
11419625	34864
Site Address / Contact Details	
RUEBEN PAGE BOOKMAKER (CORAL)	
10 ETHEL TERRACE, CASTLETOWN	
SUNDERLAND	
TYNE & WEAR	
SR5 3BQ	

Drawing Title:	PROPOSED SITE PLAN
Purpose of Issue:	PLANNING
Drawing Number:	201
Surveyed By:	PB
Drawn:	CDN
Date:	27.11.20
Checked:	AS
Date:	27.11.20
Original Sheet Size:	A3
Drawn:	CDN
Date:	27.11.20
Checked:	AS
Date:	27.11.20
Drawn:	CDN
Date:	27.11.20
Checked:	AS
Date:	27.11.20
Drawn:	CDN
Date:	27.11.20
Checked:	AS
Date:	27.11.20

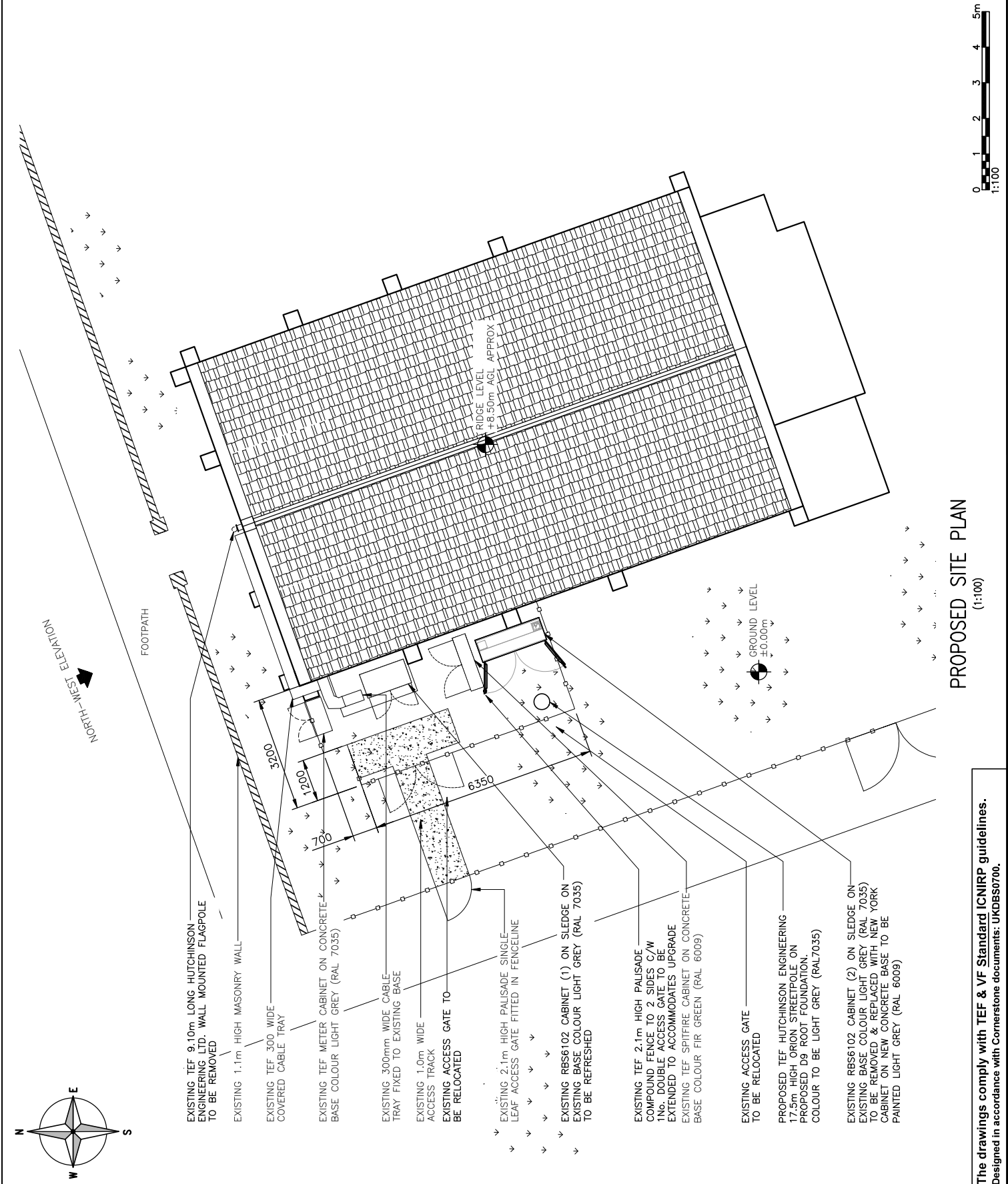

PROPOSED SITE PLAN
(1:100)

The drawings comply with TEF & VF Standard ICNIRP guidelines.
 Designed in accordance with Cornerstone documents: UKDBS0700.

ALL DIMENSIONS ARE IN mm UNLESS NOTED OTHERWISE

N.G.R E: 435969 N: 558136

NOTES:

REV	Issued for Approval	MODIFICATION	BY	CH	DATE
A			CDN	JS	27.11.20



WHP Telecoms Ltd
 Faraday Court
 401 Faraday Street
 Birchwood Park
 Warrington WA3 6QA
 Tel: 01925 424100 Fax: 01925 424101
 e-mail: info@whptelecoms.com

O₂
 CORNERSTONE - BEACON

Cell Name	Opt
HYLTON REDHOUSE	A
Cell ID No	VF
CORNERSTONE	TEF
11419625	34864
Site Address / Contact Details	
RUEBEN PAGE BOOKMAKER (CORAL)	
10 ETHEL TERRACE, CASTLETOWN	
SUNDERLAND	
TYNE & WEAR	
SR5 3BQ	

Drawing Title:	EXISTING EAST ELEVATION
Purpose of Issue:	PLANNING
Drawing Number:	300
Surveyed By:	PB
Original Sheet Size:	A3
Drawn:	CDN
Date:	27.11.20
Checked:	AS
Date:	27.11.20
Drawn:	CDN
Date:	27.11.20
Checked:	AS
Date:	27.11.20
Drawn:	CDN
Date:	27.11.20
Checked:	AS
Date:	27.11.20
Drawn:	CDN
Date:	27.11.20
Checked:	AS
Date:	27.11.20

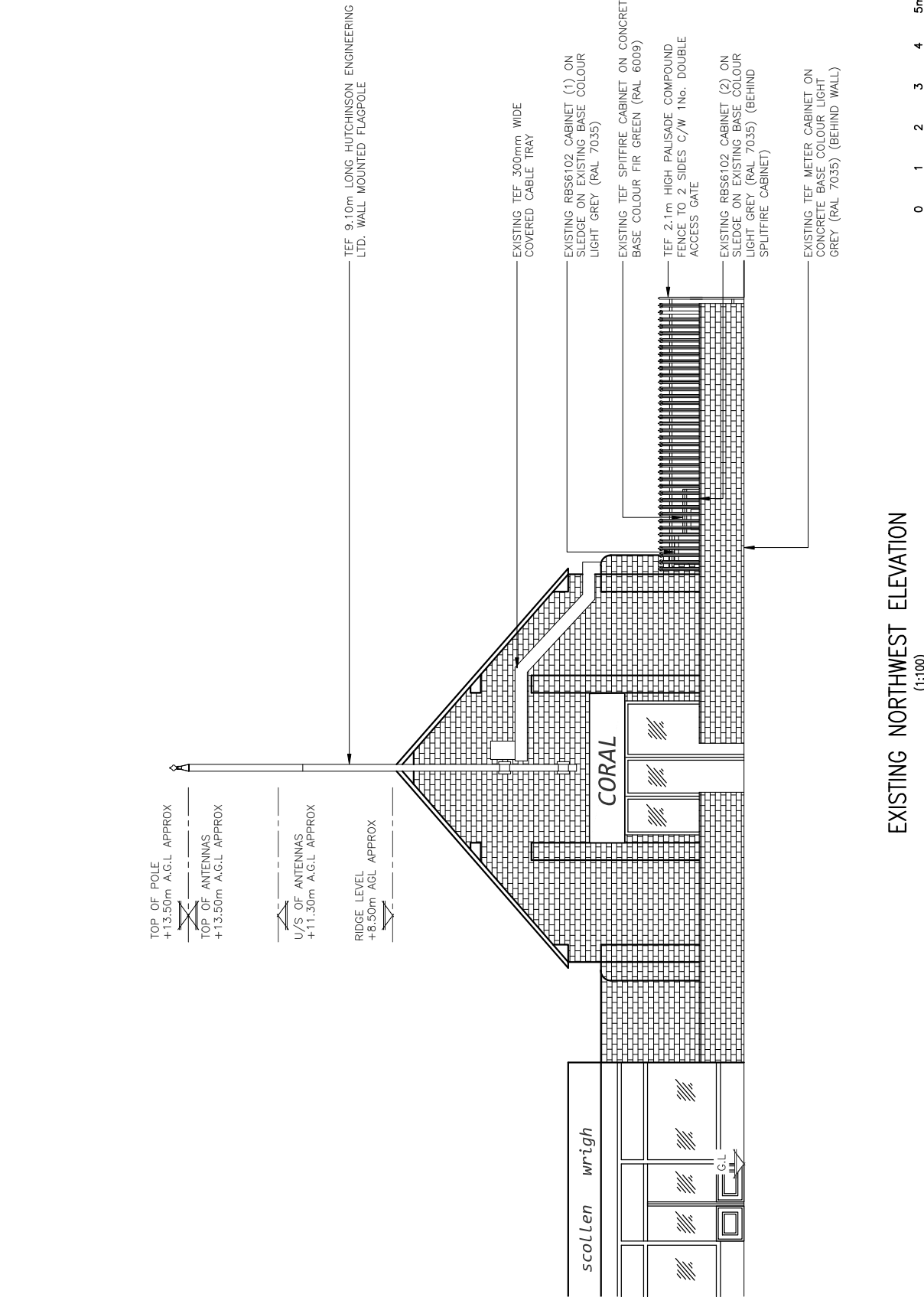

TOP OF POLE
 +13.50m A.G.L. APPROX

TOP OF ANTENNAS
 +13.50m A.G.L. APPROX

U/S OF ANTENNAS
 +11.30m A.G.L. APPROX

RIDGE LEVEL
 +8.50m AGL APPROX

TEF 9.10m LONG HUTCHINSON ENGINEERING LTD. WALL MOUNTED FLAGPOLE

EXISTING TEF 300mm WIDE COVERED CABLE TRAY

EXISTING RBS6102 CABINET (1) ON SLEDGE ON EXISTING BASE COLOUR LIGHT GREY (RAL 7035)

EXISTING TEF SPITFIRE CABINET ON CONCRETE BASE COLOUR FIR GREEN (RAL 6009)

TEF 2.1m HIGH PALISADE COMPOUND FENCE TO 2 SIDES C/W 1No. DOUBLE ACCESS GATE

EXISTING RBS6102 CABINET (2) ON SLEDGE ON EXISTING BASE COLOUR LIGHT GREY (RAL 7035) (BEHIND SPLITFIRE CABINET)

EXISTING TEF METER CABINET ON CONCRETE BASE COLOUR LIGHT GREY (RAL 7035) (BEHIND WALL)

EXISTING NORTHWEST ELEVATION
 (1:100)

ALL DIMENSIONS ARE IN mm UNLESS NOTED OTHERWISE

N.G.R E: 435969 N: 558136

NOTES:

REV	MODIFICATION	BY	CH	DATE
B	Replace Proposed Pole of 17.5m High	CDN	AS	29.07.21
A	Issued for Approval	CDN	AS	27.11.20

WHP Telecoms Ltd
 Faraday Court
 401 Faraday Street
 Birchwood Park
 Warrington WA3 6QA
 Tel: 01925 424100 Fax: 01925 424101
 e-mail: info@whptelecoms.com

O₂
 CORNERSTONE - BEACON

Cell Name	Opt
HYLTON REDHOUSE	A
Cell ID No	VF
CORNERSTONE	TEF
11419625	34864
-	-

Site Address / Contact Details
 RUEBEN PAGE BOOKMAKER (CORAL)
 10 ETHEL TERRACE, CASTLETOWN
 SUNDERLAND
 TYNE & WEAR
 SR5 3BQ

Drawing Title:	PROPOSED SITE ELEVATION
Purpose of Issue:	PLANNING
Drawing Number:	301
Drawn:	CDN
Checked:	AS
Date:	27.11.20
Original Sheet Size:	A3
Drawn:	CDN
Checked:	AS
Date:	27.11.20
Drawn:	CDN
Checked:	AS
Date:	27.11.20
Drawn:	CDN
Checked:	AS
Date:	27.11.20

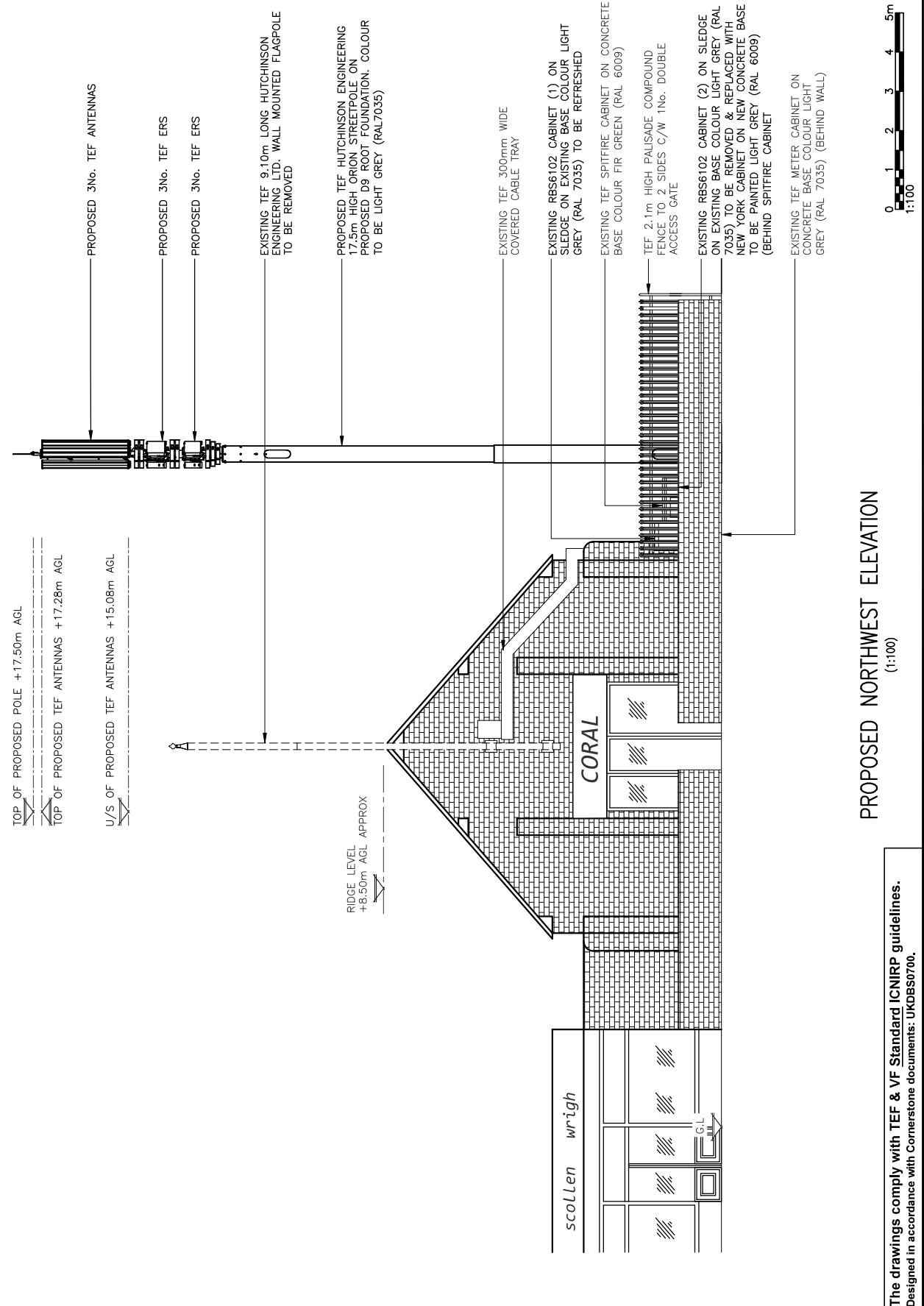

PROPOSED NORTHWEST ELEVATION
 (1:100)

The drawings comply with TEF & VF Standard ICNIRP guidelines.
 Designed in accordance with Cornerstone documents: UKDBS0700.

ALL DIMENSIONS ARE IN mm UNLESS NOTED OTHERWISE
 N.G.R. E: 435969 N: 558136

DUCT KEY

⊖	EXISTING Ø100 POWER
⊖	EXISTING Ø100 TRANSMISSION
⊖	EXISTING Ø150 FEEDER
⊖	EXISTING Ø100 INCOMING*
⊖	PROPOSED Ø100 POWER
⊖	PROPOSED Ø100 TRANSMISSION
⊖	PROPOSED Ø150 FEEDER
⊖	PROPOSED Ø98 FIBRE
⊖	PROPOSED Ø100 POKE-OUT*

*INCOMING AND POKE-OUT DUCTS TO BE COLOURED BY DUCT TYPE (POWER/COMMS/FEEDER)

EXISTING U/G SERVICES KEY

HV	POWER LINE HV
LV	POWER LINE LV
E	POWER LINE UNIDENTIFIED
GLP	GAS LOW PRESSURE
GMP	GAS MEDIUM PRESSURE
GHP	GAS HIGH PRESSURE
PW	POTABLE WATER
FW	FOUL SEWER
CSEW	COMBINED SEWER
SW	SURFACE WATER SEWER
TU	TELECOM
CIV	CABLE
EA	ABANDONED PIPE
?	UNIDENTIFIED

C	Replace Proposed Pole of 17.5m High	CON AS	29/07/21	
B	Compound Demise Area Revised	AS	26/07/21	
A	Issued for Approval	CON AS	27/11/20	
REV	MODIFICATION	BY	CH	DATE

WHP Telecoms Ltd
 Faraday Court
 401 Faraday Street
 Brighton Park
 Worthington WA3 8GA
 Tel: 01925 424100 Fax: 01925 424101
 e-mail: info@whptelecoms.com

O₂
 CORNERSTONE - BEACON

Cell Name	Opt
HYLTON REDHOUSE	A
Cell ID No	VF
CORNERSTONE	TEF
11419625	34864

Site Address / Contact Details
 RUEBEN PAGE BOOKMAKER (CORAL)
 10 ETHEL TERRACE, CASTLETOWN
 SUNDERLAND
 TYNE & WEAR
 SR5 3BQ

Drawing Title	PROPOSED TEF EQUIPMENT LAYOUT	Dwg Ref	
Purpose of Issue	PLANNING		
Drawing Number	400		
Surveyed By	PB	Original Sheet Size:	C
Drawn:	CDN	Check:	AS
Date:	27/11/20	Date:	27/11/20
Issue:		Issue:	C

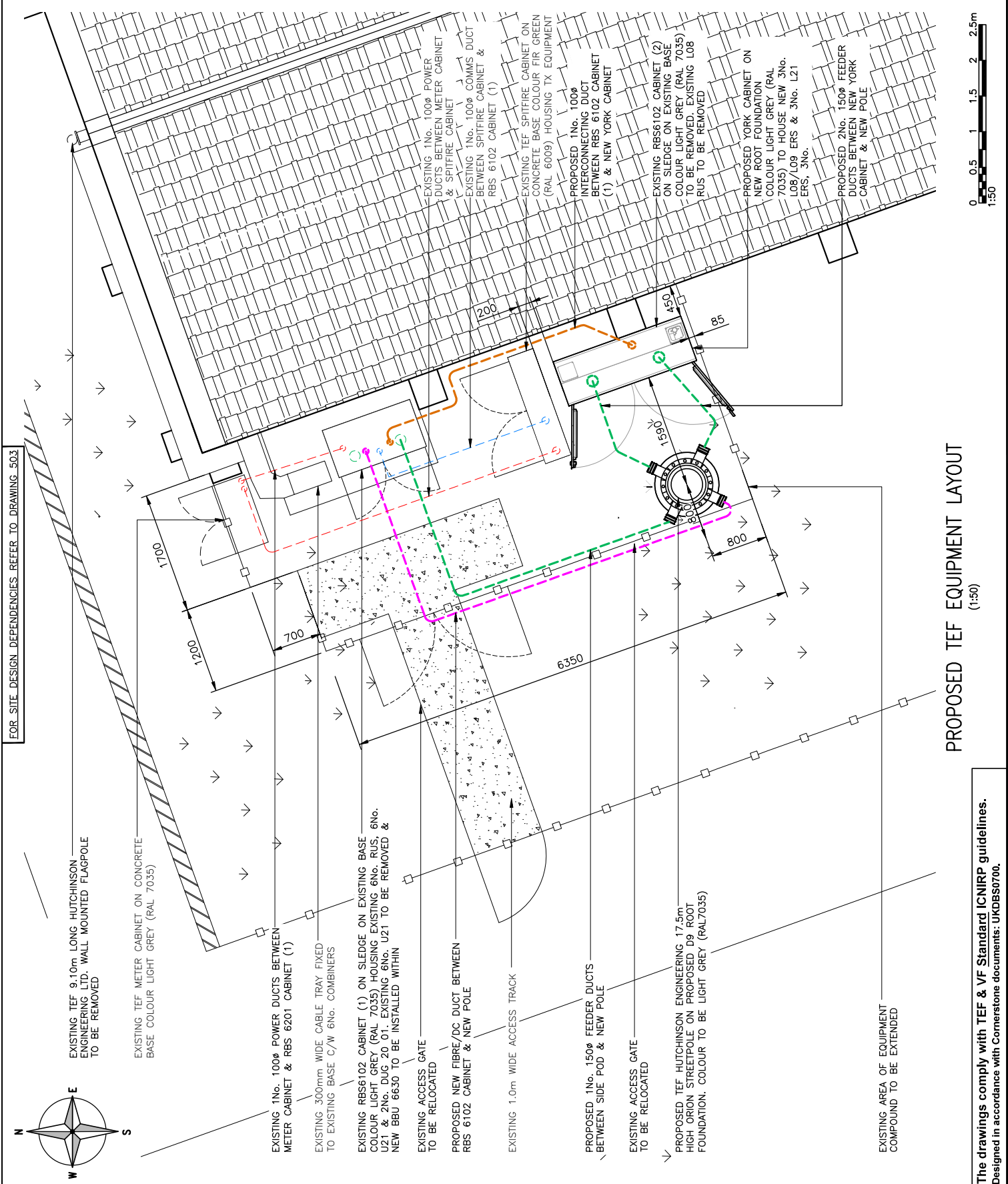

The drawings comply with TEF & VF Standard ICNIRP guidelines.
 Designed in accordance with Cornerstone documents: UKDBS0700.

FOR SITE DESIGN DEPENDENCIES REFER TO DRAWING 503

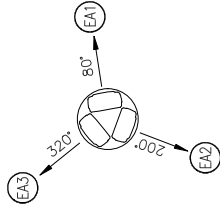
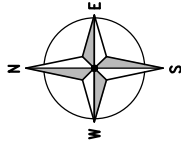

EXISTING TEF ANTENNA PLAN
(1:20)

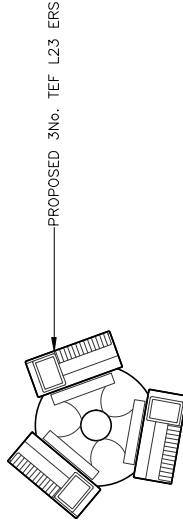

PROPOSED TEF ERS PLAN (LOWER)
(1:20)

PROPOSED 3No. TEF
HUAWEI ANTENNAS ON
NEW ORION POLE (TOP)

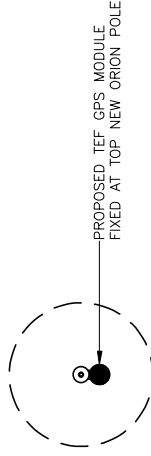

PROPOSED TEF GPS MODULE PLAN
(1:20)

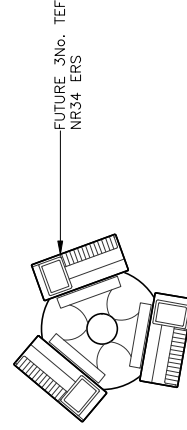

FUTURE TEF ERS PLAN (UPPER)
(1:20)

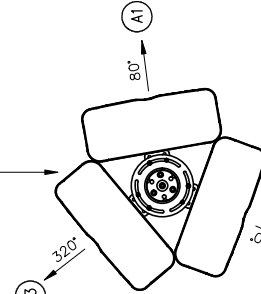

PROPOSED TEF UPPER ANTENNA PLAN
(1:20)

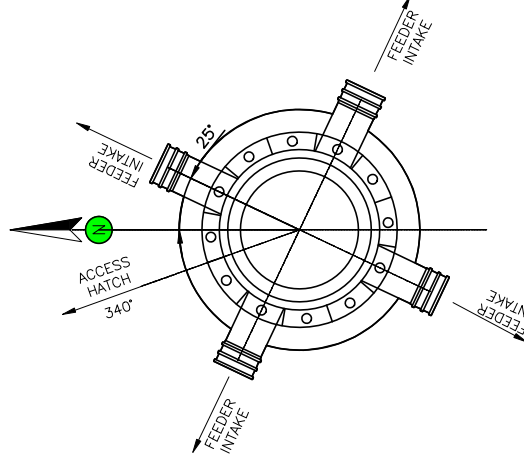

PROPOSED TEF HATCH ORIENTATION PLAN
(1:20)



ALL DIMENSIONS ARE IN mm UNLESS NOTED OTHERWISE

N.G.R E: 435969 N: 558136

NOTES:

REV	MODIFICATION	BY	CH	DATE
A	Issued for Approval	CDN	AS	27.11.20



WHP Telecoms Ltd
Faraday Court
401 Faraday Street
Richmond Park
Warrington WA3 6GA
Tel: 01925 424100 Fax: 01925 424101
e-mail: info@whptelecoms.com

O₂

CORNERSTONE - BEACON

Cell Name	Opt
HYLTON REDHOUSE	A

Cell ID No	VF
------------	----

CORNERSTONE TEF	VF
11419625	34864
-	-

Site Address / Contact Details
RUEBEN PAGE BOOKMAKER (CORAL)
10 ETHEL TERRACE, CASTLETOWN
SUNDERLAND
TYNE & WEAR
SR5 3BQ

Drawing Title:	ANTENNA PLANS
Purpose of Issue:	PLANNING
Drawing Number:	401

Drawn:	CDN	Date:	27.11.20	Checked:	AS	Date:	27.11.20
Surveyed By:	PB	Original Sheet Size:	A3	Drawn:	CDN	Date:	27.11.20
Dwg Ref:		Pack Issue:	A	Drawn:	CDN	Date:	27.11.20

The drawings comply with TEF & VF Standard ICNIRP guidelines.
Designed in accordance with Cornerstone documents: UKDBS0700.