

Mews House:
 GF: 44.2m²
 FF: 76.8m²
 Total: 121.0m²

Typical 4 Bed House:
 GF: 50.2m²
 FF: 48.0m²
 SF: 48.0m²
 TF: 36.0m²
 Total: 182.2m²

Typical 3 Bed House:
 GF: 50.2m²
 FF: 48.0m²
 SF: 48.0m²
 Total: 146.2m²

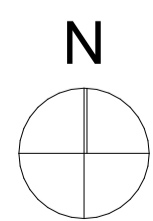
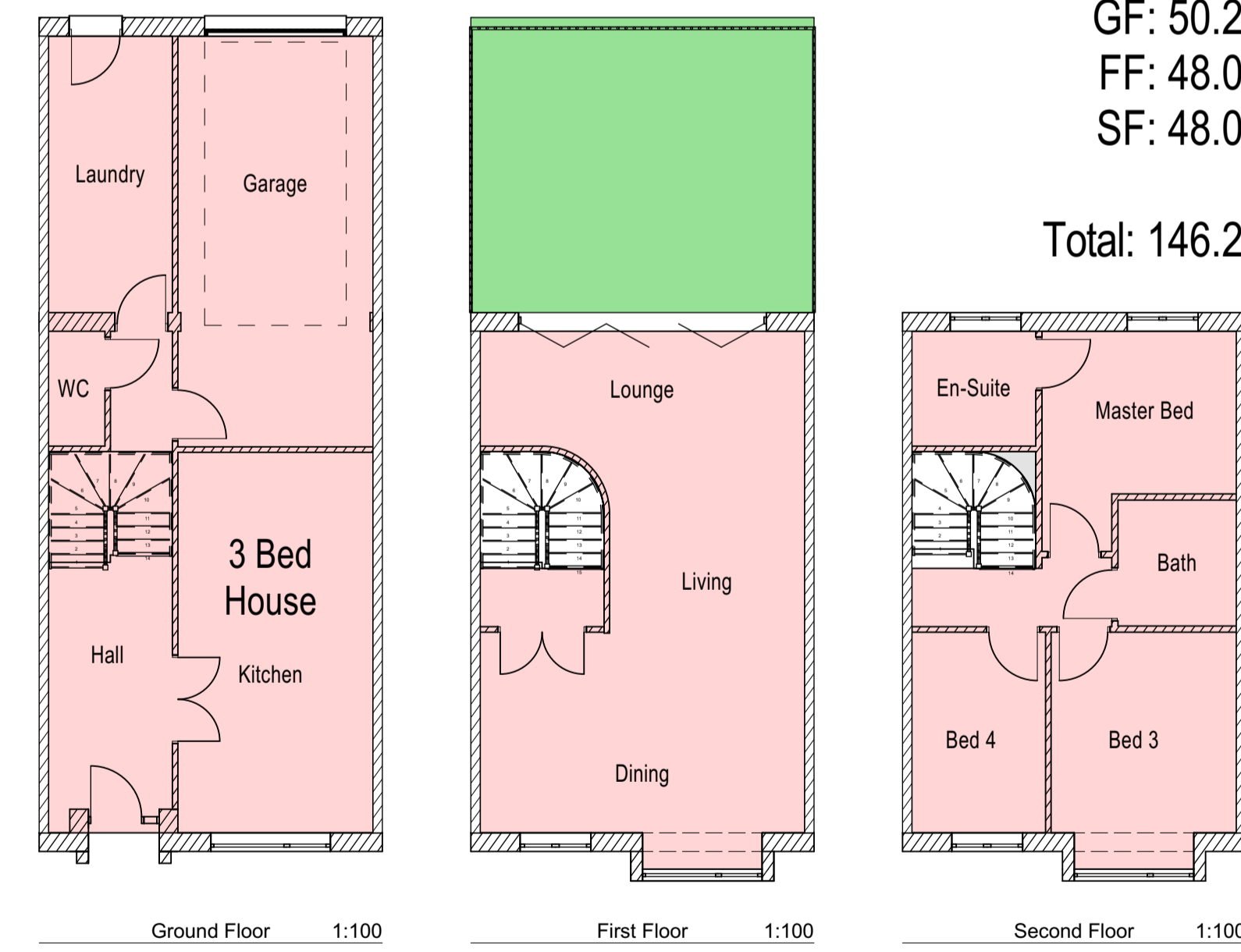
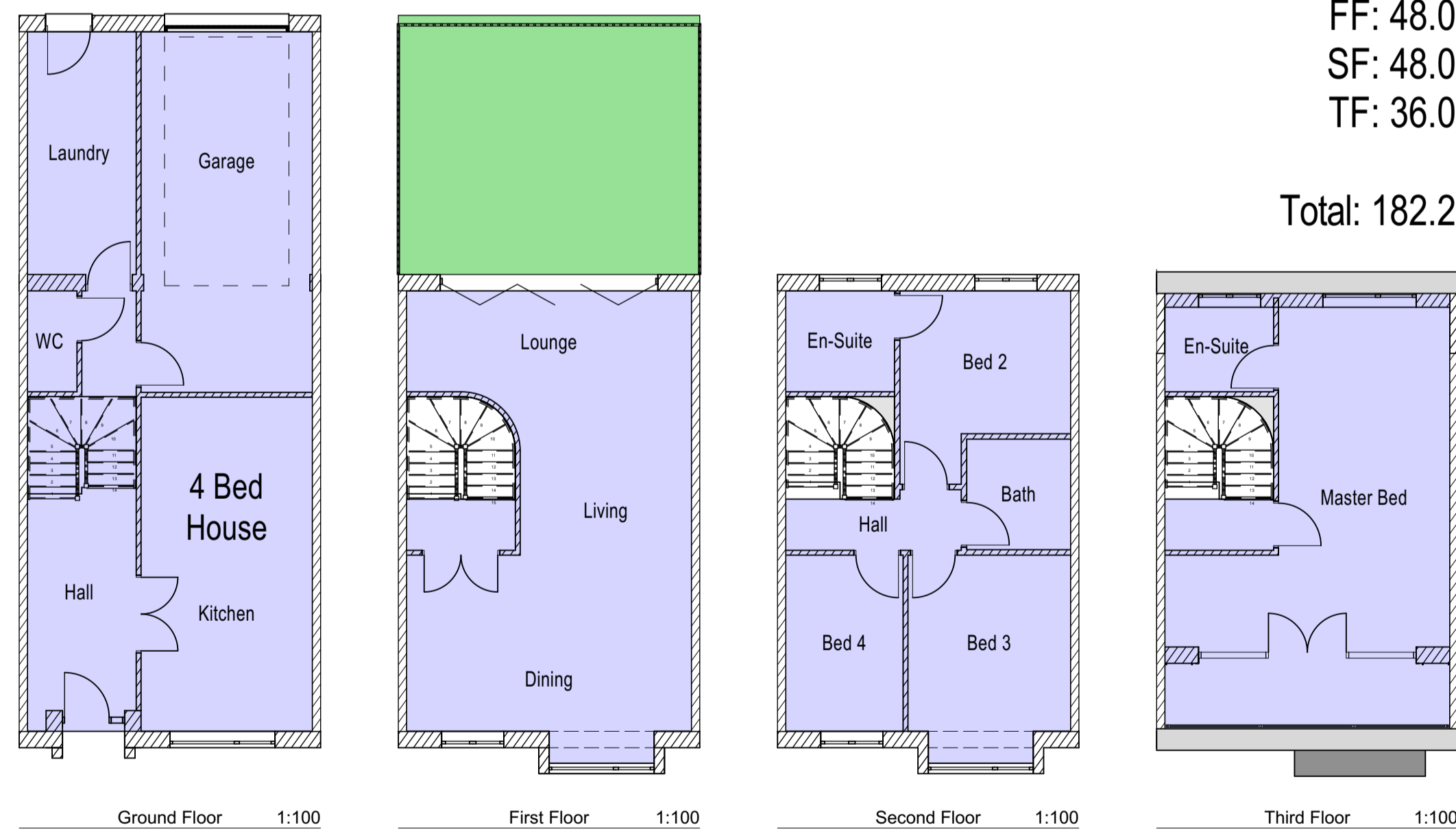

revisions & notes: A | 25-11-2020 | JS | Overall design revised
 B | 11-12-2020 | JS | Planning Application

project: Silver Street
 Southsea
 Portsmouth

drawing name: Typical Floor Plans
 status: Planning Application
 date: 11.12.2020
 scale: 1:100
 drawn: JS



61 South Street, Havant, Hampshire PO9 1BZ
 t: 023 9248 2494 f: 023 9248 1152
 e: design@pwp-architects.com w: www.pwp-architects.com
 Project No. **5293** drawing No. **1500** rev **B**

Note: All dimensions to be checked on site by the contractor before fabrication and erection. Figured dimensions to be taken in preference to scaled dimensions. This drawing is the copyright of the architects and must not be reproduced or used without their express consent, except for the purposes of a planning application. Electronic issue of this drawing to be confirmed by paper hard copy only.