

2^N VELUX WINDOWS 66x118
TYPE FK06 OR SIMILAR FITTED
IN ACCORDANCE WITH MANUFACTURERS
STRICT INSTRUCTIONS

VALLEYS TO BE FORMED FROM
22mm x 225mm EXT PLY LAYBOARDS
WITH CODE 4 LEAD TROUGHS

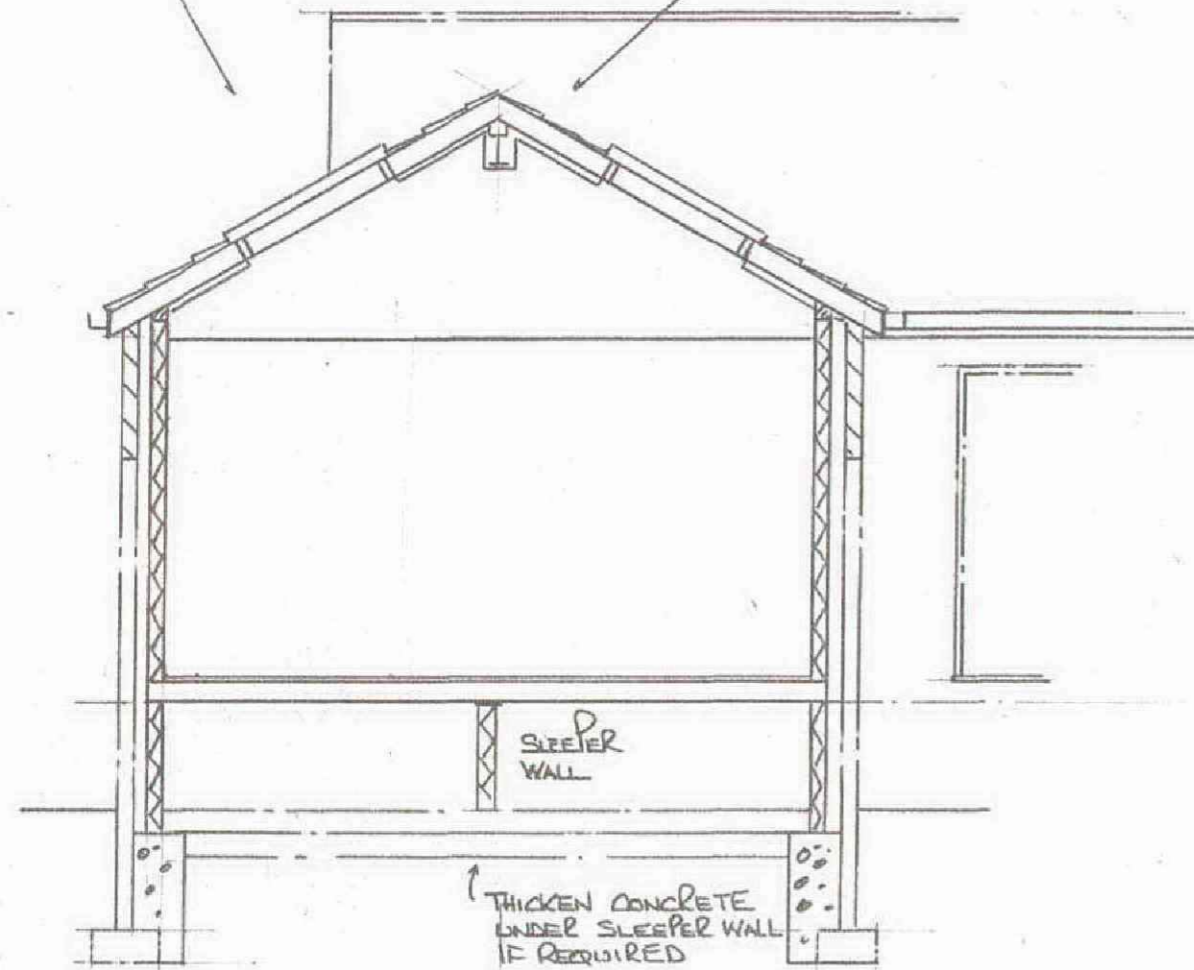

SECTION AA (1.50)

All dimensions and levels to be checked and verified on site, any discrepancies to be reported before work commences.

Regs- The project to which this drawing applies should if applicable be undertaken in full compliance with the CDM regulations (2015) and under the control of a client appointed supervisor. Party wall act- Client to comply with Party Wall Act 1996 and ensure written notification is issued to neighbours prior to commencement of work when carrying out work to a party wall or structure including: Excavations within 3m of an existing structure where the foundations will go deeper than the adjacent foundations, or within 6m of an existing structure where the new foundations are within a 45 degree line of the adjoining foundations.

Support of a beam.

Insertion of a DPC through a wall.

Raising a wall or cutting off projections.

Demolition and rebuilding.

Underpinning.

Insertion of lead flashing.

Legal boundaries to be confirmed by the owner before work commences. The boundaries shown are believed to be accurate, but it is the responsibility of the parties sharing the boundaries to agree the position before the work commences, as neither the agent nor the builder can be held responsible for establishing the boundaries. No part of the construction or work should cross the boundary without the written authority from the adjoining owner.

An explanatory booklet can be obtained free of charge from www.gov.uk/party-wall-etc-act-1996-guidance.

Foundations- 225mm x 600mm concrete foundation, concrete mix to conform to BS EN 206-1 and BS 8500-2. Min concrete grade GEN1 (unreinforced), RC30 (reinforced). All foundations to be a min of 1000mm below ground lvl, exact depth to be agreed on site with Building Control Officer to suit site conditions. All constructed in accordance with 2004 Building Regulations A1/2 and BS8004:1986 code of practice for foundations. Ensure foundations are constructed below invert lvl of any adjacent drains. Depth to be no less than foundation to existing dwelling. Base of foundations supporting internal walls to be min 600mm below ground lvl. Sulphate resistant cement to be used if required. Please note that should any adverse soil conditions be found or any major tree roots in excavations, the Building Control Officer is to be contacted and the advise of a structural engineer should be sought.

Note. Foundation for new inner leaf as shown on section.

Wall construction- 102.5mm facing bwk to match and be consistent with existing, 100mm cavity filled with 100mm crown Dritherm batts, 100mm thermalite blockwork inner leaf faced with 12.5mm plasterboard and skim on dot and dabs to achieve U value of 0.28w/m2k, sec eng bwk below dpc lvl with weak mix concrete cavity fill to min 225mm below dpc lvl or use concrete foundation blocks. S/S ties @ 5/sqm and 225mm vertical to unbonded jambs. All reveals, heads and cills to be insulated with thermabate cavity closes. All bwk and blockwork to be suitably bonded to existing(toothed every other brick or use furfix or similar approved profiles). All cavities to be continuous and min external returns to be 665mm.

Dpc- to be 2000g to walls min 150mm above g/f lvl, vertical dpc's and weather checks to all to all external openings.

A/B's- to be 225x75mm with cavity liners and tray dpc over, A/B's to be @ max 1500crs and min 450mm from corners.

Ground floor construction-47mm x 120mm C24 grade joists @ 400crs boarded with 22mm floor quality boards, 120mm celotex material laid between joists on polypropylene netting with min