

Existing Ground Floor Plan

CANOPY COOKER 1000 X 4000 mm
 400 X 400 mm STAINLESS STEEL HOOD WITH 4 No. WASHABLE GREASE FILTER
 600 X 600 mm CARBON FILTER UNIT WITH PRE-FILTER UNIT
 MOTOR MODEL 102 H2 WL/4 MOTOR TO HAVE ANTI-VIBRATION MOUNTS WHERE MOUNTED TO BUILDING STRUCTURES AND TO BE HOUSED IN AN ENCLOSED CHAMBER FOR MINIMUM NOISE

TYPE: PERMANENT SPLIT CAPACITOR, VENTILATED ENCLOSURE. SPEED: 4 POLE APPROX 1400 REV/M
 400 DIA EXTRACTION FLUE FITTED ON WALL WITH ANTI-VIBRATION BRACKETS AND DISCHARGING AT LEAST 1000 ABOVE HIGHEST WINDOW HEAD

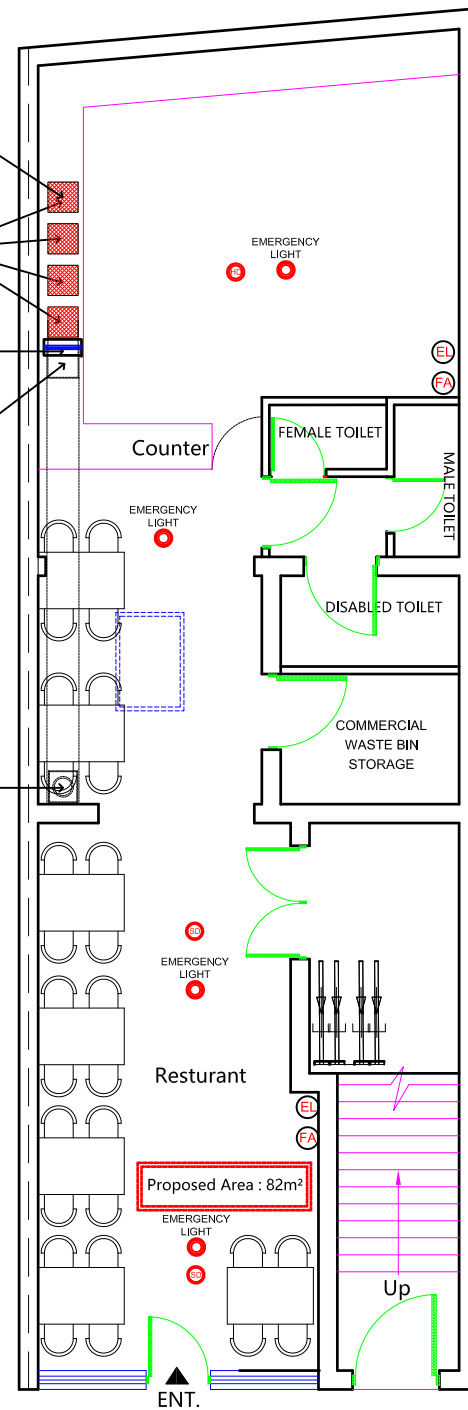

Proposed Ground Floor Plan

FAN UNIT:
 MANUFACTURER : HELIOS
 MODEL : GBW500/4/1
 DIMENSIONS : 670x670x670MM OVERALL
 620x620MM INSIDE FRAME
 MOTOR RATING : 1.38KW
 SUPPLY : 240/50/1 PHASE
 FULL LOAD CURRENT : 6.4 AMPS
 BREAKOUT NOISE : 45DB (A) AT 4M
 1.57 M3/S @ 200 PA
 1.57 M3/S @ 350 PA
 SPEED CONTROLLER : TSW 7.5

SELF-CONTAINED SMOKE ALARM TO BE INTERLINKED & MAIN OPERATED WITH BATTERY BACK TO BS5446 INSTALLED IN ACCORDANCE WITH BS 5839 PART1
 HEAT DETECTOR TO BS 5839
 FIRE ALARM CALL POINT TO BS 5839
 ALL AREAS COVERED BY AUTOMATIC FIRE DETECTORS AND FIRE ALARM CALL POINTS ARE TO BE INSTALLED IN ACCORDANCE WITH BS 5839 PART1
 ANY EXISTING STEEL BEAMS TO BE PROTECTED BY 20MM VERMICULUX FIRE PROTECTION BOARD OR SIMILAR TO ACHIEVE 1HOUR FIRE RATING.
FIRE EXIT
 SIGNAGE TO BE PROVIDED (ILLUMINATED) AT TOP LEVEL OF THE DOORS & WHERE MOST SUITABLE AND DIRECTING THE NEAREST EXIT.
 BATTERY BACKUP EMERGENCY LIGHT TO BS5266

NOTES
 1-STAINLESS STEEL CANOPY, LENGTH: 4000 MM , WIDTH 900 MM, DEPTH 600 MM WITH GREASE FILTERS.
 2-500 MM DIAMETER DUCTING
 3-SINGLE 500 WOOD'S CASED FAN; SOUND LEVEL: 75 DBA AT 3 METERS PERFORMANCE: 3 CUBIC METERS PER SECOND AGAINST 340 PA
 4-SILENCER TO CUT DOWN 8 DBA
 5-CARBON FILTER UNIT FOR THE ODOURS
 6-SPEED CONTROL UNIT ME 1,12

PROJECT ADDRESS
 59 BURDETT ROAD
 LONDON
 E3 4TN

DWG TITLE
 EXISTING AND PROPOSED PLANS

| SCALE | DATE | DWG # | ISSUE | DRAWN BY |
|----------|------------|--------------|-------|----------|
| 1:100@A3 | 10/02/2021 | N.A/59BR/201 | A | AA |

PARTY WALL NOTICES:
 PLEASE NOTE THAT BEFORE BUILDING WORKS COMMENCES IT IS THE RESPONSIBILITY OF BUILDER OR OWNER TO SERVE PARTY WALL NOTICES TO ALL NEIGHBOURS.

DIMENSIONS:
 ALL DIMENSIONS TO BE CHECKED ON SITE. CONTRACTOR TO VERIFY ALL BOUNDARY POSITIONS AND DIMENSIONS ON SITE PRIOR TO COMMENCING ANY WORKS, MAKING WORKMANSHIP DRAWINGS OR OBTAINING ANY MATERIALS. DO NOT TRACE OR COPIED FROM THIS DRAWING. DIMENSIONS STATED ARE FOR GUIDANCE ONLY.

NOTES: THIS DRAWING IS COPYRIGHT AND MUST NOT BE TRACED OR COPIED IN ANY WAY OR FORM IN PART OR WHOLE BY ANY MEANS WHATSOEVER WITHOUT PRIOR WRITTEN CONSENT AND MAY ONLY BE USED BY THE PRESENT OWNER IN RELATION TO THE PROPERTY AS REFERRED TO ON THE DRAWING. THIS DRAWING MAY BE COPIED BY AN AUTHORISED OFFICER OF THE LOCAL AUTHORITY WITH THE SOLE PURPOSE TO ASSIST IN THE DETERMINATION OF A PLANNING OR BUILDING REGULATIONS APPLICATION AND MAY NOT BE USED FOR ANY OTHER PURPOSE UNLESS OTHERWISE AGREED IN WRITING.

THE USE OF PERMITTED DEVELOPMENT RIGHT IN PROPERTY IS SUBJECT TO INFORMATION PROVIDED BY OWNER REGARDING THE STATUS OF PROPERTY AS A DWELLING HOUSE AND THE DWELLING NOT BEING IN A CONSERVATION AREA. ANY DEVELOPMENT WITH OUT A CERTIFICATE OF LAWFULNESS OR PLANNING PERMISSION IS SOLELY AT OWNER'S RISK.
 AFTER CONFIRMATION FROM LOCAL AUTHORITY THAT PRIOR APPROVAL IS NOT REQUIRED, IT MUST BE ENSURED THAT THE PROPOSED EXTENSION COMPLIES WITH ALL OF THE CRITERIA SET OUT WITHIN THE TOWN AND COUNTY PLANNING (GENERAL PERMITTED DEVELOPMENT) ORDER 1995 SCHEDULE 2, PART 1, CLASS A. AND NOTIFIES TO LOCAL COUNCIL ONCE DEVELOPMENT COMPLETED.
 IT IS STRONGLY RECOMMENDED TO APPLY FOR A CERTIFICATE OF LAWFULNESS FOR A FORMAL CONFIRMATION.

- = 30 MINUTE FIRE RESISTING DOOR AND FRAME
- = EMERGENCY LIGHTING TO BS5266: Part 1 1988
- = HEAT DETECTOR
- = SMOKE DETECTOR WITH SOUNDER



CLIENT
 MR. KASHIF JAVAID

SMART SKILLS LTD
 info@smartskillsltd.co.uk

NAQSHARCH
 Address: 30 UPHALL ROAD,
 ILFORD, IG1 2JF
 TEL: 020 3489 3287
 Mobile: 07931 176 907

