



Shadow Analysis Booklet

Proposed Garage

11 Scotsmill View

Blackburn

AB21 0FZ

JWD 2304

# Shadow Analysis

11 Scotsmill View, Blackburn

Proposed Shadow Fall in Summer

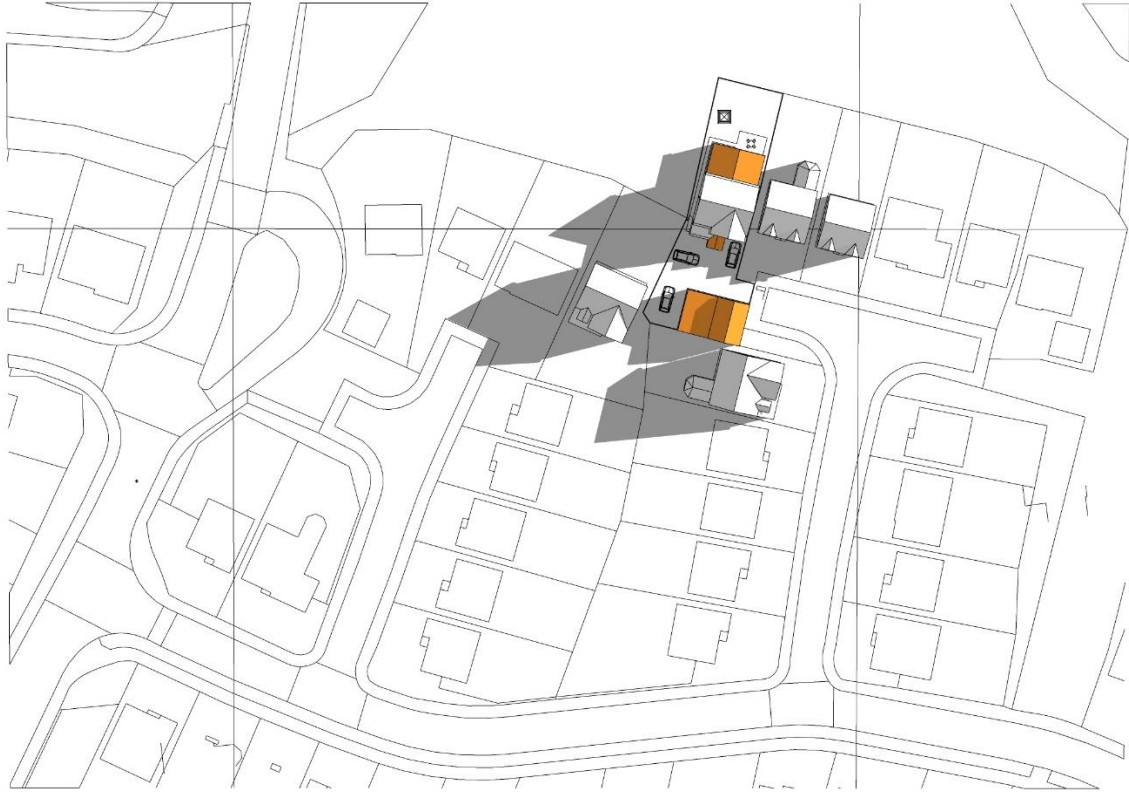

June 1<sup>st</sup> 06:00

## Shadow Analysis Conclusion

Further to carrying out the shadow analysis, it is clear that the only minor impact is on the neighbouring property to the West. The shadow created by the proposed garage falls slightly on to the existing gable which accommodates a singular first floor level obscured bathroom window.

# Shadow Analysis

11 Scotsmill View, Blackburn

Proposed Shadow Fall in Summer



June 1<sup>st</sup> 09:00

## Shadow Analysis Conclusion

Further to carrying out the shadow analysis, it is clear that the proposal does not have any impact on the neighbouring properties.

# Shadow Analysis

11 Scotsmill View, Blackburn

Proposed Shadow Fall in Summer



June 1<sup>st</sup> 12:00

## Shadow Analysis Conclusion

Further to carrying out the shadow analysis, it is clear that the proposal does not have any impact on the neighbouring properties.

# Shadow Analysis

11 Scotsmill View, Blackburn

Proposed Shadow Fall in Summer



June 1<sup>st</sup> 15:00

## Shadow Analysis Conclusion

Further to carrying out the shadow analysis, it is clear that the proposal does not have any impact on the neighbouring properties.

# Shadow Analysis

11 Scotsmill View, Blackburn

Proposed Shadow Fall in Summer



June 1<sup>st</sup> 18:00

## Shadow Analysis Conclusion

Further to carrying out the shadow analysis, it is clear that the proposal does not have any impact on the neighbouring properties.

# Shadow Analysis

11 Scotsmill View, Blackburn

Proposed Shadow Fall in Summer

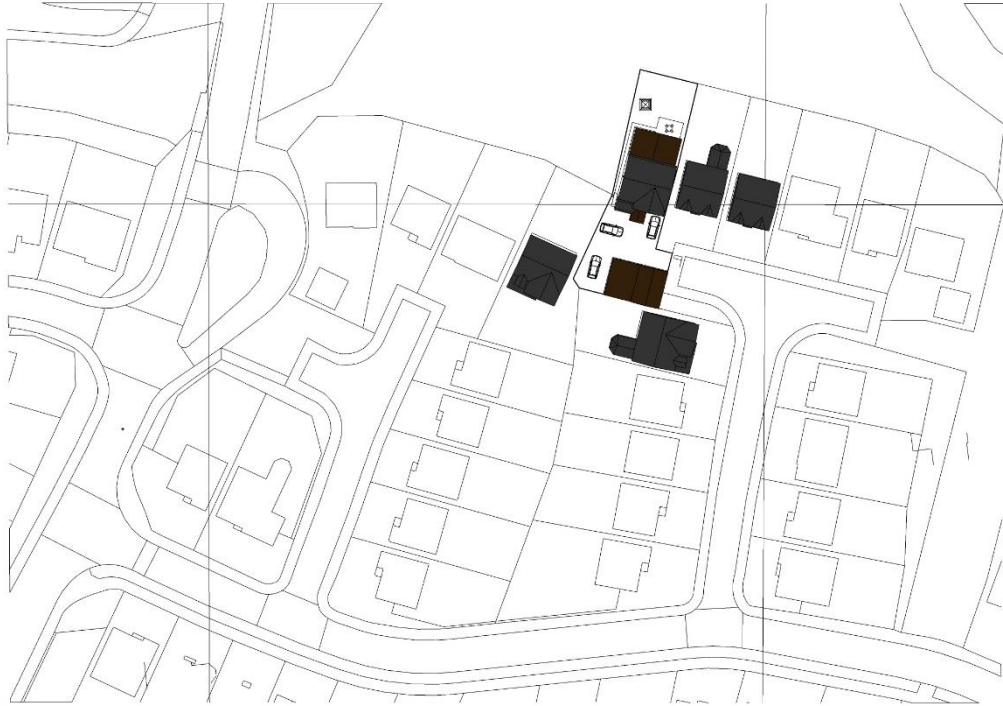

June 1<sup>st</sup> 21:00

## Shadow Analysis Conclusion

No overshadowing occurs.

# Shadow Analysis

11 Scotsmill View, Blackburn

Proposed Shadow Fall in Winter

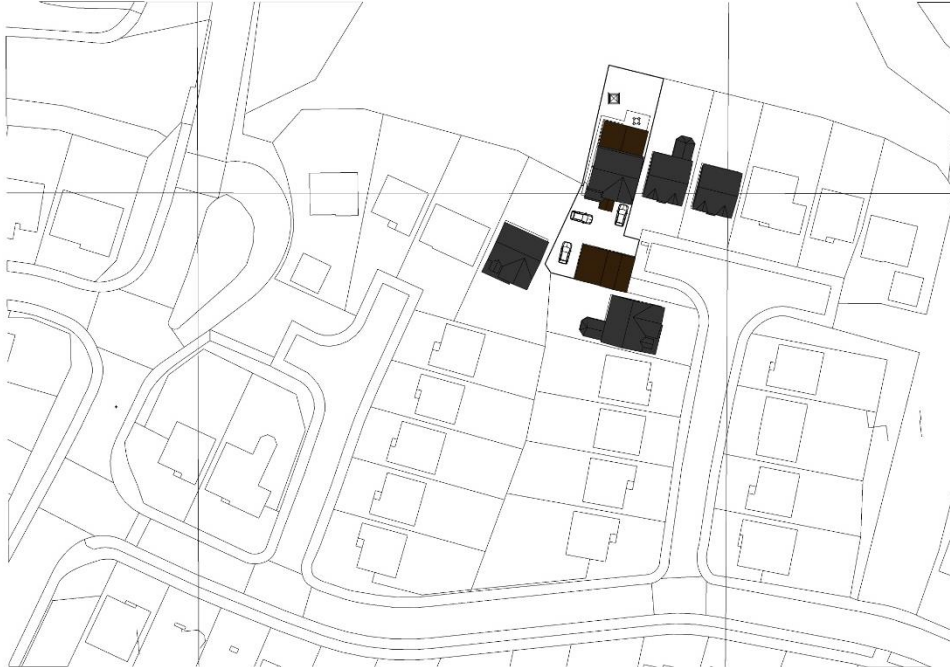

December 1<sup>st</sup> 06:00

## Shadow Analysis Conclusion

No overshadowing occurs.



# Shadow Analysis

11 Scotsmill View, Blackburn

Proposed Shadow Fall in Winter

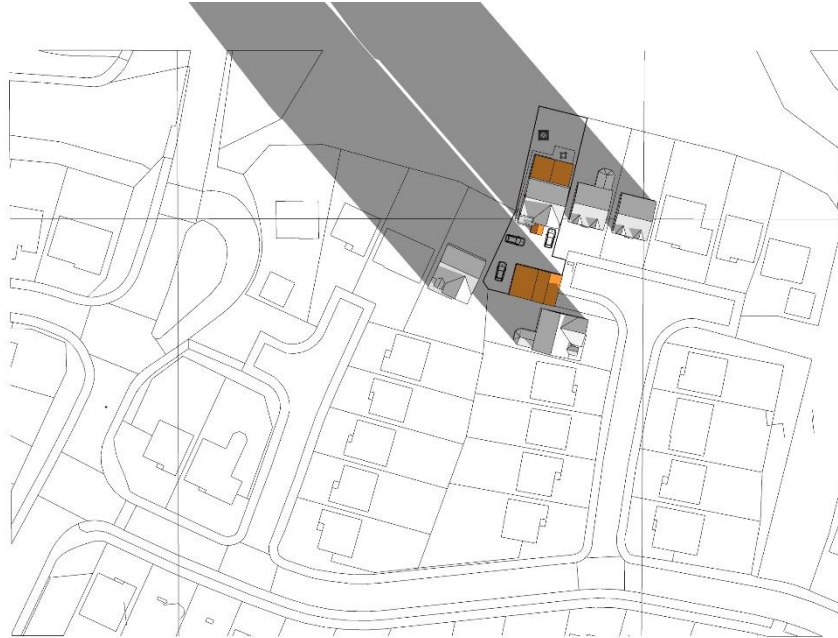

December 1<sup>st</sup> 09:00

## Shadow Analysis Conclusion

Further to carrying out the shadow analysis, it is clear that the proposal does not increase the shadowing from the current situation.

# Shadow Analysis

11 Scotsmill View, Blackburn

Proposed Shadow Fall in Winter



December 1<sup>st</sup> 12:00

## Shadow Analysis Conclusion

Further to carrying out the shadow analysis, it is clear that the proposal does not increase the shadowing from the current situation.

# Shadow Analysis

11 Scotsmill View, Blackburn

Proposed Shadow Fall in Winter



December 1<sup>st</sup> 15:00

## Shadow Analysis Conclusion

Further to carrying out the shadow analysis, it is clear that some shadowing occurs in late afternoon however the property to the east already experiences overshadowing from the property from the south from around 12pm. Also, at this time in winter, the sun sets shortly before 4pm.

# Shadow Analysis

11 Scotsmill View, Blackburn

Proposed Shadow Fall in Winter

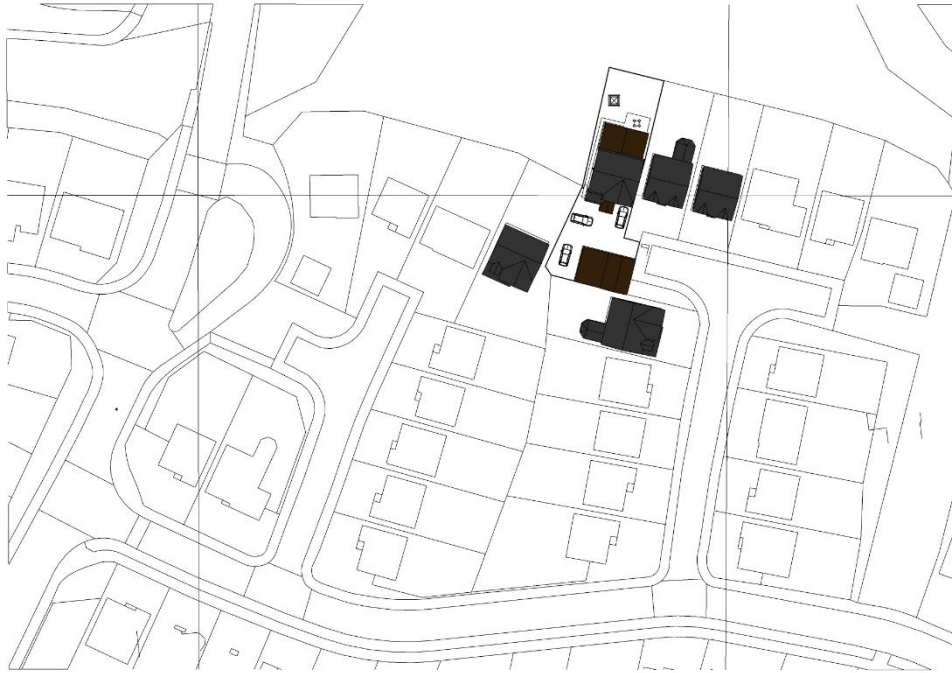

December 1<sup>st</sup> 18:00

## Shadow Analysis Conclusion

No overshadowing occurs.

# Shadow Analysis

11 Scotsmill View, Blackburn

Proposed Shadow Fall in Winter

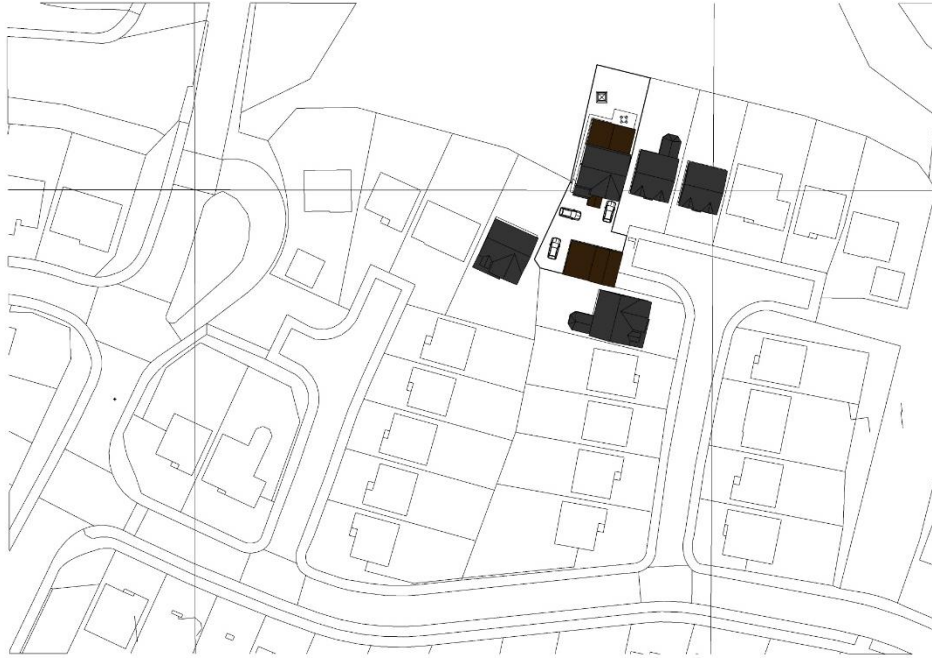

December 1<sup>st</sup> 21:00

## Shadow Analysis Conclusion

No overshadowing occurs.