

Disclaimer:
 Subject to survey.
 The topographical information shown is based on the
 topographical survey by Greenhatch Group
 Survey project no. 37505_T Rev1, dated January 2021

Notes:
 Site Boundary
 (103,050m² / 25.46 acres / 10.31ha)

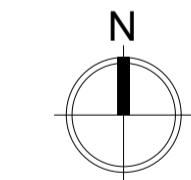

- Planning Issue	11.02.21	HT	HA
- DRAFT ISSUE	02.02.21	HT	HA
Rev: Notes:	Date:	Dwn:	Iss:
Suitability Code:			
0 10 20 50m			
Scale bar - 1:1250m			

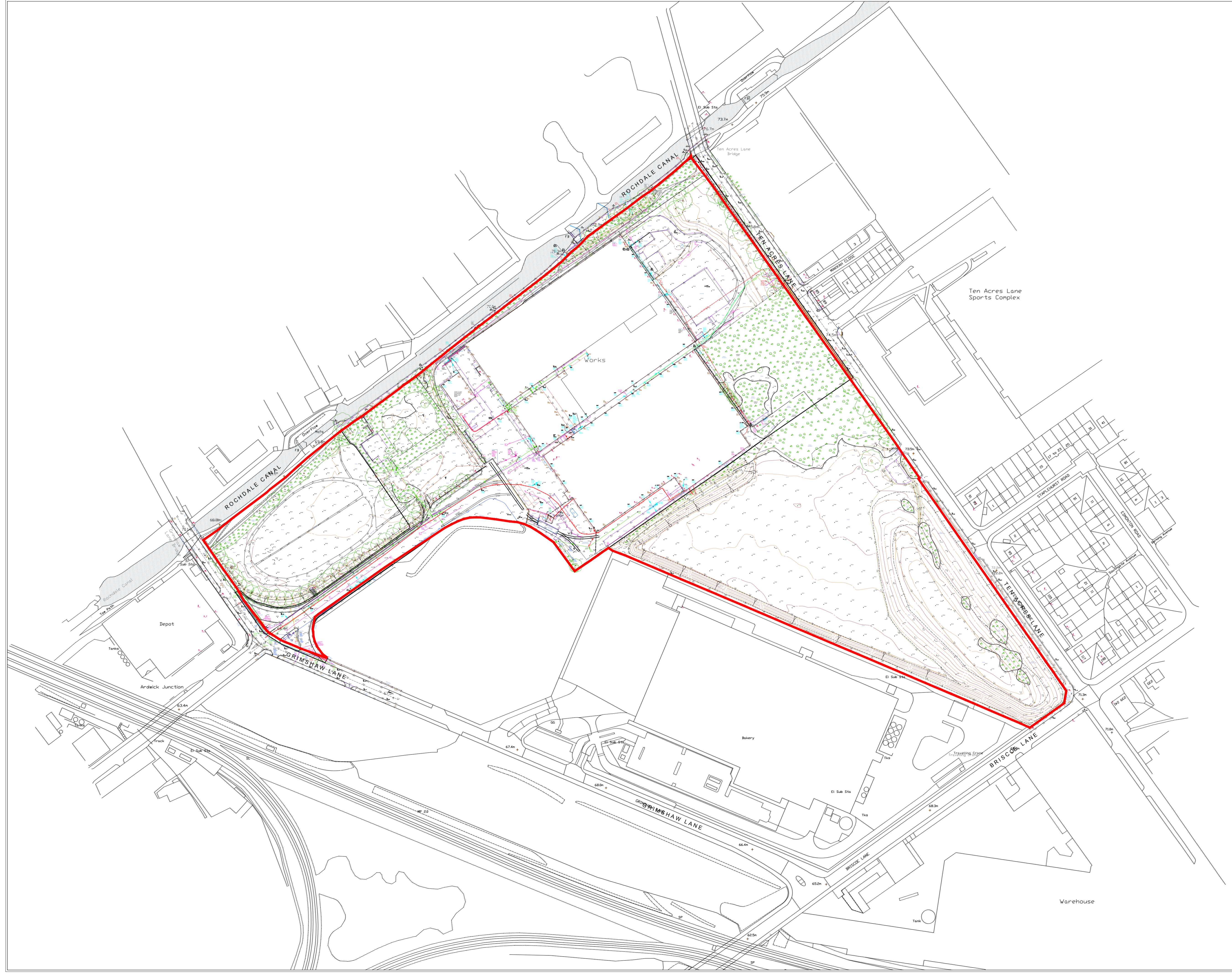

hale
 ARCHITECTURE
 22c Leathermarket Street, London, SE1 3HP

Project:
 Grimshaw Lane, Manchester

Drawing Title:
 Site Location Plan

Project No: 20066	Scale @ A1 @ A3 1:1250 / 1:2500	Revision: -
Drawing No: PL1002		