

NEW ROOF IN INTERLOCKING CONCRETE TILES TO MATCH EXISTING OVER 38 X 19mm ROOFING QUALITY TANALIZED ROOFING BATTENS SECURELY FIXED OVER ROOFING QUALITY BREATHABLE/ UNTEARABLE APPROVED ROOFING FELT OVER 150 X 50 S/WOOD SC3 GRADE RAFTERS @400mm CENTRES BOLTED AT FEET TO 200 X 50mm S/WOOD SC3 GRADE CEILING JOISTS @400mm CENTRES WITH DOUBLE 12mm BOLT CONNECTORS WITH 200 X 32mm S/WOOD RIDGE AND 200 X 50mm S/WOOD HIP RAFTERS WITH PATENTED FIBREGLASS VALLEY GUTTERS OVER MIN 25 X 150mm ROOFING QUALITY S/WOOD BASE, MIN 150mm GAP REQUIRED BETWEEN TILE EDGES

CEILINGS IN 12.5mm FOILBACKED PLASTERBOARD AND SKIM WITH MIN 300mm THICK FIBREGLASS QUILT INSULATION LAID BTWN AND OVER NEW CEILING JOISTS.
NEW FASCIAS AND EAVES SOFFITES IN APPROVED UPVC TO MATCH EXISTING WITH UPVC 100mm HALF ROUND GUTTERS AND RVP'S TO MATCH EXISTING.

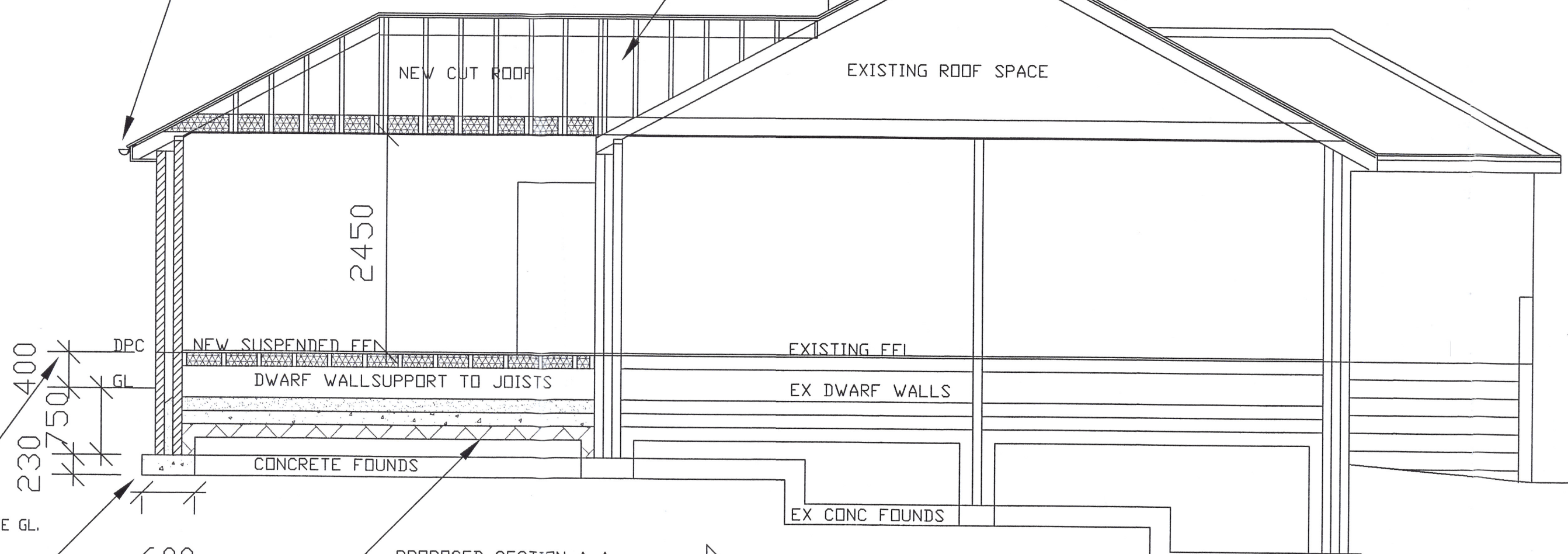
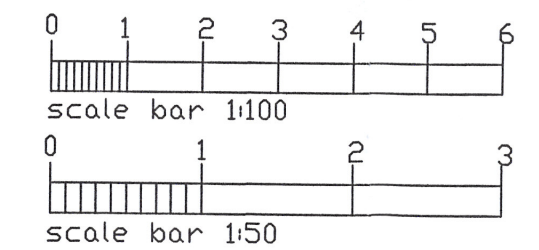

DPC IN APPROVED FELT TO BE MIN 150mm ABOVE GL.

DEPTH OF NEW FOUNDATIONS TO SUIT SITE SOIL CONDITIONS IN 1:36-40mm AGGREGATE MIX AND UNDERPIN EXISTING FOUNDATIONS AT JUNCTION WITH NEW FOUNDATIONS IF DEEMED NECESSARY BY BUILDING INSPECTOR DURING SITE INSPECTION.

NEW SUSPENDED FLOOR TO MATCH EXISTING WITH MIN 25mm FLOORING GRADE WEYROC OVER 147 X 50 S/WOOD FLOOR JOISTS @400mm CENTRES BUILT OVER NEW CAVITY WALLS AND INTERMEDIATE BRICK DWARF WALLS 2 NO EQUALLY SPACED ABOVE 150mm CONCRETE BASE 1:2.4-40mm AGG MIX OVER 150mm CELOTEX CW3000 INSULATION SHEET AND 150mm HARDCORE @SITE BASE INCL. BACKFILL TO ALL NEW FOUNDATION TRENCHES. FLOOR VOID VENTILATED ALL ROUND WITH 230 X 80 TERRACOTTA AIR BRICKS

ALL NEW WINDOWS & EXT. DOORS IN UPVC DOUBLE GLAZED UNITS TO MATCH EXIST. IN TOUGHENED SAFETY GLASS TO BS6206 WITH CATNIC CG70/100 OR CH70/100 LINTELS OVER & VERT. PATENTED INSULATED 150mm WIDE DPC'S AS CAVITY CLOSURES. GLAZING IN LOW E GLASS WITH MIN. 16mm AIR GAPS. ALL NEW WINDOWS TO HAVE AT LEAST 1no DPNG SASH MIN 850 X 550mm CLEAR DPNG SIZE SECONDARY MEANS OF ESCAPE. ALL EXT DPNGS SEALED ALL RND IN APPROVED MASTIC SEALANT.

LATERAL RESTRAINT STRAPS REQ'D FROM SIDE CAVITY WALLS AND OVER 3 OUTER CEILING JOISTS AT APPROX 1200mm CENTRES.

NEW SOIL & VENTSTACKS IN 100mm DIAMETER UPVC TO TERMINATE AT MIN. 10m ABOVE HIGHEST POINT OF ANY ADJACENT WINDOW OPENINGS AND TO BE ENCASED FULL HEIGHT IN 12mm MASTERBOARD AS FIRE PROTECTION. 200mm MIN RADIUS BEND REQUIRED AT FOOT OF S&VPS.

NEW CAVITY WALLS IN 100mm BLOCK AND RENDER AS EXISTING. & MIN. 100mm CAVITIES FULLY INSULATED WITH APPROVED BLOWN FIBRE INSULATION BY SPECIALIST SUPPLIER AND INNER SKIN IN 100mm CELCON INSULATION BLOCKS ALL WITH 12mm RENDER AND SKIM TO INNER FACES AND DECORATED TO CLIENTS CHOICE. CERTIFICATION TO BE PROVIDED FOR BLOWN FIBRE INSULATION.

EXISTING FOUNDATIONS TO BE EXPOSED AND CHECKED FOR SUITABILITY TO SUPPORT ADDITIONAL LOAD AND UNDERPINNED IF DEEMED NECESSARY BY THE LOCAL AUTHORITY BUILDING CONTROL OFFICER DURING SITE INSPECTION.

NEW CAVITY WALLS TO BE TOOTHED AND BONDED TO EXISTING CAVITY WALLS MAINTAINING FULL HEIGHT CONTINUOUS UNRESTRICTED CAVITIES.

NEW SOIL STACK IN 100mm DIAMETER UPVC TO TERMINATE AT MIN. 150mm ABOVE FLOOD LEVEL IN NEW WHB WITH AN AIR EMITTANCE VALVE TO BE ENCASED FULL HEIGHT IN 12mm MASTERBOARD AS FIRE PROTECTION.

NEW DRAINS IN 100mm DIAMETER UPVC APPROVED DRAIN PIPE WITH HEPSLEEVE FLEXIBLE JOINTS TO MAX. 1:40 FALLS BEDDED ON AND SURROUNDED WITH MIN 150mm PEA GRAVEL. DRAIN TO CONNECT INTO EXISTING MANHOLE.

ALL ELECTRICAL WORK TO BE CARRIED OUT BY A COMPETENT PERSON TO PART P OF THE BUILDING REGS. DESIGNED, INSTALLED, INSPECTED & TESTED TO NICEIC STANDARDS & A COMPLETION CERTIFICATE MUST BE ISSUED TO THE LOCAL AUTHORITY BUILDING CONTROL DEPT., BEFORE OCCUPATION OF THE BUILDING COMMENCES.

PROVIDE MECHANICAL VENTILATION TO NEW KITCHEN, EXISTING BATHROOM AND WC TO PROVIDE MIN 30LITRES AIR EXTRACT RATE PER SECOND TO EXTERNAL AIR.

EXTEND HOT WATER RADIATOR SYSTEM INTO NEW HABITABLE AREAS & EXTEND HOT AND COLD WATER SUPPLIES AS NECESSARY. ALL PLUMBING TO BE INSTALLED AS PER BS EN 12056 2000.

PROVIDE ALL NEW ELECTRICAL SOCKETS & LIGHT FITTINGS TO CLIENTS CHOICE TO IEE REGS & PROVIDE A SELF CONTAINED INTERCONNECTED SMOKE ALARM SYSTEM, PERMANENTLY WIRED TO A FUSED CIRCUIT TO IEE WIRING REGS & TO BS 5839 PART 1.

NEW 38mm DIAMETER UPVC WASTES TO BE PROVIDED TO NEW SINK COMPLETE WITH 75mm DEEP SEAL ANTISIPHONAGE TRAPS TO ALL WASTE OUTLETS

Note: this drawing is to be read in conjunction with drwg number ATP3

SPECIFICATION NOTES.

CEILING:
CONSTRUCTED IN 12.5mm FOIL BACKED PLASTERBOARD AND SKIM COAT GYPSUM PLASTER WITH MINIMUM 300mm THICK FIBREGLASS QUILT INSULATION OVER LAID BETWEEN CEILING JOISTS.
A MINIMUM GAP OF 50mm MUST BE MAINTAINED AT EAVES ABOVE INSULATION TO ALLOW AIR FLOW INTO ROOF VOID, PATENTED ROOF VENTS TO BE FITTED AT RIDGE LEVEL AND AT ANY ROOF JUNCTION WITH AN EXTERNAL WALL TO GIVE A MINIMUM OF 2,500mm square VENT AREA PER METRE OF ROOF TO GIVE CROSS FLOW VENTILATION TO ENCLOSED ROOF SPACE.

FLOORS:
GROUND FLOOR AS EXISTING (SEE SPEC ON SECTION). DAMP TRAYS AND FLASHINGS TO BE PROVIDED IN CODE 5 LEAD AND INSTALLED AS PER THE LEAD DEVELOPMENT ASSOCIATION REQUIREMENTS. MINIMUM OF 150mm LEAD UPSTAND IS REQUIRED WHERE A WALL AND ROOF JUNCTION OCCURS ABOVE WHICH A CONTINUOUS LEAD DAMP TRAY MUST BE PROVIDED WITHIN THE CAVITY WALL.

CAVITY WALLS:
TO BE CONSTRUCTED IN INS. BLOCK OUTER SKIN TO MATCH EXISTING WHERE APPLICABLE WITH A 100mm WIDE CAVITY WITH 90d GALVANISED MILDSTEEL WALL TIES PER METRE SQUARE WALL AREA AND INNER SKIN OF 100mm INSULATION BLOCKS AND 12.5mm RENDER AND SKIM COAT GYPSUM PLASTER TO INNER FACE. CAVITY TO BE FULLY FILLED WITH A PUMPED FIBREGLASS INSULATION BY 'ROCKWOOL LIMITED' CERTIFICATION TO BE PROVIDED TO BUILDING CONTROL. (OR EQUIVALENT APPROVED MATERIAL)

DRAINS: 100mm DIAMETER U.P.V.C SOAKAWAY PIPE LAID TO MAX. FALLS 1:40 ENCASED IN MIN. 150mm PEA SHINGLE ALL RND. TO DISCHARGE INTO SOAKAWAYS MIN. 1.5 CUBIC METRES CAPACITY AT DISTANCE NOT LESS THAN 5.0 METRES OFF THE BUILDING FACE.
CONCRETE STRIP FOUNDATIONS TO BE TAKEN DOWN TO INVERT LEVEL OF ANY DRAIN PASSING WITHIN 1.0 METRE OF THE BUILDING. ANY DRAIN PASSING UNDER A STRUCTURAL FLOOR TO BE ENCASED IN MIN. 150mm PEA SHINGLE AND PROTECTED OVER BY A REINFORCED CONCRETE LINTEL WHERE PASSING BELOW ANY STRUCTURAL WALL.

ROOF:
CONSTRUCT IN C16 GRADE SOFTWOOD. VENTILATION TO HABITABLE ROOMS TO BE NOT LESS THAN 1/20th THE TOTAL FLOOR AREA - A MIN. OF 3 AIR CHANGES PER HOUR. TRICKLE VENTS TO BE FITTED TO WINDOWS TO ALL HABITABLE ROOMS TO GIVE BACKGROUND VENTILATION AREA OF 8000mm square.
LIGHTING TO BE A MIN. OF 40 LUMENS PER CIRCUIT WATT TO EACH ROOM. ELECTRICAL INSTALLATION BY SPECIALIST TO I.E.E REGULATIONS.

CEMENT TO BS12, WALL TIES TO BS1243, BRICKS TO BS1257 AND BS657, CONCRETE BLOCKS TO BS2028 AND BS882, DPC'S IN APPROVED FELT OR EQUIVALENT TO BS747 AND CP144, CATNIC LINTELS TO BE FITTED AS PER MANUFACTURERS FULL INSTRUCTIONS WITH MIN. 150mm END BEARINGS.

ALL WORK MUST COMPLY WITH THE 2010 BUILDING REGULATIONS AND ANY SUBSEQUENT AMENDMENTS.
AV.U.V VALUE TO EXT. WALL NOT TO EXCEED 0.28W/Msq.degC.
AV.U.V VALUE TO ROOF NOT TO EXCEED 0.16W/Msq.degC.
AV.U.V VALUE TO FLOOR NOT TO EXCEED 0.22W/Msq.degC.
AV.U.V VALUE TO DOORS/WINDOWS N.T.O EXC. 1.60W/Msq.degC.
ALL D.GLAZING TO BE IN LOW E TOUGHENED SAFETY GLASS WITH MIN 16mm AIR GAPS. GLASS TO BS6206.

ALL STRUCTURAL ELEMENTS OF WORK TO HAVE A MINIMUM OF 1/2 HOUR FIRE RESISTANCE.
BASIC RADON PROTECTION TO BE PROVIDED IF REQUIRED.
PROVIDE WHOLESOME WATER SUPPLY TO INSTALLATION.

AMENDMENTS:

TITLE
PROPOSED SINGLE STOREY EXTENSION TO REAR OF 94 MEDSTEAD ROAD, BEECH, NR ALTON HANTS, GU344AE for MR AND MRS A PATEL.
(proposed ground floor plan, elevations and section A-A)

DATE 07/02/2021	TELE: 01420 88245
SCALE: 1:100 & 1:50	DRAWING NO: ATP4.