

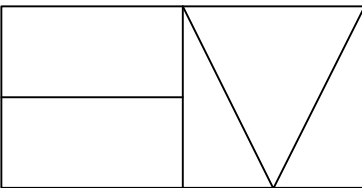

Notes

Copyright and not to be reproduced without the consent of Holmes Miller Holmes Miller accepts responsibility for this document only to the commissioning Party and not to any other. Holmes Miller does not accept liability for accuracy or veracity of survey information provided by others and horizontal dimensions and levels provided by Holmes Miller and based on survey information provided by others must be verified on site
DO NOT SCALE: Use figured dimensions only

P02	Additional notes and key added	JG	DJ	18.02.21
P01	First Revision	JG	DJ	23.11.20
Rev	Notes	Drawn	Appr	Date



Holmes Miller
89 Minerva Street
Glasgow
G3 8LE
0141 204 2080
www.holmesmiller.com

Project 4687

**City Halls & Old Fruitmarket
Roofworks
City Building**

Drawing Name

Roof 3C - Plan

Scale @A3	Checked	Revision
1:100	DJ	P02

Drawing Number

CHF-HML-03-RF-DR-A-12106

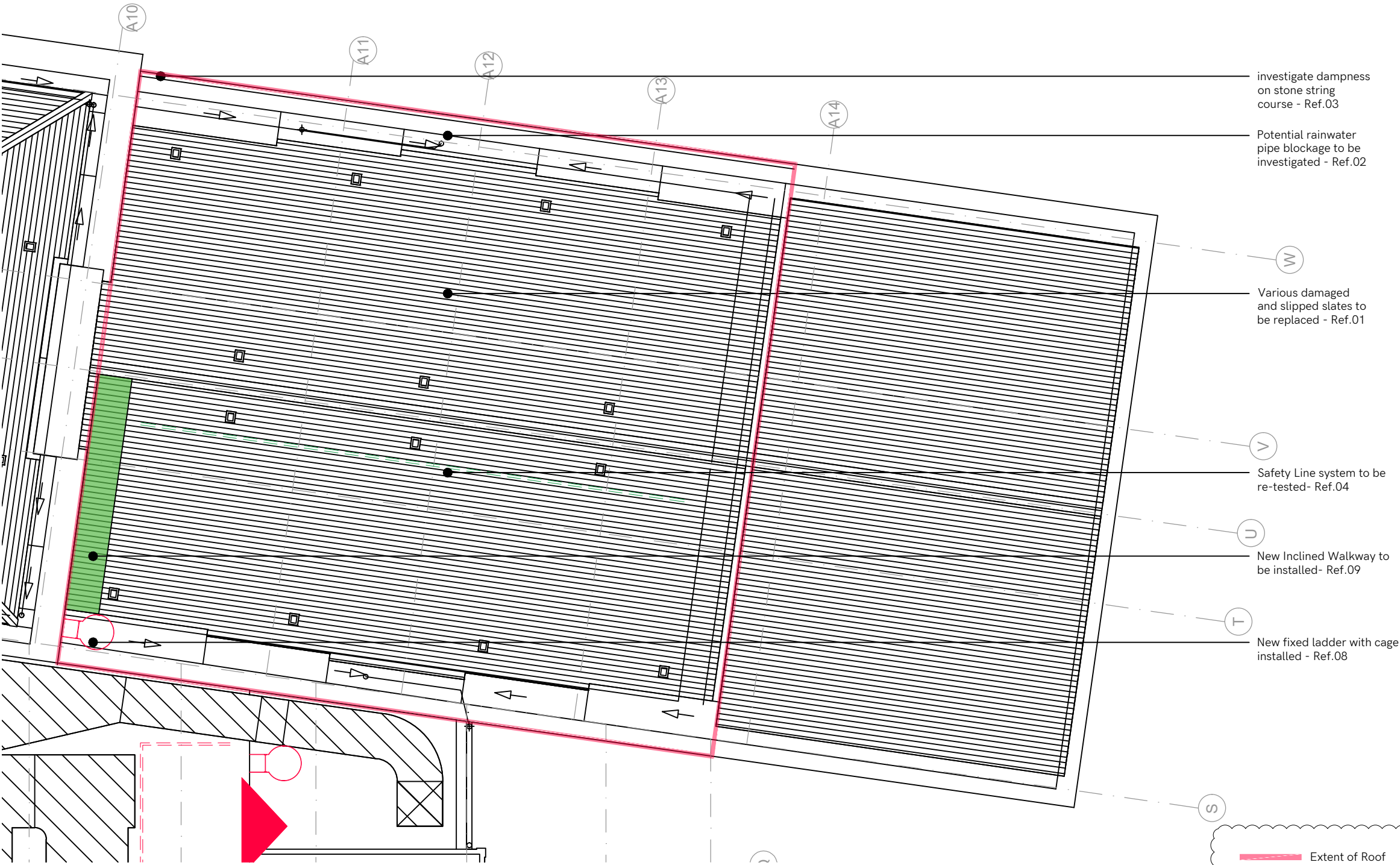

investigate dampness
on stone string
course - Ref.03

Potential rainwater
pipe blockage to be
investigated - Ref.02

Various damaged
and slipped slates to
be replaced - Ref.01

Safety Line system to be
re-tested- Ref.04

New Inclined Walkway to
be installed- Ref.09

New fixed ladder with cage
installed - Ref.08

GENERAL
Ref.01 - All slate roofs to be inspected and all slipped and damaged slates to be carefully removed (without damaging adjacent sound slates).
Ref.05 - Existing system to be assessed by a lightning protection specialist
Ref.06 - Sacrificial lead flashing to be installed at base of slate roof where it meets a lead gutter
Ref.07 - Lead slate pieces to be fitted around all roof penetrations

- Extent of Roof
- Extent of gutter requiring repairs
- Proposed Safety Line System
- Existing Safety Line (to be tested)
- Existing Safety Line to be removed
- Proposed fixed ladder with cage
- Existing ladder with cage
- Metal access walkway (flat)
- Metal access walkway (inclined)
- Existing metal walkway
- Access out onto Roof