

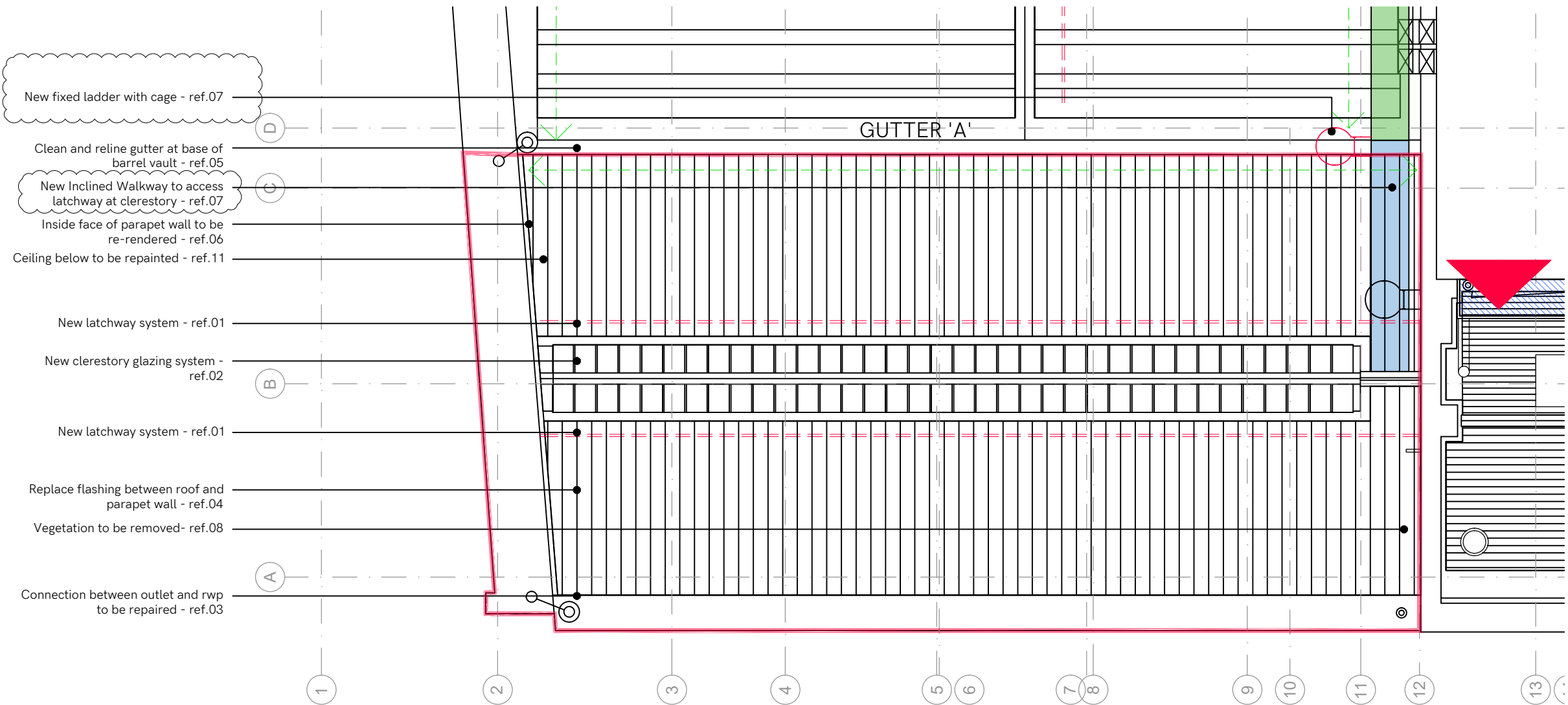

Notes

Copyright and not to be reproduced without the consent of Holmes Miller Holmes Miller accepts responsibility for this document only to the commissioning Party and not to any other. Holmes Miller does not accept liability for accuracy or veracity of survey information provided by others and horizontal dimensions and levels provided by Holmes Miller and based on survey information provided by others must be verified on site
DO NOT SCALE: Use figured dimensions only



New fixed ladder with cage - ref.07

Clean and reline gutter at base of barrel vault - ref.05

New Inclined Walkway to access latchway at clerestory - ref.07

Inside face of parapet wall to be re-rendered - ref.06

Ceiling below to be repainted - ref.11

New latchway system - ref.01

New clerestory glazing system - ref.02

New latchway system - ref.01

Replace flashing between roof and parapet wall - ref.04

Vegetation to be removed- ref.08

Connection between outlet and rwp to be repaired - ref.03

WORKS NOT NOTED ELSEWHERE ON DRAWINGS
Ref.09 - Timber floor of bar to be sanded and sealed
Ref.10 - MDF ledge to be repaired; exposed cast iron elements to be sanded down and repainted; all walls and soffits to be prepared and painted

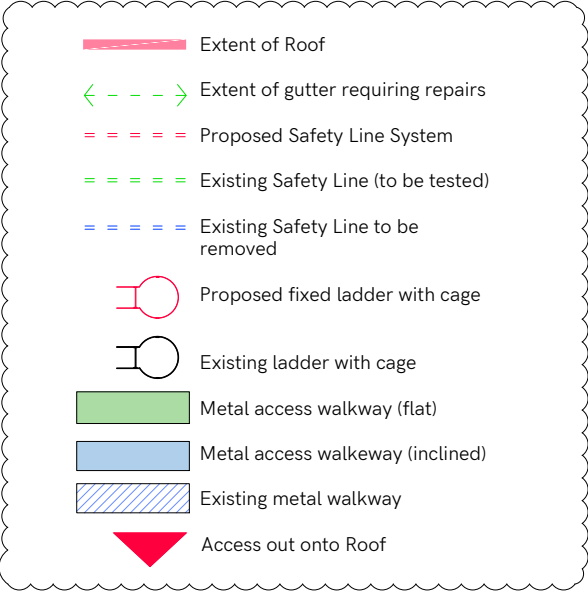

P02	Notes updated. Key added. New access ladder added and walkways altered	JG	DJ	18-02-21
P01	First Revision	JG	DJ	23-11-20
Rev	Notes	Drawn	Appr	Date

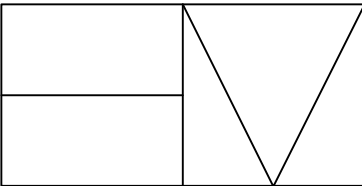

Holmes Miller
89 Minerva Street
Glasgow
G3 8LE
0141 204 2080
www.holmesmiller.com

Project 4687

City Halls & Old Fruitmarket
Roofworks
City Building

Drawing Name
Roof 1A - Plan

Scale @A3	Checked	Revision
1:100	DJ	P02

Drawing Number
CHF-HML-01-RF-DR-A-12100