

A Member of the RSK Group plc

## Somerset

Published 1938

Source map scale - 1:10,560

The historical maps shown were reproduced from maps predominantly held at the scale adopted for England, Wales and Scotland in the 1840's. In 1854 the 1:2,500 scale was adopted for mapping urban areas; these maps were used to update the 1:10,560 maps. The published date given therefore is often some years later than the surveyed date. Before 1938, all OS maps were based on the Cassini Projection, with independent surveys of a single county or group of counties, giving rise to significant inaccuracies in outlying areas. In the late 1940's, a Provisional Edition was produced, which updated the 1:10,560 mapping from a number of sources. The maps appear unfinished - with all military camps and other strategic sites removed. These maps were initially overprinted with the National Grid. In 1970, the first 1:10,000 maps were produced using the Transverse Mercator Projection. The revision process continued until recently, with new editions appearing every 10 years or so for urban areas.

### Map Name(s) and Date(s)

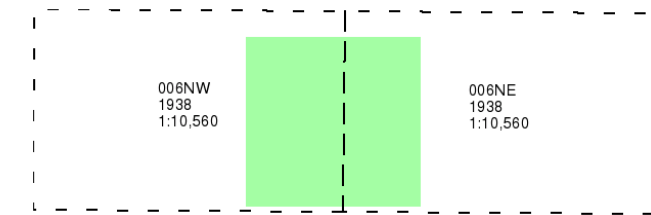

### Historical Map - Slice A

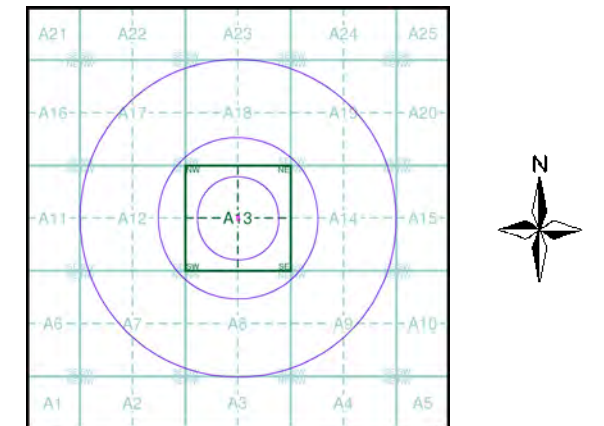

### Order Details

Order Number: 180883921\_1\_1  
 Customer Ref: 733272/AW  
 National Grid Reference: 358600, 171800  
 Slice: A  
 Site Area (Ha): 0.05  
 Search Buffer (m): 1000

### Site Details

Lombard Service Station, Brook Road, Southville, BRISTOL, BS3 1AJ



Tel: 0844 844 9952  
 Fax: 0844 844 9951  
 Web: www.envirocheck.co.uk

357400 357600 357800 358000 358200 358400 358600 358800 359000 359200 359400 359600 359800

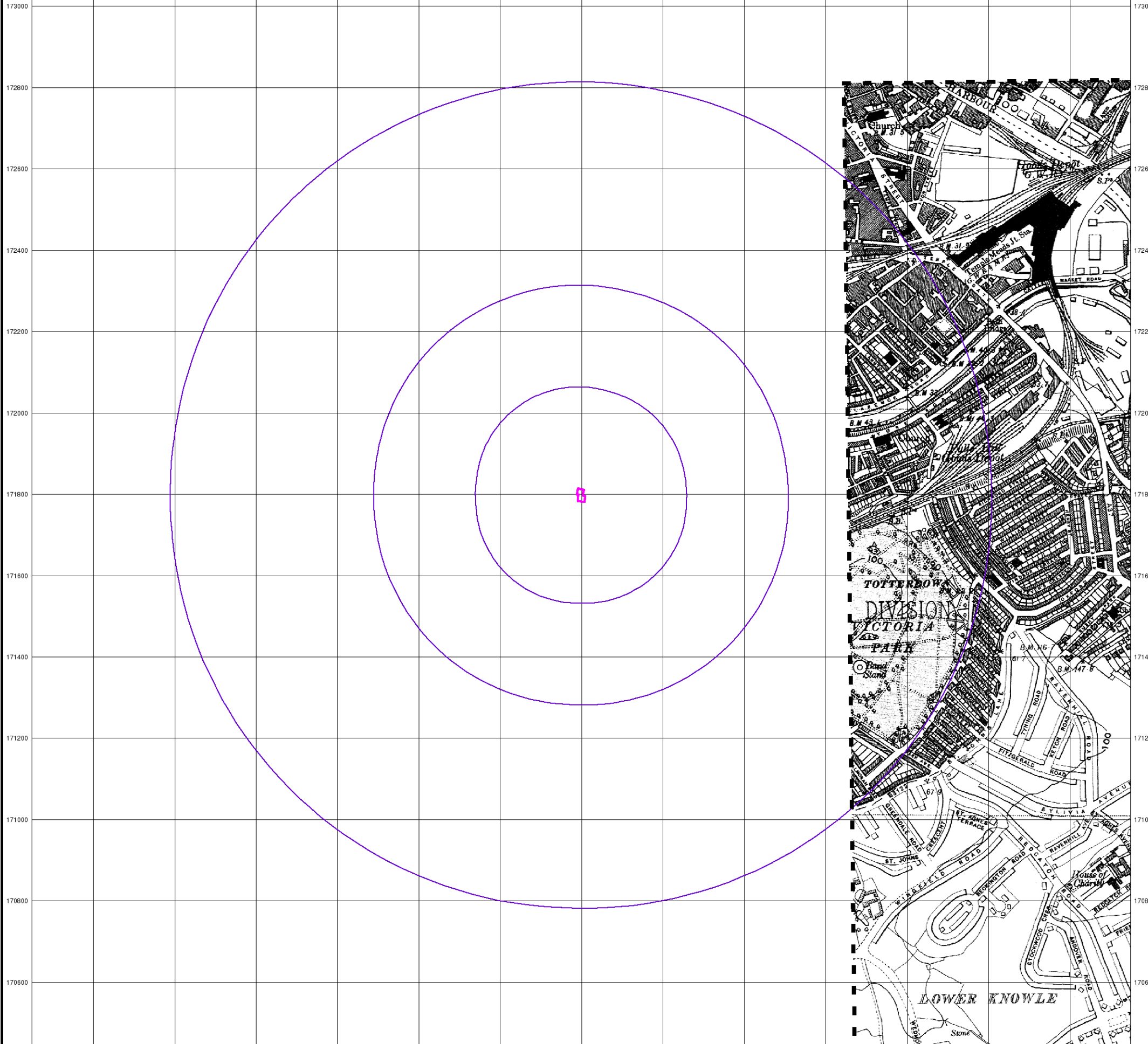

A Member of the RSK Group plc

**Gloucestershire**

**Published 1946**

**Source map scale - 1:10,560**

The historical maps shown were reproduced from maps predominantly held at the scale adopted for England, Wales and Scotland in the 1840's. In 1854 the 1:2,500 scale was adopted for mapping urban areas; these maps were used to update the 1:10,560 maps. The published date given therefore is often some years later than the surveyed date. Before 1938, all OS maps were based on the Cassini Projection, with independent surveys of a single county or group of counties, giving rise to significant inaccuracies in outlying areas. In the late 1940's, a Provisional Edition was produced, which updated the 1:10,560 mapping from a number of sources. The maps appear unfinished - with all military camps and other strategic sites removed. These maps were initially overprinted with the National Grid. In 1970, the first 1:10,000 maps were produced using the Transverse Mercator Projection. The revision process continued until recently, with new editions appearing every 10 years or so for urban areas.

**Map Name(s) and Date(s)**

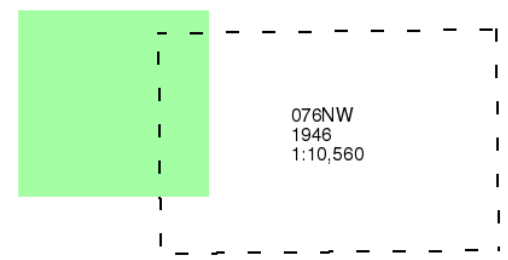

**Historical Map - Slice A**

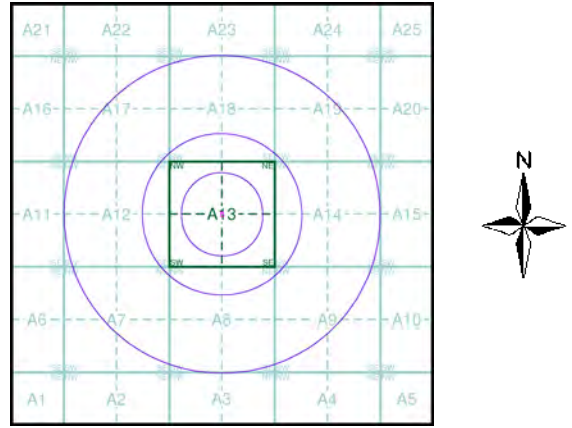

**Order Details**

Order Number: 180883921\_1\_1  
 Customer Ref: 733272/AW  
 National Grid Reference: 358600, 171800  
 Slice: A  
 Site Area (Ha): 0.05  
 Search Buffer (m): 1000

**Site Details**

Lombard Service Station, Brook Road, Southville, BRISTOL, BS3 1AJ



Tel: 0844 844 9952  
 Fax: 0844 844 9951  
 Web: www.envirocheck.co.uk

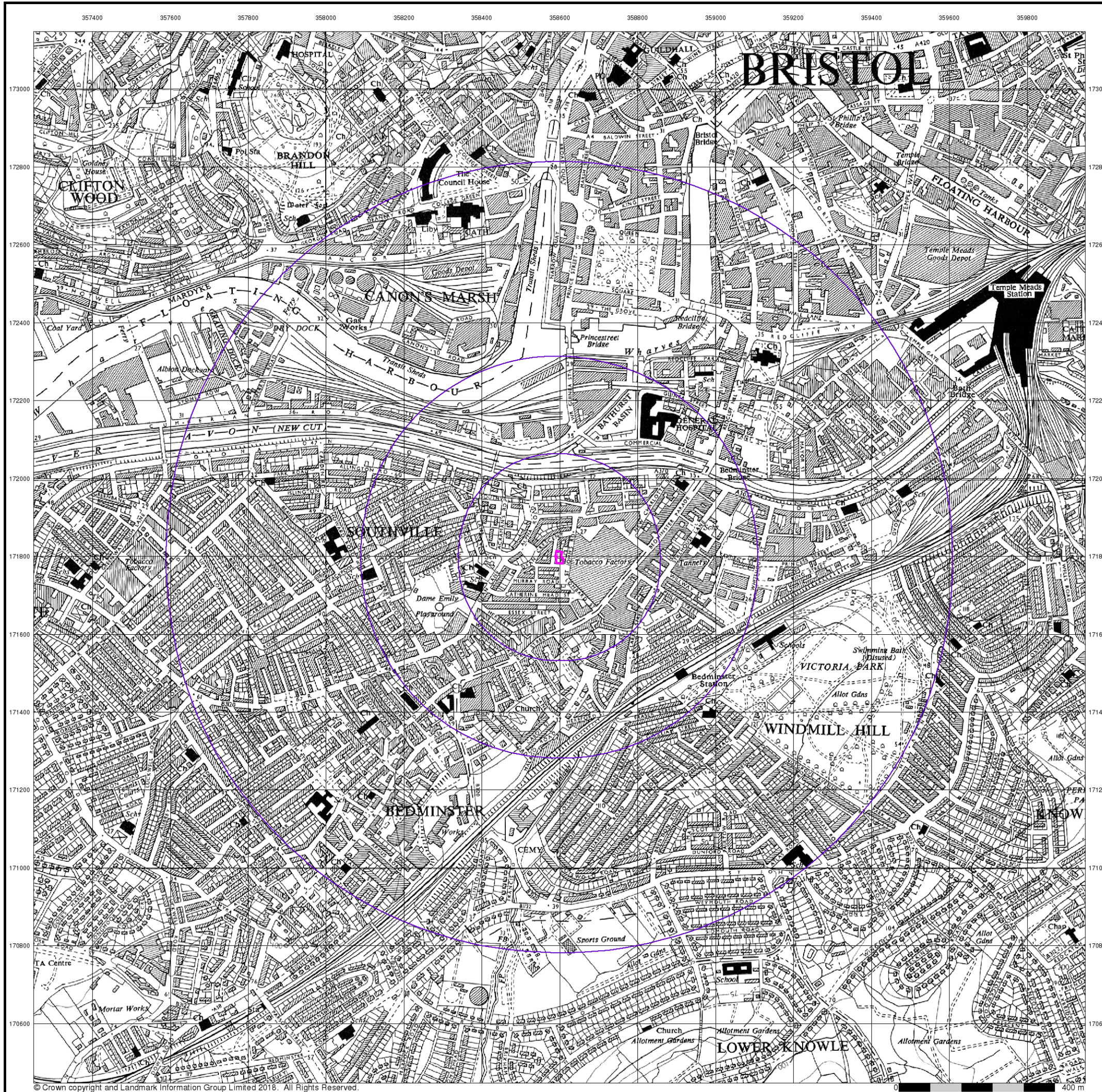

© Crown copyright and Landmark Information Group Limited 2018. All Rights Reserved.



**STRUCTURAL SOILS LTD**

A Member of the **RSK** Group plc

## Ordnance Survey Plan

Published 1955

Source map scale - 1:10,000

The historical maps shown were reproduced from maps predominantly held at the scale adopted for England, Wales and Scotland in the 1840's. In 1854 the 1:2,500 scale was adopted for mapping urban areas; these maps were used to update the 1:10,560 maps. The published date given therefore is often some years later than the surveyed date. Before 1938, all OS maps were based on the Cassini Projection, with independent surveys of a single county or group of counties, giving rise to significant inaccuracies in outlying areas. In the late 1940's, a Provisional Edition was produced, which updated the 1:10,560 mapping from a number of sources. The maps appear unfinished - with all military camps and other strategic sites removed. These maps were initially overprinted with the National Grid. In 1970, the first 1:10,000 maps were produced using the Transverse Mercator Projection. The revision process continued until recently, with new editions appearing every 10 years or so for urban areas.

### Map Name(s) and Date(s)

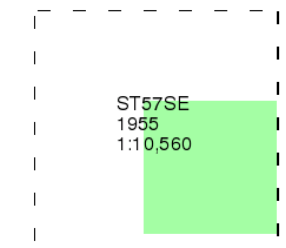

### Historical Map - Slice A

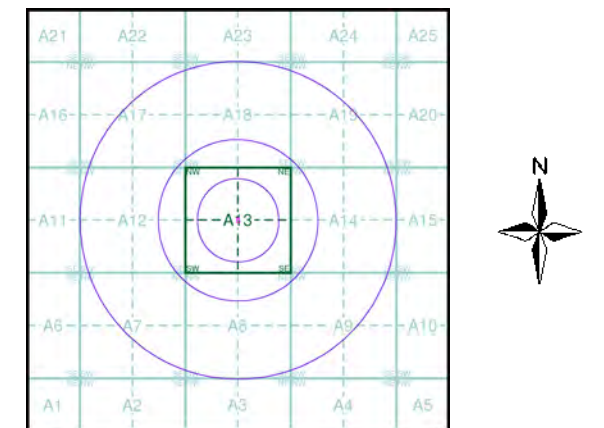

### Order Details

Order Number: 180883921\_1\_1  
 Customer Ref: 733272/AW  
 National Grid Reference: 358600, 171800  
 Slice: A  
 Site Area (Ha): 0.05  
 Search Buffer (m): 1000

### Site Details

Lombard Service Station, Brook Road, Southville, BRISTOL, BS3 1AJ



Tel: 0844 844 9952  
 Fax: 0844 844 9951  
 Web: www.envirocheck.co.uk

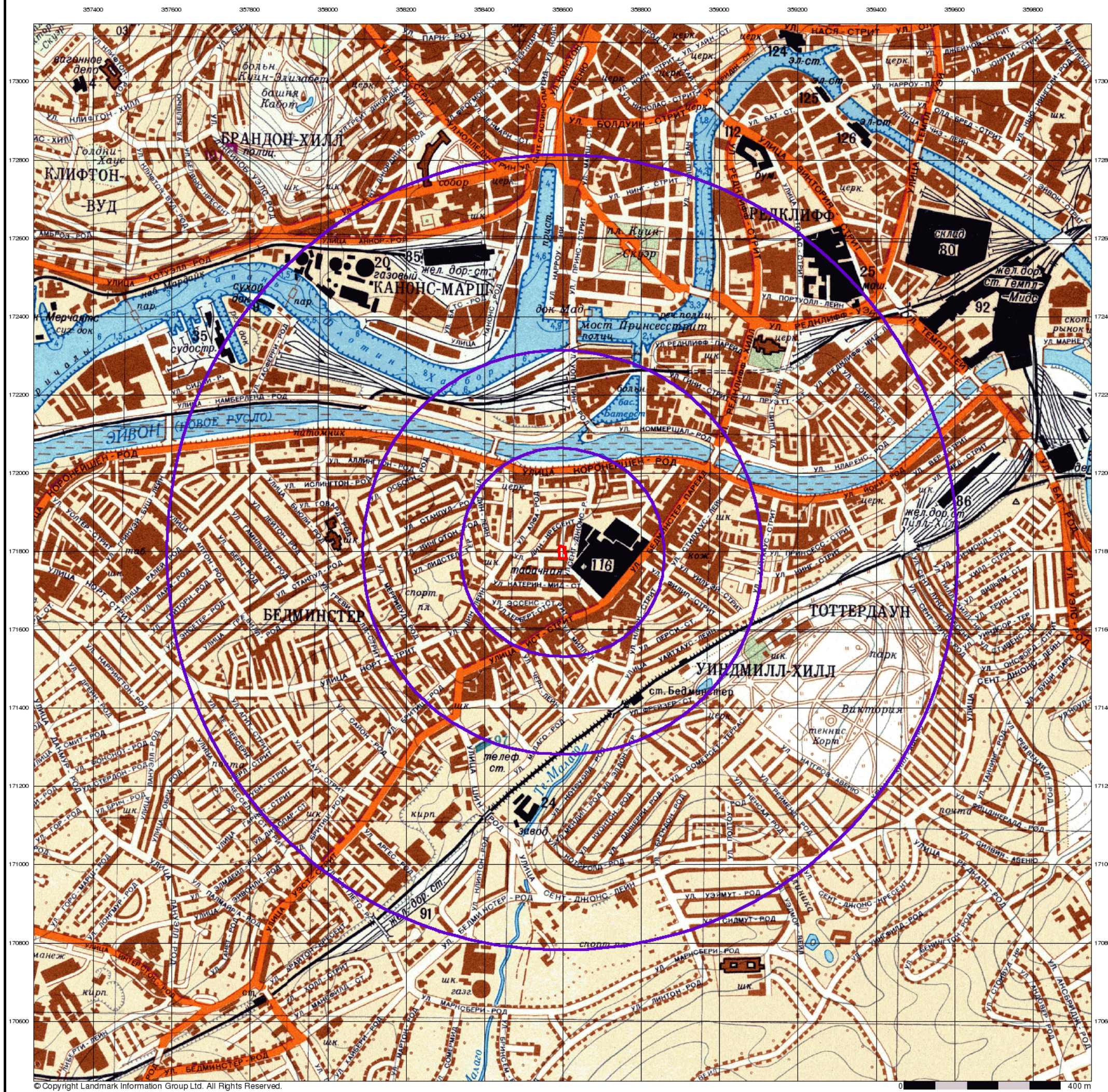

© Copyright Landmark Information Group Ltd. All Rights Reserved.



**STRUCTURAL SOILS LTD**  
A Member of the RSK Group plc

**Bristol**  
**Published 1972**  
**Source map scale - 1:10,000**

These maps were produced by the Russian military during the Cold War between 1950 and 1997, and cover 103 towns and cities throughout the U.K. The maps are produced at 1:25,000, 1:10,000 and 1:5,000 scale, and show detailed land use, with colour-coded areas for development, green areas, and non-developed areas. Buildings are coloured black and important building uses (such as hospitals, post offices, factories etc.) are numbered, with a numbered key describing their use. They were produced by the Russians for the benefit of navigation, as well as strategic military sites and transport hubs, for use if they were to have invaded the U.K. The detailed information provided indicates that the areas were surveyed using land-based personnel, on the ground, in the cities that are mapped.

**Map Name(s) and Date(s)**

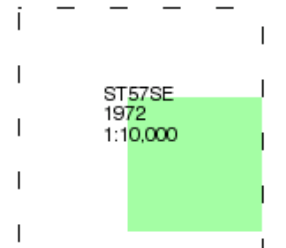

**Russian Map - Slice A**

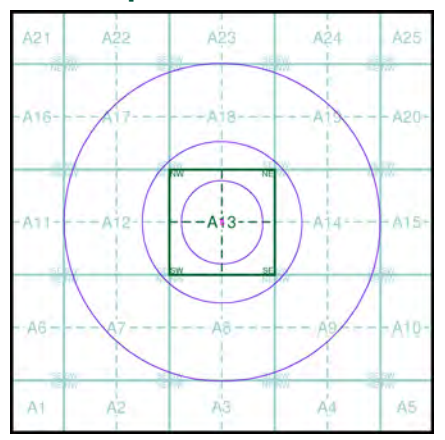

**Order Details**

Order Number: 180883921\_1\_1  
Customer Ref: 733272/AW  
National Grid Reference: 358600, 171800  
Slice: A  
Site Area (Ha): 0.05  
Search Buffer (m): 1000

**Site Details**

Lombard Service Station, Brook Road, Southville, BRISTOL, BS3 1AJ



Tel: 0844 844 9952  
Fax: 0844 844 9951  
Web: www.envirocheck.co.uk

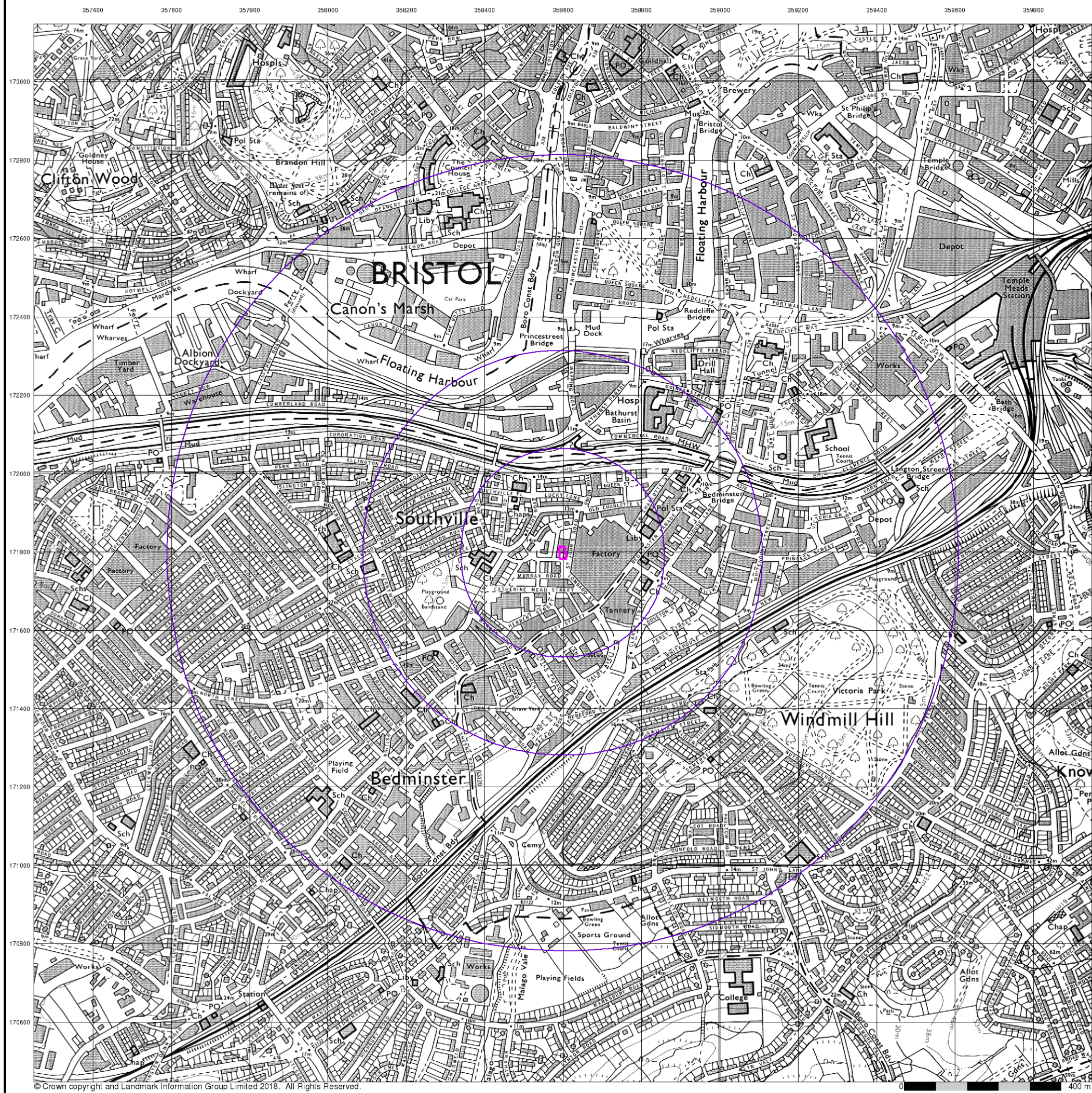

© Crown copyright and Landmark Information Group Limited 2018. All Rights Reserved.



A Member of the RSK Group plc

## Ordnance Survey Plan

Published 1976

Source map scale - 1:10,000

The historical maps shown were reproduced from maps predominantly held at the scale adopted for England, Wales and Scotland in the 1840's. In 1854 the 1:2,500 scale was adopted for mapping urban areas; these maps were used to update the 1:10,560 maps. The published date given therefore is often some years later than the surveyed date. Before 1938, all OS maps were based on the Cassini Projection, with independent surveys of a single county or group of counties, giving rise to significant inaccuracies in outlying areas. In the late 1940's, a Provisional Edition was produced, which updated the 1:10,560 mapping from a number of sources. The maps appear unfinished - with all military camps and other strategic sites removed. These maps were initially overprinted with the National Grid. In 1970, the first 1:10,000 maps were produced using the Transverse Mercator Projection. The revision process continued until recently, with new editions appearing every 10 years or so for urban areas.

### Map Name(s) and Date(s)

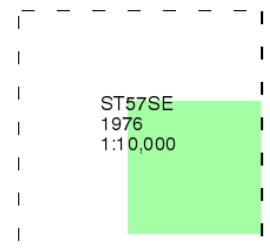

### Historical Map - Slice A

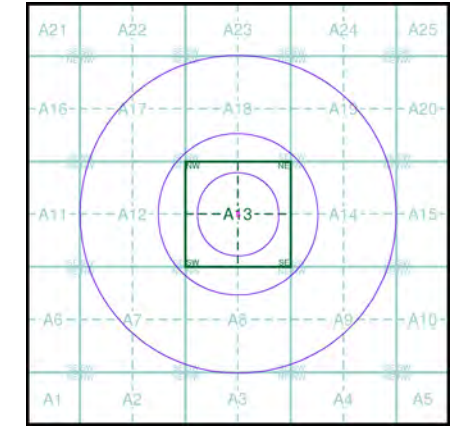

### Order Details

Order Number: 180883921\_1\_1  
 Customer Ref: 733272/AW  
 National Grid Reference: 358600, 171800  
 Slice: A  
 Site Area (Ha): 0.05  
 Search Buffer (m): 1000

### Site Details

Lombard Service Station, Brook Road, Southville, BRISTOL, BS3 1AJ



Tel: 0844 844 9952  
 Fax: 0844 844 9951  
 Web: www.envirocheck.co.uk

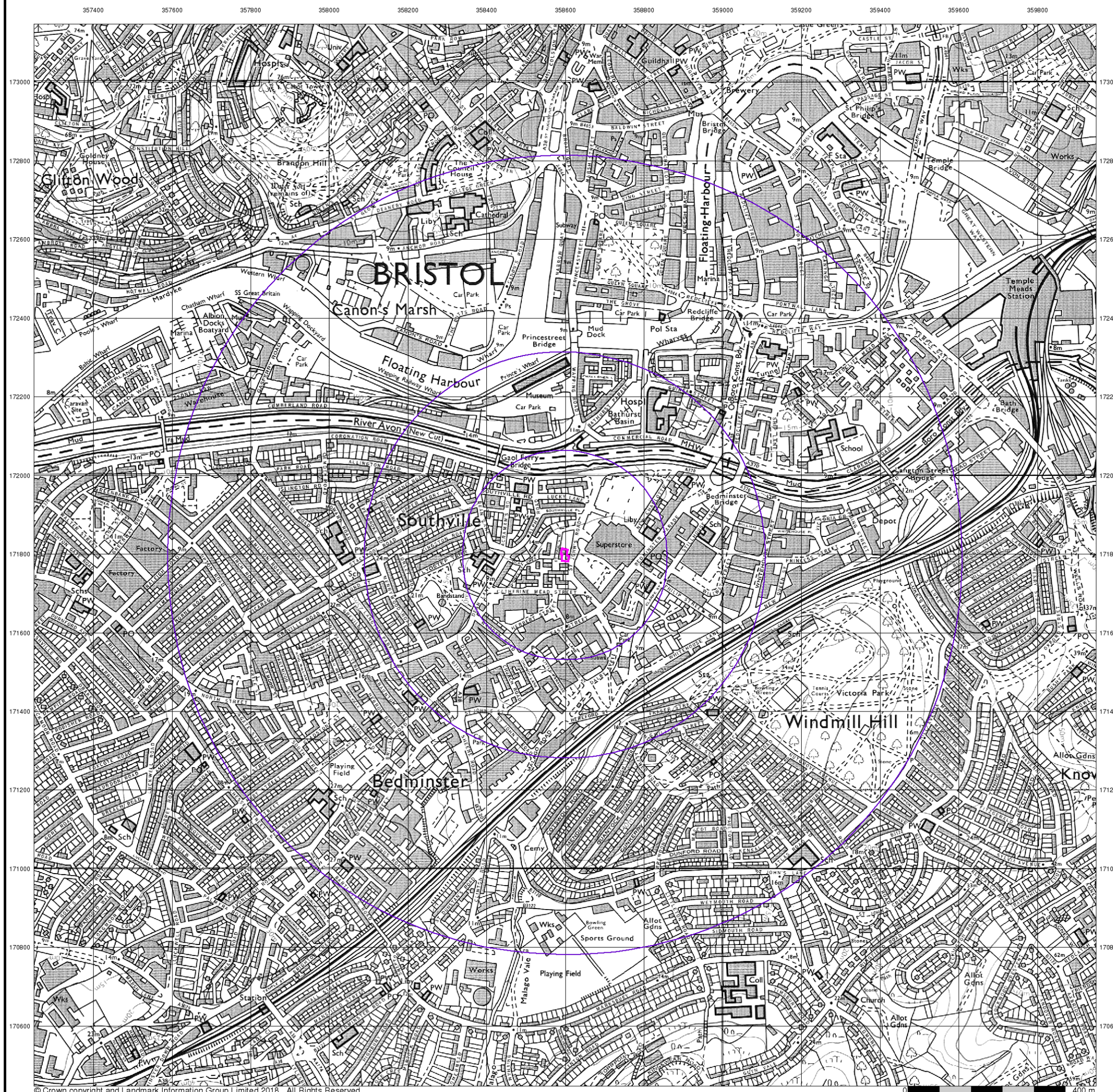

© Crown copyright and Landmark Information Group Limited 2018. All Rights Reserved.



A Member of the RSK Group plc

## Ordnance Survey Plan

Published 1991

Source map scale - 1:10,000

The historical maps shown were reproduced from maps predominantly held at the scale adopted for England, Wales and Scotland in the 1840's. In 1854 the 1:2,500 scale was adopted for mapping urban areas; these maps were used to update the 1:10,560 maps. The published date given therefore is often some years later than the surveyed date. Before 1938, all OS maps were based on the Cassini Projection, with independent surveys of a single county or group of counties, giving rise to significant inaccuracies in outlying areas. In the late 1940's, a Provisional Edition was produced, which updated the 1:10,560 mapping from a number of sources. The maps appear unfinished - with all military camps and other strategic sites removed. These maps were initially overprinted with the National Grid. In 1970, the first 1:10,000 maps were produced using the Transverse Mercator Projection. The revision process continued until recently, with new editions appearing every 10 years or so for urban areas.

### Map Name(s) and Date(s)

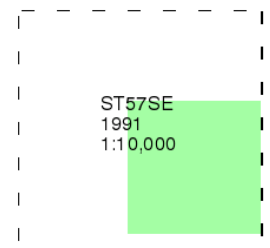

### Historical Map - Slice A

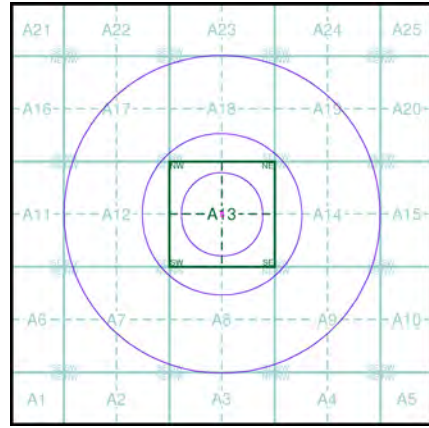

### Order Details

Order Number: 180883921\_1\_1  
 Customer Ref: 733272/AW  
 National Grid Reference: 358600, 171800  
 Slice: A  
 Site Area (Ha): 0.05  
 Search Buffer (m): 1000

### Site Details

Lombard Service Station, Brook Road, Southville, BRISTOL, BS3 1AJ



Tel: 0844 844 9952  
 Fax: 0844 844 9951  
 Web: www.envirocheck.co.uk