

- 1. PV solar panels
- 2. Flush Glazed Roof-lights (1500x1500mm and 1000mmx1800mm)
- 3. Lift overrun
- 4. ASHP Air Source Heat Pump (Indicative only)
- 5. Green Roof

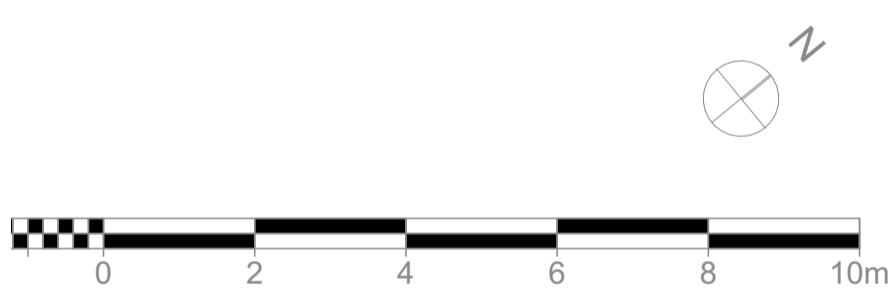
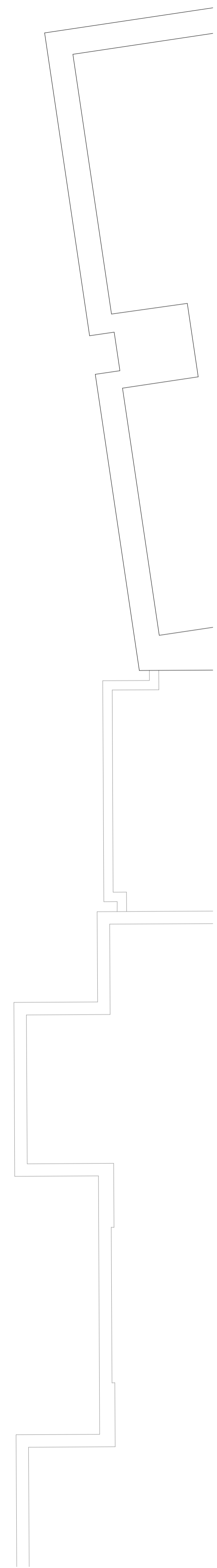
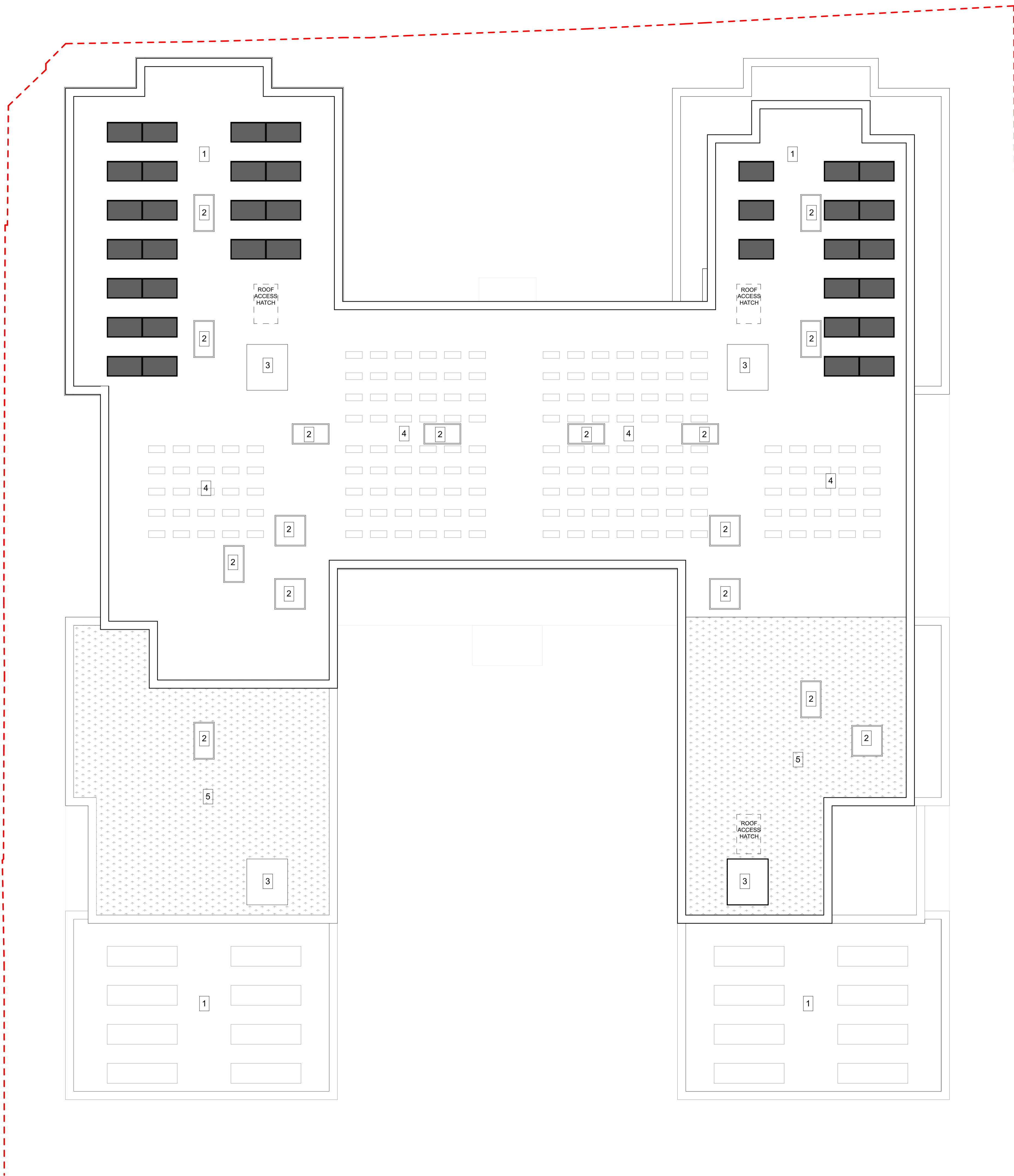

PK	01	PLANNING SET	PK	29/01/2021
PK			PK	20/08/2020
Rev	Ch	Description	By	Date

Designer
PENWARDENHALE
 ARCHITECTS

Project No.
 2513

Project Title
 17, 17B & 19 Between Towns Road, Cowley

Building Name
 Cowley Conservative Club-00

Drawing Title
 GAS Plans Proposed

LR
 Roof Level

Drawn by PK	Checked CH	Scale 1:100 @ A1	Date 29/01/2021
----------------	---------------	---------------------	--------------------

Drawing Number							
Proj	Orig	Zone	Level	Type	Role	No.	Status/Rev
2513	PHA	00	LR	DR	A	0115-P6	