

GROUND FLOOR PLAN

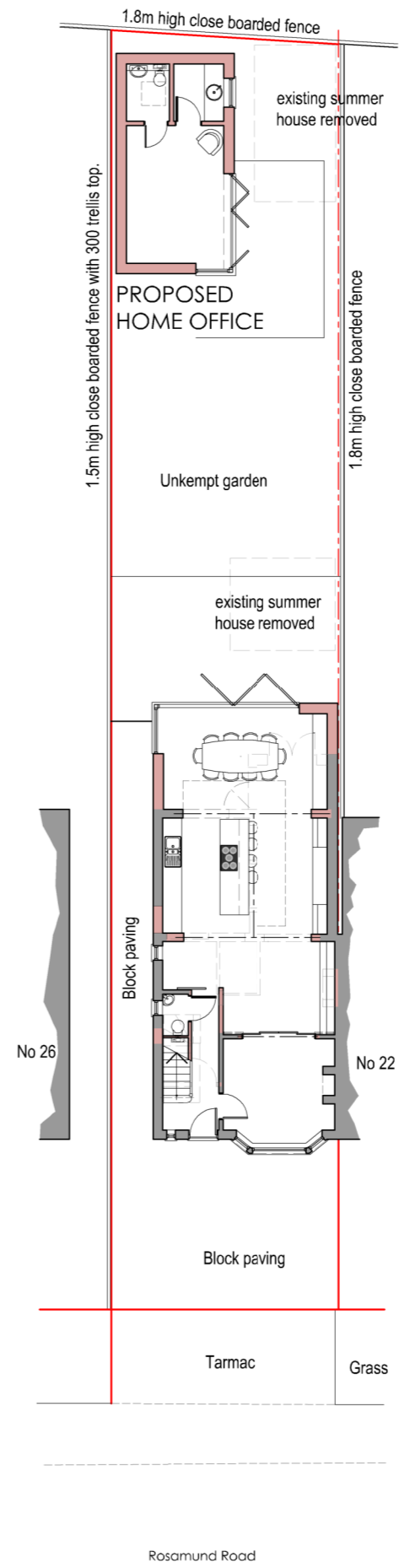

BLOCK PLAN
Scale 1:200



Ordnance Survey, (c) Crown Copyright 2020. All rights reserved.
Licence number 100022432

LOCATION PLAN
Scale 1:1000

arc
architectural design
01235 834771 | 07443 002238
projects@arc-ad.co.uk

Client:
MS HANNAH EDWARDS
Project:
**PROPOSED ALTERATIONS TO
24 ROSAMUND ROAD
WOLVERCOTE, OXFORD**
Drawing:
**HOME OFFICE
BLOCK PLAN AND
LOCATION PLAN.**

Date: **26JAN21** Drawn: **JCF**
Scale: 1:100
A2 1:200

Drawing No: **113-1120 - P02**

All Dimensions must be checked on site and not scaled from this drawing.
Prior to implementation the proposals shown should be assessed by a
Structural Engineer and checked for compliance with the Building
Regulations - For use in precise named location only.
Copyright reserved