

GENERAL NOTES

DIMENSIONED DRAWINGS ONLY. DO NOT SCALE.
 ALL DIMENSIONS TO BE CHECKED PRIOR TO COMMENCEMENT OF ANY WORKS, AND / OR PREPARATION OF ANY SHOP DRAWINGS.
 ALL DISCREPANCIES TO BE REPORTED TO THE ARCHITECT.
 THIS DRAWING TO BE READ IN CONJUNCTION WITH ALL OTHER ARCHITECTS DRAWINGS AND SPECIFICATIONS AND OTHER CONSULTANTS INFORMATION.
 ALL STRUCTURAL ELEMENTS TO BE CROSS CHECKED WITH ENGINEERS DOCUMENTS

NOTES

Stage-3 Indicative Spec Notes	
Key Value	Indicative Specification
L20/465	Frameless Glass double doors and screen. Low Iron Glass. Floor box operation at base. Patch fitting hinges to door head. Bespoke pull handles. Screen over bookshelf with loose fit around joinery and ceiling to avoid alteration to building fabric. Bracket fixing to soffit and walls

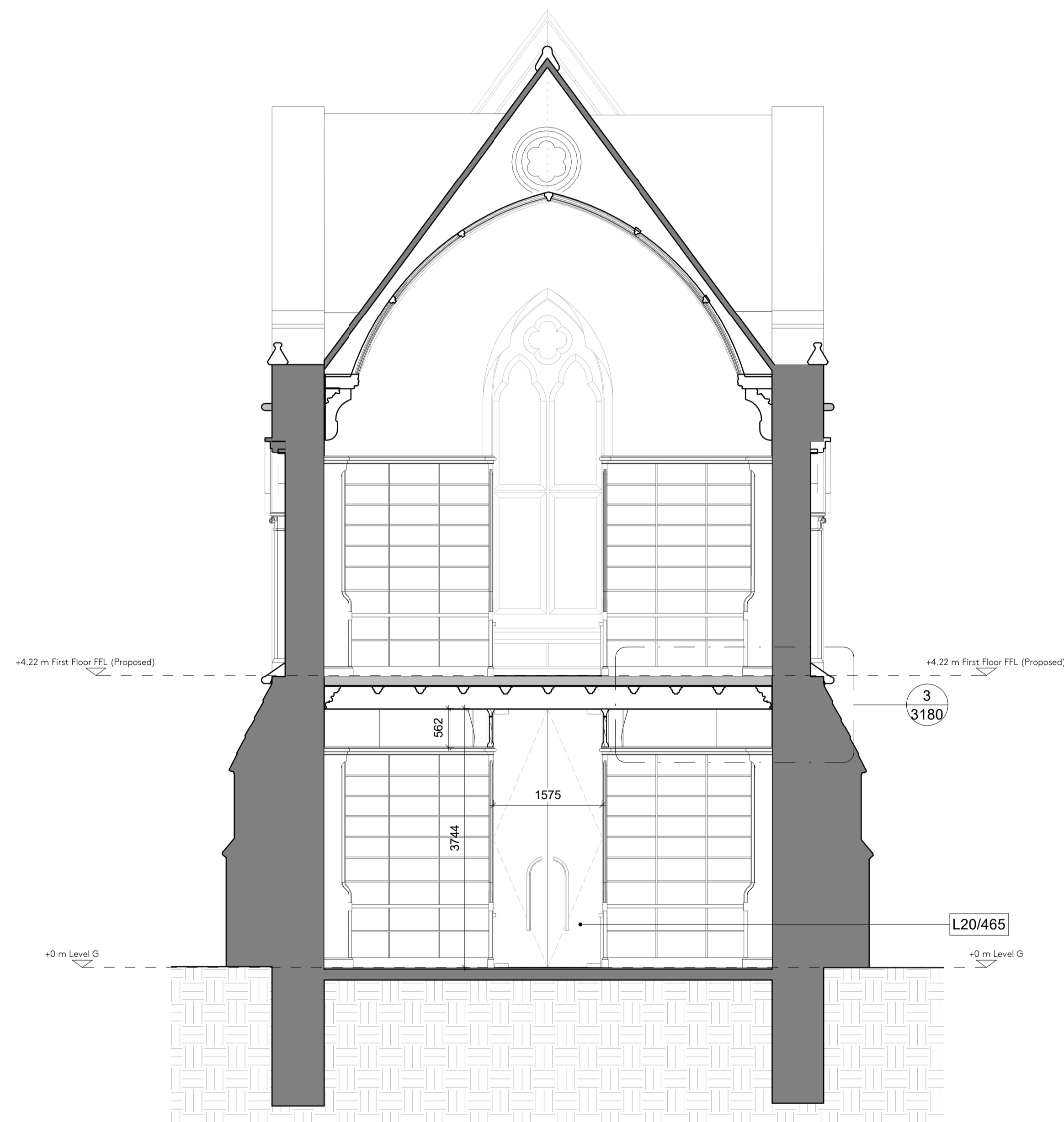

1 GA Section HH - North South
1 : 50

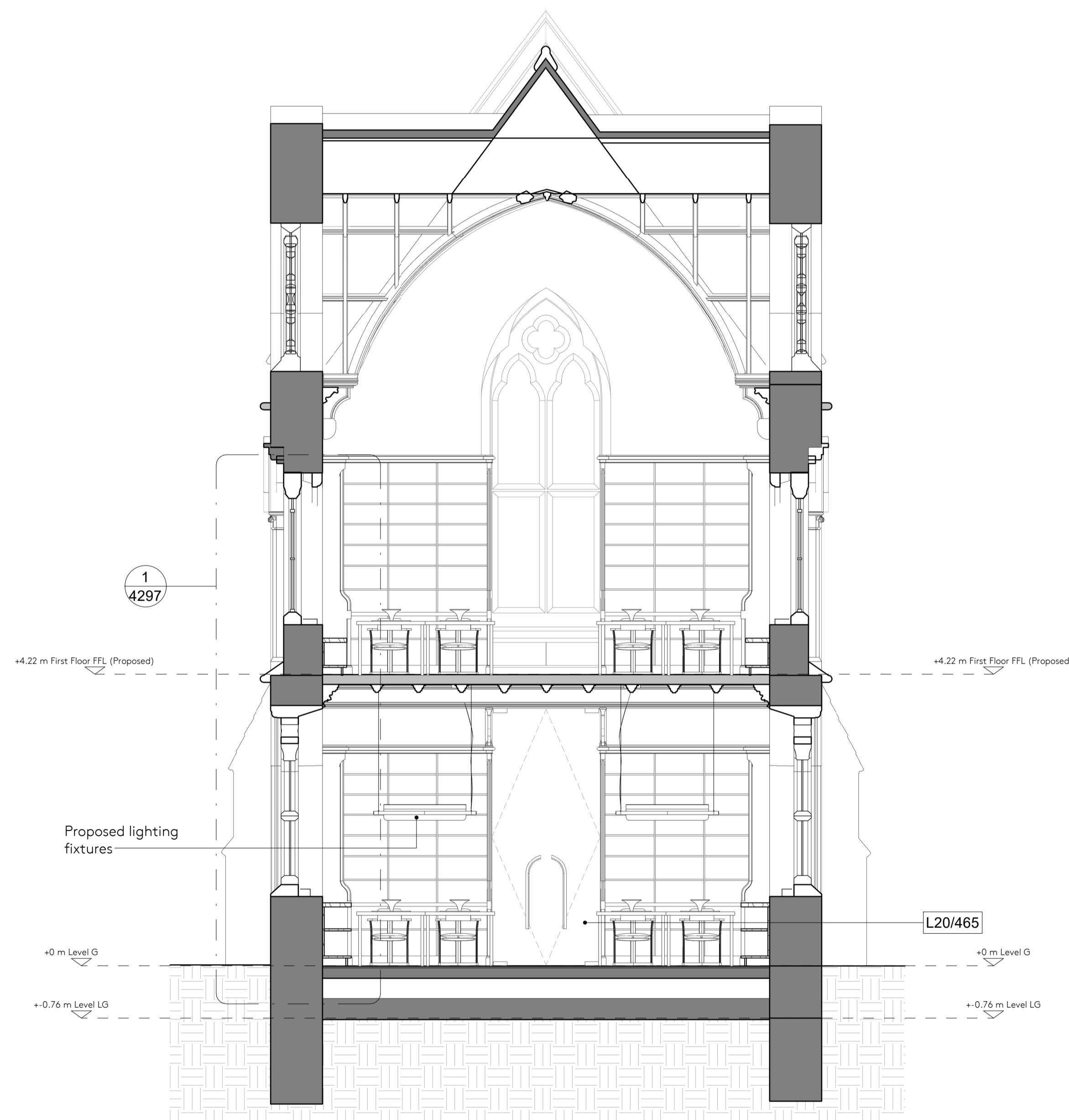

2 GA Section JJ - North South
1 : 50

REVISION SCHEDULE

REVISION	DATE	DESCRIPTION	ISSUED BY
P1	29/01/21	Planning Application	AA

Nex —

90-93 Cowcross St, Clerkenwell,
 London EC1M 6BF

e: office@nex-architecture.com
 t: +44 20 7183 0900

— Exeter College Oxford
 Turf Street, Oxford, OX1 3DP

PROJECT:
 Exeter College - The Library Renewed

DRAWING:
 GA Section HH - North South

STATUS: Planning	DATE: 29/01/21	DRAWN: AA	CHECKED: JF
SCALE: 1 : 50 @ A1	DRAWING NO: 098-Nex- PP-	REVISION: 2505	P1

