

GENERAL NOTES
 DIMENSIONED DRAWINGS ONLY. DO NOT SCALE.
 ALL DIMENSIONS TO BE CHECKED PRIOR TO COMMENCEMENT OF ANY WORKS, AND / OR PREPARATION OF ANY SHOP DRAWINGS.
 ALL DISCREPANCIES TO BE REPORTED TO THE ARCHITECT.
 THIS DRAWING TO BE READ IN CONJUNCTION WITH ALL OTHER ARCHITECTS DRAWINGS AND SPECIFICATIONS AND OTHER CONSULTANTS INFORMATION.
 ALL STRUCTURAL ELEMENTS TO BE CROSS CHECKED WITH ENGINEERS DOCUMENTS

NOTES

Stage-3 Indicative Spec Notes	
Key Value	Indicative Specification
L20/117	Flush oak veneered FD30 fire door. Opens into recess in wall lining. Held open operation via concealed electromagnetic hold open door closer. European Oak veneer to match joinery.
L20/612	Coopers Horizontal Simplex active fire curtain barrier assembly to meet fire consultant spec. Head and guide boxes encapsulated with oak with plasterboard lining to achieve required fire resistance
N10/111	Purpose Made Joinery - Refuge areas. Solid European Oak / Oak Veneered plywood mix - 24mm ply core with solid oak lipping and oak veneer. Spread of flame treatment to Euroclass B-s1-d0. 10% Lacquered finish

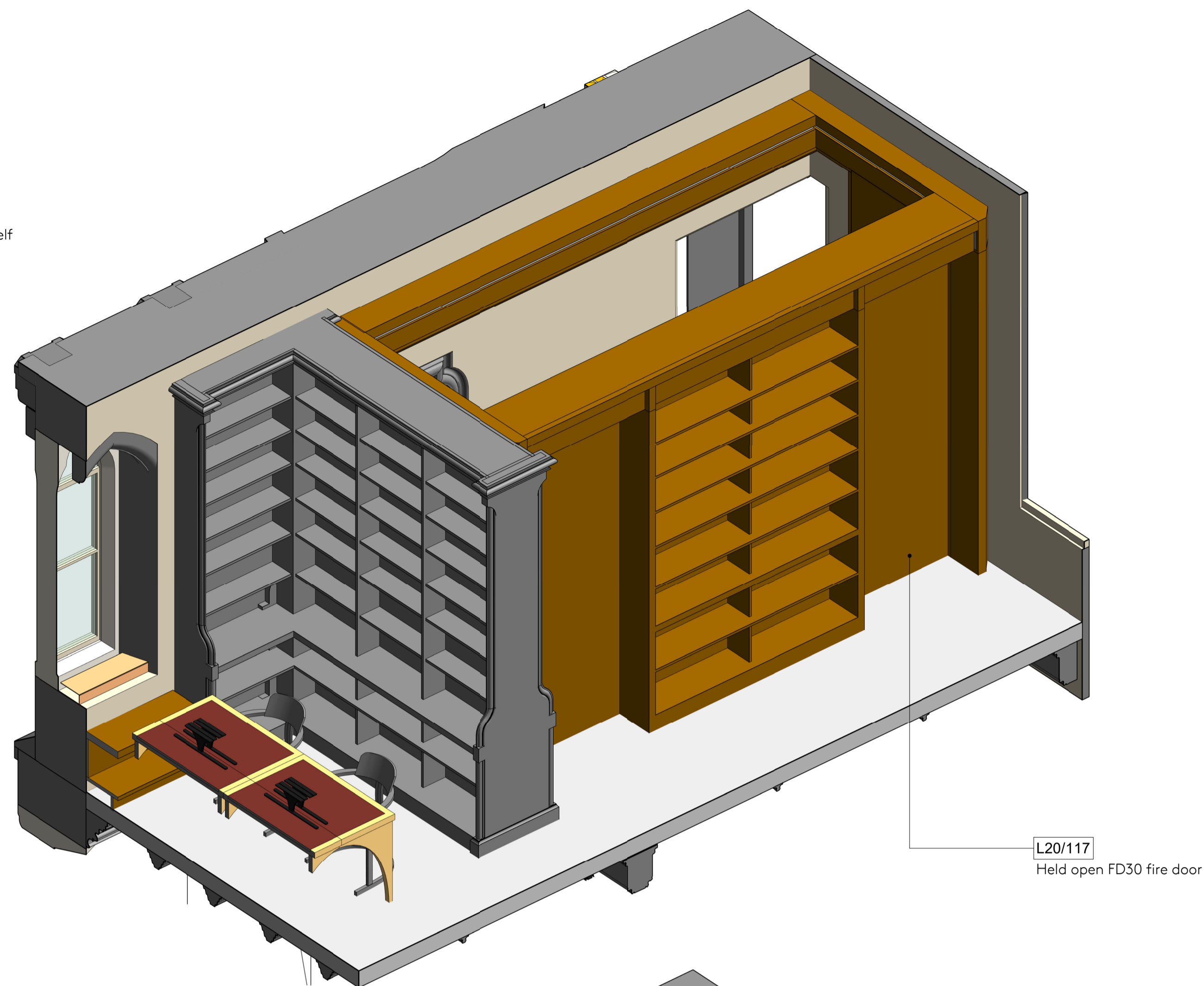
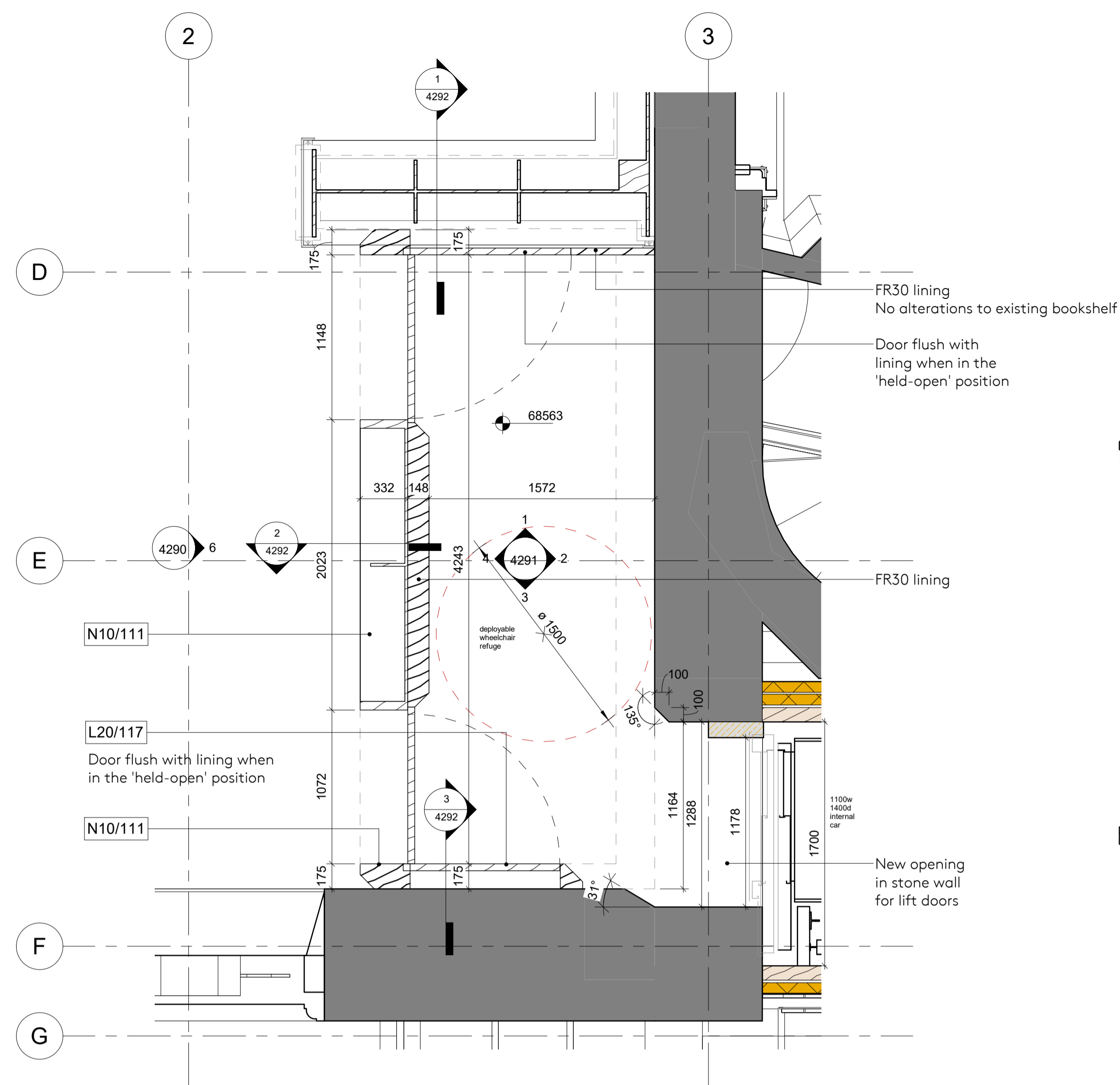

1 Refuge Plan
1:25

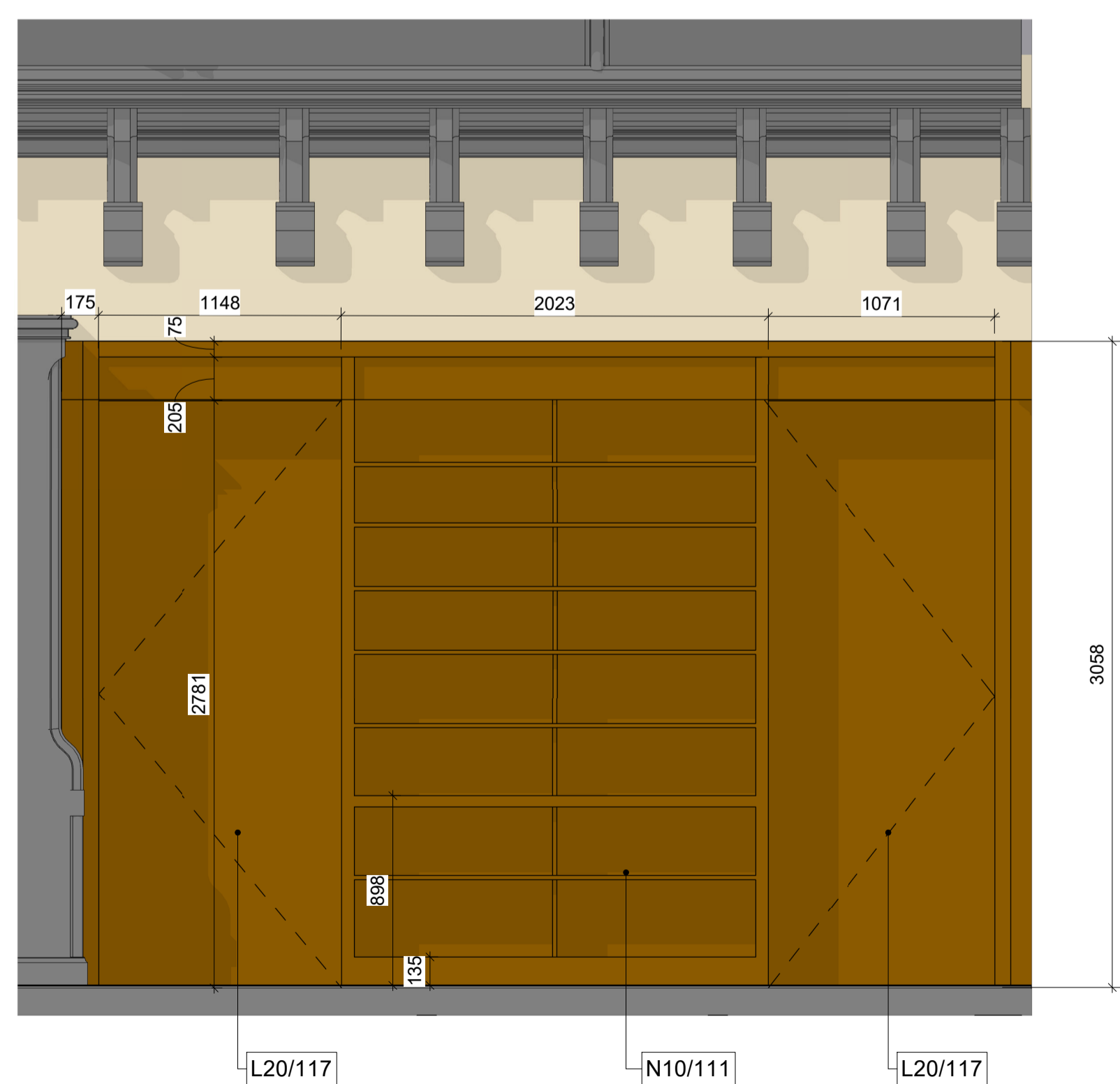

6 Refuge Elevation E
1:25

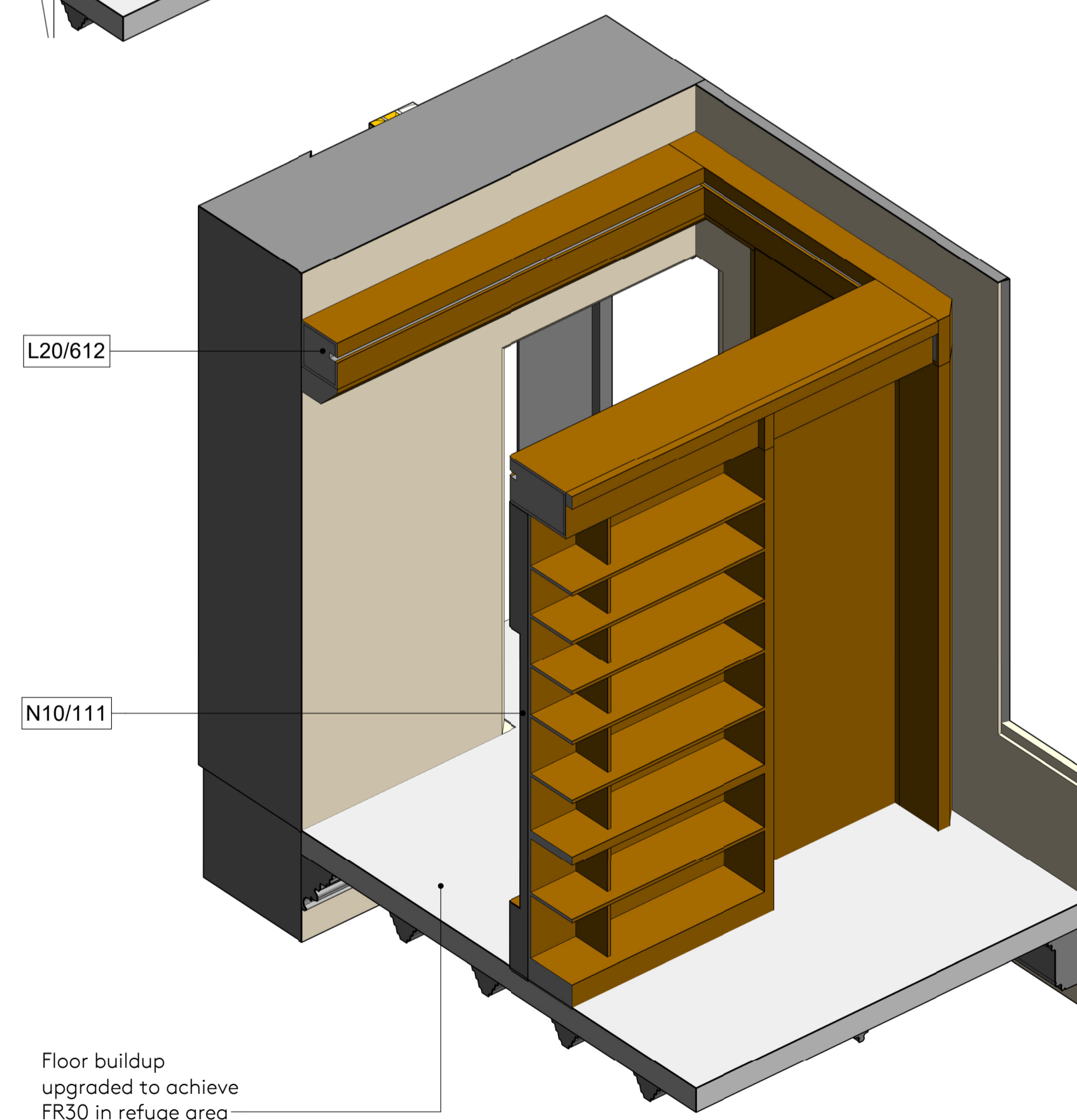

REVISION SCHEDULE

REVISION	DATE	DESCRIPTION	ISSUED BY
P1	29/01/21	Planning Application	AA

Nex —
 90-93 Cowcross St, Clerkenwell,
 London EC1M 6BF
 e: office@nex-architecture.com
 t: +44 20 7183 0900

— Exeter College Oxford
 Turf Street, Oxford, OX1 3DP

PROJECT:
Exeter College - The Library Renewed
 DRAWING:
Deployable refuge

STATUS: Planning	DATE: 29/01/21	DRAWN: AA	CHECKED: JF
SCALE: 1:25 @ A1	DRAWING NO: 098-Nex-PP-	REVISION: 4290	P1

