



GENERAL NOTES
 DIMENSIONED DRAWINGS ONLY. DO NOT SCALE.
 ALL DIMENSIONS TO BE CHECKED PRIOR TO COMMENCEMENT OF ANY WORKS, AND / OR PREPARATION OF ANY SHOP DRAWINGS.
 ALL DISCREPANCIES TO BE REPORTED TO THE ARCHITECT.
 THIS DRAWING TO BE READ IN CONJUNCTION WITH ALL OTHER ARCHITECTS DRAWINGS AND SPECIFICATIONS AND OTHER CONSULTANTS INFORMATION ALL STRUCTURAL ELEMENTS TO BE CROSS CHECKED WITH ENGINEERS DOCUMENTS

NOTES

Stage-3 Indicative Spec Notes	
Key Value	Indicative Specification
G20/255	100mm tk Pollmeier Baubuche Laminated Beech Structural Panel
H31/100	Cast Iron panelised rainscreen cladding. Ductile iron grade 450/10, nom 10mm tk. plus stiffening ribs and external texture. Hook-on fixings to horizontal rails cladding bracket system. Cured surface finish
P10/100	Non-Combustible timber frame / rainscreen-specific mineral-wool insulation slab system with black face finish installed to mfr's recommendation. Allow for breather membrane and vapour barrier.

REVISION SCHEDULE

REVISION	DATE	DESCRIPTION	ISSUED BY
P1	29/01/21	Planning Application	AA

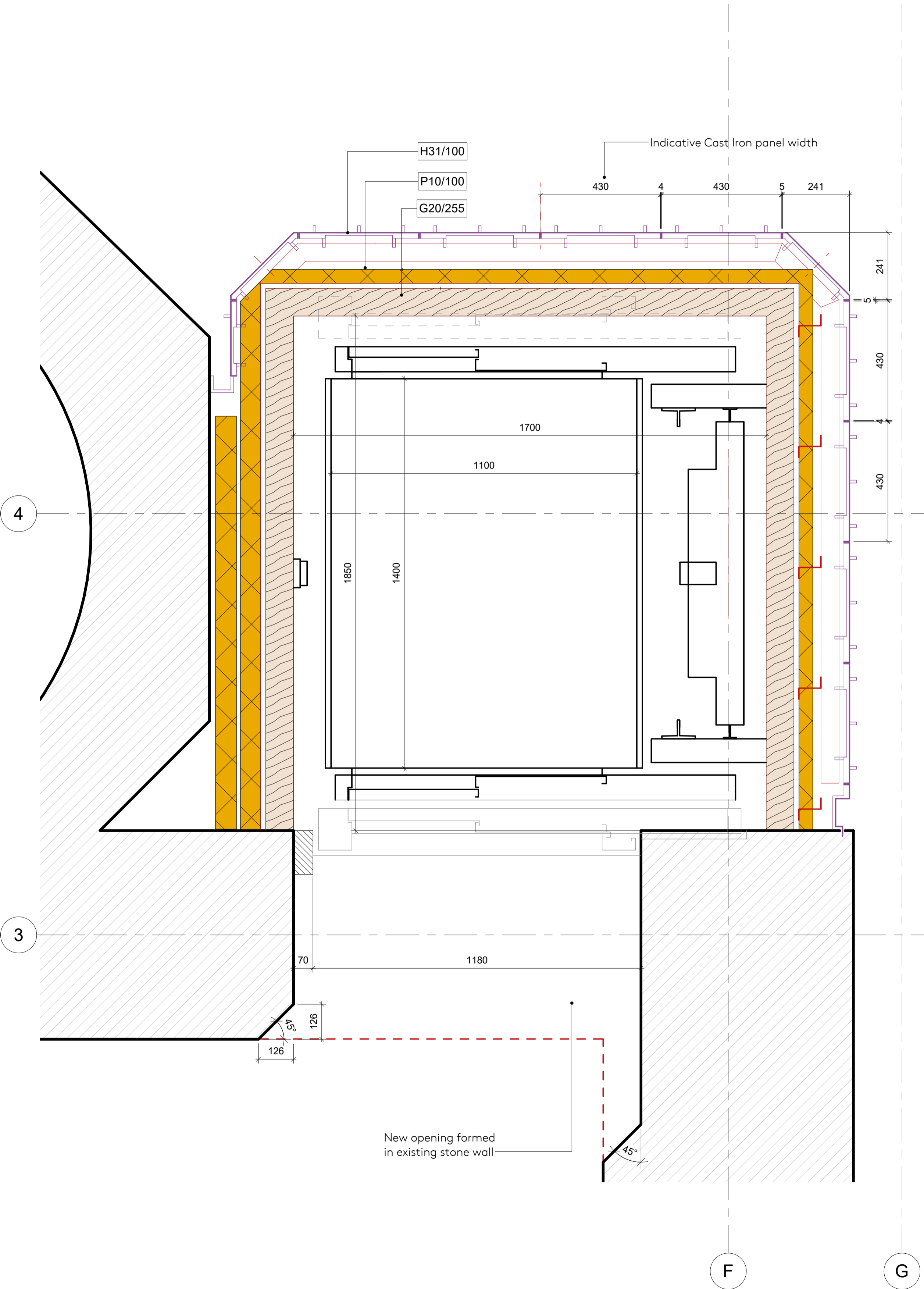

1 Horizontal Section through lift enclosure at L01
1 : 10

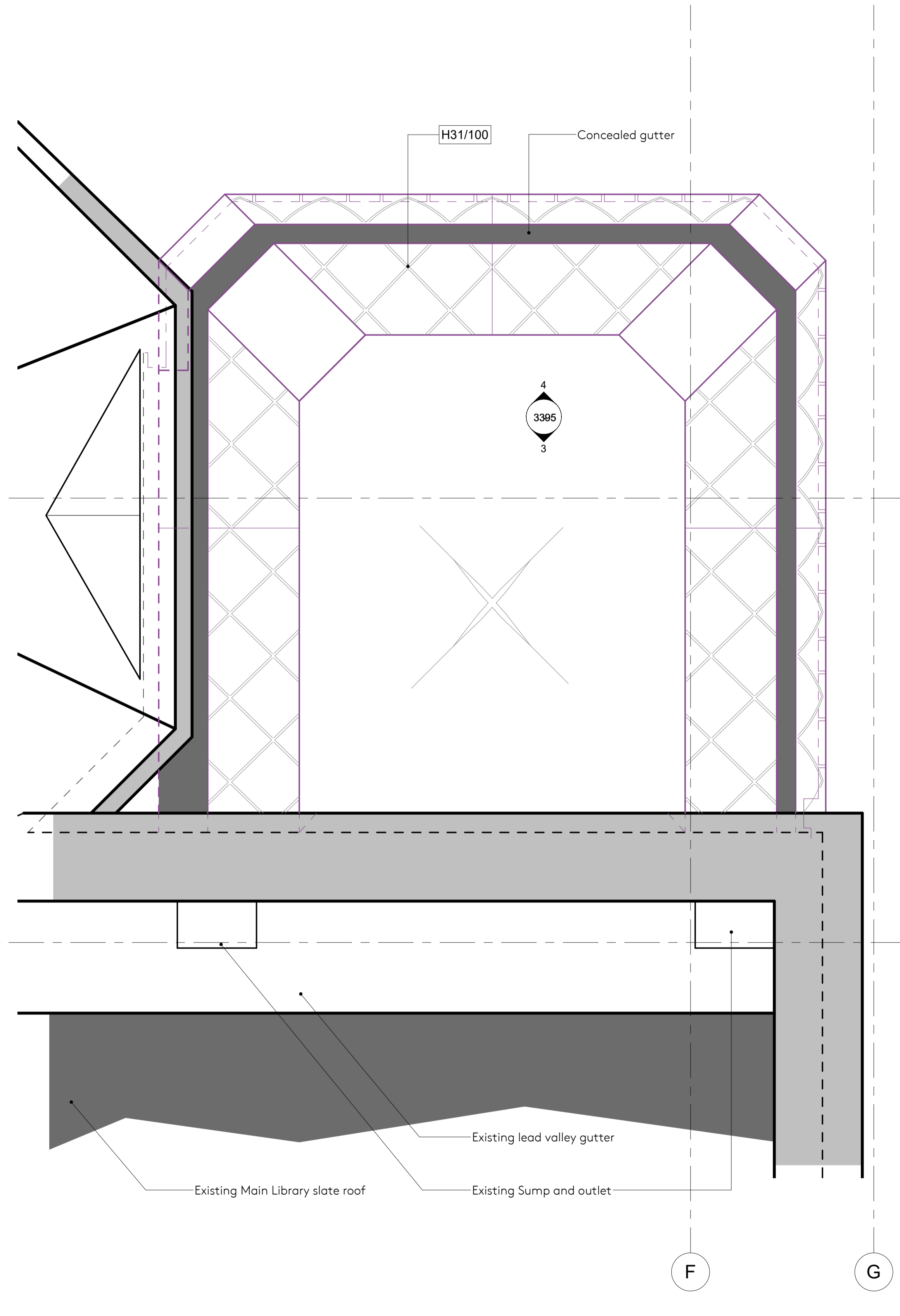

2 Plan - Lift Enclosure at Roof Level
1 : 10

Nex —
 90-93 Cowcross St, Clerkenwell,
 London EC1M 6BF
 e: office@nex-architecture.com
 t: +44 20 7183 0900

— Exeter College Oxford
Turf Street, Oxford, OX1 3DP

PROJECT:
Exeter College - The Library Renewed

DRAWING:
Lift Shaft External Cladding - Horizontal Section

STATUS: Planning	DATE: 29/01/21	DRAWN: JF	CHECKED: JF
SCALE: 1 : 10 @ A1	DRAWING NO: 098-Nex-PP-	REVISION: 3390	P1